

(SUBMIT IN TRIPLICATE)

UNITED STATES
DEPARTMENT OF THE INTERIOR
GEOLOGICAL SURVEY

Land Office Santa Fe
Lease No. 879122-A
Unit _____

SUNDRY NOTICES AND REPORTS ON WELLS

NOTICE OF INTENTION TO DRILL.....		SUBSEQUENT REPORT OF WATER SHUT-OFF.....	
NOTICE OF INTENTION TO CHANGE PLANS.....	X	SUBSEQUENT REPORT OF SHOOTING OR ACIDIZING.....	
NOTICE OF INTENTION TO TEST WATER SHUT-OFF.....		SUBSEQUENT REPORT OF ALTERING CASING.....	
NOTICE OF INTENTION TO RE-DRILL OR REPAIR WELL.....		SUBSEQUENT REPORT OF RE-DRILLING OR REPAIR.....	
NOTICE OF INTENTION TO SHOOT OR ACIDIZE.....		SUBSEQUENT REPORT OF ABANDONMENT.....	
NOTICE OF INTENTION TO PULL OR ALTER CASING.....		SUPPLEMENTARY WELL HISTORY.....	
NOTICE OF INTENTION TO ABANDON WELL.....			

(INDICATE ABOVE BY CHECK MARK NATURE OF REPORT, NOTICE, OR OTHER DATA)

November 14, 1960

Well No. 3-26 Warren Federal is located 990 ft. from [KMX] line and 990 ft. from [E] line of sec. 36
SE SE 26 25N 6W NMP
(1/4 Sec. and Sec. No.) (Twp.) (Range) (Meridian)
Undesignated Dakota Rio Arriba New Mexico
(Field) (County or Subdivision) (State or Territory)

The elevation of the derrick floor above sea level is 6680 ft.

DETAILS OF WORK

(State names of and expected depths to objective sands; show sizes, weights, and lengths of proposed casings; indicate mudding jobs, cementing points, and all other important proposed work)

We propose to change plans for drilling and completing this well to the following:

- (1) Drill with rotary tools from surface to 7050'. E. P. Campbell Drilling contractor.
- (2) Set 290' of 8-5/8" surface casing with cement circulated to surface.
- (3) Set 7050' of 4-1/2" production casing with 200 sacks of cement.
- (4) Set BV tool at 2625' (below Pictured Cliffs sandstone) and cement with 100 sax.
- (5) Perforate and sand free Dakota formation.

I understand that this plan of work must receive approval in writing by the Geological Survey before operation commenced.

Company Kay Kimbell
 Address 2127 San Mateo NE
Albuquerque, New Mexico

By Bert Dargatzis
 Title Geologist

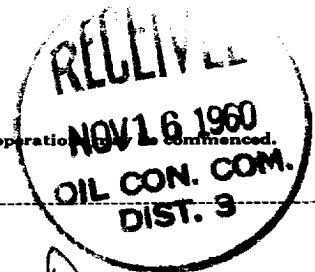

SECRET

CONFIDENTIAL

TOP SECRET

SECRET

CONFIDENTIAL

TOP SECRET

SECRET

CONFIDENTIAL

TOP SECRET

SECRET

CONFIDENTIAL

TOP SECRET

SECRET

CONFIDENTIAL

TOP SECRET

SECRET

CONFIDENTIAL

TOP SECRET

SECRET

CONFIDENTIAL

TOP SECRET

SECRET

CONFIDENTIAL

TOP SECRET

SECRET

CONFIDENTIAL

TOP SECRET

SECRET

CONFIDENTIAL

TOP SECRET

SECRET

CONFIDENTIAL

TOP SECRET

SECRET

CONFIDENTIAL

TOP SECRET

SECRET

CONFIDENTIAL

TOP SECRET

SECRET

CONFIDENTIAL

TOP SECRET

SECRET

CONFIDENTIAL

TOP SECRET

SECRET

CONFIDENTIAL

TOP SECRET

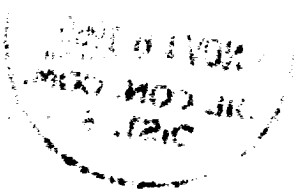

NEW MEXICO OIL CONSERVATION COMMISSION

Well Location and Acreage Dedication Plat

Section A.

Date September 19

Operator Kay Kimbell Lease Warren-Federal
 Well No. 3-26 Unit Letter P Section 26 Township 25 North Range 6 West
 Located 990 Feet From South Line, 990 Feet From East
 County Rio Arriba G. L. Elevation 6670 Dedicated Acreage 320
 Name of Producing Formation Dakota Gallup Pool Otero

1. Is the Operator the only owner* in the dedicated acreage outlined on the plat below?
 Yes X No _____
2. If the answer to question one is "no," have the interests of all the owners been consolidated by communitization agreement or otherwise? Yes _____ No _____. If answer is "yes,"
 Type of Consolidation _____
3. If the answer to question two is "no," list all the owners and their respective interests below:

Owner

Land Description

<u>Owner</u>	<u>Land Description</u>

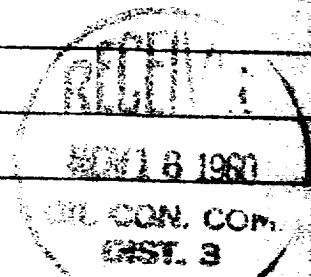

Section B

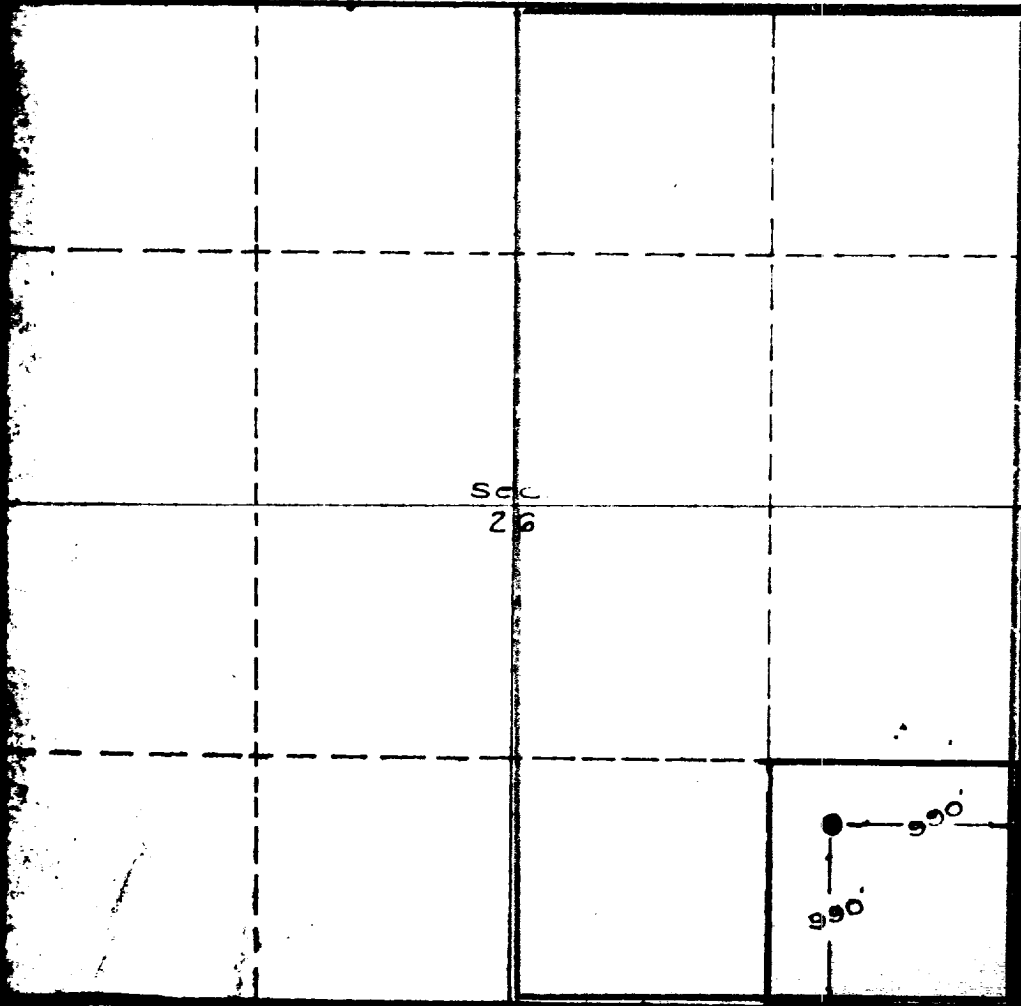

This is to certify that the information in Section A above is true and complete to the best of my knowledge and belief.

Kay Kimbell

(Operator)

Bert Venegas
 (Representative)

2127 San Mateo NE-Albuquerque, N.M.
 Address

This is to certify that the well location shown on this plat in Section B is true from field notes of surveys made by me or my supervisor and the same is true to the best of my knowledge and belief.

Date Surveyed _____

Ernest V. Johnson
 Registered Land Surveyor.

Certificate No. 1945