

(SUBMIT IN TRIPLICATE)

UNITED STATES
DEPARTMENT OF THE INTERIOR
GEOLOGICAL SURVEY

Land Office Santa Fe
Lease No. 079071
Unit W/2

SUNDRY NOTICES AND REPORTS ON WELLS

NOTICE OF INTENTION TO DRILL.....	XXX	SUBSEQUENT REPORT OF WATER SHUT-OFF.....	
NOTICE OF INTENTION TO CHANGE PLANS.....		SUBSEQUENT REPORT OF SHOOTING OR ACIDIZING.....	
NOTICE OF INTENTION TO TEST WATER SHUT-OFF.....		SUBSEQUENT REPORT OF ALTERING CASING.....	
NOTICE OF INTENTION TO RE-DRILL OR REPAIR WELL.....		SUBSEQUENT REPORT OF RE-DRILLING OR REPAIR.....	
NOTICE OF INTENTION TO SHOOT OR ACIDIZE.....		SUBSEQUENT REPORT OF ABANDONMENT.....	
NOTICE OF INTENTION TO PULL OR ALTER CASING.....		SUPPLEMENTARY WELL HISTORY.....	
NOTICE OF INTENTION TO ABANDON WELL.....			

(INDICATE ABOVE BY CHECK MARK NATURE OF REPORT, NOTICE, OR OTHER DATA)

March 28, 1957

, 19

Schultz-Canyon Largo Unit

Well No. 1-28 is located 1,650 ft. from [N] line and 1,450 ft. from [W] line of sec. 28

NW/4 Section 28

25-North

6 West

N.M.P.M.

(1/4 Sec. and Sec. No.)

(Twp.)

(Range)

(Meridian)

Canyon Largo P. C.

(Field)

Rio Arriba County

(County or Subdivision)

New Mexico

(State or Territory)

The elevation of the derrick floor above sea level is 6,739 ft.

DETAILS OF WORK

(State names of and expected depths to objective sands; show sizes, weights, and lengths of proposed casings; indicate mudding jobs, cementing points, and all other important proposed work)

West half of Section 28 is dedicated to this well. (SW/4 on Santa Fe 079071-A)

Propose to spud with ~~subbitum~~ "shot hole" rig; then drill with rotary tools to the top of the Pictured Cliffs formation - expected at about 2,700 feet. Completion with cable tools - and sand fracturing and/or shooting with solidified nitro-glycerin as conditions warrant.

Casing program: 90 feet of 8-5/8" new 8 rd. thd. 24# casing. Circulate cement to surface, using at least 70 sacks of cement.

5-1/2" OD J-55 - 14# or better casing - to be set on top of Pictured Cliffs formation, cemented with 100 sacks regular cement.

1" tubing to be set within 20 feet of total depth for production

I understand that this plan of work must receive approval in writing by the Geological Survey before operations may be commenced.

Company Frank A. Schultz, Jr.Address Box 728Farmington, New Mexico.

By C. Beeson Neal
C. Beeson Neal, Agent in Farmington
Title _____

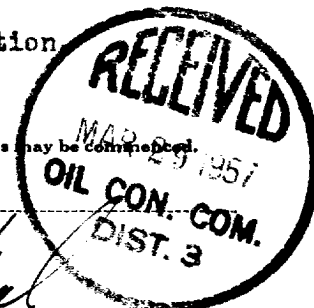

NEW MEXICO
OIL CONSERVATION COMMISSION

Form C-128

Well Location and/or Gas Proration Plat

Date March 28, 1957

Operator EL PASO NATURAL GAS COMPANY Lease Canyon Largo Unit

Well No. 1-28 Section 28 Township 25 NORTH Range 6 WEST, NMPM

Located 1650 Feet From the NORTH Line, 1450 Feet From the WEST Line,

RIO ARRIBA County, New Mexico. G. L. Elevation 6730.6 UNGRADED.

Name of Producing Formation Pictured Cliffs Pool Canyon Largo Dedicated Acreage 320

(Note: All distances must be from outer boundaries of Section)

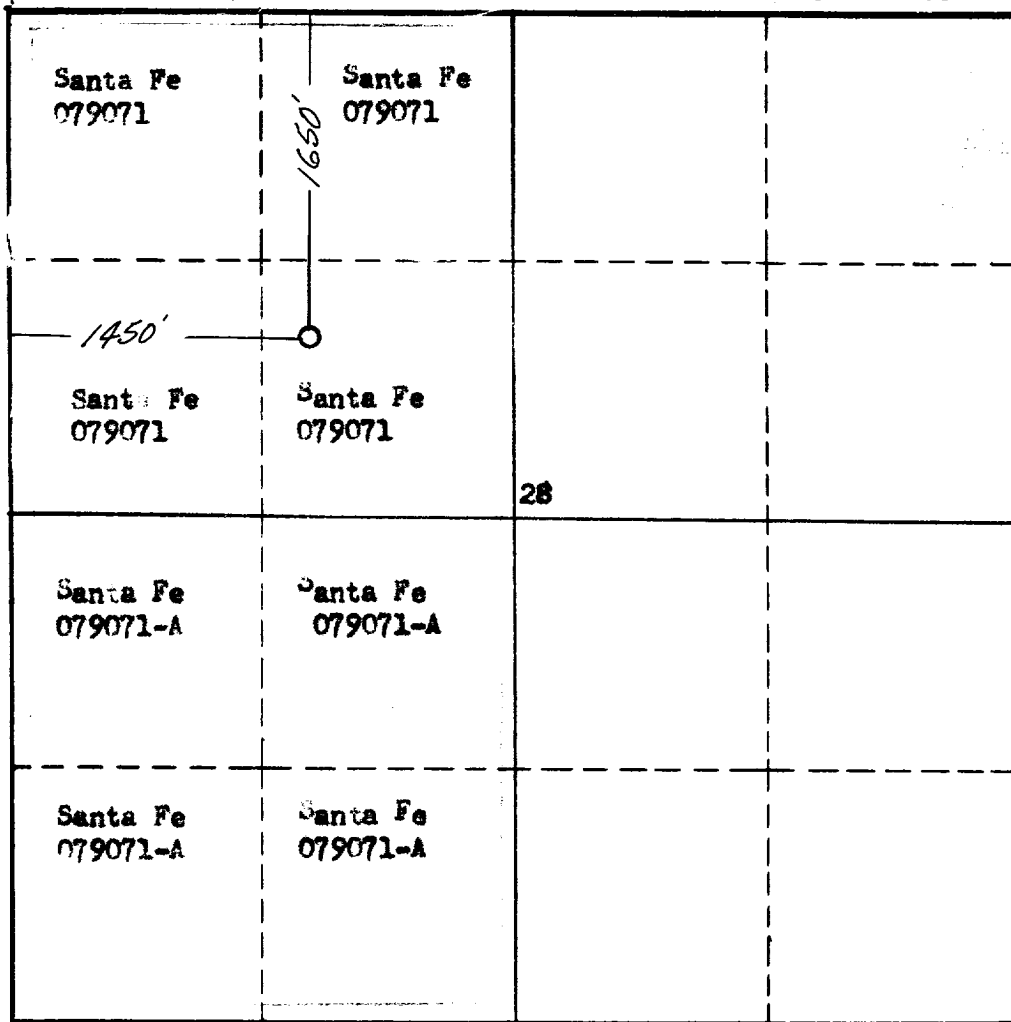

NOTE

This section of
form is to be
used for gas
wells only.

SCALE: 1"=1000'

1. Is this Well a Dual Comp. ? Yes No X.
2. If the answer to Question 1 is yes, are there any other dually completed wells within the dedicated acreage? Yes No X.

Name James P. Leese
Position C. Benson Neal, Agent in Farmington
Representing Frank A. Schultz, Jr.
Address Box 728 - Farmington, New Mexico

This is to certify that the above plat was prepared from field notes of actual surveys made by me or under my supervision and that the same are true and correct to the best of my knowledge and belief.

Date Surveyed 11 FEBRUARY 1957
James P. Leese
Registered Professional Engineer and/or
Land Surveyor James P. Leese
N. Mex. Reg. No. 1463