

IN REPLY REFER TO:



COPY TO O. G. Co.

UNITED STATES  
DEPARTMENT OF THE INTERIOR  
GEOLOGICAL SURVEY  
P. O. Box 965  
Farmington, New Mexico

January 6, 1956

The Superior Oil Company  
Midland, Texas

Re: Santa Fe 078875

Gentlemen:

Receipt is acknowledged of your "Notice of Intention to Drill" dated January 3, 1956 covering your well No. 1-29 Inabeth-Phillips in NW 1/4 sec. 29, T. 25 N., R. 6 W., N. M. P. M., Rio Arriba County, New Mexico, Canyon Large Unit.

Your proposed work is hereby approved subject to compliance with the provisions of the "Oil and Gas Operating Regulations" revised May 25, 1942, a copy of which will be sent to you on request, and subject to the following conditions:

1. Drilling operations so authorized are subject to the attached sheet for general conditions of approval.
2. Furnish copies of all logs.

Very truly yours,

(Orig. Sgd.) P. T. McGrath

P. T. McGrath  
District Engineer

PTMcGrath:ac

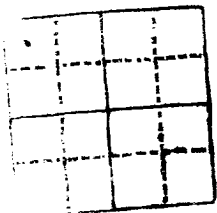

<b>X</b>		

(SUBMIT IN TRIPLICATE)

UNITED STATES  
DEPARTMENT OF THE INTERIOR  
GEOLOGICAL SURVEY

Land Office Santa Fe  
Lease No. 078875  
Unit Canyon Largo Unit

SUNDRY NOTICES AND REPORTS ON WELLS

NOTICE OF INTENTION TO DRILL.....	<b>X</b>	SUBSEQUENT REPORT OF WATER SHUT-OFF.....	
NOTICE OF INTENTION TO CHANGE PLANS.....		SUBSEQUENT REPORT OF SHOOTING OR ACIDIZING.....	
NOTICE OF INTENTION TO TEST WATER SHUT-OFF.....		SUBSEQUENT REPORT OF ALTERING CASING.....	
NOTICE OF INTENTION TO RE-DRILL OR REPAIR WELL.....		SUBSEQUENT REPORT OF RE-DRILLING OR REPAIR.....	
NOTICE OF INTENTION TO SHOOT OR ACIDIZE.....		SUBSEQUENT REPORT OF ABANDONMENT.....	
NOTICE OF INTENTION TO PULL OR ALTER CASING.....		SUPPLEMENTARY WELL HISTORY.....	
NOTICE OF INTENTION TO ABANDON WELL.....			

(INDICATE ABOVE BY CHECK MARK NATURE OF REPORT, NOTICE, OR OTHER DATA)

INARTE PHILLIPS-GOVERNMENT #1-29 ..... January 3 ..... 19 56

Well No. 1-29 is located 990 ft. from N line and 700 ft. from W line of sec. 29

1/4 Section 29 ..... T-25N ..... R-6W ..... NM  
(1/4 Sec. and Sec. No.) (Twp.) (Range) (Meridian)  
Canyon Largo Unit ..... Rio Arriba ..... New Mexico  
(Field) (County or Subdivision) (State or Territory)

The elevation of the derrick floor above sea level is 6786' ft. (Estimated)

DETAILS OF WORK

(State names of and expected depths to objective sands; show sizes, weights, and lengths of proposed casings; indicate mudding jobs, cementing points, and all other important proposed work)

Propose to drill well to Pictured Cliffs Formation, or 2760', or production, whichever is the lesser.

Propose to set approximately 175' of 9-5/8" casing with cement circulated to the surface.

Propose to cement 7" casing through or on top of producing zone, if production is encountered.

I understand that this plan of work must receive approval in writing by the Geological Survey before operations may be commenced.

Company THE SUPERIOR OIL COMPANY

Address Midland, Texas

By L. J. Willis (L. J. Willis)

Title Petroleum Engineer

W. W. STUDDERT  
MEMBER  
AMERICAN SOCIETY OF  
CIVIL ENGINEERS

REGISTERED ENGINEERS  
& LAND SURVEYORS

ARIZONA  
COLORADO  
IDAHO  
LOUISIANA  
MONTANA  
NEVADA  
NEW MEXICO  
OKLAHOMA  
TEXAS  
UTAH  
WYOMING

# STUDDERT ENGINEERING CO.

CIVIL ENGINEERS

221 SOUTH COLORADO  
MIDLAND, TEXAS

TELEPHONES 4-8682 & 2-1373

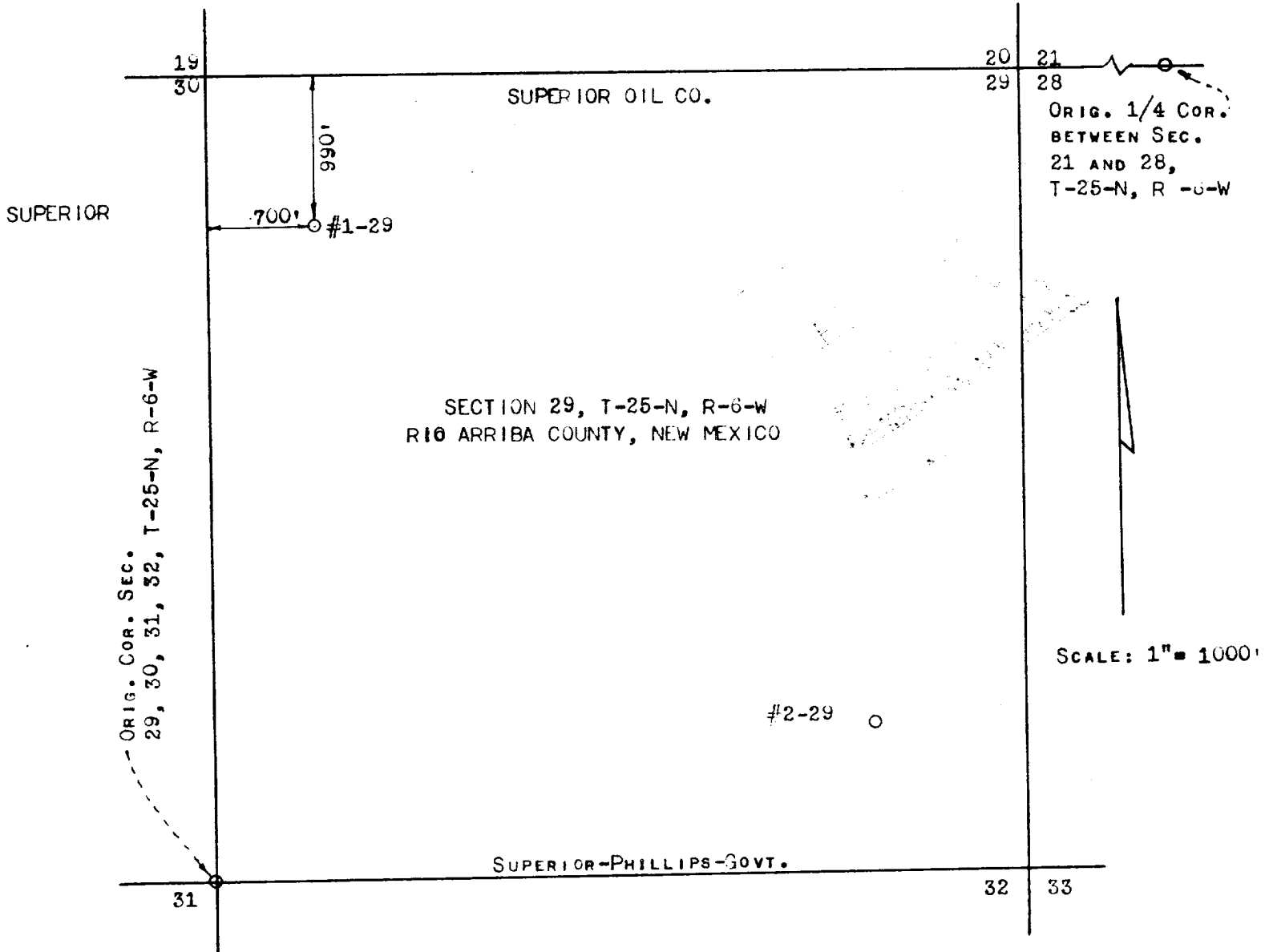

I, W W STUDDERT, REGISTERED PROFESSIONAL ENGINEER No. 388, STATE OF NEW MEXICO, HEREBY CERTIFY THAT THIS WELL LOCATION: SUPERIOR OIL CO., SUPERIOR-PHILLIPS-GOVT., #1-29, 990' FROM THE NORTH LINE AND 700' FROM THE WEST LINE OF SECTION 29, T-25-N, R-6-W, RIO ARRIBA COUNTY, NEW MEXICO IS STAKED ON THE GROUND UNDER MY SUPERVISION AND THAT THIS PLAT IS AND CORRECT.

DECEMBER 15, 1955

*W W Studdert*  
W W STUDDERT

