

(SUBMIT IN TRIPLICATE)

Land Office Santa Fe

Lease No. ST 078477

Unit _____

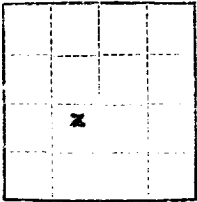

UNITED STATES
DEPARTMENT OF THE INTERIOR
GEOLOGICAL SURVEY

SUNDRY NOTICES AND REPORTS ON WELLS

| | | | |
|--|-------------------------------------|--|--|
| NOTICE OF INTENTION TO DRILL | <input checked="" type="checkbox"/> | SUBSEQUENT REPORT OF WATER SHUT-OFF | |
| NOTICE OF INTENTION TO CHANGE PLANS | | SUBSEQUENT REPORT OF SHOOTING OR ACIDIZING | |
| NOTICE OF INTENTION TO TEST WATER SHUT-OFF | | SUBSEQUENT REPORT OF ALTERING CASING | |
| NOTICE OF INTENTION TO RE-DRILL OR REPAIR WELL | | SUBSEQUENT REPORT OF RE-DRILLING OR REPAIR | |
| NOTICE OF INTENTION TO SHOOT OR ACIDIZE | | SUBSEQUENT REPORT OF ABANDONMENT | |
| NOTICE OF INTENTION TO PULL OR ALTER CASING | | SUPPLEMENTARY WELL HISTORY | |
| NOTICE OF INTENTION TO ABANDON WELL | | | |

(INDICATE ABOVE BY CHECK MARK NATURE OF REPORT, NOTICE, OR OTHER DATA)

December 4, 19 56

Nordhaus-Federal

Well No. 6 is located 1825 ft. from N line and 1850 ft. from W line of sec. 19

NE/4 SW/4 19
(1/4 Sec. and Sec. No.)

25-N
(Twp.)

7-W
(Range)

(Meridian)

Undesignated
(Field)

Rio Arriba
(County or Subdivision)

New Mexico
(State or Territory)

The elevation of the derrick floor above sea level is _____ ft. 6535.52 G.L.

DETAILS OF WORK

(State names of and expected depths to objective sands; show sizes, weights, and lengths of proposed casings; indicate mudding jobs, cementing points, and all other important proposed work)

Plan to drill and complete in the Pictured Cliffs formation.
Will set 100' @ 5/8" casing with 100 sacks cement; set 5 1/2" 15.5# J-55 new casing at expected TD of 2300' and cement with 100 sacks cement. Perforate 5 1/2" casing and fracture treat formation with 40,000 gallons of water mixed 1 1/2 pounds of sand to the gallon. Expected top of Pictured Cliff 2200'.

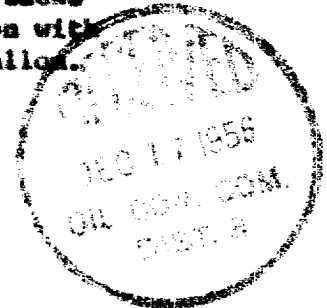

I understand that this plan of work must receive approval in writing by the Geological Survey before operations may be commenced.

Company WESTERN NATURAL GAS COMPANY

Address 823 Midland Tower

Midland, Texas

By _____

Title Office Manager

DECEMBER 3, 1956

WESTERN NATURAL GAS CO. ETAL

NORDHAUS FEDERAL

SF 078477

6

19

25 N

7 W

1825

SOUTH

1850

WEST

RIO ARRIBA

6528.45

PICTURED CLIFF

WILDCAT

160.47 AC
(1882 PLAT)

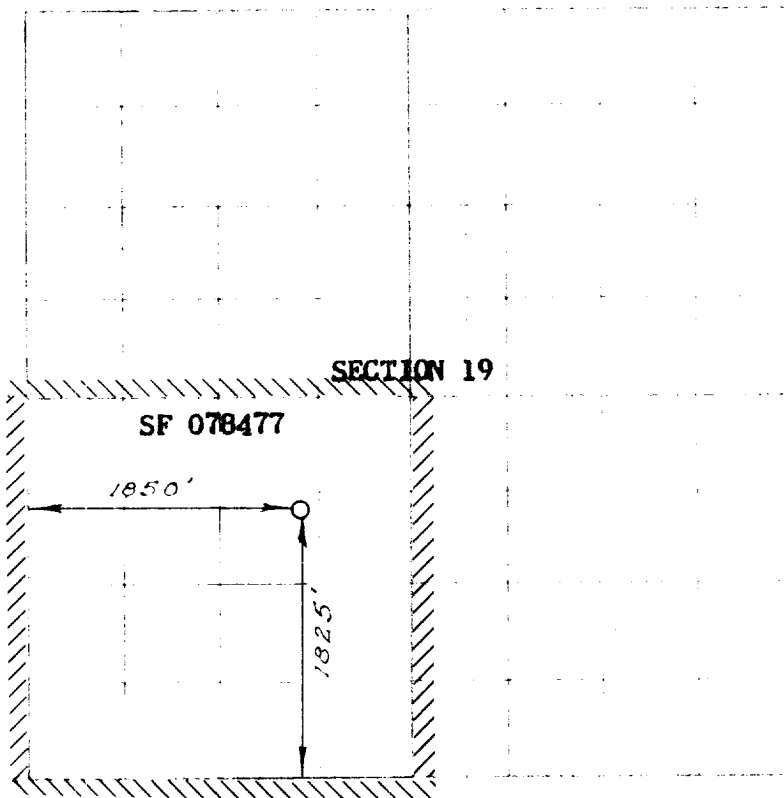

RECORDED
DEC 14
U.S. GEOLOGICAL SURVEY

NOTE:
This section of
land is to be used
for public purposes.

I, the undersigned, being a duly qualified and licensed Professional Engineer and of lawful age, do hereby certify that the foregoing is a true and correct copy of the original plat as shown to me by the applicant.

DECEMBER 1, 1956

L. C. Walker
L. C. Walker
Registered Professional Engineer and of Lawful Age

By this western land survey
I hereby certify that the
information furnished to me
in the above plat, and all
other information furnished
to me by the applicant, are
true and correct, and that
I am a duly qualified and
licensed Professional Engineer
and of lawful age.