

(SUBMIT IN TRIPLICATE)

Land Office **Santa Fe**  
Lease No. **NM 067988**  
Unit **RECEIVED**

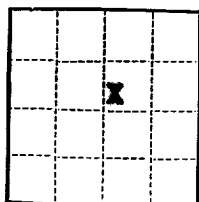

UNITED STATES  
DEPARTMENT OF THE INTERIOR  
GEOLOGICAL SURVEY

SUNDRY NOTICES AND REPORTS ON WELLS

NOTICE OF INTENTION TO DRILL	<input checked="" type="checkbox"/>	SUBSEQUENT REPORT OF WATER SHUT-OFF	
NOTICE OF INTENTION TO CHANGE PLANS		SUBSEQUENT REPORT OF SHOOTING OR ACIDIZING	
NOTICE OF INTENTION TO TEST WATER SHUT-OFF		SUBSEQUENT REPORT OF ALTERING CASING	
NOTICE OF INTENTION TO RE-DRILL OR REPAIR WELL		SUBSEQUENT REPORT OF RE-DRILLING OR REPAIR	
NOTICE OF INTENTION TO SHOOT OR ACIDIZE		SUBSEQUENT REPORT OF ABANDONMENT	
NOTICE OF INTENTION TO PULL OR ALTER CASING		SUPPLEMENTARY WELL HISTORY	
NOTICE OF INTENTION TO ABANDON WELL			

(INDICATE ABOVE BY CHECK MARK NATURE OF REPORT, NOTICE, OR OTHER DATA)

November 21, 1961

WELL T. J. Foster  
Well No. **1** is located **1820** ft. from **[N]** line and **1830** ft. from **[E]** line of sec. **7**  
**NE**  
**SW/4 Sec. 7** **25 N** **7 W** **N.M.P.M.**  
(1/4 Sec. and Sec. No.) (Twp.) (Range) (Meridian)  
**Basin Dakota** **Rio Arriba** **New Mexico**  
(Field) (County or Subdivision) (State or Territory)

The elevation of the **ground level** ~~surface~~ above sea level is **6498** ft.

DETAILS OF WORK

(State names of and expected depths to objective sands; show sizes, weights, and lengths of proposed casings; indicate mudding jobs, cementing points, and all other important proposed work)

1. Drill 12-1/4" hole to 250' with rotary tools.
2. Run and cement 8-5/8" OD, 24# casing set at 250'. Circulate cement to surface.
3. Drill 7-7/8" hole to TD (approximately 7000') using rotary tools.
4. Run 5-1/2" OD, 14# and 15.5# casing to TD
5. Cement in two stages. First stage: 300 sacks; second stage: (with stage collar 50' below base of Pictured Cliff) 50 sacks.
6. Perforate, stimulate formation, clean up location.

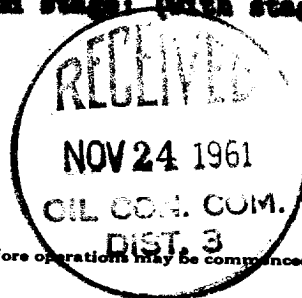

I understand that this plan of work must receive approval in writing by the Geological Survey before operations may be commenced.

Company **Tenneco Oil Company**  
Address **P. O. Box 1714**  
**Durango, Colorado**

By **L. B. Plumb**  
Title **District Production Superintendent**

NUMBER OF COPIES RECEIVED	
DISTRIBUTION	
SANTA FE	
FILE	
U.S.G.S.	
LAND OFFICE	
TRANSPORTER	OIL
	GAS
PRORATION OFFICE	
OPERATOR	

**NEW MEXICO OIL CONSERVATION COMMISSION**  
**WELL LOCATION AND ACREAGE DEDICATION PLAT**  
 SEE INSTRUCTIONS FOR COMPLETING THIS FORM ON THE REVERSE SIDE

FORM C-128  
 Revised 5/1/57

**SECTION A**

Operator <b>TENNECO OIL COMPANY</b>		Lease <b>U.S.A. - T. J. FOSTER</b>		Well No. <b>1</b>
Unit Letter <b>G</b>	Section <b>7</b>	Township <b>25 North</b>	Range <b>7 West</b>	County <b>Rio Arriba</b>

Actual Footage Location of Well:  
**1820** feet from the **North** line and **1830** feet from the **East** line

Ground Level Elev. <b>6498' ungraded</b>	Producing Formation <b>Dakota</b>	Pool <b>Basin Dakota</b>	Dedicated Acreage: <b>320</b> Acres
---	--------------------------------------	-----------------------------	--

1. Is the Operator the only owner in the dedicated acreage outlined on the plat below? YES ☒ NO \_\_\_\_ . ("Owner" means the person who has the right to drill into and to produce from any pool and to appropriate the production either for himself or for himself and another. (65-3-29 (e) NMSA 1935 Comp.)
2. If the answer to question one is "no," have the interests of all the owners been consolidated by communitization agreement or otherwise? YES \_\_\_\_ NO \_\_\_\_ . If answer is "yes," Type of Consolidation \_\_\_\_
3. If the answer to question two is "no," list all the owners and their respective interests below:

Owner	Land Description

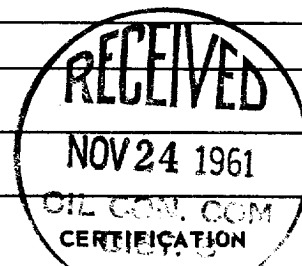

**SECTION B**

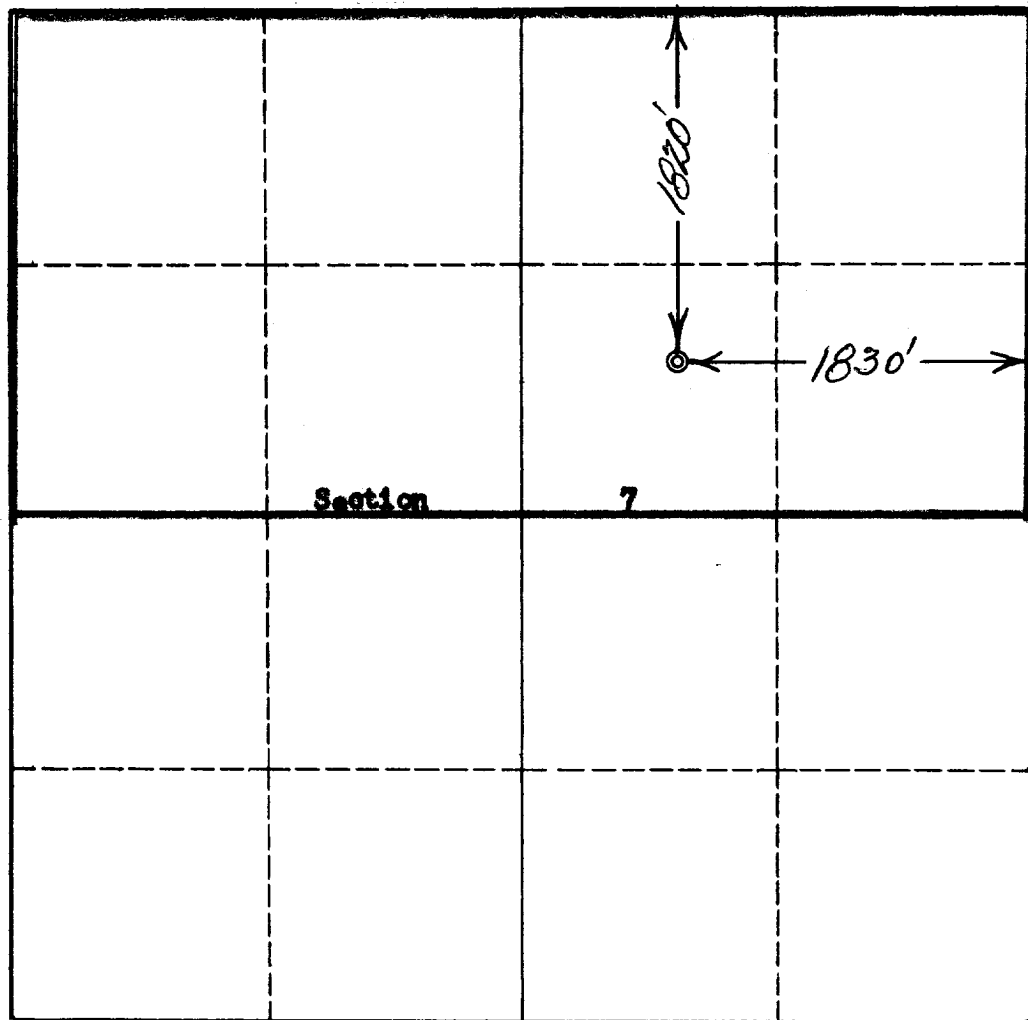

I hereby certify that the information in SECTION A above is true and complete to the best of my knowledge and belief.

Name <b>L. B. Plumb</b>
Position <b>Dist. Production Supt.</b>
Company <b>Tenneco Oil Company</b>
Date <b>November 21, 1961</b>

I hereby certify that the well location shown on the plat in SECTION B was plotted from field notes of actual surveys made by me or under my supervision, and that the same is true and correct to the best of my knowledge and belief.

Date Surveyed <b>16 November 1961</b>
Registered Professional Engineer and/or Land Surveyor <b>Robert H. Ernst</b> <b>San Juan Engineering Co.</b>
Certificate No. <b>PE &amp; LS 2463</b>

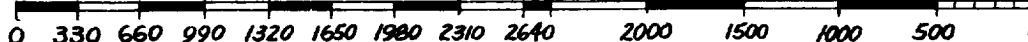

## INSTRUCTIONS FOR COMPLETION OF FORM C-128

1. Operator shall furnish and certify to the information called for in Section A.
2. Operator shall outline the dedicated acreage for *both* oil and gas wells on the plat in Section B.
3. A registered professional engineer or land surveyor registered in the State of New Mexico or approved by the Commission shall show on the plat the location of the well and certify this information in the space provided.
4. All distances shown on the plat must be from the outer boundaries of the Section.
5. If additional space is needed for listing owners and their respective interests as required in question 3 of Section A, please use space below.