

NOV 16 1955

(SUBMIT IN TRIPLICATE)

Land Office Santa Fe  
Lease No. N.M. 011639  
Unit \_\_\_\_\_

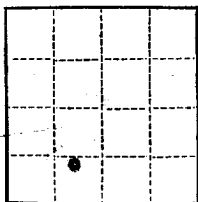

UNITED STATES  
DEPARTMENT OF THE INTERIOR  
GEOLOGICAL SURVEY

SUNDRY NOTICES AND REPORTS ON WELLS

NOTICE OF INTENTION TO DRILL.....	<input checked="" type="checkbox"/>	SUBSEQUENT REPORT OF WATER SHUT-OFF.....	
NOTICE OF INTENTION TO CHANGE PLANS.....		SUBSEQUENT REPORT OF SHOOTING OR ACIDIZING.....	
NOTICE OF INTENTION TO TEST WATER SHUT-OFF.....		SUBSEQUENT REPORT OF ALTERING CASING.....	
NOTICE OF INTENTION TO RE-DRILL OR REPAIR WELL.....		SUBSEQUENT REPORT OF RE-DRILLING OR REPAIR.....	
NOTICE OF INTENTION TO SHOOT OR ACIDIZE.....		SUBSEQUENT REPORT OF ABANDONMENT.....	
NOTICE OF INTENTION TO PULL OR ALTER CASING.....		SUPPLEMENTARY WELL HISTORY.....	
NOTICE OF INTENTION TO ABANDON WELL.....			

(INDICATE ABOVE BY CHECK MARK NATURE OF REPORT, NOTICE, OR OTHER DATA)

November 10, 1955

Well No. 4 is located 790 ft. from N line and 1350 ft. from W line of sec. 5  
SW/4 Sec. 5 25N 7W N.M.P.M.  
(1/4 Sec. and Sec. No.) (Twp.) (Range) (Meridian)  
Canyon Largo Pictured Rio Arriba New Mexico  
(Field) (County or Subdivision) (State or Territory)  
Cliffs

The elevation of the derrick floor above sea level is 6435 ft.

DETAILS OF WORK

(State names of and expected depths to objective sands; show sizes, weights, and lengths of proposed casings; indicate mudding jobs, cementing points, and all other important proposed work)

Set 100 feet 9 5/8" casing with 100 sacks of regular cement, Drill to approximate depth of 2100' with 8 3/4" bit, reduce hole to 4 1/2" and drill to approximate depth of 2215' or approximately 5 feet into the Pictured Cliffs Formation. Hole will be reamed and 5 1/2" - 14# casing will be set approximately 5' in Pictured Cliffs Formation and cemented with 150 sacks of cement. Drill plug and approximately 100' of Pictured Cliffs Formation with cable tools. Sand Oil Frac with approximately 15,000 gallons of oil and 10,000 pounds of sand.

I understand that this plan of work must receive approval in writing by the Geological Survey before operations may be commenced.

Company C.J. Warren  
Address 324 Simms Building  
Albuquerque, N.M.

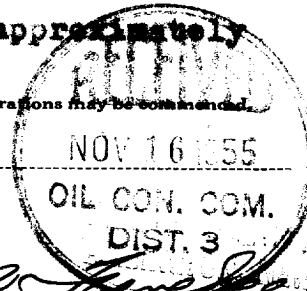

By D.M. Ferebee  
Title Geologist for C.J. Warren



COMPANY C. J. Warren

Well Name & No. \_\_\_\_\_ Lease No. \_\_\_\_\_

Location 790' from the South line and 1850' from the West line.

Being in SE<sup>1</sup>/<sub>4</sub>SW<sup>1</sup>/<sub>4</sub>

Sec. 5, T25N, R7W., N.M.P.M., Rio Arriba County, New Mexico.

Ground Elevation 6430, ungraded.

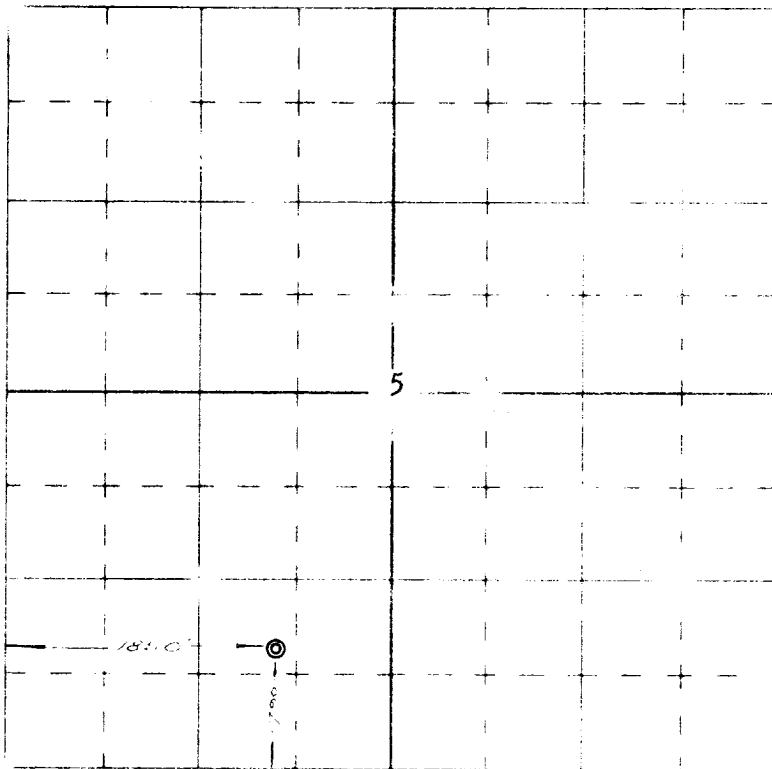

Scale -- 4 inches equals 1 mile

Surveyed May 25, 1955

This is to certify that the above plat was prepared from field notes of actual surveys made by me or under my supervision and that the same are true and correct to the best of my knowledge and belief.

*Ernest V. Echoshawk*

Ernest V. Echoshawk  
Registered Land Surveyor  
N. M. Reg. #1545

Seal:

