

Denny L. Frost
DEPUTY OIL & GAS INSPECTOR

OCT 28 1997

JICARILLA APACHE TRIBE
ENVIRONMENTAL PROTECTION OFFICE

P.O. BOX 507
DULCE, NEW MEXICO 87528

SUBMIT 1 COPY TO
NATURAL
RESOURCE DEPT
AND OIL-GAS
ADMINISTRATION

Approved

PIT REMEDIATION AND CLOSURE REPORT

Operator: PNM Gas Services (Conoco) Telephone: 324-3764

Address: 603 W. Elm Street Farmington, NM 87401

Facility or Well Name: JICARILLA D-9

Location: Unit: N Sec. 31 T. 26 N R. 3 W County Rio Arriba

Pit Type: Separator Dehydrator Other

Land Type: Jicarilla Apache

Pit Location: Pit dimensions: length 55 width 47 depth 7'

(Attach diagram) Reference: wellhead other

Footage from reference: 99'

Direction from reference: Straight Degrees East North

 West of South

Depth to Ground Water: <small>(Vertical distance from contaminants to seasonal high water elevation or ground water)</small>	Less than 50 feet (20 points)	<u>0</u>
	50 feet to 99 feet (10 points)	<u>0</u>
	Greater than 100 feet (0 points)	<u>0</u>
Wellhead Protection Area: <small>(Less than 200 feet from a private domestic water source, or, less than 1,000 feet from all other water sources)</small>	Yes (20 points)	<u>0</u>
	No (0 points)	<u>0</u>
Distance to Surface Water: <small>(Horizontal distance to perennial lakes, ponds, rivers, streams, creeks, irrigation canals and ditches)</small>	Less than 200 feet (20 points)	<u>0</u>
	200 feet to 1,000 feet (10 points)	<u>0</u>
	Greater than 1,000 feet (0 points)	<u>0</u>
Distance to Ephemeral Stream (dry wash): <small>(Horizontal distance to all downgradient streams having a width of at least 10 feet)</small>	Less than or equal to 100 feet (-10 points)	<u>0</u>
	Greater than 100 feet (0 points)	<u>0</u>
Distance to Nearest Lake, Playa, or Watering Pond: <small>(Horizontal distance to all downgradient lakes, playas, and livestock or wildlife water ponds)</small>	Less than or equal to 100 feet (10 points)	<u>0</u>
	Greater than 100 feet (0 points)	<u>0</u>
RANKING SCORE (TOTAL POINTS):		<u>0</u>

RECEIVED
JUL 31 1997
OIL CON. DIV.
DIST. 3

Date Remediation Started: 5/5/97 Date Completed: 6/17/97

Remediation Method: Excavation X Approx. Cubic Yards 670

(Check all appropriate sections) Landfarmed X Amount Landfarmed (cubic yds): 670

Other _____

Remediation Location: Onsite X Offsite _____

(i.e., landfarmed onsite, name and location of offsite facility)

General Description of Remedial Action:
Removed contaminated soil from all four sides walls
As to get a below 100 ppm head space reading.
Bottom of pit was solid sandstone rock.

Ground Water Encountered: No X Yes _____ Depth _____

Final Pit Closure Sampling: Sample Location North, East, South, and West side walls.

(if multiple samples, attach sample result and diagram of sample locations and depths.) Sample depth 6'

Sample date 5/6/97 Sample time 0830

Sample Results

Soil: Benzene (ppm) ND Water: Benzene (ppb) _____

Total BTEX (ppm) 0.0053 Toluene (ppb) _____

Field headspace (ppm) 12.4 Ethylbenzene (ppb) _____

TPH ND ppm Method 8015 Total Xylenes (ppb) _____

Ground Water Sample: Yes _____ No X (If yes, attach sample results)

I HEREBY CERTIFY THAT THE INFORMATION ABOVE IS TRUE AND COMPLETE TO THE BEST OF MY KNOWLEDGE AND MY BELIEF

DATE 5/18/97 PRINTED NAME Ronald A. Dedrick

SIGNATURE Ronald A. Dedrick AND TITLE Environmental Technician II

AFTER REVIEW OF THE PIT CLOSURE INFORMATION, PIT CLOSURE IS APPROVED IN ACCORDANCE TO JICARILLA APACHE TRIBE PIT CLOSURE ORDINANCE.

APPROVED: YES X NO _____ (REASON): _____

SIGNED: [Signature] DATE: 5/19/97

Carilla D-7
ec. 31 T26N R3W 4th N
onoco

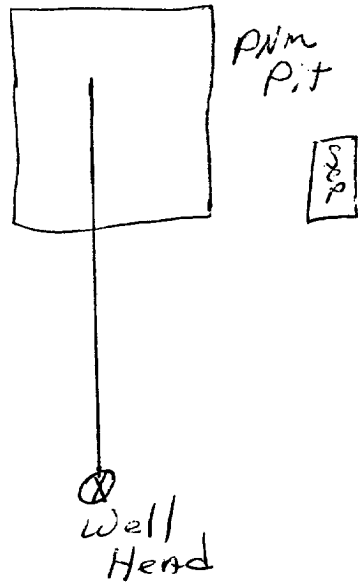

⊠ Meter House

ICARILLA D-7
Sec. 31 T26N R34W Unit N
Monoco

55' x 47' x 7'

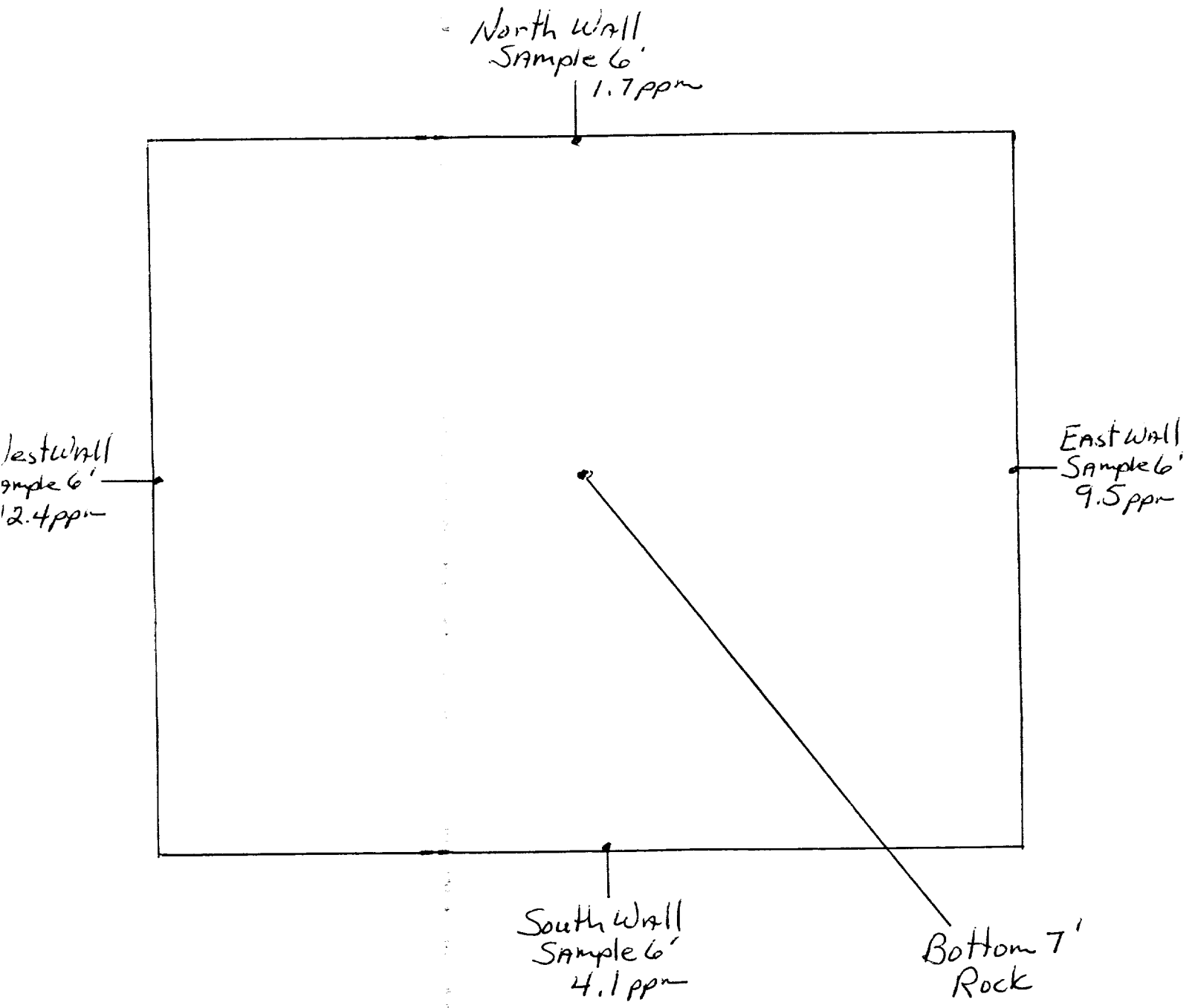

5' Sample - 1200 ppm

OFF: (505) 325-5667



LAB: (505) 325-1556

ANALYTICAL REPORT

Attn: *Denver Bearden*
Company: *PNM Gas Services*
Address: *603 W. Elm*
City, State: *Farmington, NM 87401*

Date: *12-May-97*
COC No.: *5449*
Sample No.: *14442*
Job No.: *2-1000*

Project Name: *PNM Gas Services - Jicarilla D-9 Run 12-71*
Project Location: *9705060830; 4pt. Composite*
Sampled by: *PA* Date: *6-May-97* Time: *8:30*
Analyzed by: *HR/DC* Date: *9-May-97*
Sample Matrix: *Soil*

Laboratory Analysis

Parameter	Results as Received	Unit of Measure	Limit of Quantitation	Unit of Measure
<i>Diesel Range Organics (C10 - C28)</i>	ND	mg/kg	5.0	mg/kg

ND - Not Detected at Limit of Quantitation

Quality Assurance Report

DRO QC No.: *0519-STD*

Continuing Calibration Verification

Parameter	Method Blank	Unit of Measure	True Value	Analyzed Value	RPD	RPD Limit
<i>Diesel Range (C10 - C28)</i>	ND	ppm	100	108	7.7	15%

Matrix Spike

Parameter	1- Percent Recovered	2- Percent Recovered	Limit	RPD	RPD Limit
<i>Diesel Range (C10-C28)</i>	100	99	(70-130)	1	20%

Method - *SW-846 EPA Method 8015A mod. - Nonhalogenated Volatile Hydrocarbons by Gas Chromatography*

Approved by: *[Signature]*
Date: *5/12/97*

OFF: (505) 325-5667



LAB: (505) 325-1556

ANALYTICAL REPORT

Attn: *Denver Bearden*
 Company: *PNM Gas Services*
 Address: *603 W. Elm*
 City, State: *Farmington, NM 87401*

Date: *14-May-97*
 COC No.: *5449*
 Sample No.: *14442*
 Job No.: *2-1000*

Project Name: *PNM Gas Services - Jicarilla D-9 Run 12-71*
 Project Location: *9705060830; 4pt. Composite*
 Sampled by: *PA* Date: *6-May-97* Time: *8:30*
 Analyzed by: *DC* Date: *9-May-97*
 Sample Matrix: *Soil*

Laboratory Analysis

Parameter	Results as Received	Unit of Measure	Limit of Quantitation	Unit of Measure
<i>Benzene</i>	ND	ug/kg	1.0	ug/kg
<i>Toluene</i>	ND	ug/kg	1.0	ug/kg
<i>Ethylbenzene</i>	ND	ug/kg	1.0	ug/kg
<i>m,p-Xylene</i>	3.7	ug/kg	1.0	ug/kg
<i>o-Xylene</i>	1.7	ug/kg	1.0	ug/kg
	<i>TOTAL</i>	5.3		ug/kg

ND - Not Detected at Limit of Quantitation

Method - SW-846 EPA Method 8020A Aromatic Volatile Organics by Gas Chromatography

Approved by: *[Signature]*
 Date: *5/14/97*

JICARILLA APACHE TRIBE
ENVIRONMENTAL
PROTECTION OFFICE
P.O. BOX 507
DULCE, NEW MEXICO 87528

SUBMIT 1 COPY TO
NATURAL
RESOURCE DEPT
AND OIL-GAS
ADMINISTRATION

ON-SITE SOIL REMEDIATION REPORT

Operator: <u>PNM Gas Services (Conoco)</u> Telephone: <u>324-3764</u>	
Address: <u>603 W. Elm Street Farmington, NM 87401</u>	
Facility or Well Name: <u>Jicarilla D-9</u>	
Location: Unit: <u>N</u> Sec. <u>31</u> T. <u>26N</u> R. <u>3</u> W. County <u>Rio Arriba</u>	
Land Type: <u>Jicarilla Apache</u>	
Date Remediation Started: <u>5/5/97</u>	Date Completed: <u>5/22/97</u>
Remediation Method: Landfarmed <input checked="" type="checkbox"/>	Approx. cubic yards <u>670</u>
Composted <input type="checkbox"/>	
Other <input type="checkbox"/>	
Depth to Ground Water: (pts.) <u>0</u>	Final Closure Sampling: Sampling Date: <u>5/15/97</u> Time <u>0756</u> Sampling Results: Field Headspace (ppm) <u>58.5</u> TPH (ppm) <u>35.6</u> Method <u>8015</u> Other _____
Distance to an Ephemeral Stream: (pts.) <u>0</u>	
Distance to Nearest Lake, Playa, or Watering Pond: (pts.) <u>0</u>	
Wellhead Protection Area: (pts.) <u>0</u>	
Distance to Surface Water: (pts.) <u>0</u>	
Ranking Score (Total Points): <u>0</u>	
I HEREBY CERTIFY THAT THE INFORMATION ABOVE IS TRUE AND COMPLETE TO THE BEST OF MY KNOWLEDGE AND BELIEF	
DATE <u>5/22/97</u>	PRINTED NAME <u>Ronald A. Dedrick</u>
SIGNATURE <u>Ronald A. Dedrick</u>	AND TITLE <u>Environmental Technician II</u>
AFTER REVIEW OF THE SOIL REMEDIATION INFORMATION, ON-SITE REMEDIATION APPROVED IN ACCORDANCE TO THE JICARILLA APACHE TRIBE PIT CLOSURE ORDINANCE	
APPROVED: YES <input checked="" type="checkbox"/> NO <input type="checkbox"/> (REASON) _____	
SIGNED: <u>Kate C. Mammill</u>	DATE: <u>5-29-97</u>

ICARUUA D-7
ec. 31 T26N R3W Unit N
07000

Land farm

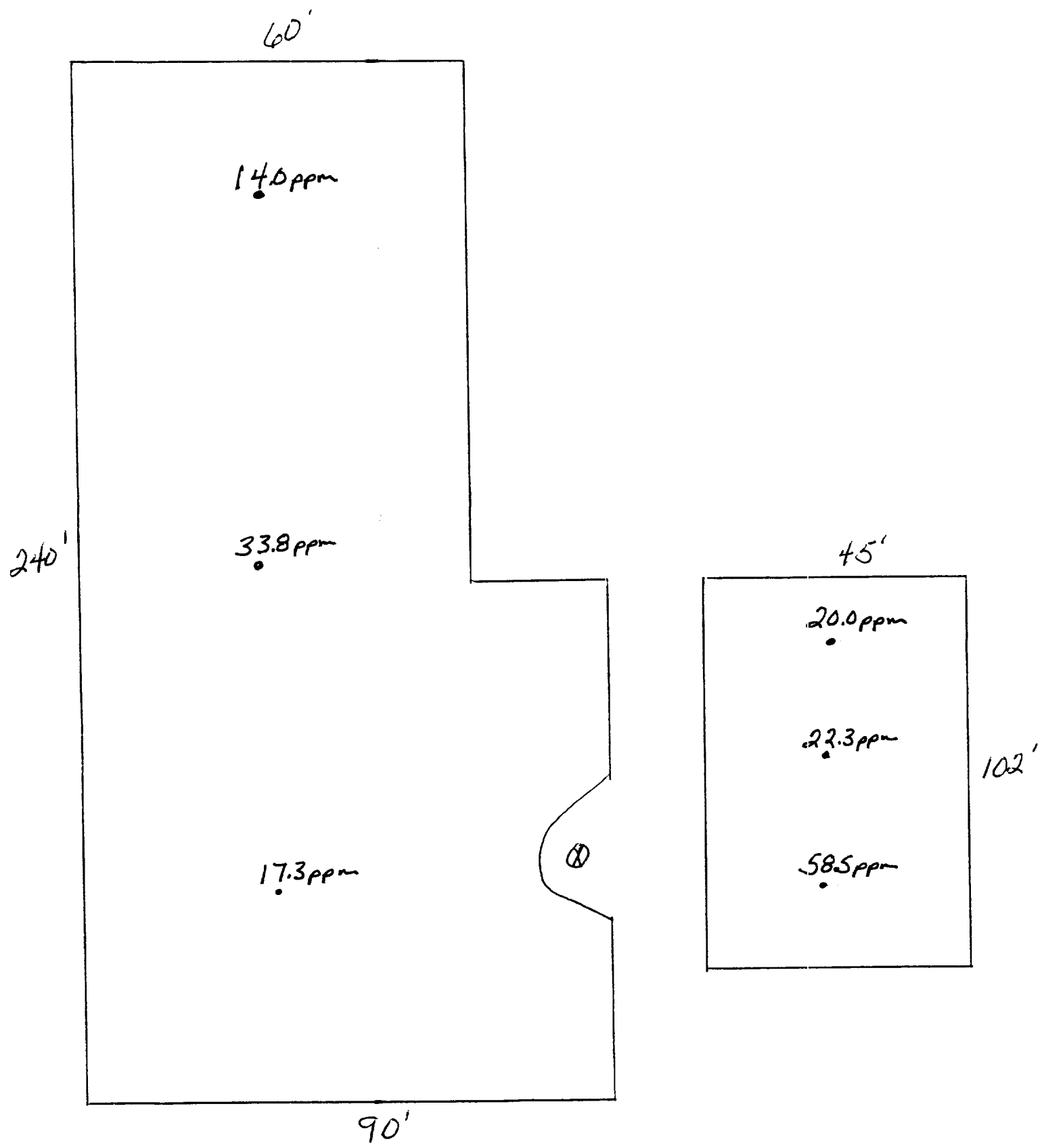

OFF: (505) 325-5667



LAB: (505) 325-1556

ANALYTICAL REPORT

Attn: *Denver Bearden*
 Company: *PNM Gas Services*
 Address: *603 W. Elm*
 City, State: *Farmington, NM 87401*

Date: *22-May-97*
 COC No.: *5465*
 Sample No.: *14636*
 Job No.: *2-1000*

Project Name: *PNM Gas Services - Jicarilla D-9 Landfarm Run 12-71*
 Project Location: *9705150756; 6pt. Composite*
 Sampled by: *RB* Date: *15-May-97* Time: *7:56*
 Analyzed by: *HR/DC* Date: *16-May-97*
 Sample Matrix: *Soil*

Laboratory Analysis

Parameter	Results as Received	Unit of Measure	Limit of Quantitation	Unit of Measure
<i>Diesel Range Organics (C10 - C28)</i>	<i>35.6</i>	<i>mg/kg</i>	<i>5.0</i>	<i>mg/kg</i>

ND - Not Detected at Limit of Quantitation

Quality Assurance Report

DRO QC No.: *0519-STD*

Continuing Calibration Verification

Parameter	Method Blank	Unit of Measure	True Value	Analyzed Value	RPD	RPD Limit
<i>Diesel Range (C10 - C28)</i>	<i>ND</i>	<i>ppm</i>	<i>100</i>	<i>104</i>	<i>4.2</i>	<i>15%</i>

Matrix Spike

Parameter	1 - Percent Recovered	2 - Percent Recovered	Limit	RPD	RPD Limit
<i>Diesel Range (C10-C28)</i>	<i>96</i>	<i>88</i>	<i>(70-130)</i>	<i>9</i>	<i>20%</i>

Method - *SW-846 EPA Method 8015A mod. - Nonhalogenated Volatile Hydrocarbons by Gas Chromatography*

Approved by: *[Signature]*
 Date: *5/22/97*