

NEW MEXICO
OIL CONSERVATION COMMISSION

Form C-128

WELL LOCATION AND/OR GAS PRORATION PLAT

DATE April 15, 1957

OPERATOR THE OHIO OIL COMPANY LEASE JIGARILLA

WELL NO. 2 SECTION 33 TOWNSHIP 26 NORTH RANGE 5 WEST NMPM

LOCATED 990 FEET FROM the SOUTH LINE 1150 FEET FROM the EAST LINE

RIO ARRIBA COUNTY, NEW MEXICO G.L. ELEVATION 6586.5 UNGRADED.

NAME OF PRODUCING FORMATION Pictured Cliffs POOL So. Blanco DEDICATED ACREAGE 160.00

Note: All distances must be from outer boundaries of section.

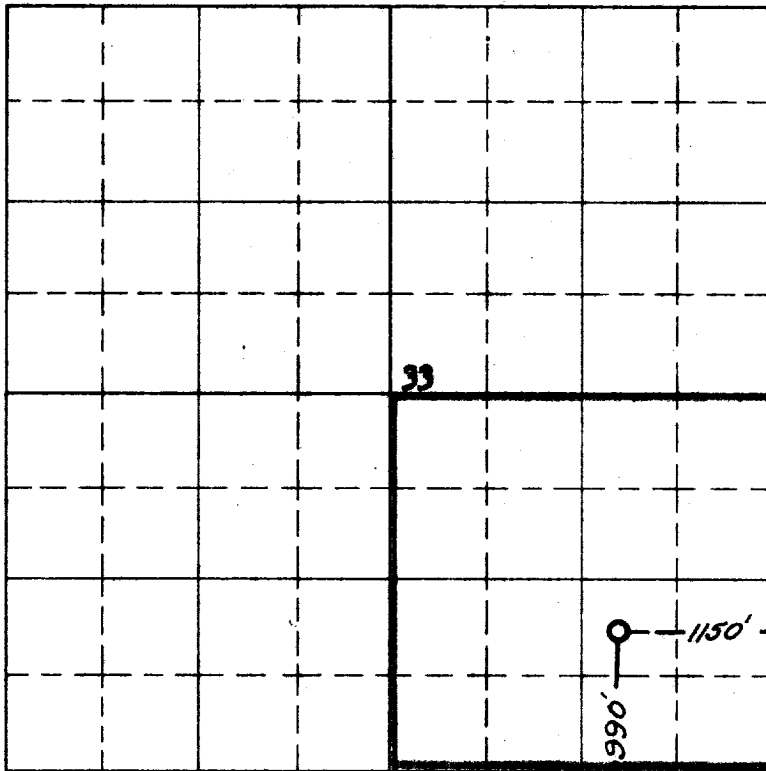

N
|
|
|
|
|
|
|
|
|
|

NOTE
This section of form is to be used for gas wells only

Scale 4 inches equal 1 mile

This is to certify that the above plat was prepared from field notes of actual surveys made by me or under my supervision and that the same are true and correct to the best of my knowledge and belief.

Date Surveyed 8 SEPTEMBER 1957

James P. Lease
Registered Professional Engineer and/or Land Surveyor
JAMES P. LEASE
N. MEX. ENG. NO. 1000

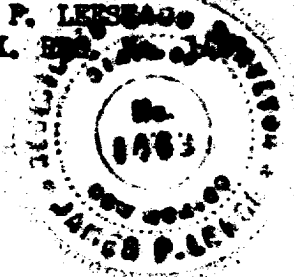

(Seal)

Remington, New Mexico

1. Is this well a Dual Comp.
Yes _____ No X
2. If the answer to Question 1 is yes, are there any other dually completed wells within the dedicated acreage.
Yes _____ No _____

Name M. J. Boyce
Position Division Production Supt.
Representing The Ohio Oil Company
Address Box 120, Casper, Wyoming

OIL CONSERVATION COMMISSION

AZTEC DISTRICT OFFICE

No. Copies Received **2**

DISTRIBUTION

	NO. FURNISHED	
Operator		
Santa Fe	/	
Proration Office		
State Land Office		
U. S. G. S.		
Transporter		
File	/	✓