

*Denny E. Faust*  
DEPUTY OIL & GAS INSPECTOR

JICARILLA APACHE TRIBE

SUBMIT ONE COPY  
TO NATURAL  
RESOURCE DEPT  
AND OIL- GAS  
ADMINISTRATION

FEB 08 1998

ENVIRONMENTAL PROTECTION OFFICE

P.O. BOX 507  
DULCE, NEW MEXICO 87528

*Approved*

**PIT REMEDIATION AND CLOSURE REPORT**

Operator: PNM Gas Services ( CONOCO ) Telephone: 324-3764  
Address: 603 W. Elm Street Farmington, NM 87401  
Facility or Well Name: Jicarilla B3  
Location: Unit K Sec 35 T 26 N R 4 W County Rio Arriba  
Pit Type: Separator ☐ Dehydrator ☐ Other Manual drip blowdown <sup>12 RAD</sup>  
Land Type: Jicarilla Apache

Pit Location: Pit dimensions: Length 20 ' Width 20 ' Depth 3 '  
(Attach diagram) Reference: Wellhead ☒ Other \_\_\_\_\_  
Footage from reference: 74'  
Direction from reference: 12 degrees ☒ East or ☐ North  
☐ West ☒ South

**Depth to Ground Water:**

(Vertical distance from contaminants to seasonal  
high water elevation of ground water)

Less than 50 feet (20 points)  
50 feet to 99 feet (10 points)  
Greater than 100 feet (0 points) 0

**Wellhead Protection Area:**

(Less than 200 feet from a private domestic water source,  
or, less than 1,000 feet from all other water sources)

Yes (20 points)  
No (0 points) 0

**Distance to Surface Water:**

(Horizontal distance to perennial lakes, ponds, rivers,  
streams, creeks, irrigation canals and ditches)

Less than 200 feet (20 points)  
200 feet to 1,000 feet (10 points)  
Greater than 100 feet (0 points) 0

**Distance to Ephemeral Stream (dry wash):**

(Horizontal distance to all downgradient streams having a width  
of at least 10 feet)

Less than or equal to 100 feet (10 points)  
Greater than 100 feet (0 points) 0

**Distance to Nearest Lake, Playa, or Watering  
Pond:**

(Horizontal distance to all downgradient lakes, playas,  
and livestock or wildlife water ponds)

Less than or equal to 100 feet (10 points)  
Greater than 100 feet (0 points) 0

**RANKING SCORE (TOTAL POINTS):** 0

Date Remediation Started: 11/2/98 Date Completed: 12/15/98

Remediation Method: Excavation ☒ Approx. Cubic Yards 231

(Check all appropriate sections) Landfarmed ☒ Amount Landfarmed (cubic yds) 231

Other \_\_\_\_\_

Remediation Location: Onsite ☒ Offsite \_\_\_\_\_

(i.e., landfarmed onsite, name and location of offsite facility)

**General Description of Remedial Action:**

Removal of contaminated soil from all four sidewalls, as to get a below 100 ppm head space reading.  
Bottom is rock.

Final excavation dimensions: 25'(N&S)X25'(E&W)X10'(D)

Ground Water Encountered: No ☒ Yes ☐ Depth \_\_\_\_\_

Final Pit Closure Sampling: Sample Location Composite of North, East, South, and West sidewalls and a three point composite of rock bottom.

(If multiple samples, attach sample result and diagram of sample locations and depths.)

Sample depth 8' 10'

Sample date 11/2/98 Sample time 1435 1430

**Sample Results**

Soil: Benzene (ppm) ND

Water: Benzene (ppb) \_\_\_\_\_

Total BTEX (ppm) 0.003

Toluene (ppb) \_\_\_\_\_

Field headspace (ppm) 130

Ethylbenzene (ppb) \_\_\_\_\_

TPH (ppm) ND Method 8015

Total Xylenes (ppb) \_\_\_\_\_

Vertical Extent (ft) 4' M4

Risk Analysis form attached: Yes ☐ No ☒

Ground Water Sample: Yes ☐ No ☒ (If yes, see attached Groundwater Site Summary Report)

I HEREBY CERTIFY THAT THE INFORMATION ABOVE IS TRUE AND COMPLETE TO THE BEST OF MY KNOWLEDGE AND MY BELIEF.

DATE: 11-20-98

PRINTED NAME Ray Haston

SIGNATURE Ray Haston

TITLE Environmental Tech. III

AFTER REVIEW OF THE PIT CLOSURE INFORMATION, PIT CLOSURE IS APPROVED IN ACCORDANCE TO JICARILLA APACHE TRIBE PIT CLOSURE ORDINANCE:

APPROVED: YES X NO \_\_\_\_\_ (REASON): \_\_\_\_\_

SIGNATURE K. C. M...

DATE: 11-30-98

Jicarilla B3  
 (K) 35-26N-4W  
 CONOCO  
 11-2-48

↑  
 N

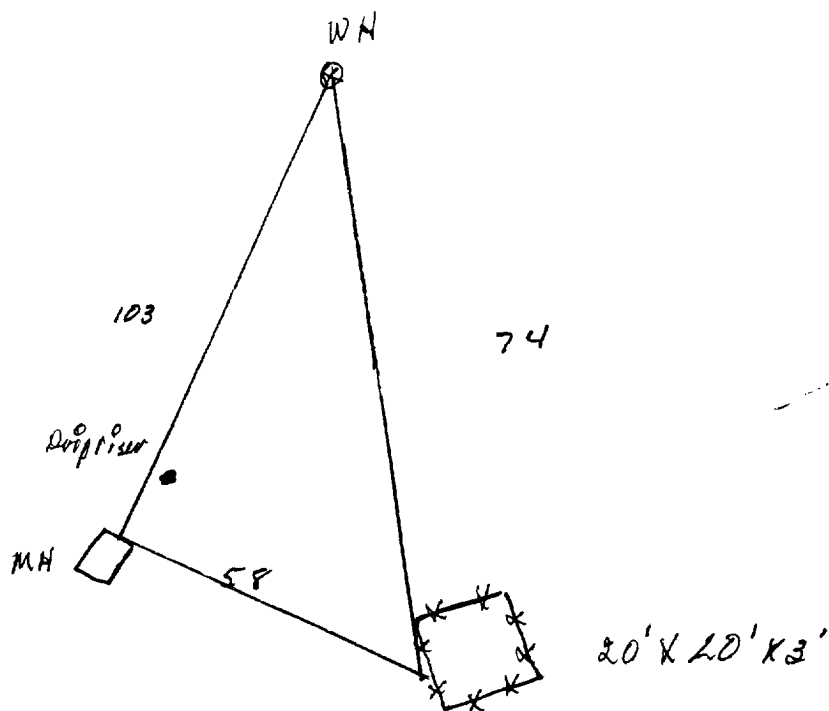

Excavation Sampling

25'(N+S) X 25'(E+W) X 10'(D)

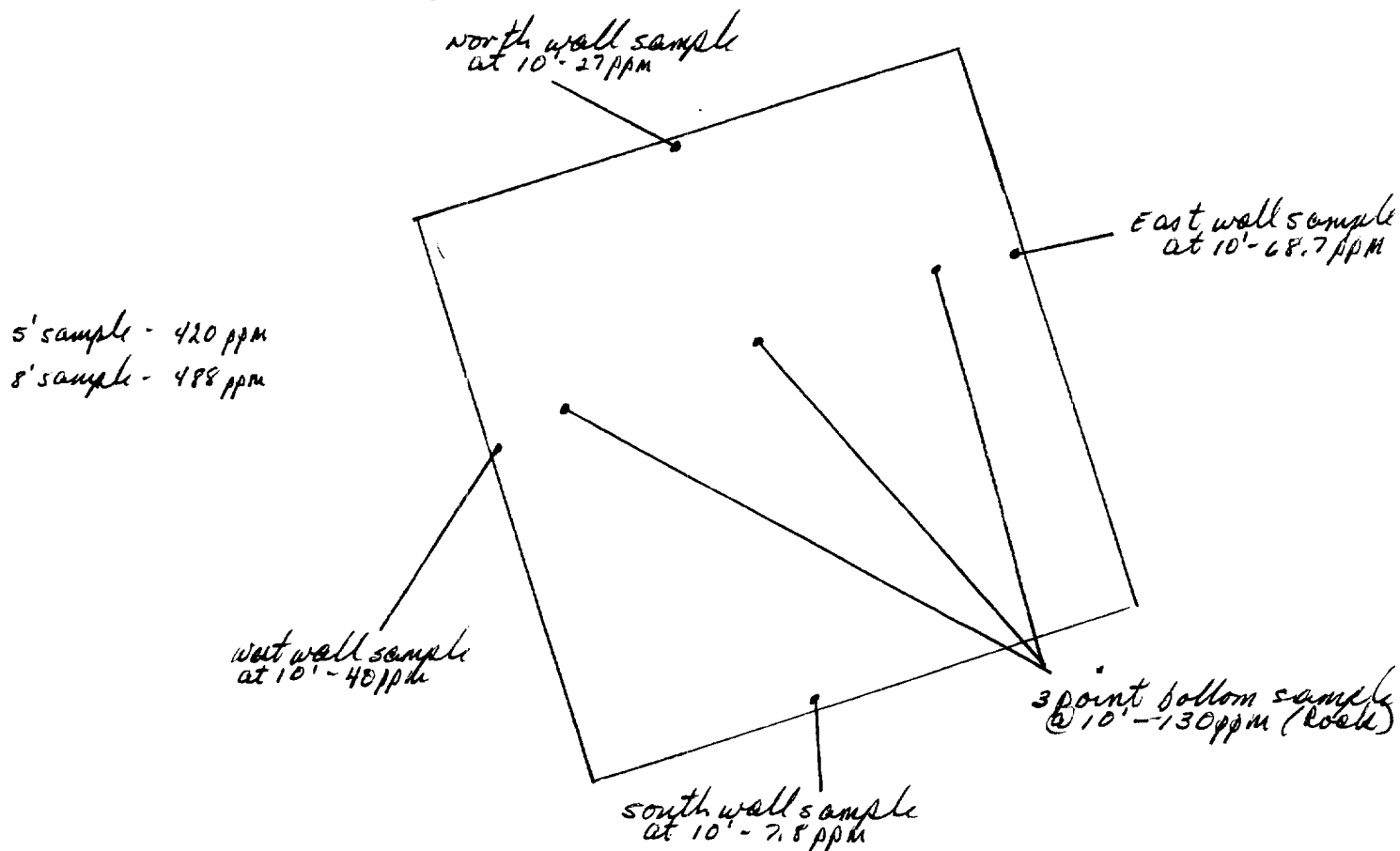

not to scale

OFF: (505) 325-5667



LAB: (505) 325-1556

**On Site Technologies, LTD.**

**Date:** 16-Nov-98

---

**CLIENT:** PNM - Public Service Company of NM  
**Project:** Jicarilla B3  
**Lab Order:** 9811019

---

## **CASE NARRATIVE**

Samples were analyzed using the methods outlined in the following references:

Test Methods for Evaluating Solid Waste, Physical/Chemical Methods, SW846, 3rd Edition

All method blanks, laboratory spikes, and/or matrix spikes met quality assurance objectives.

OFF: (505) 325-5667



LAB: (505) 325-1556

**ANALYTICAL REPORT****Date:** 16-Nov-98

<b>Client:</b>	PNM - Public Service Company of NM	<b>Client Sample Info:</b>	Jicarilla B3
<b>Work Order:</b>	9811019	<b>Client Sample ID:</b>	9811021430; 3pt Bottom Comp
<b>Lab ID:</b>	9811019-01A	<b>Matrix:</b>	SOIL
<b>Project:</b>	Jicarilla B3	<b>Collection Date:</b>	11/3/98 2:30:00 PM
		<b>COC Record:</b>	5771

Parameter	Result	PQL	Qual	Units	DF	Date Analyzed
<b>DIESEL RANGE ORGANICS</b>		<b>SW8015</b>				<b>Analyst: DC</b>
T/R Hydrocarbons: C10-C28	ND	25		mg/Kg	1	11/15/98
<b>BTEX</b>		<b>SW8020A</b>				<b>Analyst: HR</b>
Benzene	ND	1		µg/Kg	1	11/10/98
Toluene	ND	2		µg/Kg	1	11/10/98
Ethylbenzene	1.1	1		µg/Kg	1	11/10/98
m,p-Xylene	2	2		µg/Kg	1	11/10/98
o-Xylene	ND	1		µg/Kg	1	11/10/98

.0031 ppm

**Qualifiers:**

PQL - Practical Quantitation Limit

ND - Not Detected at Practical Quantitation Limit

J - Analyte detected below Practical Quantitation Limit

B - Analyte detected in the associated Method Blank

S - Spike Recovery outside accepted recovery limits

R - RPD outside accepted recovery limits

E - Value above quantitation range

Surr: - Surrogate

1 of 1

P.O. BOX 2606 • FARMINGTON, NM 87499

- TECHNOLOGY BLENDING INDUSTRY WITH THE ENVIRONMENT -

OFF: (505) 325-5667



LAB: (505) 325-1556

## ANALYTICAL REPORT

Date: 16-Nov-98

**Client:** PNM - Public Service Company of NM  
**Work Order:** 9811019  
**Lab ID:** 9811019-02A      **Matrix:** SOIL  
**Project:** Jicarilla B3

**Client Sample Info:** Jicarilla B3  
**Client Sample ID:** 9811021435; 4pt. Wall Comp  
**Collection Date:** 11/2/98 2:35:00 PM  
**COC Record:** 5771

Parameter	Result	PQL	Qual	Units	DF	Date Analyzed
<b>DIESEL RANGE ORGANICS</b>		<b>SW8015</b>				<b>Analyst: HR</b>
T/R Hydrocarbons: C10-C28	ND	25		mg/Kg	1	11/14/98

**Qualifiers:**  
PQL - Practical Quantitation Limit  
ND - Not Detected at Practical Quantitation Limit  
J - Analyte detected below Practical Quantitation Limit  
B - Analyte detected in the associated Method Blank

S - Spike Recovery outside accepted recovery limits  
R - RPD outside accepted recovery limits  
E - Value above quantitation range  
Surr: - Surrogate

1 of 1

P.O. BOX 2606 • FARMINGTON, NM 87499

- TECHNOLOGY BLENDING INDUSTRY WITH THE ENVIRONMENT -

SUBMIT ONE COPY TO  
NATURAL  
RESOURCE DEPT  
AND OIL- GAS  
ADMINISTRATION

Operator: <u>PNM Gas Services ( CONOCO )</u>		Telephone: <u>324-3764</u>
Address: <u>603 W. Elm Street Farmington, NM 87401</u>		
Facility or Well Name: <u>Jicarilla B3 Landfarm</u>		
Location:	Unit <u>K</u> Sec <u>35</u> T <u>26 N</u> R <u>4 W</u>	County <u>Rio Arriba</u>
Land Type: <u>Jicarilla Apache</u>		
Date Remediation Started: <u>11/2/98</u>		Date Completed: <u>12/9/98</u>
Remediation Method:	Landfarmed <input checked="" type="checkbox"/> Approx. cubic yards <u>231</u>	
	Composted <input type="checkbox"/>	
	Other _____	
Depth to Ground Water: (pts.) <u>0</u>		<b>Final Closure Sampling:</b> Sampling Date: <u>12/1/98</u> Time <u>1429</u>  <b>Sampling Results:</b> Field Headspace (ppm) <u>6.3</u> TPH (ppm) <u>ND</u> Method <u>8015</u> Other _____
Distance to an Ephemeral Stream: (pts.) <u>0</u>		
Distance to Nearest Lake, Playa, or Watering Pond: (pts.) <u>0</u>		
Wellhead Protection Area: (pts.) <u>0</u>		
Distance to Surface Water: (pts.) <u>0</u>		
Ranking Score (Total Points): <u>0</u>		
I HEREBY CERTIFY THAT THE INFORMATION ABOVE IS TRUE AND COMPLETE TO THE BEST OF MY KNOWLEDGE AND MY BELIEF.		
DATE: <u>12-10-98</u>		PRINTED NAME <u>Ray Haston</u>
SIGNATURE <u>Ray Haston</u>		TITLE <u>Environmental Tech. III</u>
AFTER REVIEW OF THE SOIL REMEDIATION INFORMATION, ON-SITE REMEDIATION IS APPROVED IN ACCORDANCE TO THE JICARILLA APACHE TRIBE PIT CLOSURE ORDINANCE:		
APPROVED: YES <input checked="" type="checkbox"/> NO <input type="checkbox"/> (REASON): <u>use as Backfill</u>		
SIGNATURE: <u>Kee C. Munnell</u>		DATE: <u>12-15-98</u>

Jicarilla B3 Level Farm

(K) 35-26N-4W

CONOCO

231 yds.

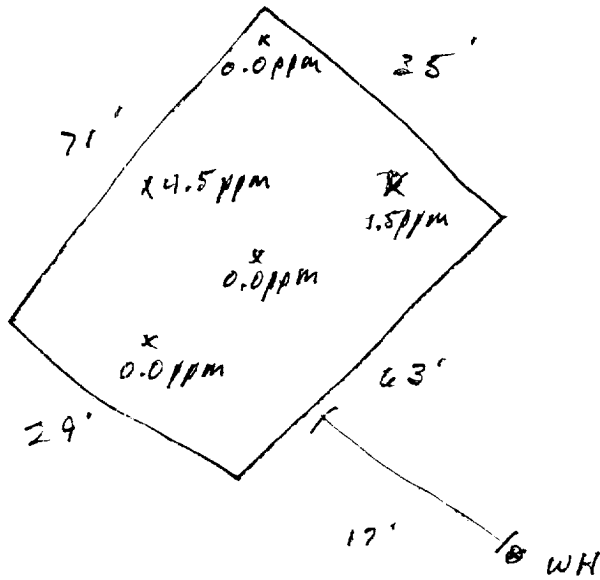

2" - 12"  
Head Space: 6.3 ppm

not to scale

OFF: (505) 325-5667



LAB: (505) 325-1556

**On Site Technologies, LTD.**

**Date:** 10-Dec-98

---

**CLIENT:** PNM - Public Service Company of NM

**Project:** Jicarilla Pit Remediation

**Lab Order:** 9812004

## **CASE NARRATIVE**

---

Samples were analyzed using the methods outlined in the following references:

Test Methods for Evaluating Solid Waste, Physical/Chemical Methods, SW846, 3rd Edition

All method blanks, laboratory spikes, and/or matrix spikes met quality assurance objectives.

OFF: (505) 325-5667



LAB: (505) 325-1556

## ANALYTICAL REPORT

Date: 10-Dec-98

<b>Client:</b>	PNM - Public Service Company of NM	<b>Client Sample Info:</b>	Jicarilla B-3 LF
<b>Work Order:</b>	9812004	<b>Client Sample ID:</b>	9812011429; 6pt Composite
<b>Lab ID:</b>	9812004-06A	<b>Matrix:</b>	SOIL
<b>Project:</b>	Jicarilla Pit Remediation	<b>Collection Date:</b>	12/1/98 2:29:00 PM
		<b>COC Record:</b>	7446

Parameter	Result	PQL	Qual	Units	DF	Date Analyzed
<b>DIESEL RANGE ORGANICS</b>		<b>SW8015</b>				Analyst: HR
T/R Hydrocarbons: C10-C28	ND	25		mg/Kg	1	12/9/98

<b>Qualifiers:</b>	PQL - Practical Quantitation Limit	S - Spike Recovery outside accepted recovery limits
	ND - Not Detected at Practical Quantitation Limit	R - RPD outside accepted recovery limits
	J - Analyte detected below Practical Quantitation Limit	E - Value above quantitation range
	B - Analyte detected in the associated Method Blank	Surr: - Surrogate

P.O. BOX 2606 • FARMINGTON, NM 87499

1 of 1

- TECHNOLOGY BLENDING INDUSTRY WITH THE ENVIRONMENT -