

Form 9-331b
(April 1952)

(SUBMIT IN TRIPLICATE)

UNITED STATES
DEPARTMENT OF THE INTERIOR
GEOLOGICAL SURVEY

Indian Agency

Jicarilla Tribal

Allottee

Jicarilla Tribal
Lease No. Contract 155

SUNDRY NOTICES AND REPORTS ON WELLS

NOTICE OF INTENTION TO DRILL	<input checked="" type="checkbox"/>	SUBSEQUENT REPORT OF WATER SHUT-OFF	
NOTICE OF INTENTION TO CHANGE PLANS		SUBSEQUENT REPORT OF SHOOTING OR ACIDIZING	
NOTICE OF INTENTION TO TEST WATER SHUT-OFF		SUBSEQUENT REPORT OF ALTERING CASING	
NOTICE OF INTENTION TO REDRILL OR REPAIR WELL		SUBSEQUENT REPORT OF REDRILLING OR REPAIR	
NOTICE OF INTENTION TO SHOOT OR ACIDIZE		SUBSEQUENT REPORT OF ABANDONMENT	
NOTICE OF INTENTION TO PULL OR ALTER CASING		SUPPLEMENTARY WELL HISTORY	
NOTICE OF INTENTION TO ABANDON WELL			

(INDICATE ABOVE BY CHECK MARK NATURE OF REPORT, NOTICE, OR OTHER DATA)

Jicarilla Contract 155

Farmington, New Mexico December 10, 1962

Well No. 18 is located 1140 ft. from $\begin{matrix} N \\ S \end{matrix}$ line and 1140 ft. from $\begin{matrix} E \\ W \end{matrix}$ line of sec. 31

SE/4, SE/4 Section 31
(1/4 Sec. and Sec. No.)

T-26-N
(Twp.)

R-5-W
(Range)

N.M.P.M.
(Meridian)

Ogawa Chama
(Field)

Rio Arriba
(County or Subdivision)

New Mexico
(State or Territory)

The elevation of the derrick floor above sea level is _____ ft. (To report later)

DETAILS OF WORK

(State names of and expected depths to objective sands; show sizes, weights, and lengths of proposed casings; indicate mudding jobs, cementing points, and all other important proposed work)

We propose to drill Jicarilla Contract 155 No. 18 to approximately 3900' with rotary tools to evaluate Ogawa formation. Stimulation and completion will be selected at total depth. The following casing program is proposed:

Size	Depth	Cement	Remarks
8-5/8"	200'	135 sacks	Incor Neat - circulate to surface
4-1/2"	3900'	300 sacks	Incor 4% gel (with 1-1/2 lbs. Tuf Plug per sack) and neat - to fill 500' above top of Pictured Cliffs

A copy of any survey will be submitted upon completion of well. Copies of location detailed on attached New Mexico Oil Conservation Commission Form C-128.

I understand that this plan of work must receive approval in writing by the Geological Survey before operations may be commenced.

Company Pan American Petroleum Corporation

Address Box 480

Farmington, New Mexico

Attn: L. O. Spear, Jr.

By

Title Petroleum Engineer

RECEIVED
ORIGINAL SIGNATURE
F. H. HOLLISSWORTH
DEC 13 1962
OIL CON. COM.
DIST. 3

NUMBER OF COPIES RECEIVED	
DISTRIBUTION	
SANTA FE	
FILE	
U.S.S.	
LAND OFFICE	
TRANSPORTER	OIL
	GAS
PRODUCTION OFFICE	
OPERATOR	

NEW MEXICO OIL CONSERVATION COMMISSION
WELL LOCATION AND ACREAGE DEDICATION PLAT
 SEE INSTRUCTIONS FOR COMPLETING THIS FORM ON THE REVERSE SIDE

FORM C-128
 Revised 5/1/57

SECTION A

Operator Pan American Petroleum Corporation			Lease Jicarilla Contract 155		Well No. 18
Unit Letter P	Section 31	Township T-26-N	Range R-5-W	County Rio Arriba	
Actual Footage Location of Well: 1140 feet from the South line and 1140 feet from the East line					
Ground Level Elev. To report later	Producing Formation Chacra		Pool Otero Chacra		Dedicated Acreage: 160 Acres

1. Is the Operator the only owner in the dedicated acreage outlined on the plat below? YES ☒ NO ____ . ("Owner" means the person who has the right to drill into and to produce from any pool and to appropriate the production either for himself or for himself and another. (65-3-29 (e) NMSA 1935 Comp.)
2. If the answer to question one is "no," have the interests of all the owners been consolidated by communication agreement or otherwise? YES ____ NO ____ . If answer is "yes," Type of Consolidation ____
3. If the answer to question two is "no," list all the owners and their respective interests below:

Owner	Land Description

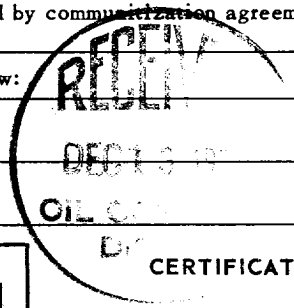

SECTION B

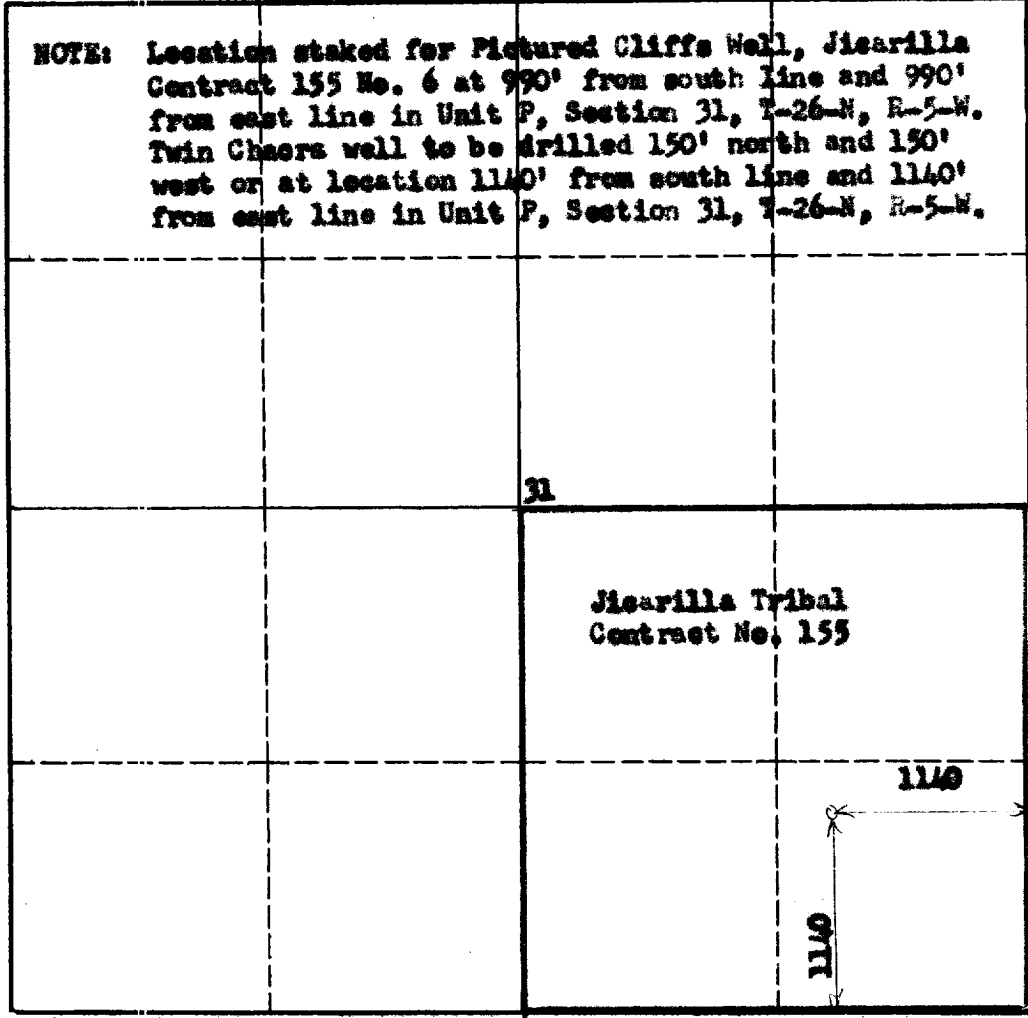

CERTIFICATION

I hereby certify that the information in SECTION A above is true and complete to the best of my knowledge and belief. *F. H. Hollingsworth*
F. H. Hollingsworth
 Name
Petroleum Engineer
 Position
Pan American Petr. Corp.
 Company
December 10, 1962
 Date

I hereby certify that the well location shown on the plat in SECTION B was plotted from field notes of actual surveys made by me or under my supervision, and that the same is true and correct to the best of my knowledge and belief. **Location for Jicarilla Contract 155 No. 6**

Date Surveyed
October 20, 1955
 Registered Professional Engineer and/or Land Surveyor
original /s/ Ernest V. Echobawk
 Certificate No.
1545

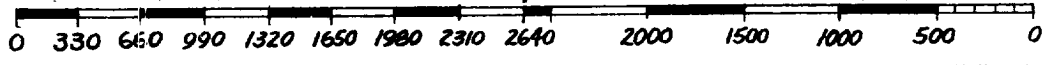

INSTRUCTIONS FOR COMPLETION OF FORM C-128

1. Operator shall furnish and certify to the information called for in Section A.
2. Operator shall outline the dedicated acreage for *both* oil and gas wells on the plat in Section B.
3. A registered professional engineer or land surveyor registered in the State of New Mexico or approved by the Commission shall show on the plat the location of the well and certify this information in the space provided.
4. All distances shown on the plat must be from the outer boundaries of the Section.
5. If additional space is needed for listing owners and their respective interests as required in question 3 of Section A, please use space below.