

(SUBMIT IN TRIPLICATE)

Indian Agency _____

Hearville

Allottee Contract #120

Lease No. _____

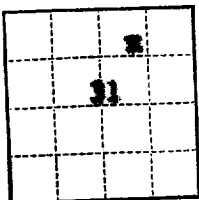
UNITED STATES
DEPARTMENT OF THE INTERIOR
GEOLOGICAL SURVEY

SUNDRY NOTICES AND REPORTS ON WELLS

NOTICE OF INTENTION TO DRILL	<input checked="" type="checkbox"/>	SUBSEQUENT REPORT OF WATER SHUT-OFF	
NOTICE OF INTENTION TO CHANGE PLANS		SUBSEQUENT REPORT OF SHOOTING OR ACIDIZING	
NOTICE OF INTENTION TO TEST WATER SHUT-OFF		SUBSEQUENT REPORT OF ALTERING CASING	
NOTICE OF INTENTION TO REDRILL OR REPAIR WELL		SUBSEQUENT REPORT OF REDRILLING OR REPAIR	
NOTICE OF INTENTION TO SHOOT OR ACIDIZE		SUBSEQUENT REPORT OF ABANDONMENT	
NOTICE OF INTENTION TO PULL OR ALTER CASING		SUPPLEMENTARY WELL HISTORY	
NOTICE OF INTENTION TO ABANDON WELL			

(INDICATE ABOVE BY CHECK MARK NATURE OF REPORT, NOTICE, OR OTHER DATA)

July 23, 19 57

Well No. "C" 10-31 is located 990 ft. from [N] line and 1440 ft. from [E] line of sec. 31

NE/4 NW/4 31
(1/4 Sec. and Sec. No.)26N
(Twp.)4W
(Range)MSPM
(Meridian)Wildcat (PC)
(Field)

Rio Arriba

(County or Subdivision)

New Mexico
(State or Territory)The elevation of the ~~surface~~ ^{water level} above sea level is 6707 ft.

DETAILS OF WORK

(State names of and expected depths to objective sands; show sizes, weights, and lengths of proposed casings; indicate mudding jobs, cementing points, and all other important proposed work)

Propose to drill 9-7/8" hole to 130', set 7-3/8" CB casing and cement to surface w/75 cu yd. Drill 6-3/4" hole to total depth of 3165', set 9" CB casing and cement w/100 cu yd. Perforate 9" casing from 3110-3174 and fracture the Pictured Cliffs w/40,000 gals water & 40,000 sand. Use 1 1/2" CB tubing and run well in. The NE/4 of Section 31, containing 160 acres, is dedicated to the well.

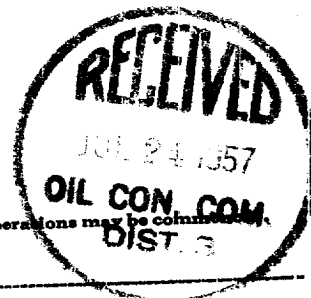

I understand that this plan of work must receive approval in writing by the Geological Survey before operations may be commenced.

Company _____

NORTHWEST PRODUCTION CORPORATION

Address _____

520 Simms Building
Albuquerque, New MexicoBy RAY PHILLIPS
Ray Phillips

Title Asst. Mgr., Prod. Gp.

NEW MEXICO OIL CONSERVATION COMMISSION
Well Location and Acreage Dedication Plat

Section A.

Date July 22, 1957

Operator Northwest Production Company Lease "C"
Well No. 10-31 Unit Letter Section 31 Township 26 N Range 4 W NMPM
Located 990 Feet From north Line, 1460 Feet From east Line
County Rio Arriba G. L. Elevation 6707 Dedicated Acreage Acres
Name of Producing Formation Pool

1. Is the Operator the only owner* in the dedicated acreage outlined on this plat below?
Yes X No .
2. If the answer to question one is "no," have the interests of adjacent owners been consolidated by communitization agreement or otherwise? Yes . If answer is "yes," Type of Consolidation .
3. If the answer to question two is "no," list all the owners and their respective interests below:

Owner

Land Description

Section B

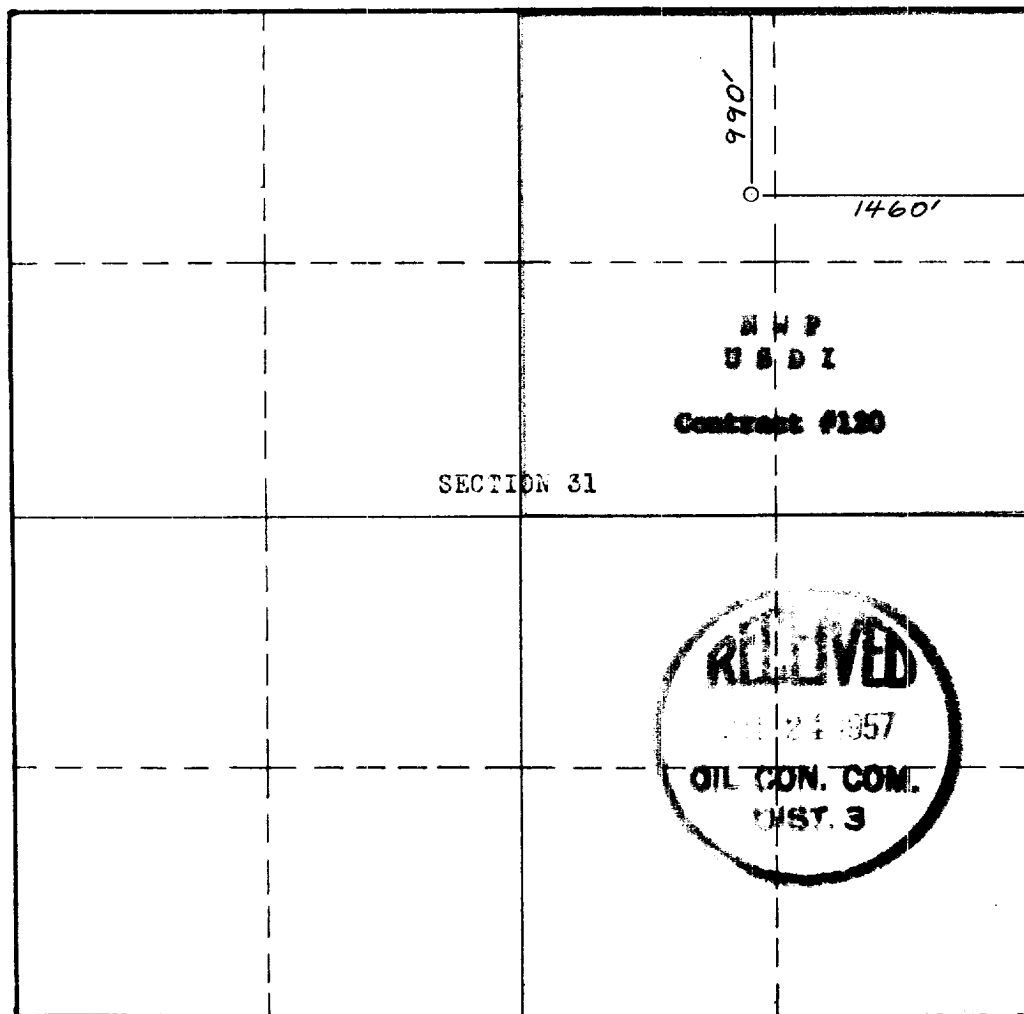

This is to certify that the information in Section A above is true and complete to the best of my knowledge and belief.

Northwest Production Corp.

(Operator)

RAY PHILLIPS

Ray Phillips, Asst Mgr, Prod Ope

(Representative)

3205 Adams Bldg, Albuquerque, N.M.

Address

This is to certify that the well location shown on the plat in Section B was plotted from field notes of actual surveys made by me or under my supervision and that the same is true and correct to the best of my knowledge and belief.

Date Surveyed June 24, 1957

Stephen H. Kinney

Registered Professional
Engineer and/or Land Surveyor.

Certificate No. 803

(See instructions for completing this form on the reverse side)

INSTRUCTIONS FOR COMPLETION:

1. Operator shall furnish and certify to the information called for in Section A.
2. Operator shall outline the dedicated acreage for both oil and gas wells on the plat in Section B.
3. A registered professional engineer or land surveyor registered in the State of New Mexico or approved by the Commission shall show on the plat the location of the well and certify this information in the space provided.
4. All distances shown on the plat must be from the outer boundaries of Section.
5. If additional space is needed for listing owners and their respective interests as required in question 3, Section A, please use space below

10

* "Owner" means the person who has the right to drill into and to produce from any pool and to appropriate the production either for himself or for himself and another. (65-3-29 (e) NMSA 1953 Comp.)