

NEW MEXICO OIL CONSERVATION COMMISSION
Santa Fe, New Mexico

Form C-101
Revised (12/1/55)

NOTICE OF INTENTION TO DRILL

Notice must be given to the District Office of the Oil Conservation Commission and approval obtained before drilling or recompletion begins. If changes in the proposed plan are considered advisable, a copy of this notice showing such changes will be returned to the sender. Submit this notice in QUINTUPLICATE. One copy will be returned following approval. See additional instructions in Rules and Regulations of the Commission.

If State Land submit 6 Copies Attach Form C-128 in triplicate to first 3 copies of form C-101

Farmington, New Mexico

September 26, 1958

(Place)

(Date)

OIL CONSERVATION COMMISSION
SANTA FE, NEW MEXICO

Gentlemen:

You are hereby notified that it is our intention to commence the Drilling of a well to be known as

SKELLY OIL COMPANY

(Company or Operator)

Paul Williams

(Lease)

Well No. **2**

E

(Unit)

The well is

located **1450** feet from the **North** line and **1190** feet from the

West line of Section **35**, T. **26N**, R. **6W**, NMPM.

(GIVE LOCATION FROM SECTION LINE)

South Blance (P.C.)

Pool,

Rio Arriba County

If State Land the Oil and Gas Lease is No.

If patented land the owner is

Paul Williams

Address **600 West Central Avenue - Albuquerque, New Mexico**

We propose to drill well with drilling equipment as follows:

Rotary Tools from 0' to approximately 3050'.

The status of plugging bond is

Drilling Contractor **Banner Drilling Company**

We intend to complete this well in the **Pictured Cliffs**

formation at an approximate depth of **3050** feet.

CASING PROGRAM

We propose to use the following strings of Casing and to cement them as indicated:

Size of Hole	Size of Casing	Weight per Foot	New or Second Hand	Depth	Sacks Cement
10-3/4"	10-3/4" OD	32.75#	New	200'	200
5-1/2"	5-1/2" OD	14#	New	3050'	200

If changes in the above plans become advisable we will notify you immediately.

ADDITIONAL INFORMATION (If recompletion give full details of proposed plan of work.)

Approved
Except as follows:

9-29, 19 **58**

Sincerely yours,

SKELLY OIL COMPANY

(ORIGINAL)
(SIGNED) **H. E. Aab**

By

Position

District Foreman

Send Communications regarding well to

Name **SKELLY OIL COMPANY**

Address **Box 426**

Farmington, New Mexico

OIL CONSERVATION COMMISSION

By

Emery C. Aab

NEW MEXICO OIL CONSERVATION COMMISSION
WELL LOCATION AND ACREAGE DEDICATION PLAT

FORM C-128
Revised 5/1/57

SEE INSTRUCTIONS FOR COMPLETING THIS FORM ON THE REVERSE SIDE

SECTION A

Operator SKELLY OIL COMPANY		Lease PAUL WILLIAMS		Well No. 2
Unit Letter E	Section 35	Township 26 NORTH	Range 6 WEST	County RIO ARriba
Actual Footage Location of Well: 1450 feet from the NORTH line and 1190 feet from the WEST line				
Ground Level Elev.	Producing Formation Pictured Cliffs	Pool South Blanco	Dedicated Acreage: 160 Acres	

Ref: GLO plat dated 4 November 1882

1. Is the Operator the only owner in the dedicated acreage outlined on the plat below? YES ☒ NO ____ . ("Owner" means the person who has the right to drill into and to produce from any pool and to appropriate the production either for himself or for himself and another. (65-3-29 (e) NMSA 1935 Comp.)
2. If the answer to question one is "no," have the interests of all the owners been consolidated by communitization agreement or otherwise? YES ____ NO ____ . If answer is "yes," Type of Consolidation _____
3. If the answer to question two is "no," list all the owners and their respective interests below:

Owner	Land Description



SECTION B

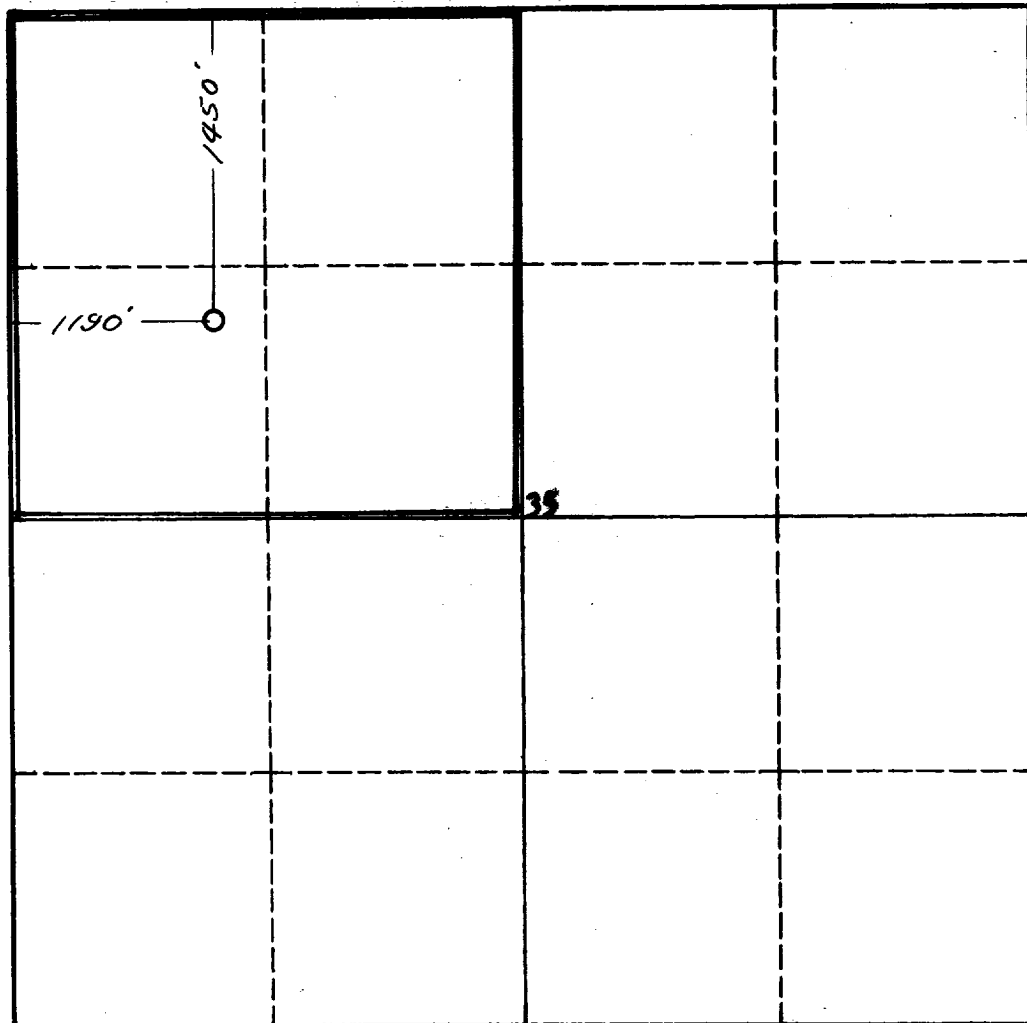

I hereby certify that the information in SECTION A above is true and complete to the best of my knowledge and belief.

Name (ORIGINAL SIGNED) H. E. Aab
Position District Foreman
Company SKELLY OIL COMPANY
Date September 26, 1958

I hereby certify that the well location shown on the plat in SECTION B was plotted from field notes of actual surveys made by me or under my supervision, and that the same is true and correct to the best of my knowledge and belief.

Date Surveyed 25 September 1958
Registered Professional Engineer and/or Land Surveyor James P. Leese
Certificate No. 1463



INSTRUCTIONS FOR COMPLETION OF FORM C-128

1. Operator shall furnish and certify to the information called for in Section A.
2. Operator shall outline the dedicated acreage for *both* oil and gas wells on the plat in Section B.
3. A registered professional engineer or land surveyor registered in the State of New Mexico or approved by the Commission shall show on the plat the location of the well and certify this information in the space provided.
4. All distances shown on the plat must be from the outer boundaries of the Section.
5. If additional space is needed for listing owners and their respective interests as required in question 3 of Section A, please use space below.

OIL CONSERVATION COMMISSION		
AZTEC DISTRICT OFFICE		
No. Copies Received <u>5</u>		
DISTRIBUTION		
	NO. FURNISHED	
Operator	1	
Santa Fe	1	
Proration Office		
State Land Office		
U. S. G. S.	2	
Transporter		
Other	1	✓