

NEW MEXICO
OIL CONSERVATION COMMISSION

Form C-128

WELL LOCATION AND/OR GAS PRORATION PLAT

DATE April 15, 1957

OPERATOR THE OHIO OIL COMPANY LEASE JICARILLA

WELL NO. 3 SECTION 34 TOWNSHIP 26 NORTH RANGE 5 WEST NMPM

LOCATED 990 FEET FROM the NORTH LINE 990 FEET FROM the WEST LINE

RIO ARriba COUNTY, NEW MEXICO G.L. ELEVATION 6549.7 UNGRADED.

NAME OF PRODUCING FORMATION Pictured Cliffs POOL So. Blanco DEDICATED ACREAGE 180.00

Note: All distances must be from outer boundaries of section.

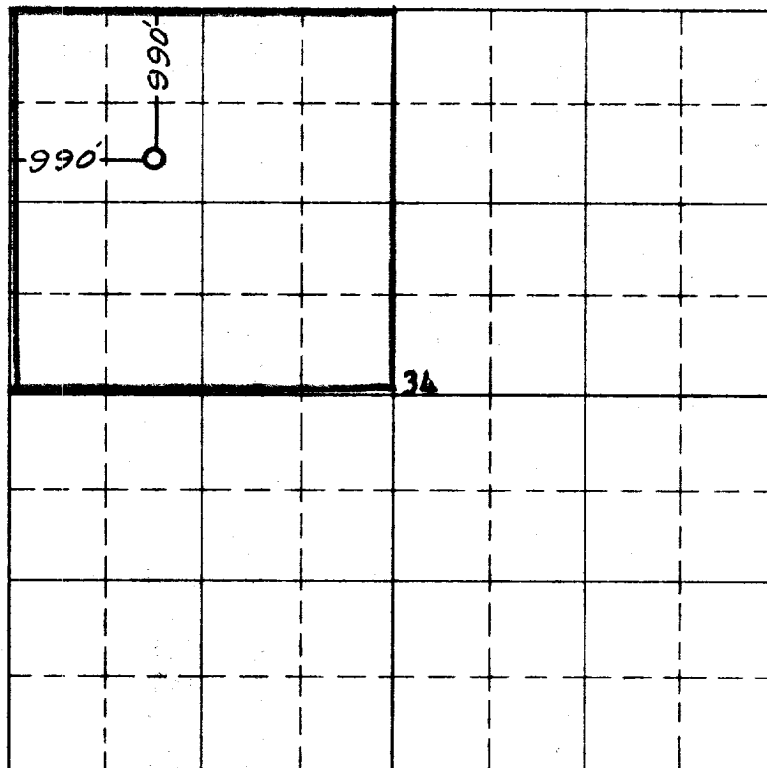

Scale 1 inches equal 1 mile

N

NOTE

This section of
form is to be used
for gas wells only

This is to certify that the above plat was prepared from
field notes of actual surveys made by me or under my
supervision and that the same are true and correct to the
best of my knowledge and belief.

Date Surveyed 8 SEPTEMBER 1955

James P. Reese
Registered Professional Engineer and/or Land Surveyor

JAMES P. REESE
No. 1463



(Seal)

Farmington, New Mexico



1. Is this well a Dual Comp.

Yes _____ No X

2. If the answer to Question 1
is yes, are there any otherdually
completed wells within the
dedicated acreage.

Yes _____ No _____

Name M. J. Boyce

Position Division Production Supt.

Representing The Ohio Oil Company

Address Box 120, Casper, Wyoming

OIL CONSERVATION COMMISSION

AZTEC DISTRICT OFFICE

No. Copies Received **2**

DISTRIBUTION

	NO. FURNISHED	
Director		
Santa Fe	/	
Proration Office		
State Land Office		
U. S. G. S.		
Transporter		
File	/	✓