

NEW MEXICO OIL CONSERVATION COMMISSION
Santa Fe, New Mexico

Form C-101
Revised (12/1/55)

NOTICE OF INTENTION TO DRILL

Notice must be given to the District Office of the Oil Conservation Commission and approval obtained before drilling or recompletion begins. If changes in the proposed plan are considered advisable, a copy of this notice showing such changes will be returned to the sender. Submit this notice in QUINTUPPLICATE. One copy will be returned following approval. See additional instructions in Rules and Regulations of the Commission. If State Land submit 6 Copies Attach Form C- 128 in triplicate to first 3 copies of form C-101 on all wells

Farmington, New Mexico
(Place)

December 18, 1957
(Date)

OIL CONSERVATION COMMISSION
SANTA FE, NEW MEXICO

Gentlemen:

You are hereby notified that it is our intention to commence the Drilling of a well to be known as

SKELLY OIL COMPANY
(Company or Operator)

Paul Williams
(Lease)

Well No. 1, in A The well is

located 1190 feet from the North line and 1190 feet from the

East line of Section 35, T. 26N, R. 6W, NMPM.

(GIVE LOCATION FROM SECTION LINE) Undesignated (P.C.) Pool, Rio Arriba County

If State Land the Oil and Gas Lease is No.

If patented land the owner is Paul Williams

Address

We propose to drill well with drilling equipment as follows:

Rotary Tools from 0' to 2950'.

The status of plugging bond is

Drilling Contractor George W. Riley, Inc.

We intend to complete this well in the Pictured Cliffs

formation at an approximate depth of 2950 feet.

CASING PROGRAM

We propose to use the following strings of Casing and to cement them as indicated:

Size of Hole	Size of Casing	Weight per Foot	New or Second Hand	Depth	Sacks Cement
5-1/2"	5 1/2" OD	14#	New	200- 2950	200
10-3/4"	10-3/4" OD	32.75#	New	200	200

If changes in the above plans become advisable we will notify you immediately.

ADDITIONAL INFORMATION

Approved 12-20, 19 57
Except as follows:

OIL CONSERVATION COMMISSION

By *Ernest C. Cawley*

Sincerely yours,

SKELLY OIL COMPANY

(Company or Operator)

By (Signed) P. E. Cosper

Position District Superintendent

Send Communications regarding well to

Name SKELLY OIL COMPANY

Address Box 426

Farmington, New Mexico

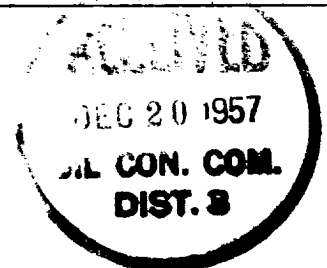

NEW MEXICO OIL CONSERVATION COMMISSION
Well Location and Acreage Dedication Plat

Section A.

Date 13 DECEMBER 1957

Operator SKELLY OIL COMPANY Lease PAUL WILLIAMS
Well No. 1 Unit Letter A Section 35 Township 26 NORTH Range 6 WEST NMPM
Located 1190 Feet From THE NORTH Line, 1190 Feet From THE EAST Line
County RIO ARriba G. L. Elevation _____ Dedicated Acreage 160 Acres
Name of Producing Formation Pictured Cliffs Pool Undesignated S. Blum

1. Is the Operator the only owner* in the dedicated acreage outlined on the plat below?
Yes X No ____.
2. If the answer to question one is "no," have the interests of all the owners been consolidated by communitization agreement or otherwise? Yes ____ No ____ . If answer is "yes," Type of Consolidation _____
3. If the answer to question two is "no," list all the owners and their respective interests below:
REF. GLO Plat of 1957 SURVEY.

Owner

Land Description

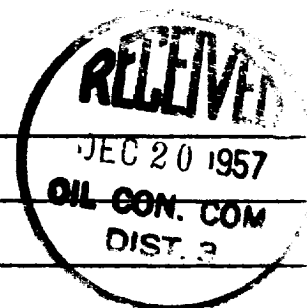

Section B

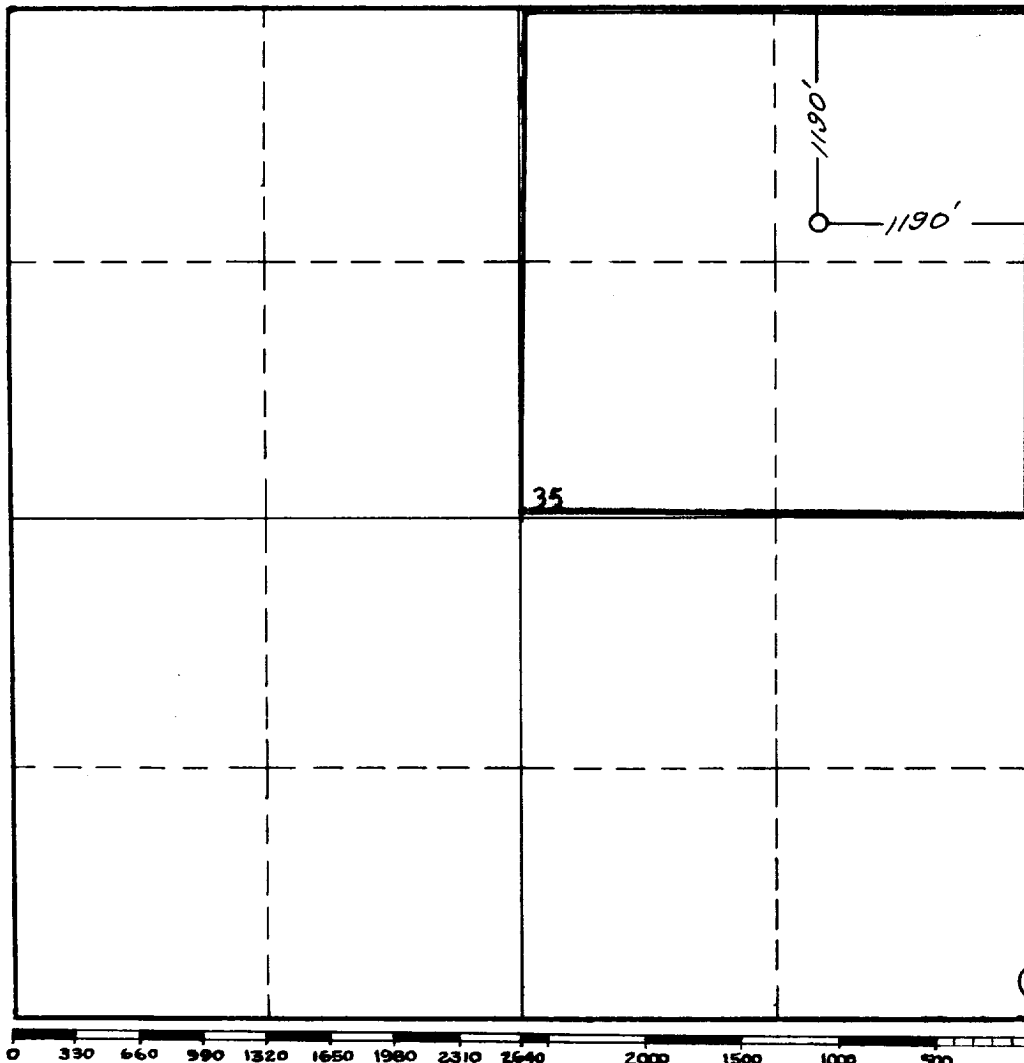

This is to certify that the information in Section A above is true and complete to the best of my knowledge and belief.

SKELLY OIL COMPANY

(Operator)

(Signed) P. E. Cosper

(Representative)

Box 426, Farmington, New Mexico

Address

This is to certify that the well location shown on the plat in Section B was plotted from field notes of actual surveys made by me or under my supervision and that the same is true and correct to the best of my knowledge and belief.

Date Surveyed 12 DECEMBER 1957

James P. Leese
Registered Professional
Engineer and/or Land Surveyor.

JAMES P. LEESE

Certificate No. 1463

(See instructions for completing this form on the reverse side)

INSTRUCTIONS FOR COMPLETION:

1. Operator shall furnish and certify to the information called for in Section A.
2. Operator shall outline the dedicated acreage for both oil and gas wells on the plat in Section B.
3. A registered professional engineer or land surveyor registered in the State of New Mexico or approved by the Commission shall show on the plat the location of the well and certify this information in the space provided.
4. All distances shown on the plat must be from the outer boundaries of Section.
5. If additional space is needed for listing owners and their respective interests as required in question 3, Section A, please use space below

OIL CONSERVATION COMMISSION	
AZTEC DISTRICT OFFICE	
NO. OF WELLS	5
DATE	
NAME	
ADDRESS	
CITY	
STATE	
ZIP	
PHONE	
TELETYPE	
TELEFAX	
EMAIL	
WEB	
OTHER	

* "Owner" means the person who has the right to drill into and to produce from any pool and to appropriate the production either for himself or for himself and another. (65-3-29 (e) NMSA 1953 Comp.)