

**NEW MEXICO OIL CONSERVATION COMMISSION
WELL LOCATION AND ACREAGE DEDICATION PLAT**

Okal

Form C-102
Supersedes C-128
Effective 1-1-65

All distances must be from the outer boundaries of the Section.

Operator SUPRON ENERGY CORPORATION			Lease JICARILLA "F"		Well No. 1
Unit Letter L	Section 27	Township 26 North	Range 4 West	County Rio Arriba	
Actual Footage Location of Well: 1600 feet from the South line and 850 feet from the West line					
Ground Level Elev. 7190	Producing Formation PICTURED CLIFFS		Pool TAPAICTO		Dedicated Acreage: 160 Acres

1. Outline the acreage dedicated to the subject well by colored pencil or hachure marks on the plat below.
2. If more than one lease is dedicated to the well, outline each and identify the ownership thereof (both as to working interest and royalty).
3. If more than one lease of different ownership is dedicated to the well, have the interests of all owners been consolidated by communitization, unitization, force-pooling, etc?

☐ Yes ☐ No If answer is "yes," type of consolidation _____

If answer is "no," list the owners and tract descriptions which have actually been consolidated. (Use reverse side of this form if necessary.) _____

No allowable will be assigned to the well until all interests have been consolidated (by communitization, unitization, forced-pooling, or otherwise) or until a non-standard unit, eliminating such interests, has been approved by the Commission.

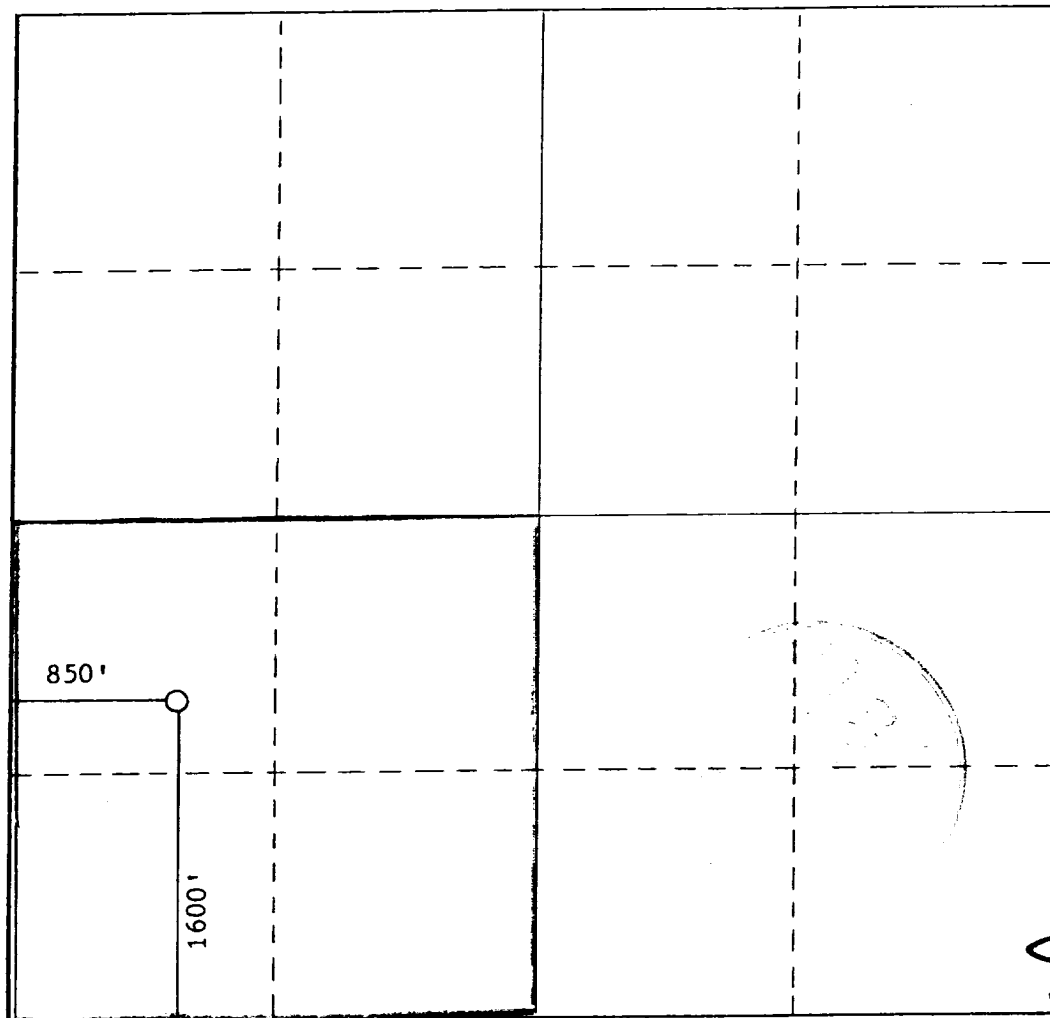

CERTIFICATION

I hereby certify that the information contained herein is true and complete to the best of my knowledge and belief.

Kenneth E. Roddy

Name
Kenneth E. Roddy

Position
Production Superintendent

Company
SUPRON ENERGY CORPORATION

Date
October 3, 1979

I hereby certify that the well location shown on this plat was plotted from field notes of actual surveys made by me or under my supervision, and that the same is true and correct to the best of my knowledge and belief.

JAMES P. LEASE

Date Surveyed
19 March 1954

Registered Professional Engineer and/or Land Surveyor
James P. Lease

Certificate No.
1463

