



IN REPLY REFER TO:

UNITED STATES
DEPARTMENT OF THE INTERIOR
GEOLOGICAL SURVEY
P. O. Box 965
Farmington, New Mexico

April 30, 1956

Southern Union Gas Company
1001 Burt Building
Dallas, Texas

Re: Jicarilla Tribal
Contract 100

Gentlemen:

Receipt is acknowledged of your "Notice of Intention to Drill" dated April 26, 1956 covering your well No. 4-D Jicarilla in NE $\frac{1}{4}$ sec. 30, T. 26 N., R. 3 W., N. M. P. M., Rio Arriba County, New Mexico, Tapicito Pictured Cliffs pool.

Your proposed work is hereby approved subject to Compliance with the provisions of the "Oil and Gas Operating Regulations" revised May 25, 1942, a copy of which will be sent to you on request, and subject to the following conditions:

1. Drilling operations so authorized are subject to the attached sheet for general conditions of approval.
2. Furnish copies of all logs.

Very truly yours,

(Orig. Sgd.) P. T. McGRATH

P. T. McGrath
District Engineer

PTMcGrath:ac
cc - Jicarilla Agency



UNITED STATES
DEPARTMENT OF THE INTERIOR
GEOLOGICAL SURVEY



Washington, D. C.

Dear Sir:

I have the honor to acknowledge the receipt of your letter of the 10th inst. in relation to the matter mentioned therein. The same has been referred to the proper authorities for their consideration.

Very respectfully,
Director



Very respectfully,
Director

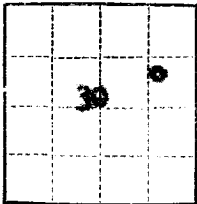

(SUBMIT IN TRIPLICATE)

UNITED STATES
DEPARTMENT OF THE INTERIOR
GEOLOGICAL SURVEY

Land Office Jicarilla Tribal
Lease No. Contract No. 100
Unit NE 1/4 Sec. 30, T-26N,
R-3W, N.M.P.M., Rio Arriba
County, New Mexico

SUNDRY NOTICES AND REPORTS ON WELLS

NOTICE OF INTENTION TO DRILL.....	<input checked="" type="checkbox"/>	SUBSEQUENT REPORT OF WATER SHUT-OFF.....	
NOTICE OF INTENTION TO CHANGE PLANS.....		SUBSEQUENT REPORT OF SHOOTING OR ACIDIZING.....	
NOTICE OF INTENTION TO TEST WATER SHUT-OFF.....		SUBSEQUENT REPORT OF ALTERING CASING.....	
NOTICE OF INTENTION TO RE-DRILL OR REPAIR WELL.....		SUBSEQUENT REPORT OF RE-DRILLING OR REPAIR.....	
NOTICE OF INTENTION TO SHOOT OR ACIDIZE.....		SUBSEQUENT REPORT OF ABANDONMENT.....	
NOTICE OF INTENTION TO PULL OR ALTER CASING.....		SUPPLEMENTARY WELL HISTORY.....	
NOTICE OF INTENTION TO ABANDON WELL.....			

(INDICATE ABOVE BY CHECK MARK NATURE OF REPORT, NOTICE, OR OTHER DATA)

April 26, 1956

Well No. 4-D Jicarilla is located 1650 ft. from N line and 990 ft. from E line of sec. 30

NE 1/4 Section 30 26-N 3-W N.M.P.M.
(1/4 Sec. and Sec. No.) (Twp.) (Range) (Meridian)
Pictured Cliffs Rio Arriba County New Mexico
(Field) (County or Subdivision) (State or Territory)

The elevation of the derrick floor above sea level is _____ ft. To be determined.

DETAILS OF WORK

(State names of and expected depths to objective sands; show sizes, weights, and lengths of proposed casings; indicate mudding jobs, cementing points, and all other important proposed work)

The objective sand is the Pictured Cliffs formation anticipated at approximately 3500'.

Proposed Casing Program: 100' 9-5/8" Cemented to surface
3550' 5-1/2" Cemented with 150 sacks

Rotary Tools will be employed from surface to T.D. Estimated T.D. 3550'.

The well will be sand fraced in an effort to stimulate production.

I understand that this plan of work must receive approval in writing by the Geological Survey before operations may be commenced.

Company Southern Union Gas Company

Address 1001 Durt Bldg.
Dallas, Texas

By [Signature]
A. H. Wiedersheim
Title Manager, Exploration Dept.

NEW MEXICO
OIL CONSERVATION COMMISSION

Form C-128

Well Location and/or Gas Proration Plat

Date April 26, 1956

Operator SOUTHERN UNION GAS COMPANY Lease JICARILLA

Well No. 4-D Section 30 Township 26 NORTH Range 3 WEST, NMPM

Located 1650 Feet From the NORTH Line, 990 Feet From the EAST Line,

RIO ARRIBA County, New Mexico. G. L. Elevation To be determined

Name of Producing Formation PICTURED CLIFFS Pool TAPICITO P.C. Dedicated Acreage 320

(Note: All distances must be from outer boundaries of Section)

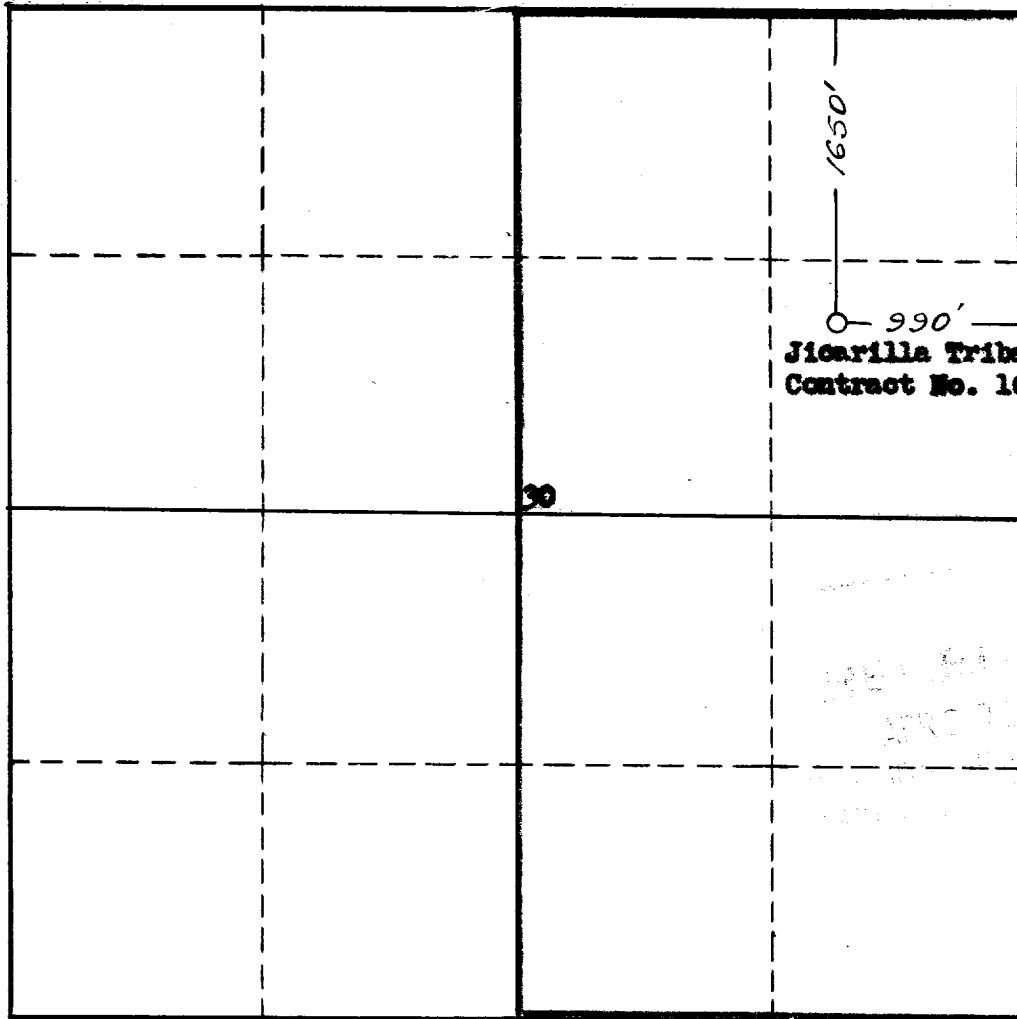

SCALE: 1" = 1000'

1. Is this Well a Dual Comp. ? Yes ___ No X .

2. If the answer to Question 1 is yes, are there any other dually completed wells within the dedicated acreage? Yes ___ No X .

This is to certify that the above plat was prepared from field notes of actual surveys made by me or under my supervision and that the same are true and correct to the best of my knowledge and belief.

Name A. M. Wiederkehr

Position Manager, Exploration Dept.

Representing Southern Union Gas Company

Address 1001 Burt Bldg., Dallas, Texas

Date Surveyed 26 MARCH 1956

James P. Leese

Registered Professional Engineer and/or

Land Surveyor James P. Leese

M. Mex. Reg. No. 1463