

NEW MEXICO OIL CONSERVATION COMMISSION

Well Location and Acreage Dedication Plat

Section A.

Date March 7, 1958

Operator Honolulu Oil Company Lease Jicarilla "A"
Well No. 1 Unit Letter Section 26 Township 26 N Range 3 W N.M.P.M.
Located 1130 Feet From north Line, 1130 Feet From east Line
County Rio Arriba G. L. Elevation 7390 Dedicated Acreage 10 (NE 1/4) Acres
Name of Producing Formation Wildcat Pool East Tapacito

1. Is the Operator the only owner* in the dedicated acreage outlined on the plat below?
Yes X No .
2. If the answer to question one is "no," have the interests of all the owners been consolidated by communitization agreement or otherwise? Yes No . If answer is "yes," Type of Consolidation
3. If the answer to question two is "no," list all the owners and their respective interests below:

Owner

Land Description

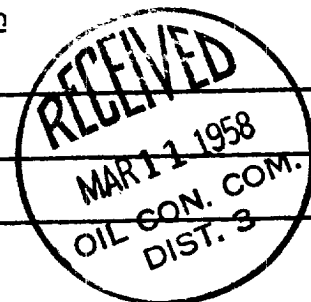

Section B

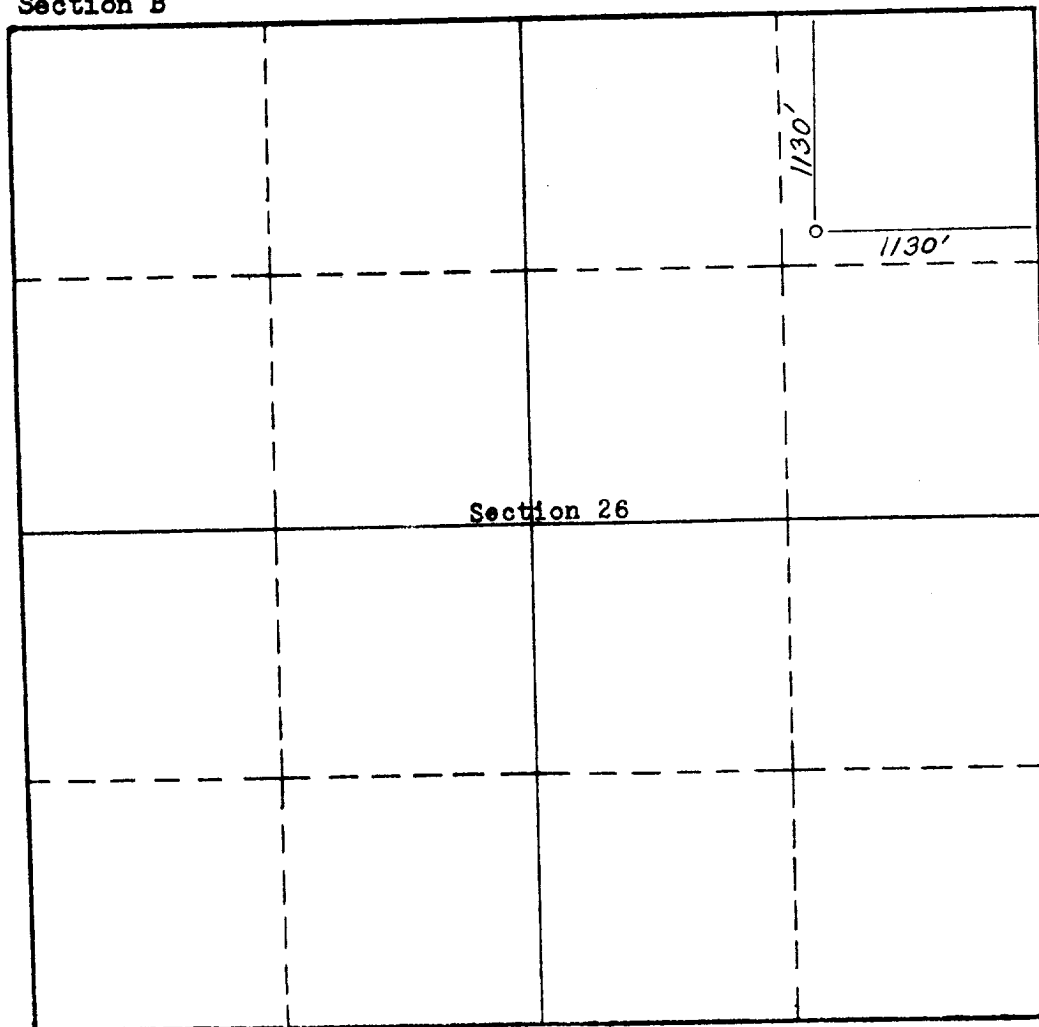

This is to certify that the information in Section A above is true and complete to the best of my knowledge and belief.

HONOLULU OIL CORPORATION
(Operator)

Tom R. Carter
(Representative)

P. O. DRAWER 1391
Address Midland, Tex

This is to certify that the well location shown on the plat in Section B was plotted from field notes of actual surveys made by me or under my supervision and that the same is true and correct to the best of my knowledge and belief.

Date Surveyed 11 July 1957

Stephen H. Henny
STEPHEN H. HENNY
Registered Professional
Engineer and/or Land Surveyor.

Certificate No. 803

WILDLIFE CONSERVATION COMMISSION

DISTRICT OFFICE

Sl. No.	3	
Name		
Age	1	
Sex	1	
Religion		
Occupation		
Address		
Transporter		
File	1	✓