

NEW MEXICO
OIL CONSERVATION COMMISSION

Form C-128

WELL LOCATION AND/OR GAS PRORATION PLAT

April 15, 1957

DATE _____

OPERATOR THE OHIO OIL COMPANY LEASE JICARILLA

WELL NO. 5 SECTION 28 TOWNSHIP 26 NORTH RANGE 5 WEST NMPM

LOCATED 1090 FEET FROM the NORTH LINE 1090 FEET FROM the WEST LINE

RIO ARriba COUNTY, NEW MEXICO G.L. ELEVATION 6462.0 UNGRADED.
160.00

NAME OF PRODUCING FORMATION Pictured Cliffs So. Blanco
FOOT DEDICATED ACREAGE _____

Note: All distances must be from outer boundaries of section.

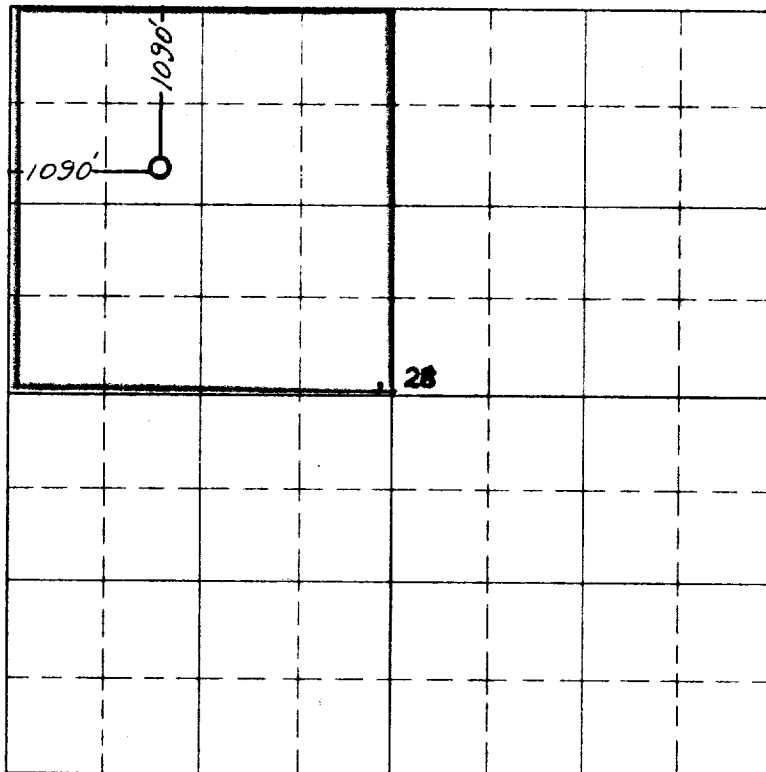

RECEIVED
MAY 1 1957
U.S. GEOLOGICAL SURVEY
FARMINGTON, NEW MEXICO

N

NOTE

This section of
form is to be used
for gas wells only

Scale 4 inches equal 1 mile

This is to certify that the above plat was prepared from
field notes of actual surveys made by me or under my
supervision and that the same are true and correct to the
best of my knowledge and belief.

Date Surveyed 3 NOVEMBER 1955

Registered Professional Engineer and/or Surveyor

JAMES R. ROBERTS
No. 1463

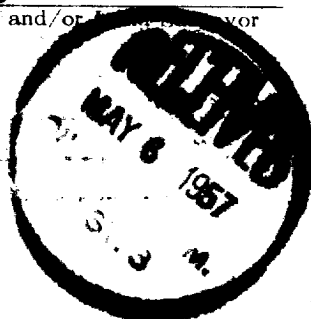
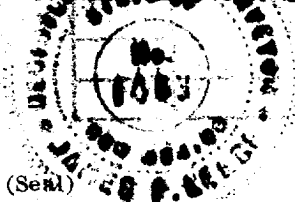

1. Is this well a Dual Comp. ☒
Yes _____ No _____

2. If the answer to Question 1
is yes, are there any other dually
completed wells within the
dedicated acreage.

Yes _____ No _____
M. J. Boyce

Name Division Production Supt.

Position The Ohio Oil Company

Representing Box 120, Casper, Wyoming

Address _____

OIL CONSERVATION COMMISSION		
AZTEC DISTRICT OFFICE		
No. Copies Received		2
DISTRIBUTION		
	NO. FURNISHED	
Operator		
Santa Fe	1	
Proration Office		
State Land Office		
U. S. G. S.		
Transporter		
File	1	✓