

(SUBMIT IN TRIPLICATE)

UNITED STATES
DEPARTMENT OF THE INTERIOR
GEOLOGICAL SURVEY

Land Office _____
Lease No. **NM 014334**
Unit _____

SUNDRY NOTICES AND REPORTS ON WELLS

| | | | |
|--|-------------------------------------|--|--|
| NOTICE OF INTENTION TO DRILL | <input checked="" type="checkbox"/> | SUBSEQUENT REPORT OF WATER SHUT-OFF | |
| NOTICE OF INTENTION TO CHANGE PLANS | | SUBSEQUENT REPORT OF SHOOTING OR ACIDIZING | |
| NOTICE OF INTENTION TO TEST WATER SHUT-OFF | | SUBSEQUENT REPORT OF ALTERING CASING | |
| NOTICE OF INTENTION TO RE-DRILL OR REPAIR WELL | | SUBSEQUENT REPORT OF RE-DRILLING OR REPAIR | |
| NOTICE OF INTENTION TO SHOOT OR ACIDIZE | | SUBSEQUENT REPORT OF ABANDONMENT | |
| NOTICE OF INTENTION TO PULL OR ALTER CASING | | SUPPLEMENTARY WELL HISTORY | |
| NOTICE OF INTENTION TO ABANDON WELL | | | |

(INDICATE ABOVE BY CHECK MARK NATURE OF REPORT, NOTICE, OR OTHER DATA)

Well No. **2-23** is located ⁷⁰⁰~~600~~ ft. from ^{ON}~~SW~~ line and ⁶³⁵~~600~~ ft. from ^{XXE}~~W~~ line of sec. **23**
SEW Sec 23 ^{26N} ^{1E} **N.M.P.M.**
(1/4 Sec. and Sec. No.) (Twp.) (Range) (Meridian)
NC **Rio Arriba** **New Mexico**
(Field) (County or Subdivision) (State or Territory)

The elevation of the derrick floor above sea level is **7840** ft.

DETAILS OF WORK

(State names of and expected depths to objective sands; show sizes, weights, and lengths of proposed casings; indicate mudlogging jobs, cementing points, and all other important proposed work)

Drill with cable tools and set approximately 100' of 13 3/8" surface casing with 100 sx. Drill with cable tools to an approximate depth of 2650' or a sufficient depth to test the Dakota formation. If productive, we will set 4 1/2" casing to total depth, perforate, and sand-oil fracture, if necessary.

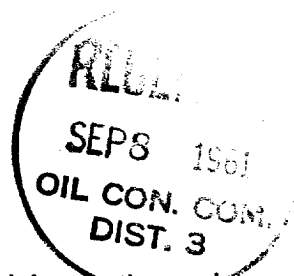

I understand that this plan of work must receive approval in writing by the Geological Survey before operations may be commenced.

Company **Central Production Company (Kent Elliott)**

Address **Box 1097**

El Paso, Texas

By Jay J. Harris
Jay J. Harris
 Title **Geologist**

801 Ridgcrest Dr.
Albuquerque, N. M.

NEW MEXICO OIL CONSERVATION COMMISSION

Well Location and Acreage Dedication Plat

SECTION A.

Date **Sep't 5, 1961**

Operator **Central Production Company** Lease **Federal**
Well No. **2-23** Unit Letter **M** Section **23** Township **26 North** Range **1 East**, NMPM
Located **700** Feet From **South** Line, **635** Feet From **West** Line
County **Rio Arriba** G. L. Elevation **7840** Dedicated Acreage **40** Acres
Name of Producing Formation **Greenhorn** Pool **MC**

1. Is the Operator the only owner* in the dedicated acreage outlined on the plat below? Yes ☒ No ☐
2. If the answer to question One is "No," have the interests of all the owners been consolidated by communization agreement or otherwise? Yes ☐ No ☐ If answer is "Yes," Type of Consolidation _____
3. If the answer to question Two is "No," list all the owners and their respective interests below:

OWNER

LAND DESCRIPTION

SECTION B.

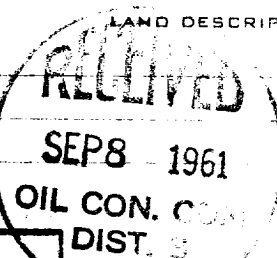
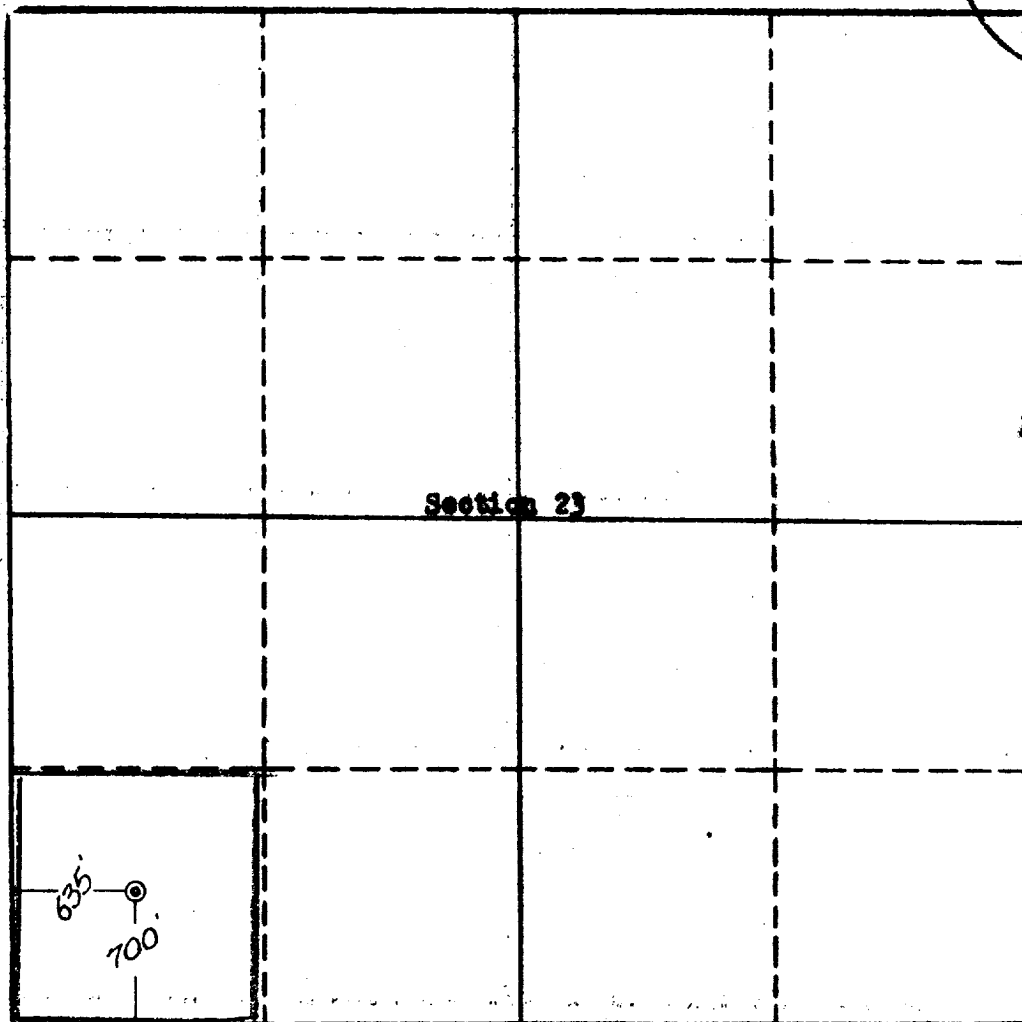

This is to certify that the information in Section A above is true and complete to the best of my knowledge and belief.

Central Production Co.

(OPERATOR)

Jay J. Harris

(REPRESENTATIVE)

**801 Ridgcrest Dr., SE.
Albuquerque, New Mexico**

Jay J. Harris
(ADDRESS)

This is to certify that the well location shown on the plat in Section B was plotted from field notes of actual survey made by me or under my supervision and is true and correct to the best of my knowledge and belief.

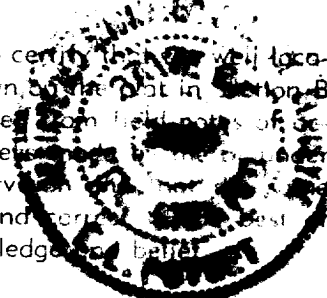

Date Surveyed **August 26, 1961**

Four States Engineering Co.
FARMINGTON, NEW MEXICO

E. L. Poteet
REGISTERED ENGINEER OR
LAND SURVEYOR

Certificate No. **3084**

