

Mobil Oil Corporation

THREE GREENWAY PLAZA EAST - SUITE 800
HOUSTON, TEXAS 77046

September 3, 1976

New Mexico Oil Conservation Commission
1000 Rio Brazos Road
Aztec, New Mexico 87410

CHANGE OF ACREAGE DEDICATION
MOBIL OIL CORPORATION'S
JICARILLA "B", WELLS NO. 3 ~~1-5~~ M-20-26-3
BLANCO MESAVERDE POOL
RIO ARRIBA COUNTY, NEW MEXICO

Gentlemen:

Attached are amended acreage dedication plats for the subject wells. The acreage currently assigned to Well #3 is being changed from the west half of Sec. 20 to the south half, and the acreage assigned to Well #5 is being changed from the east half of Sec. 20 to the north half. These changes are necessary to avoid re-numbering proposed Well #3A.

Yours very truly,



J. A. Morris

ADBond: to

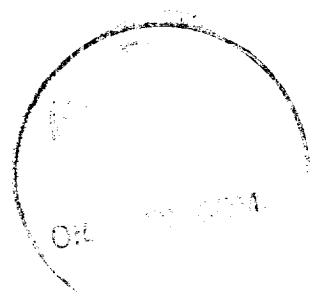

**NEW MEXICO OIL CONSERVATION COMMISSION
WELL LOCATION AND ACREAGE DEDICATION PLAT**

Form C-102
Supersedes C-128
Effective 1-1-65

All distances must be from the outer boundaries of the Section.

Operator Mobil Oil Corporation			Lease Jicarilla B		Well No. 3
Unit Letter M	Section 20	Township 26N	Range 3W	County Rio Arriba	
Actual Footage Location of Well: 990 feet from the South line and 1190 feet from the West line					
Ground Level Elev.	Producing Formation Mesaverde		Pool Blanco Mesaverde		Dedicated Acreage: 320 Acres

1. Outline the acreage dedicated to the subject well by colored pencil or hachure marks on the plat below.
2. If more than one lease is dedicated to the well, outline each and identify the ownership thereof (both as to working interest and royalty).
3. If more than one lease of different ownership is dedicated to the well, have the interests of all owners been consolidated by communitization, unitization, force-pooling, etc?

☐ Yes ☐ No If answer is "yes," type of consolidation _____

If answer is "no," list the owners and tract descriptions which have actually been consolidated. (Use reverse side of this form if necessary.) _____

No allowable will be assigned to the well until all interests have been consolidated (by communitization, unitization, forced-pooling, or otherwise) or until a non-standard unit, eliminating such interests, has been approved by the Commission.

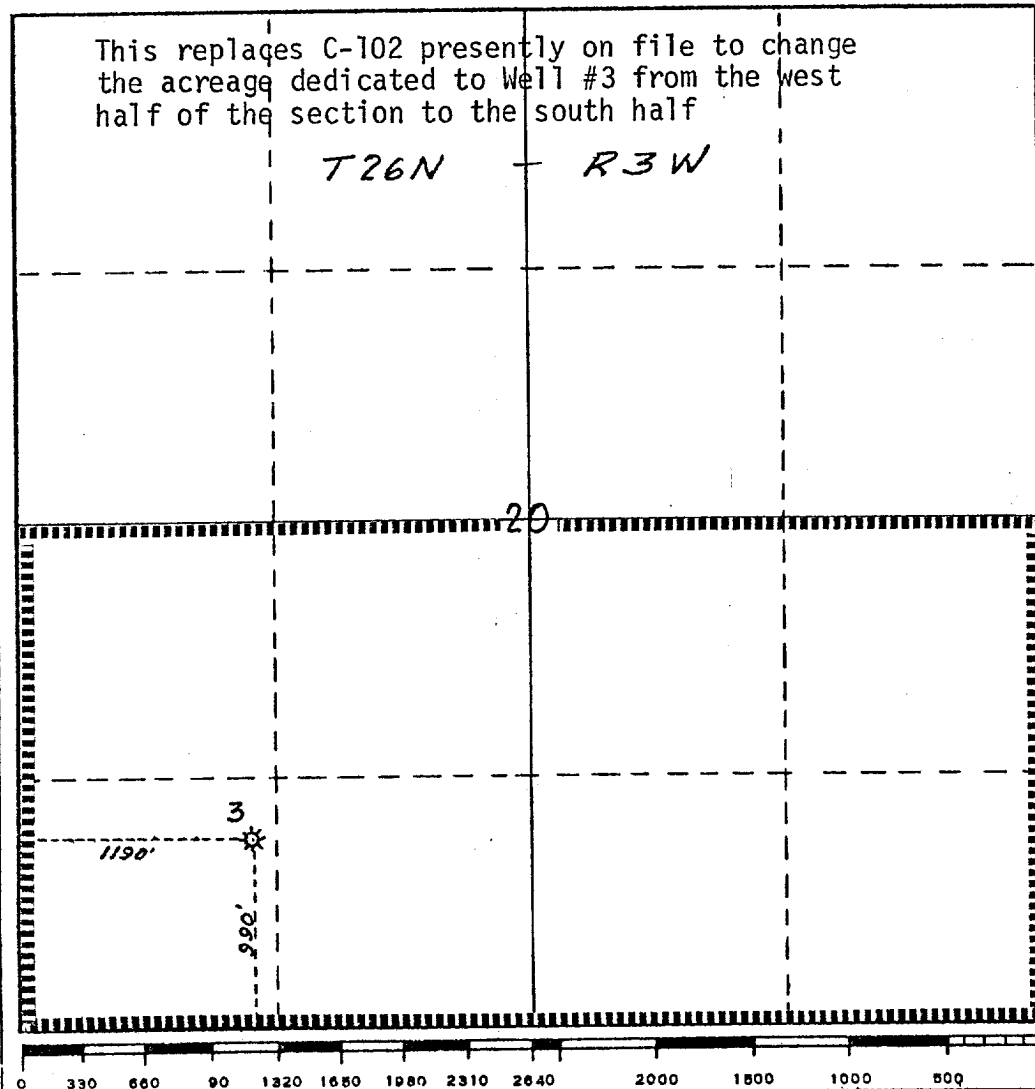
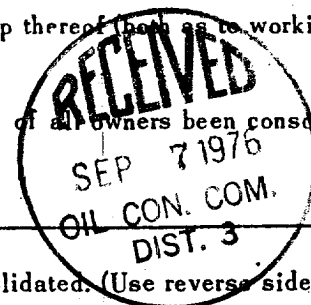

CERTIFICATION	
I hereby certify that the information contained herein is true and complete to the best of my knowledge and belief.	
Name	A.D. Bond
Position	Regulatory Engineering Coordinator
Company	Mobil Oil Corporation
Date	September 3, 1976
I hereby certify that the well location shown on this plat was plotted from field notes of actual surveys made by me or under my supervision, and that the same is true and correct to the best of my knowledge and belief.	
Date Surveyed	
Registered Professional Engineer and/or Land Surveyor	
Certificate No.	