

(SUBMIT IN TRIPLICATE)

UNITED STATES  
DEPARTMENT OF THE INTERIOR  
GEOLOGICAL SURVEY

Land Office Jicarilla-Apache  
Lease No. Contract - 110  
Unit Tract - 203

SUNDRY NOTICES AND REPORTS ON WELLS

NOTICE OF INTENTION TO DRILL.....	<input checked="" type="checkbox"/>	SUBSEQUENT REPORT OF WATER SHUT-OFF.....	
NOTICE OF INTENTION TO CHANGE PLANS.....		SUBSEQUENT REPORT OF SHOOTING OR ACIDIZING.....	
NOTICE OF INTENTION TO TEST WATER SHUT-OFF.....		SUBSEQUENT REPORT OF ALTERING CASING.....	
NOTICE OF INTENTION TO RE-DRILL OR REPAIR WELL.....		SUBSEQUENT REPORT OF REDRILLING OR REPAIR.....	
NOTICE OF INTENTION TO SHOOT OR ACIDIZE.....		SUBSEQUENT REPORT OF ABANDONMENT.....	
NOTICE OF INTENTION TO PULL OR ALTER CASING.....		SUPPLEMENTARY WELL HISTORY.....	
NOTICE OF INTENTION TO ABANDON WELL.....			

(INDICATE ABOVE BY CHECK MARK NATURE OF REPORT, NOTICE, OR OTHER DATA)

Delhi-Atlantic Jicarilla

August 13, 19 53

Well No. 1 is located 990 ft. from XXXX line and 990 ft. from XXXX line of sec. 19

S. E. 1/4 Sec. 19  
(1/4 Sec. and Sec. No.)

T-26-N R-5-N  
(Twp.) (Range)

NHFM  
(Meridian)

Wildcat  
(Field)

Kio Arriba  
(County or Subdivision)

New Mexico  
(State or Territory)

The elevation of the derrick floor above sea level is \_\_\_\_\_ ft. (Will be furnished later)

DETAILS OF WORK

(State names of and expected depths to objective sands; show sizes, weights, and lengths of proposed casings; indicate mudding jobs, cementing points, and all other important proposed work)

We propose to drill with rotary tools to the top of the Pictured Cliff sand and set pipe; then drill with rotary using gas thru the Pictured Cliff formation and shoot with nitro for gas completion.

Proposed Casing Program:

150' - 9-5/8" 36# J-55 SS Casing - circulate cement to surface  
3100' - 5-1/2" 15.5# J-55 Casing - cemented with 200 sacks  
3200' - 1" Std. API Line Pipe - Siphon Line

I understand that this plan of work must receive approval in writing by the Geological Survey before operations may be commenced.

Company Delhi Oil Corporation

Address Box 1175

Farmington, N. M.

By J. B. Howell  
J. B. Howell  
Title Superintendent

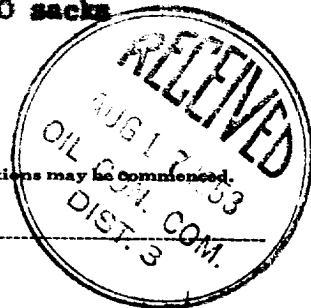

Company Delhi Oil Corporation  
Lease Delhi-Atlantic Jicarilla Well No. 1  
Sec. 19, T. 26 N., R. 5 W., N.M.P.M.  
Location 990' from the South line and 990' from  
the West line.

Jicarilla-Apache  
Contract - 110  
Tract - 203

Rio Arriba County

New Mexico

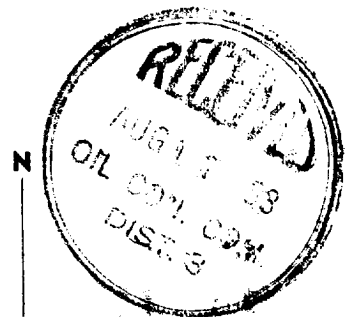
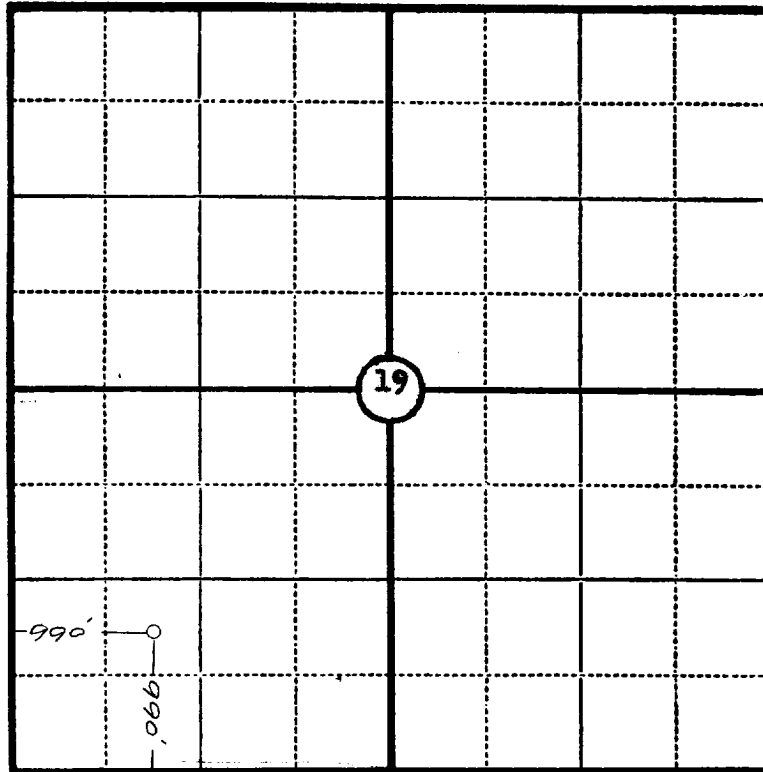

Scale—4 inches equal 1 mile.

This is to certify that the above plat was prepared from field notes of actual surveys made by me or under my supervision and that the same are true and correct to the best of my knowledge and belief.

Seal:

*James P. Leese*  
Registered Professional  
Engineer and Land Surveyor.

James P. Leese  
N. Mex. Reg. No. 1463

Surveyed August 12, 19 53.