

COPY TO O. D. C.

L

COPY FOR
STATE OF NEW MEXICO
**OIL CONSERVATION
COMMISSION**
SUBMIT IN TRIPLICATE TO
DISTRICT OFFICE

UNITED STATES
DEPARTMENT OF THE INTERIOR
GEOLOGICAL SURVEY

Land Office _____
Lease No. **22 079304**
Unit **21/4, Section 24,**

SUNDRY NOTICES AND REPORTS ON WELLS

NOTICE OF INTENTION TO DRILL.....	<input checked="" type="checkbox"/>	SUBSEQUENT REPORT OF WATER SHUT-OFF.....	
NOTICE OF INTENTION TO CHANGE PLANS.....		SUBSEQUENT REPORT OF SHOOTING OR ACIDIZING.....	
NOTICE OF INTENTION TO TEST WATER SHUT-OFF.....		SUBSEQUENT REPORT OF ALTERING CASING.....	
NOTICE OF INTENTION TO RE-DRILL OR REPAIR WELL.....		SUBSEQUENT REPORT OF REDRILLING OR REPAIR.....	
NOTICE OF INTENTION TO SHOOT OR ACIDIZE.....		SUBSEQUENT REPORT OF ABANDONMENT.....	
NOTICE OF INTENTION TO PULL OR ALTER CASING.....		SUPPLEMENTARY WELL HISTORY.....	
NOTICE OF INTENTION TO ABANDON WELL.....			

(INDICATE ABOVE BY CHECK MARK NATURE OF REPORT, NOTICE, OR OTHER DATA)

November 13, 1952

C.A. Sanchez

Well No. **2** is located **1000** ft. from **SW** line and **1720** ft. from **WE** line of sec. **24**

21/4, Sec. 24

(1/4 Sec. and Sec. No.)

26E

(Twp.)

6W

(Range)

N.M.P.M.

(Meridian)

Dogie Canyon P.C.

(Field)

Rio Arriba

(County or Subdivision)

New Mexico

(State or Territory)

The elevation of the derrick floor above sea level is _____ ft. **To be furnished later.**

DETAILS OF WORK

(State names of and expected depths to objective sands; show sizes, weights, and lengths of proposed casings; indicate muddling jobs, cementing points, and all other important proposed work)

It is intended to test the Pictured Cliffs formation expected around 3000'.

Casing Program:

Approximately 500' of 10-3/4"
" 3000' of 7".



I understand that this plan of work must receive approval in writing by the Geological Survey before operations may be commenced.

Company **Lovry et al Operating Account**

Address **616 N. Central.**

Albuquerque, N.M.

By

Title **Asst. General Manager.**

NOV 17 1952
OIL CON. OF
DIST. 2

Company.....**Lowry et al Operating Account**.....

Lease.....**Santa Fe 07930h**..... Well No. **2 - Sanchez**

Sec. **24**....., T. **26 N.**....., R. **6 W.**, N.M.P.M.....

Location.....**1800' from the South line and 1720' from the West line.**

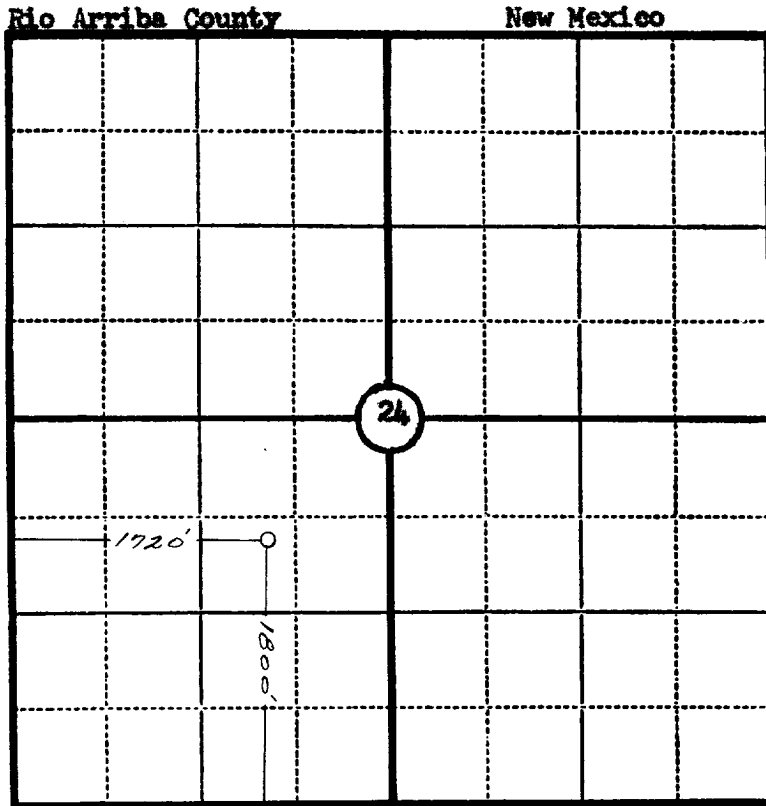

Scale—4 inches equal 1 mile.

This is to certify that the above plat was prepared from field notes of actual surveys made by me or under my supervision and that the same are true and correct to the best of my knowledge and belief.

Charles J. Finkles

Seal:

Registered Professional Engineer and Land Surveyor.

Charles J. Finkles
N. Mex. Reg. No. 1302



Surveyed**November 12**....., 19.....**52**