

NEW MEXICO
OIL CONSERVATION COMMISSION

Form C-128

Well Location and/or Gas Proration Plat

Date July 23, 1956

Operator Magnolia Petroleum Company

Lease Jicarilla "B"

Well No. Two (2) Section 19 Township 26 N Range 3 W NMPM

Located 990 Feet From North Line, 1190 Feet From East Line,

Rio Arriba County, New Mexico.

G. L. Elevation 7016

Name of Producing Formation Mesa Verde

Pool Blanco

Dedicated Acreage 320

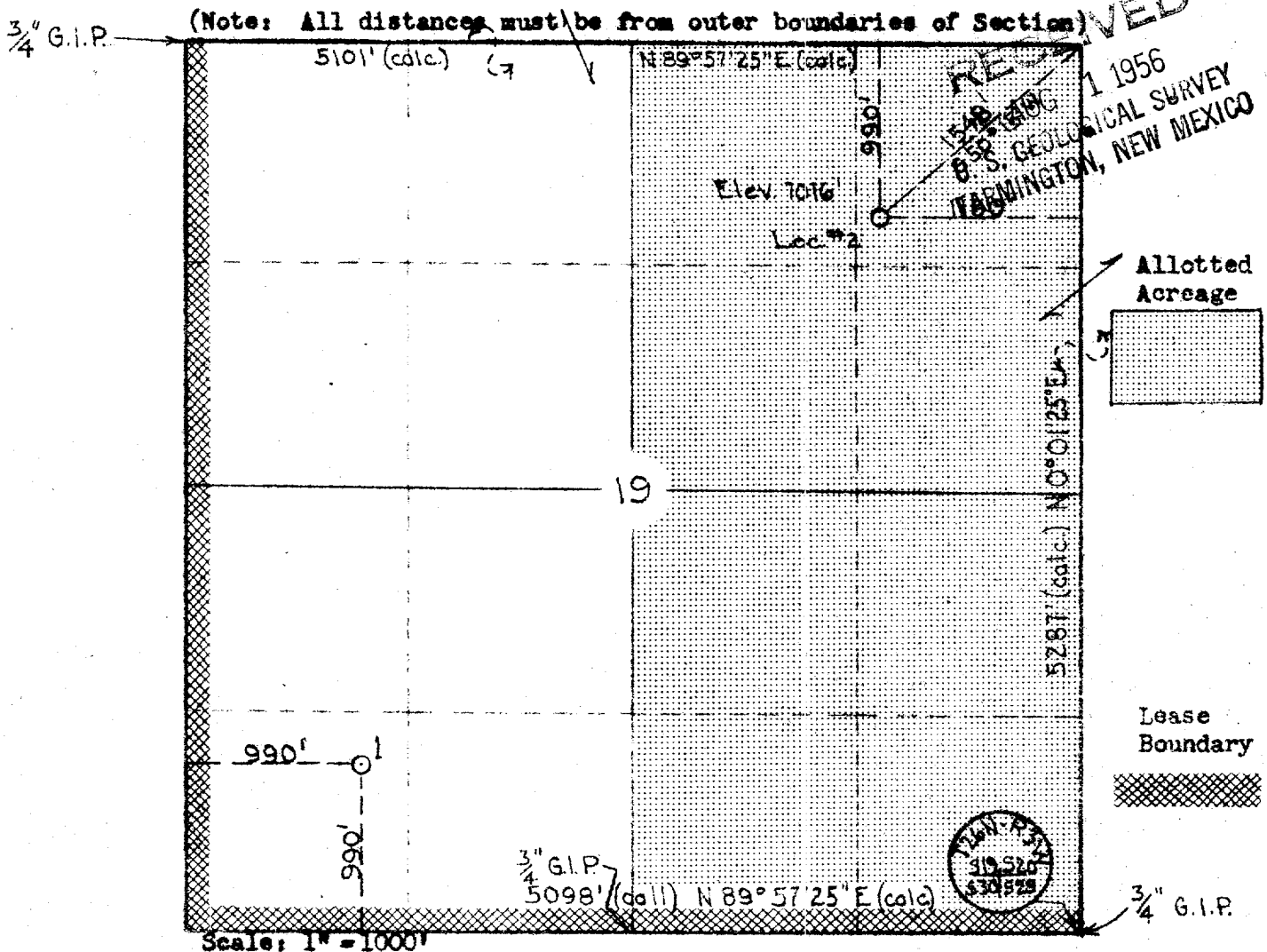

1. Is this Well a Dual Comp.? Yes X No. .

2. If the answer to Question 1 is yes, are there any other dually completed wells within the dedicated acreage? Yes No X.

This is to certify that the above plat was prepared from field notes of actual surveys made by me or under my supervision and that the same are true and correct to the best of my knowledge and belief.

Name E. Y. German
Position E. Y. German, Div. Superintendent
Representing Magnolia Petroleum Co.
Address Box 633 - Midland, Texas

Date Surveyed June 26, 1956
[Signature]
Registered Professional Engineer and/or
Land Surveyor 1115