

(SUBMIT IN TRIPLICATE)

UNITED STATES
DEPARTMENT OF THE INTERIOR
GEOLOGICAL SURVEY

Budget Item No. 12-1639-1
Approval expires 12-31-60.
Indian Agency Jicarilla

Allottee Jicarilla Tribal
Lease No. Contract 108

SUNDRY NOTICES AND REPORTS ON WELLS

NOTICE OF INTENTION TO DRILL	<input checked="" type="checkbox"/>	SUBSEQUENT REPORT OF WATER SHUT-OFF	RECEIVED JUN 16 1958 U. S. GEOLOGICAL SURVEY FARMINGTON, NEW MEXICO
NOTICE OF INTENTION TO CHANGE PLANS	<input type="checkbox"/>	SUBSEQUENT REPORT OF SHOOTING OR ACIDIZING	
NOTICE OF INTENTION TO TEST WATER SHUT-OFF	<input type="checkbox"/>	SUBSEQUENT REPORT OF ALTERING CASING	
NOTICE OF INTENTION TO REDRILL OR REPAIR WELL	<input type="checkbox"/>	SUBSEQUENT REPORT OF REDRILLING OR REPAIR	
NOTICE OF INTENTION TO SHOOT OR ACIDIZE	<input type="checkbox"/>	SUBSEQUENT REPORT OF ABANDONMENT	
NOTICE OF INTENTION TO PULL OR ALTER CASING	<input type="checkbox"/>	SUPPLEMENTARY WELL HISTORY	
NOTICE OF INTENTION TO ABANDON WELL	<input type="checkbox"/>		

(INDICATE ABOVE BY CHECK MARK NATURE OF REPORT, NOTICE, OR OTHER DATA)

June 12th, 1958

Well No. 7-0 is located 1750 ft. from N line and 1800 ft. from E line of sec. 23
SW/4 NE/4 Sec. 23 26N 5W H.M.P.M.
 (1/4 Sec. and Sec. No.) (Twp.) (Range) (Meridian)
S. Blanco FC Int. Rio Arriba New Mexico
 (Field) (County or Subdivision) (State or Territory)

The elevation of the derrick floor above sea level is 6629 ft.

DETAILS OF WORK

(State names of and expected depths to objective sands; show sizes, weights, and lengths of proposed casings; indicate mudding jobs, cementing points, and all other important proposed work)

Pictured Cliffs Sand test. Estimated total depth 3300'.

Surface Casing: 90' of 8-5/8" OD 24# J-55 cemented to surface.
 Production " : Approximately 3300' of 5-1/2" OD 15.5# J-55 cemented with 100 sacks.

If commercial production is indicated, the producing zone will be sand-water fractured.



I understand that this plan of work must receive approval in writing by the Geological Survey before operations may be commenced.

Company EL PASO NATURAL GAS COMPANY

Address Box 997
Farmington, New Mexico

By [Signature]
 Title Petroleum Engineer

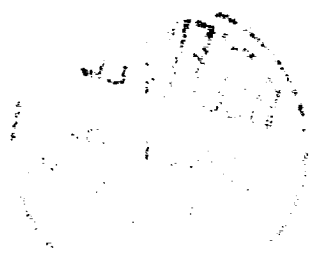

NEW MEXICO OIL CONSERVATION COMMISSION
Well Location and Acreage Dedication Plat

Section A.

Date June 12th, 1958

Operator EL PASO NATURAL GAS COMPANY Lease JICARILLA APACHE
Well No. 7-G Unit Letter G Section 23 Township 26 NORTH Range 5 WEST NMPM
Located 1750 Feet From THE NORTH Line, 1800 Feet From THE EAST Line
County RIO ARriba G. L. Elevation 6621.7 Dedicated Acreage 160 Acres
Name of Producing Formation Pictured Cliffs Pool S. Blanco 1C Ext.

1. Is the Operator the only owner* in the dedicated acreage outlined on the plat below?
Yes No
2. If the answer to question one is "no," have the interests of all the owners been consolidated by communitization agreement or otherwise? Yes No . If answer is "yes," Type of Consolidation _____
3. If the answer to question two is "no," list all the owners and their respective interests below:
REF. GLO Plat dated: 4 November 1882

Owner

Land Description

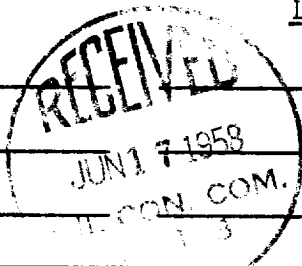

RECEIVED

JUN 16 1958

U. S. GEOLOGICAL SURVEY
FARMINGTON, NEW MEXICO

Section B

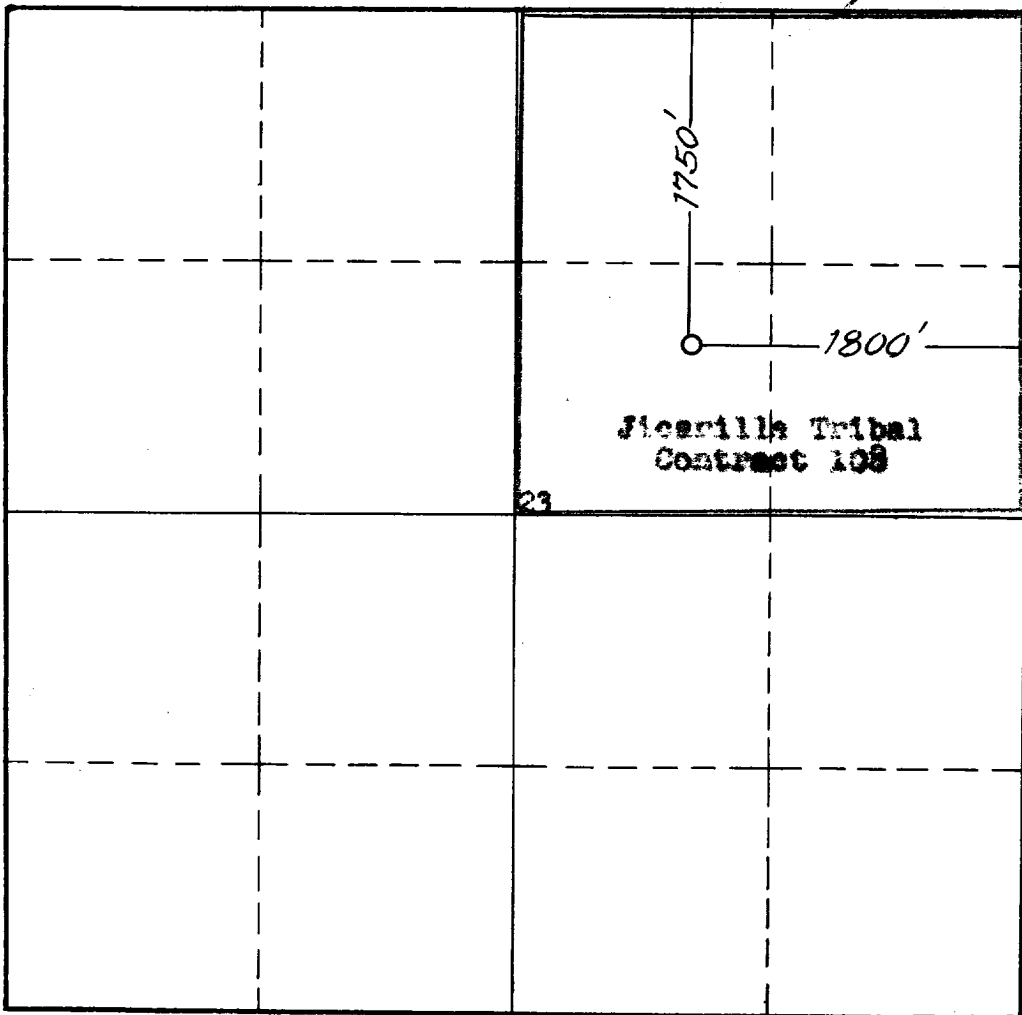

This is to certify that the information in Section A above is true and complete to the best of my knowledge and belief.

EL PASO NATURAL GAS COMPANY

(Operator)

D. C. Johnston

(Representative)

Box 307

Address Farmington, New Mexico

This is to certify that the well location shown on the plat in Section B was plotted from field notes of actual surveys made by me or under my supervision and that the same is true and correct to the best of my knowledge and belief.

Date Surveyed 11 June 1958

James P. Leese
Registered Professional Engineer and/or Land Surveyor.

JAMES P. LEESE

Certificate No. 1463



(See instructions for completing this form on the reverse side)

INSTRUCTIONS FOR COMPLETION:

1. Operator shall furnish and certify to the information called for in Section A.
2. Operator shall outline the dedicated acreage for both oil and gas wells on the plat in Section B.
3. A registered professional engineer or land surveyor registered in the State of New Mexico or approved by the Commission shall show on the plat the location of the well and certify this information in the space provided.
4. All distances shown on the plat must be from the outer boundaries of Section.
5. If additional space is needed for listing owners and their respective interests as required in question 3, Section A, please use space below

* "Owner" means the person who has the right to drill into and to produce from any pool and to appropriate the production either for himself or for himself and another. (65-3-29 (e) NMSA 1953 Comp.)