

Form 5-3-11a
1-1

Approved by _____
Date _____

SUBMIT IN TRIPlicate

Field Office **Santa Fe**

Lease No. **2-10-100**

Lessee **None**

UNITED STATES
DEPARTMENT OF THE INTERIOR
GEOLOGICAL SURVEY

SUNDRY NOTICES AND REPORTS ON WELLS

NOTICE OF INTENTION TO DRILL	20. SUBSEQUENT REPORT OF WATER SHUT OFF
NOTICE OF INTENTION TO CHANGE DEPTH	SUBSEQUENT REPORT OF GRADING OR ACIDIZING
NOTICE OF INTENTION TO STOP OR WATER SHUT OFF	SUBSEQUENT REPORT OF ALTERING CASING
NOTICE OF INTENTION TO RE-DRILL OR REPAIR WELL	SUBSEQUENT REPORT OF RE-DRILLING OR REPAIR
NOTICE OF INTENTION TO STOP WORK FOR A PERIOD	SUBSEQUENT REPORT OF ABANDONMENT
NOTICE OF INTENTION TO RE-DRILL AFTER CASING	SUPPLEMENTARY WELL HISTORY
NOTICE OF INTENTION TO ABANDON WELL	

INDICATE ABOVE BY CHECK MARK NATURE OF REPORT, NOTICE, OR OTHER DATA

19

Well No. **1-1** ^{Federal} is located **123** ft. from **IN** line and **541** ft. from **W** line of sec. **17**

1-1 sec. **17**

Elletts

2-10-100

(Well)

Rio Arriba

(County or Municipality)

804

(Meridian)

New Mexico

(State or Territory)

The elevation of the derrick floor above sea level is **7217** ft--est. (Ground level **7217**)

DETAILS OF WORK

(State names of and expected depths of objective sands, show sizes, weights, and lengths of proposed casings; indicate mudding jobs, cementing points, and all other important proposed work)

550' test for Base Dakota at lesser depth.

1. Set **30'** surface string (**10-3/4"**) and circulate to surface.
2. Cut **7-1/2"** hole from base surface string to T.B.
3. **7-1/2"** oil string if productive.
4. Commence drilling in Lewis Shale with est. top Dakota at **6100'**.
5. **11'** core & test Greenhorn lime and 1st Dakota Sand.

I understand that this plan of work must receive approval in writing by the Geological Survey before operation may be commenced.

Company **SANJOAQUIN OIL COMPANY**
Address **315 Mile High Center**
Denver, Colorado

By **James H. Briden**
Title **Chief Geologist**

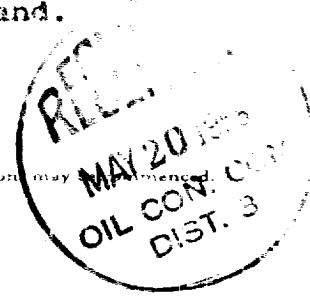

NEW MEXICO OIL CONSERVATION COMMISSION
Well Location and Acreage Dedication Plat

Section A.

Date May 14, 1958

Operator Texota Oil Company Lease SF 079288-C
Well No. 1-A Unit Letter Section 17 Township 26 North Range 1 East NMPM
Located 541 Feet From West Line, 1923 Feet From North Line
County San Arriba G. S. Elevation 7207' (U.S. Dedicated Acreage 50 40 Acres
Name of Producing Formation Dakota Sand G.S. Datum Pool Wildcat

1. Is the Operator the only owner* in the dedicated acreage outlined on the plat below?
Yes No X.
2. If the answer to question one is "no," have the interests of all the owners been consolidated by communitization agreement or otherwise? Yes No X. If answer is "yes," Type of Consolidation
3. If the answer to question two is "no," list all the owners and their respective interests below:

<u>Owner</u>	<u>Land Description</u>
<u>Texota Oil Company</u>	<u>50 %</u>
<u>Ambassador Oil Corporation</u>	<u>50 %</u>

Section B

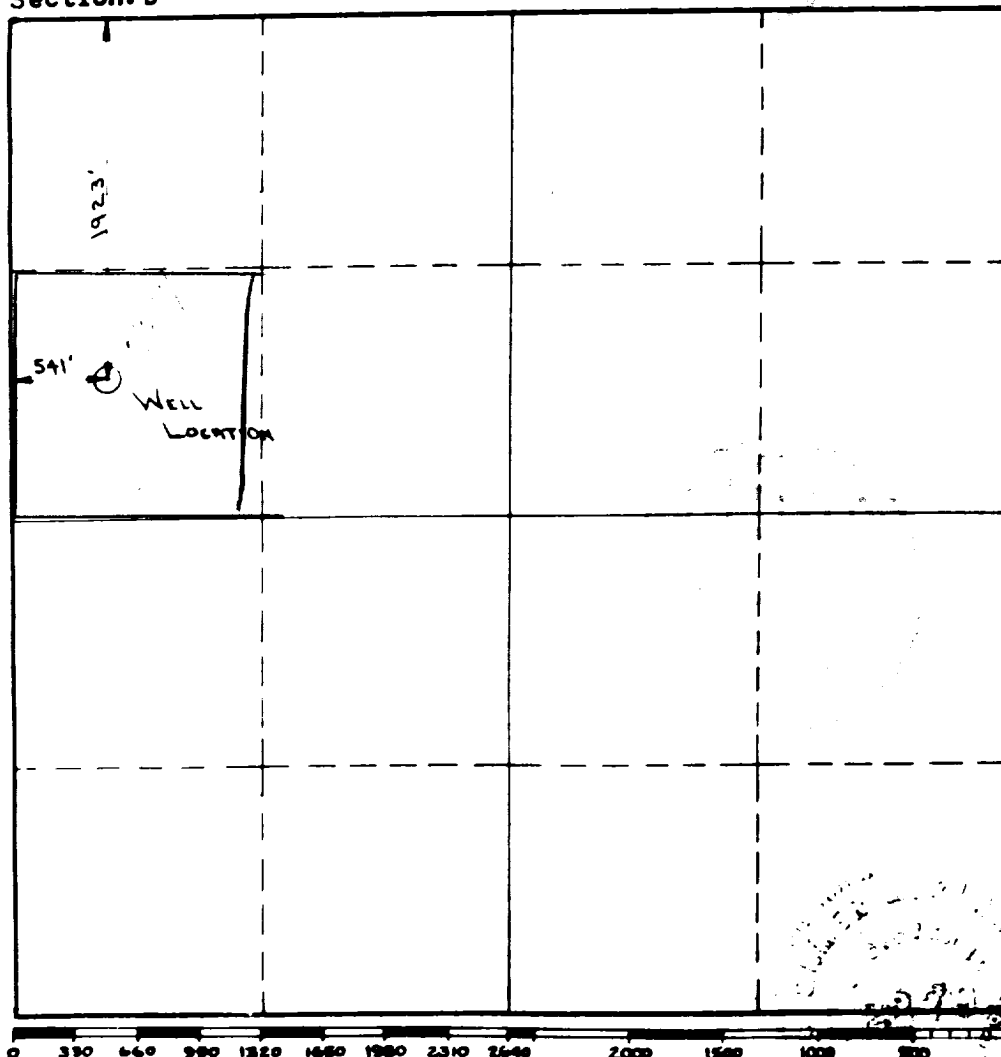

This is to certify that the information in Section A above is true and complete to the best of my knowledge and belief.

Texota Oil Company

(Operator)

John R. Rife
(Representative)

Denver 2, Colorado

Address
318 Mile High Center

This is to certify that the well location shown on the plat in Section B was plotted from field notes of actual surveys made by me or under my supervision and that the same is true and correct to the best of my knowledge and belief.

Date Surveyed February 8, 1958

Edmund M. Clark
Registered Professional
Engineer and/or Land Surveyor.

Certificate No. 2279
(See instructions for completing this form on the reverse side)(Colo. reg.)