

Form 9-331a
(Feb. 1951)

Land Office Santa Fe

(SUBMIT IN TRIPLICATE)

Lease No. 079160-A

Unit SE 1/4 Sec. 15

UNITED STATES
DEPARTMENT OF THE INTERIOR
GEOLOGICAL SURVEY

RECEIVED

FEB 13 1953

SUNDRY NOTICES AND REPORTS ON WELLS

GEOLOGICAL SURVEY
FARMINGTON, N. M.

NOTICE OF INTENTION TO DRILL	<input checked="" type="checkbox"/>	SUBSEQUENT REPORT OF WATER SHUT-OFF	
NOTICE OF INTENTION TO CHANGE PLANS		SUBSEQUENT REPORT OF SHOOTING OR ACIDIZING	
NOTICE OF INTENTION TO TEST WATER SHUT-OFF		SUBSEQUENT REPORT OF ALTERING CASING	
NOTICE OF INTENTION TO RE-DRILL OR REPAIR WELL		SUBSEQUENT REPORT OF REDRILLING OR REPAIR	
NOTICE OF INTENTION TO SHOOT OR ACIDIZE		SUBSEQUENT REPORT OF ABANDONMENT	
NOTICE OF INTENTION TO PULL OR ALTER CASING		SUPPLEMENTARY WELL HISTORY	
NOTICE OF INTENTION TO ABANDON WELL			

(INDICATE ABOVE BY CHECK MARK NATURE OF REPORT, NOTICE, OR OTHER DATA)

February 10, 1953

Well No. Jenkins 3 is located 2310 ft. from XXX line and 990 ft. from E line of sec. 25

DOGIE CANYON Sec. and Sec. No. 26N. 7W. N.M.P.M.
 (Field) (Twp.) (Range) (Meridian)

Pictured Cliffs Rio Arriba New Mexico
 (Field) (County or Subdivision) (State or Territory)

The elevation of the derrick floor above sea level is 6140 ft.

DETAILS OF WORK

(State names of and expected depths to objective sands; show sizes, weights, and lengths of proposed casings; indicate mudding jobs, cementing points, and all other important proposed work)

Proposed Pictured Cliffs ss. location. Operator to drill to total depth of approx. 3300 ft. and complete well in Pictured Cliffs ss. Will set approx. 100 ft. of 10 3/4" surface cas. with cement. Will set approx. 2240 ft. of 5 1/2" production string with 200 sacks of cement.

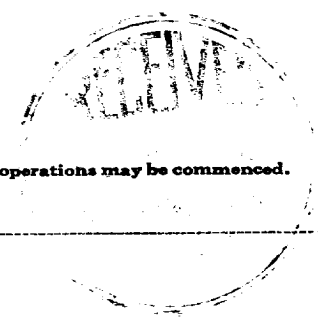

I understand that this plan of work must receive approval in writing by the Geological Survey before operations may be commenced.

Company Kingley-Locke Oil Company

Address 1400 Labor Tower

Phoenix, Arizona

By F. C. Barber

Title Geologist

RECEIVED

FEB 12 1953
U. S. GEOLOGICAL SURVEY
FARMINGTON, N. M.

Company Kingsley-Locke Oil Company

Lease Jeckius - Fed. Well No. 3

Sec. 15, T. 26 N., R. 7 W., N.M.P.M.

Location 2310' from the South line and 990' from the East line.

Elevation 6134 Ungraded ground.

Rio Arriba County

New Mexico

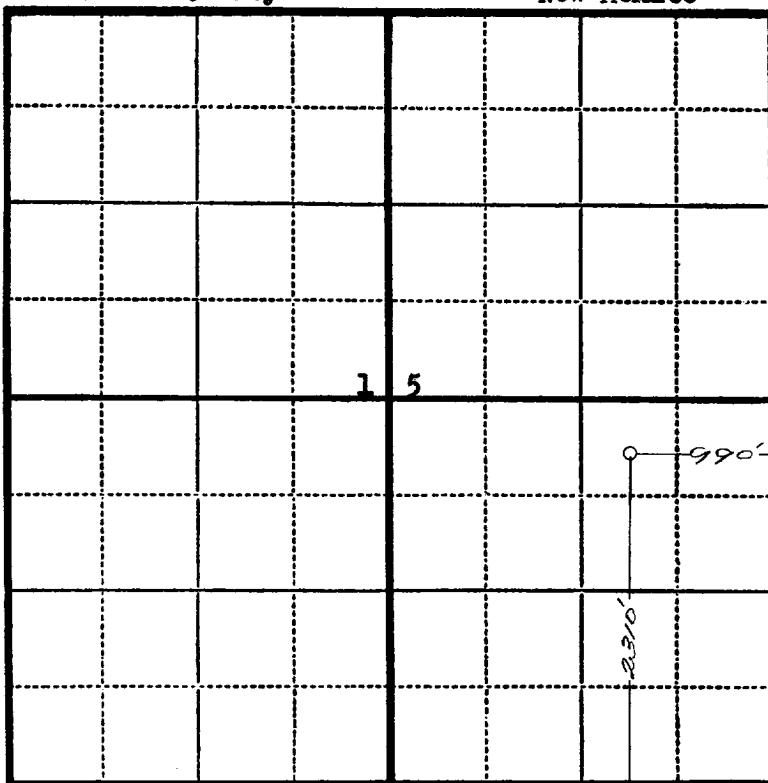

N



Scale—4 inches equal 1 mile.

This is to certify that the above plat was prepared from field notes of actual surveys made by me or under my supervision and that the same are true and correct to the best of my knowledge and belief.

Charles J. Finklea

Seal:

Registered Professional
Engineer and Land Surveyor.

Charles J. Finklea
N. Mex. Reg. No. 1302

Surveyed February 1, 1953