

(SUBMIT IN TRIPLICATE)

UNITED STATES
DEPARTMENT OF THE INTERIOR
GEOLOGICAL SURVEYLand Office Santa Fe
Lease No. 079184
Unit _____Breach "C"
RECEIVED

SUNDRY NOTICES AND REPORTS ON WELLS

NOTICE OF INTENTION TO DRILL	<input checked="" type="checkbox"/>	SUBSEQUENT REPORT OF WATER SHUT-OFF	
NOTICE OF INTENTION TO CHANGE PLANS		SUBSEQUENT REPORT OF SHOOTING OR ACIDIZING	
NOTICE OF INTENTION TO TEST WATER SHUT-OFF		SUBSEQUENT REPORT OF ALTERING CASING	
NOTICE OF INTENTION TO RE-DRILL OR REPAIR WELL		SUBSEQUENT REPORT OF RE-DRILLING OR REPAIR	
NOTICE OF INTENTION TO SHOOT OR ACIDIZE		SUBSEQUENT REPORT OF ABANDONMENT	
NOTICE OF INTENTION TO PULL OR ALTER CASING		SUPPLEMENTARY WELL HISTORY	
NOTICE OF INTENTION TO ABANDON WELL			

(INDICATE ABOVE BY CHECK MARK NATURE OF REPORT, NOTICE, OR OTHER DATA)

June 2, 1962

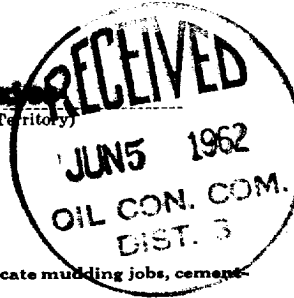
Well No. D-389 is located 1690 ft. from XX line and 1190 ft. from XX line of sec. 13SW 1/4 Section 13
(1/4 Sec. and Sec. No.)26 North 6 West
(Twp.) (Range)106PM
(Meridian)Basin Dakota
(Field)Rio Arriba
(County or Subdivision)New Mexico
(State or Territory)The elevation of the derrick floor above sea level is 6726 ft.

DETAILS OF WORK

(State names of and expected depths to objective sands; show sizes, weights, and lengths of proposed casings; indicate mudding jobs, cementing points, and all other important proposed work)

We proposed to mud drill with rotary equipment to approximately 7790' to test the Dakota formation. The following casing and cementing program will be used:

10-3/4" 32.75# H-40 Seamless Casing to 250' cemented top to bottom
5 1/2" OD 15.5# J-55 Seamless casing from 0 to 6790 approximately and
5 1/2" OD 17.0# J-55 Seamless casing from 6790 to approximately 7790'.
The 5 1/2" casing will be cemented with 200 sacks around the shoe and with
100 sacks thru a multiple stage cementing collar at approximately 3250'.

Casing will be perforated in the Dakota sand and the well sand/water fractured to obtain the best possible completion.

I understand that this plan of work must receive approval in writing by the Geological Survey before operations may be commenced.

Company Caulkins Oil CompanyAddress Box 780Farmington, New MexicoBy Frank GrayTitle Superintendent

NEW MEXICO OIL CONSERVATION COMMISSION **Well Location and Acreage Dedication Plat**

SECTION A.Date June 2, 1962

Operator Caulkins Oil Company Lease Breesh "C"
 Well No. D-389 Unit Letter L Section 13 Township 26 North Range 6 West NMPM
 Located 1650 Feet From South Line, 1190 Feet From West Line
 County Rio Arriba G. L. Elevation 6714 Dedicated Acreage 320 Acres
 Name of Producing Formation Dakota Pool Basin Dakota

1. Is the Operator the only owner* in the dedicated acreage outlined on the plat below? Yes No X
2. If the answer to question One is "No," have the interests of all the owners been consolidated by communitization agreement or otherwise? Yes X No If answer is "Yes," Type of Consolidation Communitization agreement
3. If the answer to question Two is "No," list all the owners and their respective interests below:

OWNER

LAND DESCRIPTION

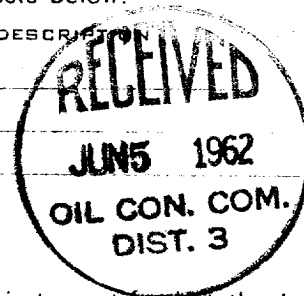
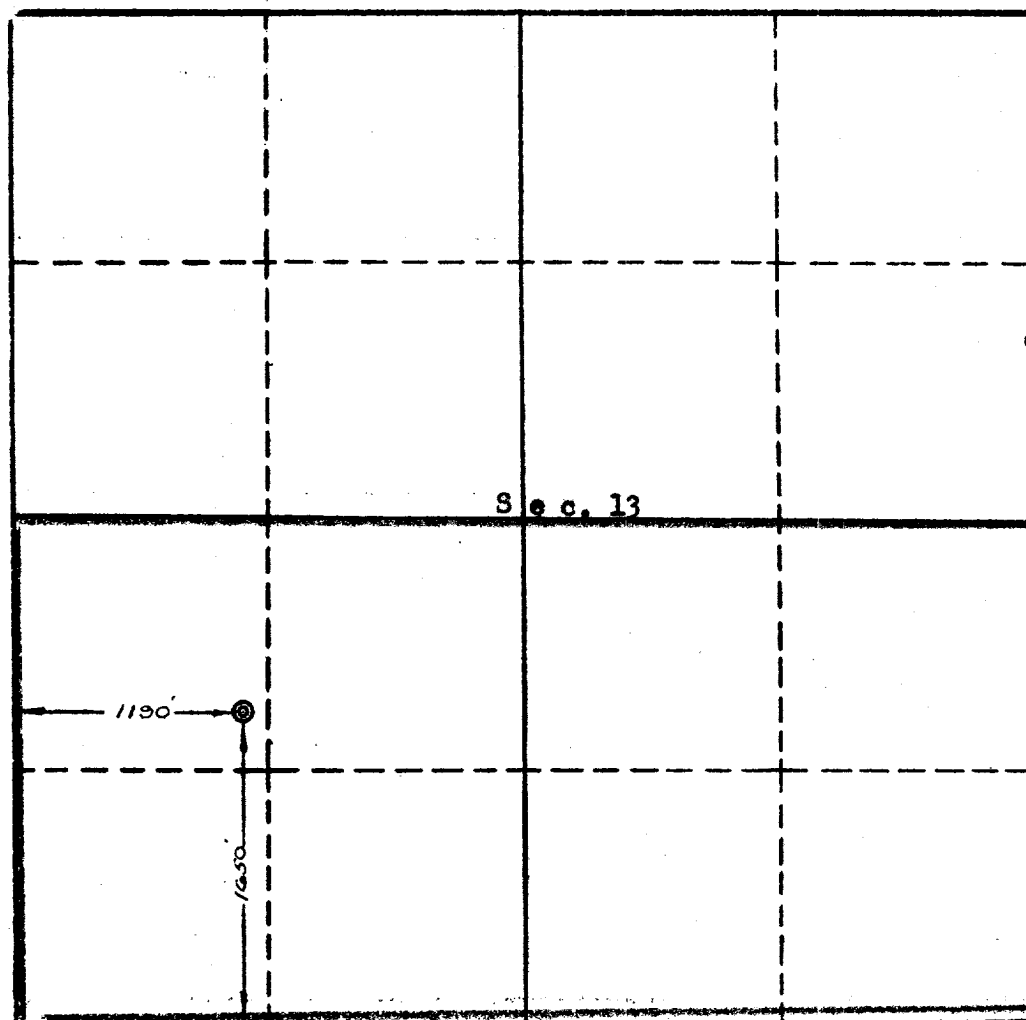
SECTION B.

This is to certify that the information in Section A above is true and complete to the best of my knowledge and belief.

Caulkins Oil Company
 (OPERATOR)

Frank Gray
 (REPRESENTATIVE)

Box 780, Farmington, N. Mex.
 (ADDRESS)

This is to certify that the well location shown on the plat in Section B was plotted from field notes of actual surveys made by me or under my supervision and that the same is true and correct to the best of my knowledge and belief.

Date Surveyed May 31, 1962

Four States Engineering Co.
 FARMINGTON, NEW MEXICO

Ernest V. Capshaw
 REGISTERED ENGINEER OR
 LAND SURVEYOR

Certificate No. 3602

