

(SUBMIT IN TRIPLICATE)

UNITED STATES
DEPARTMENT OF THE INTERIOR
GEOLOGICAL SURVEY

Land Office Julia

Lease No. Jicarilla Cont. 110

Unit new half of sec. 18

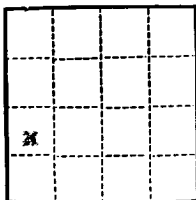

SUNDRY NOTICES AND REPORTS ON WELLS

NOTICE OF INTENTION TO DRILL.....	<input checked="" type="checkbox"/>	SUBSEQUENT REPORT OF WATER SHUT-OFF.....	
NOTICE OF INTENTION TO CHANGE PLANS.....		SUBSEQUENT REPORT OF SHOOTING OR ACIDIZING.....	
NOTICE OF INTENTION TO TEST WATER SHUT-OFF.....		SUBSEQUENT REPORT OF ALTERING CASING.....	
NOTICE OF INTENTION TO RE-DRILL OR REPAIR WELL.....		SUBSEQUENT REPORT OF RE-DRILLING OR REPAIR.....	
NOTICE OF INTENTION TO SHOOT OR ACIDIZE.....		SUBSEQUENT REPORT OF ABANDONMENT.....	
NOTICE OF INTENTION TO PULL OR ALTER CASING.....		SUPPLEMENTARY WELL HISTORY.....	
NOTICE OF INTENTION TO ABANDON WELL.....			

(INDICATE ABOVE BY CHECK MARK NATURE OF REPORT, NOTICE, OR OTHER DATA)

October 10, 1961

Jicarilla
Well No. 2 is located 1820 ft. from S line and 1130 ft. from E line of sec. 18

20 1/4 sec. 18 T-26-N R-5-E 107N
(1/4 Sec. and Sec. No.) (Twp.) (Range) (Meridian)
Basin Dakota Rio Arriba New Mexico
(Field) (County or Subdivision) (State or Territory)

The elevation of the ~~derrick floor~~ ^{ground level} above sea level is 6399 ft.

DETAILS OF WORK

(State names of and expected depths to objective sands; show sizes, weights, and lengths of proposed casings; indicate mudding jobs, cementing points, and all other important proposed work)

We propose to drill with rotary tools using mud and water to 3200', set intermediate string and drill to base of Dakota using gas to approximately 770'; set pipe thru, perforate and sand-water frac for Dakota completion.

Proposed Casing Program:

200' - 10-3/4" 32.75 11-40 cement to surface
3200' - 7-5/8" 26.40 J-55 200 sacks cement
7700' - 4-1/2" OD J-55 11.00 & 10.50 340 sacks cement
7700' - 2-3/8" 4.70 J-55 tubing

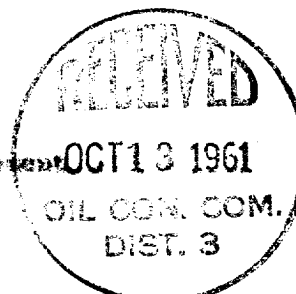

I understand that this plan of work must receive approval in writing by the Geological Survey before operations may be commenced.

Company BEHL-TAYLOR OIL CORPORATION

Address P. O. Drawer 1198

Permiotown, New Mexico

By G. T. Hingmuth

Title District Supt.

NEW MEXICO OIL CONSERVATION COMMISSION

Well Location and Acreage Dedication Plat

Section A.

Date October 10, 1961

Operator DELHI TAYLOR OIL CORPORATION Lease Jicarilla #2
 Well No. _____ Unit Letter L Section 18 Township 26 NORTH Range 5 WEST NMPM
 Located 1820 Feet From the SOUTH Line, 1130 Feet From the WEST Line
 County RIO ARriba G. L. Elevation 6599.0 Dedicated Acreage 320 W. 319.20 Acres
 Name of Producing Formation Dakota Pool Basin Dakota

1. Is the Operator the only owner in the dedicated acreage outlined on the plat below?
 Yes X No _____
2. If the answer to question one is "no", have the interests of all the owners been consolidated by communitization agreement or otherwise? Yes _____ No _____. If answer is "yes", Type of Consolidation.

3. If the answer to question two is "no", list all the owners and their respective interests below:

OwnerLand Description

Section B.

This is to certify that the information in Section A above is true and complete to the best of my knowledge and belief.

DELHI-TAYLOR OIL CORPORATION

(Operator)

G. D. Higginbotham
(Representative)P. O. Drawer 1198

(Address)

Farmington, New Mexico

Note: All distances must be from outer boundaries of section.

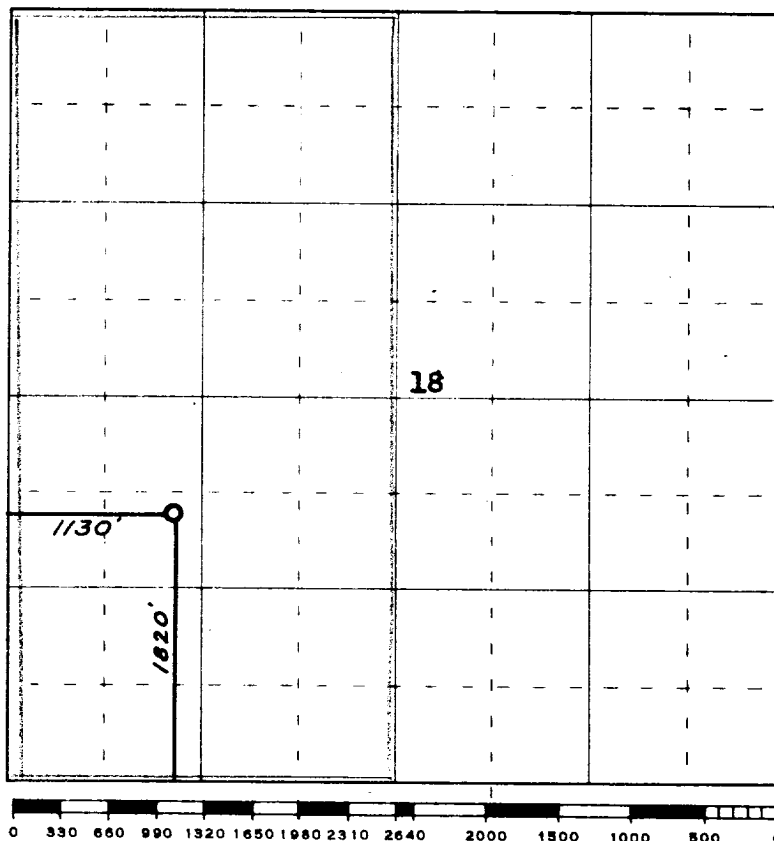

Scale 4 inches equal 1 mile

Ref: GLO plat dated 7 April 1881

This is to certify that the above plat was prepared from field notes of actual surveys made by me or under my supervision and that the same are true and correct to the best of my knowledge and belief.

Date Surveyed 6 October 1961

James P. Leese
 Registered Professional Engineer and/or Land Surveyor
 James P. Leese N. Mex. Reg. No. 1463

