

(SUBMIT IN TRIPLICATE)

Indian Agency Jicarilla
Apache
Allottee Contract #99
Lease No. Jicarilla "D"

UNITED STATES
DEPARTMENT OF THE INTERIOR
GEOLOGICAL SURVEY

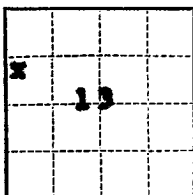

SUNDRY NOTICES AND REPORTS ON WELLS

NOTICE OF INTENTION TO DRILL	<input checked="" type="checkbox"/>	SUBSEQUENT REPORT OF WATER SHUT-OFF	
NOTICE OF INTENTION TO CHANGE PLANS		SUBSEQUENT REPORT OF SHOOTING OR ACIDIZING	
NOTICE OF INTENTION TO TEST WATER SHUT-OFF		SUBSEQUENT REPORT OF ALTERING CASING	
NOTICE OF INTENTION TO REDRILL OR REPAIR WELL		SUBSEQUENT REPORT OF REDRILLING OR REPAIR	
NOTICE OF INTENTION TO SHOOT OR ACIDIZE		SUBSEQUENT REPORT OF ABANDONMENT	
NOTICE OF INTENTION TO PULL OR ALTER CASING		SUPPLEMENTARY WELL HISTORY	
NOTICE OF INTENTION TO ABANDON WELL			

(INDICATE ABOVE BY CHECK MARK NATURE OF REPORT, NOTICE, OR OTHER DATA)

July 14, 1961

Well No. #9 is located 1650 ft. from N line and 990 ft. from W line of sec. 13

NW/4 Sec. 13 (1/4 Sec. and Sec. No.)
26N (Twp.)
3W (Range)
NMPM (Meridian)
Gavilan Pictured Cliffs (Field)
Rio Arriba (County or Subdivision)
New Mexico (State or Territory)

Grd. level

The elevation of the ~~surface~~ above sea level is 7227 ft.

DETAILS OF WORK

(State names of and expected depths to objective sands; show sizes, weights, and lengths of proposed casings; indicate mudding jobs, cementing points, and all other important proposed work)

1. Drill 10-3/4" hole to 325' & cement 7-5/8" csg. w/+ 125 sax (Circulate cement to surface). W.O.C. for 18 hrs. and press. test csg. w/600 psi for 30 min.
2. Drill 6-3/4" hole to 3905' T.D.
3. Cement 2-7/8" csg. @ 3905' w/125 sax. Run temp. survey within 24 hrs. W.O.C. for 18 hrs. & press. test csg. w/1500 psi for 30 mins.
4. Perf. est. 50' of Pictured Cliffs sands and sd-water frac w/est. 1000 wale. treated water & 1000# SAND per foot perfid.
5. Clean well up and put on production.

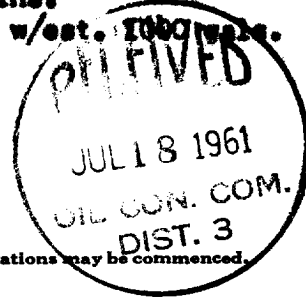

I understand that this plan of work must receive approval in writing by the Geological Survey before operations may be commenced.

Company Socony Mobil Oil Co., Inc.

Address P. O. Box 3371
Durango, Colorado

By F. W. Barry
Title Dist. Prod. Supt.

NUMBER OF COPIES RECEIVED	
DISTRIBUTION	
STATE PL	
FILE	
U.S.S.	
LAND OFFICE	
TRANSPORTER	OIL GAS
PRODUCTION OFFICE	
OPERATOR	

NEW MEXICO OIL CONSERVATION COMMISSION
WELL LOCATION AND ACREAGE DEDICATION PLAT
 SEE INSTRUCTIONS FOR COMPLETING THIS FORM ON THE REVERSE SIDE

FORM C-128
 Revised 5/1/57

SECTION A

Operator Socony Mobil Oil Company, Inc.		Lease Jicarilla "D"		Well No. 9
Unit Letter E	Section 13	Township 26N	Range 3W	County Rio Arriba
Actual Footage Location of Well: 1650 feet from the North line and 990 feet from the West line				
Ground Level Elev. 7227'	Producing Formation Pictured Cliffs	Pool Gavilan	Dedicated Acreage: 160 Acres	

1. Is the Operator the only owner in the dedicated acreage outlined on the plat below? YES ☒ NO ☐ ("Owner" means the person who has the right to drill into and to produce from any pool and to appropriate the production either for himself or for himself and another. (65-3-29 (e) NMSA 1935 Comp.)
2. If the answer to question one is "no," have the interests of all the owners been consolidated by communization, pooling or otherwise? YES ☐ NO ☐ . If answer is "yes," Type of Consolidation _____
3. If the answer to question two is "no," list all the owners and their respective interests below:

Owner Socony Mobil Oil Company, Inc.	Land Description NW $\frac{1}{4}$ Sec. 13
---	--

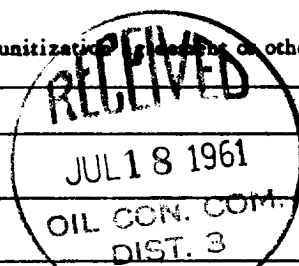

SECTION B

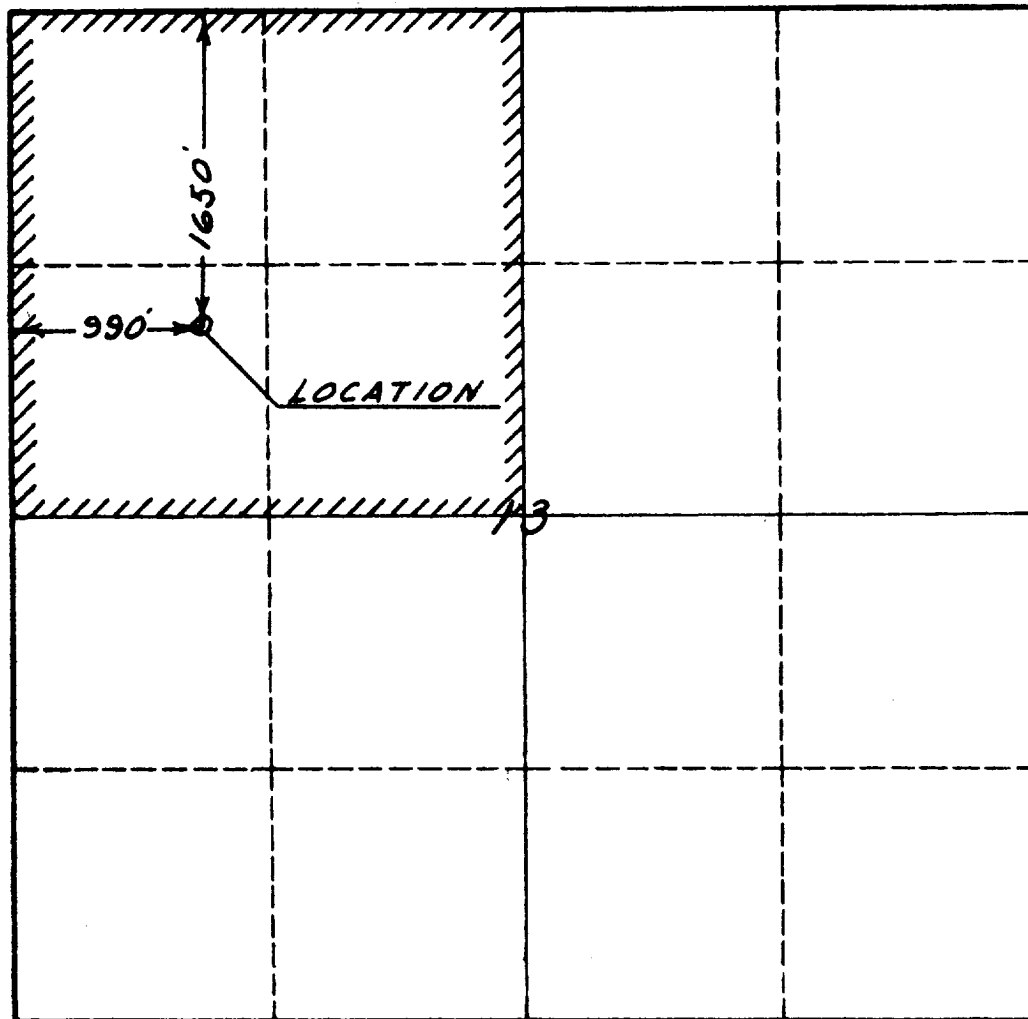

CERTIFICATION

I hereby certify that the information in SECTION A above is true and complete to the best of my knowledge and belief.

Name <i>P.M. Barry</i>
Position Dist. Prod. Supt.
Company Socony Mobil Oil Co., Inc.
Date 7/12/61

I hereby certify that the well location shown on the plat in SECTION B was plotted from field notes of actual surveys made by me or under my supervision, and that the same is true and correct to the best of my knowledge and belief.

Date Surveyed 7/11/61
Registered Professional Engineer and/or Land Surveyor

Robert L. Graham
 Certificate No.
 LS 3330

0 330 660 990 1320 1650 1980 2310 2640 2000 1500 1000 500 0