

(SUBMIT IN TRIPLICATE)

Indian Agency **Jicarilla Tribal**Contract # **99, Tr. 190**UNITED STATES
DEPARTMENT OF THE INTERIOR
GEOLOGICAL SURVEY

Allottee _____

Lease No. **Jicarilla "D"**

		03

SUNDRY NOTICES AND REPORTS ON WELLS

NOTICE OF INTENTION TO DRILL	<input checked="" type="checkbox"/>	SUBSEQUENT REPORT OF WATER SHUT-OFF	
NOTICE OF INTENTION TO CHANGE PLANS		SUBSEQUENT REPORT OF SHOOTING OR ACIDIZING	
NOTICE OF INTENTION TO TEST WATER SHUT-OFF		SUBSEQUENT REPORT OF ALTERING CASING	
NOTICE OF INTENTION TO REDRILL OR REPAIR WELL		SUBSEQUENT REPORT OF REDRILLING OR REPAIR	
NOTICE OF INTENTION TO SHOOT OR ACIDIZE		SUBSEQUENT REPORT OF ABANDONMENT	
NOTICE OF INTENTION TO PULL OR ALTER CASING		SUPPLEMENTARY WELL HISTORY	
NOTICE OF INTENTION TO ABANDON WELL			

(INDICATE ABOVE BY CHECK MARK NATURE OF REPORT, NOTICE, OR OTHER DATA)

May 29, 1957

Jicarilla "D"

Well No. **3** is located **990** ft. from **[N]** line and **990** ft. from **[E]** line of sec. **13**N4, N4, Section 13
(1/4 Sec. and Sec. No.)26 N
(Twp.)3-E
(Range)N.M.P.M.
(Meridian)Blanco
(Field)Rio Arriba
(County or Subdivision)New Mexico
(State or Territory)The elevation of the derrick floor above sea level is **7100** ft.

DETAILS OF WORK

(State names of and expected depths to objective sands; show sizes, weights, and lengths of proposed casings; indicate mudding jobs, cementing points, and all other important proposed work)

We propose to drill the above well to a Total Depth of 6300' with Rotary Tools. We expect to test the following zones at the following approximate depths if indicative of oil or gas show:

SAND
Pictured Cliffs
Mesa Verde

EXPECTED TOP
3600'
6300'

We expect to test any other zones that appear productive of oil or gas. **CASING PROGRAM:** Approximately 300' of 10-1/4" Surface Casing w/approximately 300 sz cement, approximately 4200' of 7-5/8" intermediate casing w/approximately 150 sz cement, approximately 2300' of 5 1/2" liner w/approximately 200 sz cement on bottom and will squeeze top of liner w/approximately 200 sz cement. We propose to perforate and sandwaterfree productive zones in the Pictured Cliffs and Mesa Verde zones for completion.

I understand that this plan of work must receive approval in writing by the Geological Survey before operations may be commenced.

Company **Magnolia Petroleum Company**Address **Box 633**
Midland, TexasBy **G. T. Gorman**
G. T. GORMAN
Title **Division Superintendent**



**NEW MEXICO
OIL CONSERVATION COMMISSION**

Form C-128

Well Location and/or Gas Proration Plat

Date Mar 27, 1957

Operator MAGNOLIA PETROLEUM COMPANY Lease JICARILLA "D"

Well No. Three (3) Section 13 Township 29N Range 34 NMPM

Located 990 Feet From North Line, 990 Feet From East Line,

Rio Arriba County, New Mexico.

G. L. Elevation 7298
Undesignated Pictured

Name of Producing Formation Pictured Cliffs Pool Cliffs Gas Dedicated Acreage 160

(Note: All distances must be from outer boundaries of Section)

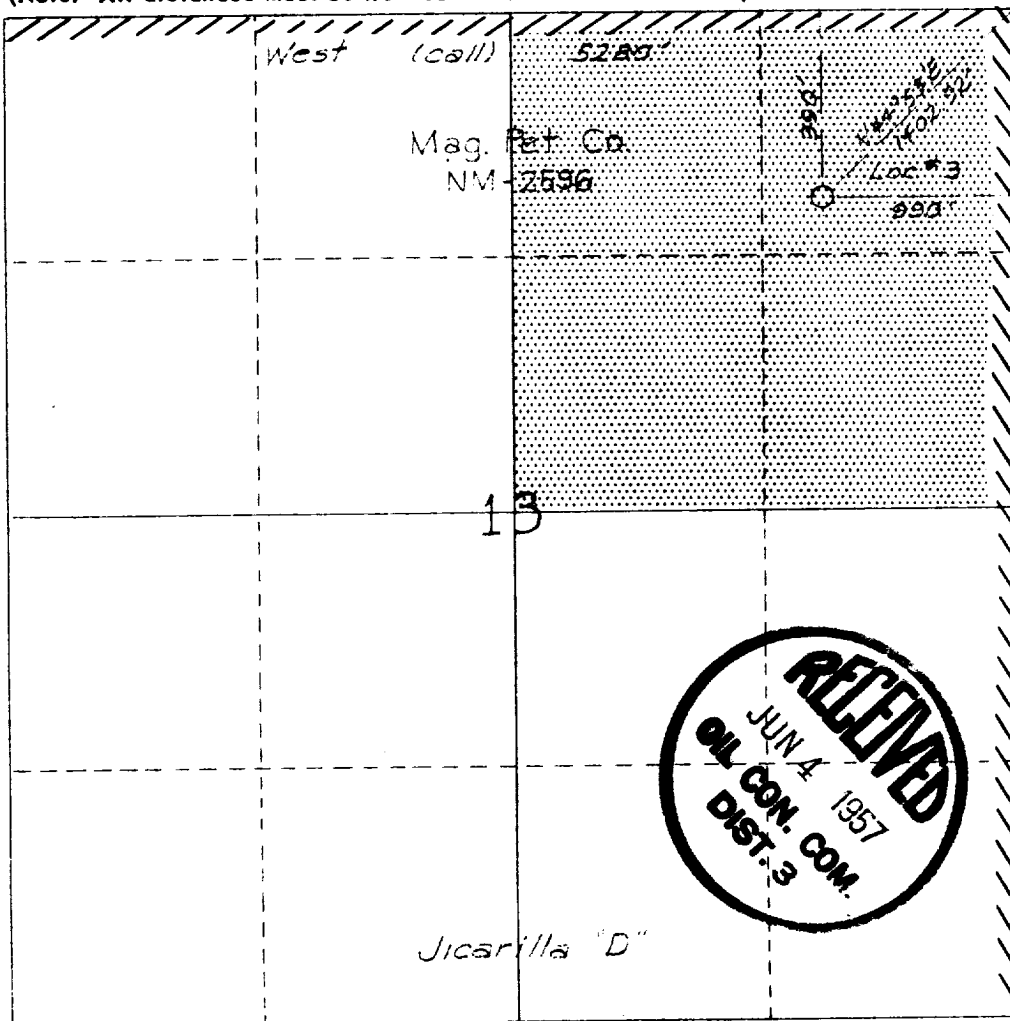

Scale: 1" = 1000'

LEGEND

Lease Boundary

Allocated Acreage

1. Is this Well a Dual Comp.? Yes X No.

2. If the answer to Question 1 is yes, are there any other dually completed wells within the dedicated acreage?

Yes No X

This is to certify that the above plat was prepared from field notes of actual surveys made by me or under my supervision and that the same are true and correct to the best of my knowledge and belief.

Name Carl E. Turner
Position R.T. GERMAN, Division Superintendent
Representing Magnolia Petroleum Company
Address Box 633 - Midland, Texas

Date Surveyed March 23, 1957

Carl E. Turner
Registered Professional Engineer and/or Land Surveyor
#2490

NEW MEXICO
OIL CONSERVATION COMMISSION

Form C-128

Well Location and/or Gas Proration Plat

Date May 27, 1957

Operator MAGNOLIA PETROLEUM COMPANY Lease JICARILLA "D"
Well No. Three (3) Section 13 Township 26N Range 3W NMPM
Located 990 Feet From North Line, 990 Feet From East Line,
Rio Arriba County, New Mexico. G. L. Elevation 7208
Name of Producing Formation Mesa Verde Pool Blanco Dedicated Acreage 320

(Note: All distances must be from outer boundaries of Section)

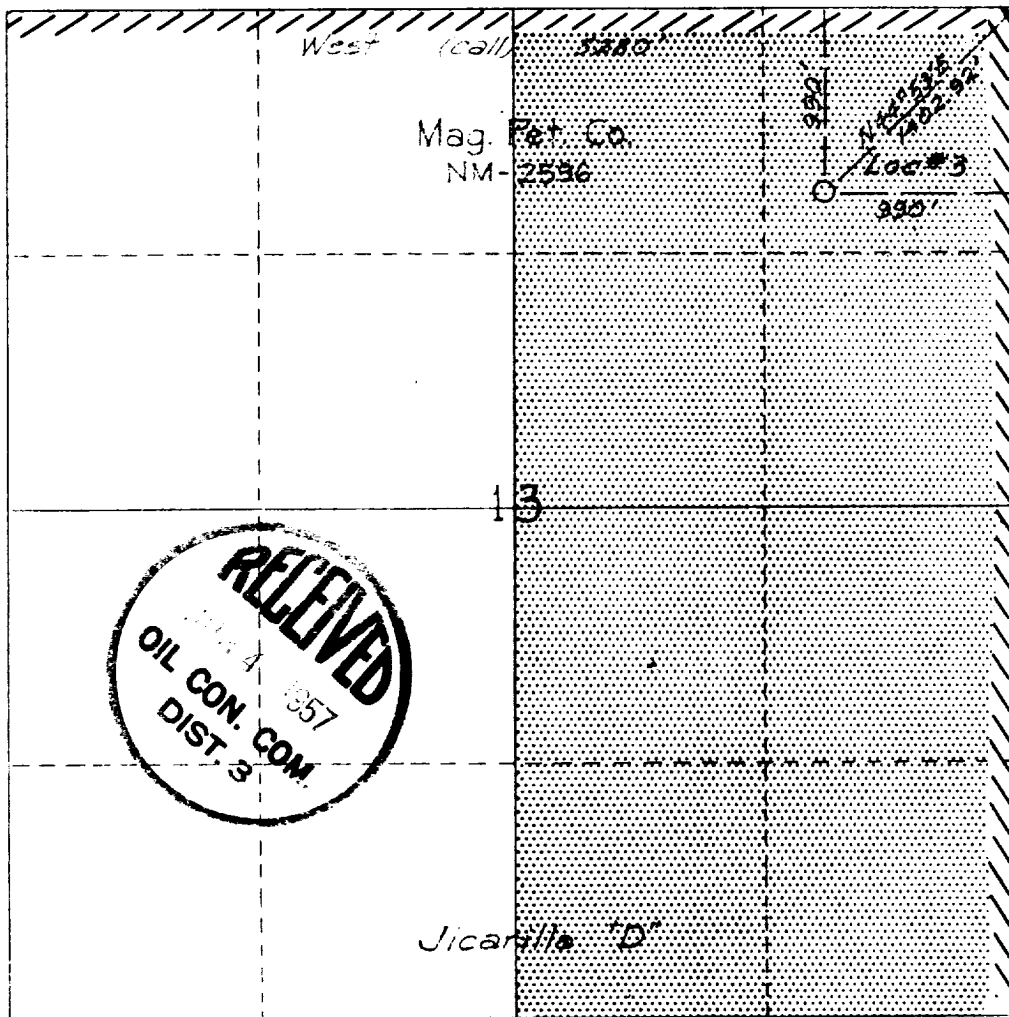

Scale: 1" = 1000'

LEGEND

Lease
Boundary

Allocated
Acreage

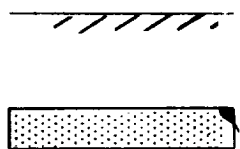

1. Is this Well a Dual Comp.? Yes X No. _____.

2. If the answer to Question 1 is yes, are there any other
dually completed wells within the dedicated acreage?
Yes _____ No X.

Name R. T. German
Position R. T. GERMAN, Division Superintendent
Representing Magnolia Petroleum Company
Address Box 633 - Midland, Texas

This is to certify that the above plat was prepared from
field notes of actual surveys made by me or under my
supervision and that the same are true and correct to the
best of my knowledge and belief.

Date Surveyed March 23, 1957

Carl E. Turner
Registered Professional Engineer and/or Land Surveyor
#2495