

COPY FOR
STATE OF NEW MEXICO
OIL CONSERVATION
COMMISSION
SUBMIT IN TRIPLICATE TO
DISTRICT OFFICE

UNITED STATES
DEPARTMENT OF THE INTERIOR
GEOLOGICAL SURVEY

Land Office **E-291-25**

Lease No. _____

Unit _____



SUNDRY NOTICES AND REPORTS ON WELLS

NOTICE OF INTENTION TO DRILL.....	<input checked="" type="checkbox"/>	SUBSEQUENT REPORT OF WATER SHUT-OFF.....	
NOTICE OF INTENTION TO CHANGE PLANS.....		SUBSEQUENT REPORT OF SHOOTING OR ACIDIZING.....	
NOTICE OF INTENTION TO TEST WATER SHUT-OFF.....		SUBSEQUENT REPORT OF ALTERING CASING.....	
NOTICE OF INTENTION TO RE-DRILL OR REPAIR WELL.....		SUBSEQUENT REPORT OF REDRILLING OR REPAIR.....	
NOTICE OF INTENTION TO SHOOT OR ACIDIZE.....		SUBSEQUENT REPORT OF ABANDONMENT.....	
NOTICE OF INTENTION TO PULL OR ALTER CASING.....		SUPPLEMENTARY WELL HISTORY.....	
NOTICE OF INTENTION TO ABANDON WELL.....			

(INDICATE ABOVE BY CHECK MARK NATURE OF REPORT, NOTICE, OR OTHER DATA)

October 9, 1951

Well No. **5-235** is located **990** ft. from **N** line and **1800** ft. from **E** line of sec. **16**.
NE 1/4 **T26N** **R6W** **N.M.P.M.**
(1/4 Sec. and Sec. No.) (Twp.) (Range) (Meridian)
Wildest **Rio Arriba** **New Mexico**
(Field) (County or Subdivision) (State or Territory)

The elevation of the derrick floor above sea level is _____ ft. (to be furnished later)

DETAILS OF WORK

(State names of and expected depths to objective sands; show sizes, weights, and lengths of proposed casings; indicate muddling jobs, cementing points, and all other important proposed work)

It is intended to drill with rotary tools to approximately 3000' to test the Pictured Cliffs formation.

Location made 1800' from the east line of Section 16 due to rough terrain.

CASING PROGRAM:

500' of 8-5/8" casing with 350 sacks of cement. To be circulated.
Approximately 3000' of 5-1/2" casing with 250 sacks of cement.

I understand that this plan of work must receive approval in writing by the Geological Survey before operations may be commenced.

Company **Lowry et al Operating Account**

Address **Room 213, 616 E. Central Ave.**

Albuquerque, New Mexico

By

Title **General Superintendent**



Company T. G. Lowry, Et. Al.

Lease State Well No. 5-235

Sec. 16 T. 26 N., R. 6 W., N.M.P.M.

Location 990' from the North line and 1800'
from the East line.

Rio Arriba County New Mexico

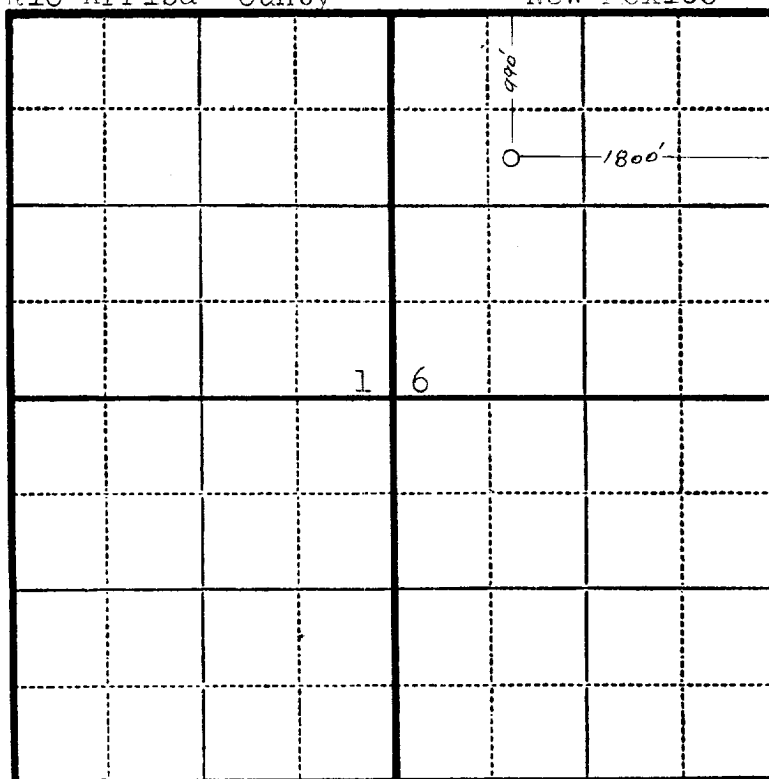

N

Scale—4 inches equals 1 mile.

This is to certify that the above plat was prepared from field notes of actual surveys made by me or under my supervision and that the same are true and correct to the best of my knowledge and belief.

Seal:

Registered Professional
Engineer and Land Surveyor.

Charles J. Finklea
N. Mex. Reg. No. 1302

Surveyed September 28, 1951.