

Section 12

(SUBMIT IN TRIPLICATE)

Indian Agency Jicarilla Tribal

Contr. #96, Trust 185

UNITED STATES
DEPARTMENT OF THE INTERIOR
GEOLOGICAL SURVEY

Allottee _____

Lease No. Jicarilla #14

SUNDRY NOTICES AND REPORTS ON WELLS

NOTICE OF INTENTION TO DRILL	<input checked="" type="checkbox"/>	SUBSEQUENT REPORT OF WATER SHUT-OFF	
NOTICE OF INTENTION TO CHANGE PLANS		SUBSEQUENT REPORT OF SHOOTING OR ACIDIZING	
NOTICE OF INTENTION TO TEST WATER SHUT-OFF		SUBSEQUENT REPORT OF ALTERING CASING	
NOTICE OF INTENTION TO REDRILL OR REPAIR WELL		SUBSEQUENT REPORT OF REDRILLING OR REPAIR	
NOTICE OF INTENTION TO SHOOT OR ACIDIZE		SUBSEQUENT REPORT OF ABANDONMENT	
NOTICE OF INTENTION TO PULL OR ALTER CASING		SUPPLEMENTARY WELL HISTORY	
NOTICE OF INTENTION TO ABANDON WELL			

(INDICATE ABOVE BY CHECK MARK NATURE OF REPORT, NOTICE, OR OTHER DATA)

June 25,

RECEIVED
JUN 27 1958Well No. 8 is located 990 ft. from SW line and 990 ft. from W line of sec. 12SW 1/4 Sec. 12
(1/4 Sec. and Sec. No.)26N
(Twp.)3W
(Range)N.M.P.M.
(Meridian)Blanco M.V. & Undesig. P.C.
(Field)Rio Arriba
(County or Subdivision)New Mexico
(State or Territory)The elevation of the derrick floor above sea level is 7208 ft. OL

DETAILS OF WORK

(State names of and expected depths to objective sands; show sizes, weights, and lengths of proposed casings; indicate mudding jobs, cementing points, and all other important proposed work)

We propose to drill the above well to a total depth of 6200' w/rotary tools. We expect to test the following zones at the following approximate depths.

Sand
Pictured Cliffs
Mesa VerdeExpected Top
3630'
5430'

We expect to test any other zone which appear productive of oil or gas.

CASING PROGRAM: Propose to set approx. 350' of 10-3/4" Surface Cag. w/approx. 300 sks. cement. To set approx. 4100' of 7-5/8" intermediate Cag. w/approx 200 sks. cement. To set approx. 2200' of 5-1/2" liner on bottom @ 6300' w/approx 200 sks. cement on bottom and will squeeze top of 5-1/2" liner w/approx. 200 sks. cement. We propose to perforate and sand-water frac the Pictured Cliffs & Mesa Verde zones for completion.

I understand that this plan of work must receive approval in writing by the Geological Survey before operations may be commenced.

Company Magnolia Petroleum CompanyAddress P. O. Box 2406
Hobbs, New MexicoBy [Signature]
Title District Superintendent

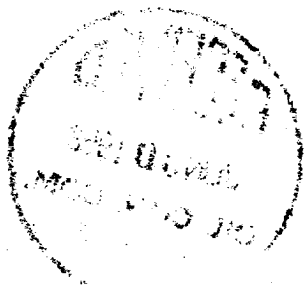

NEW MEXICO OIL CONSERVATION COMMISSION

Well Location and Acreage Dedication Plat

Section A.

Date June 20, 1958

Operator MAGNOLIA PETROLEUM COMPANY Lease JICARILLA "H"
Well No. 1593 Unit Letter Section 12 Township 26N Range 3W NMPN
Located 990 Feet From West Line, 990 Feet From South Line
County Rio Arriba G. L. Elevation 7205 Dedicated Acreage 500 Acres
Name of Producing Formation Pictured Cliffs Pool Undesignated Pictured Cliffs Gas

1. Is the Operator the only owner* in the dedicated acreage outlined on the plat below?
Yes X No .
2. If the answer to question one is "no," have the interests of all the owners been consolidated by communitization agreement or otherwise? Yes No . If answer is "yes," Type of Consolidation
3. If the answer to question two is "no," list all the owners and their respective interests below:

Owner

Land Description

Section B.

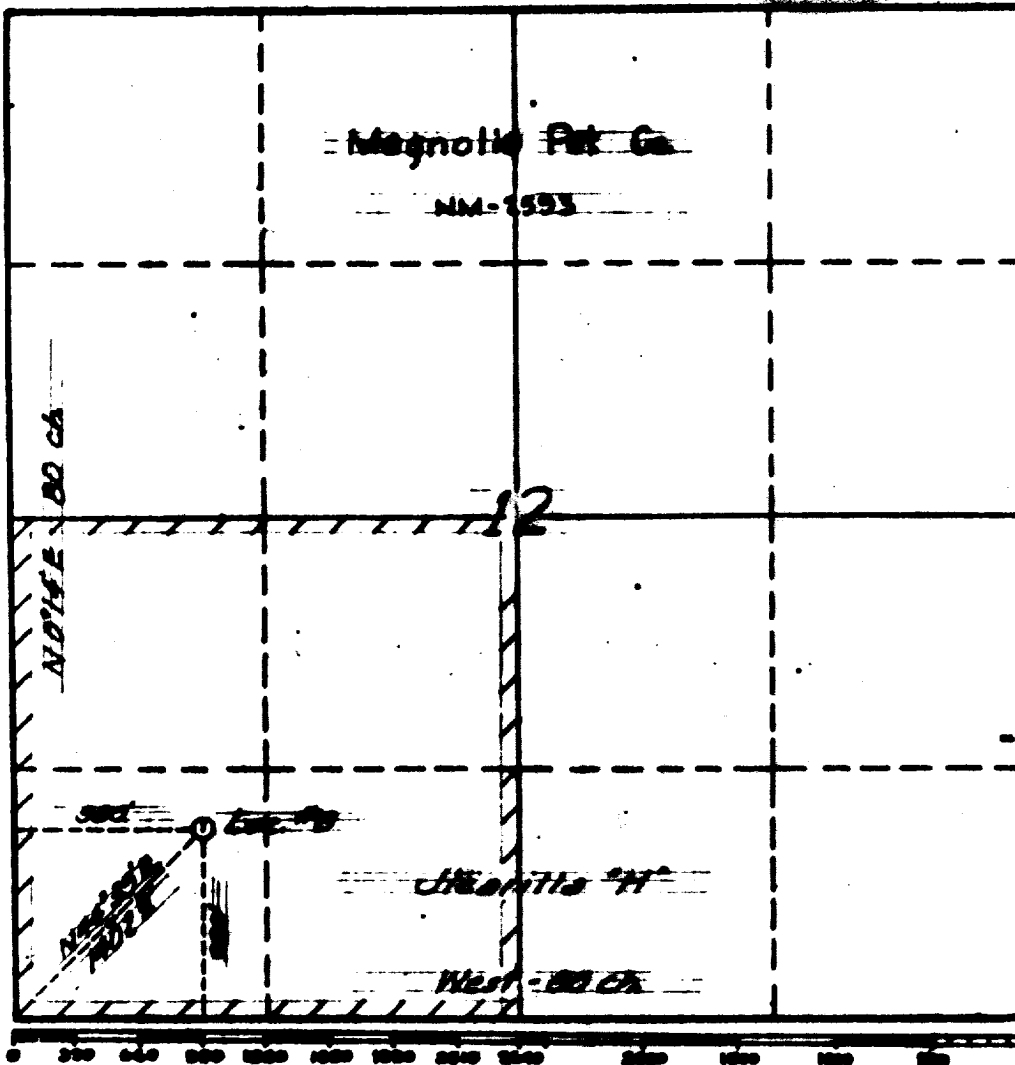

This is to certify that the information in Section A above is true and complete to the best of my knowledge and belief.

MAGNOLIA PETROLEUM COMPANY
(Operator)
G. Young, Jr.
(Representative)

Box 2406, Hobbs, New Mexico
Address

This is to certify that the well location shown on the plat in Section B was plotted from field notes of actual surveys made by me or under my supervision and that the same is true and correct to the best of my knowledge and belief.

Date Surveyed June 15, 1958
Carl E. Turner
Registered Professional
Engineer and/or Land Surveyor.

Certificate No. 2490

UNITED STATES DEPARTMENT OF JUSTICE

Washington, D.C. 20535

TO: DIRECTOR, FBI (100-441100) FROM: SAC, NEW YORK (100-100000) SUBJECT: [REDACTED] (NY 100-100000) (P)

Re New York letter to Bureau dated 1/11/61, captioned as above. The Bureau is requested to advise the New York Office of the results of its review of the New York letter and of the results of its review of the New York letter.

Very truly yours, [REDACTED]

Enclosed for the Bureau are two copies of the New York letter and two copies of the New York letter.

Very truly yours, [REDACTED]

Very truly yours, [REDACTED]

Very truly yours, [REDACTED]

Very truly yours, [REDACTED]

Very truly yours, [REDACTED]

NEW MEXICO OIL CONSERVATION COMMISSION

Well Location and Acreage Dedication Plat

Section A.

Date June 20, 1958

Operator MAGNOLIA PETROLEUM COMPANY Lease JICARILLA "H"
Well No. 8 Unit Letter Section 12 Township 26N Range 3W NMPH
Located 990 Feet From West Line, 990 Feet From South Line
County Rio Arriba G. L. Elevation 7208 Dedicated Acreage 320 Acres
Name of Producing Formation Mesa Verde Pool Blanco

1. Is the Operator the only owner* in the dedicated acreage outlined on the plat below?
Yes X No .
2. If the answer to question one is "no," have the interests of all the owners been consolidated by communitization agreement or otherwise? Yes No . If answer is "yes," Type of Consolidation
3. If the answer to question two is "no," list all the owners and their respective interests below:

Owner

Land Description

Section B.

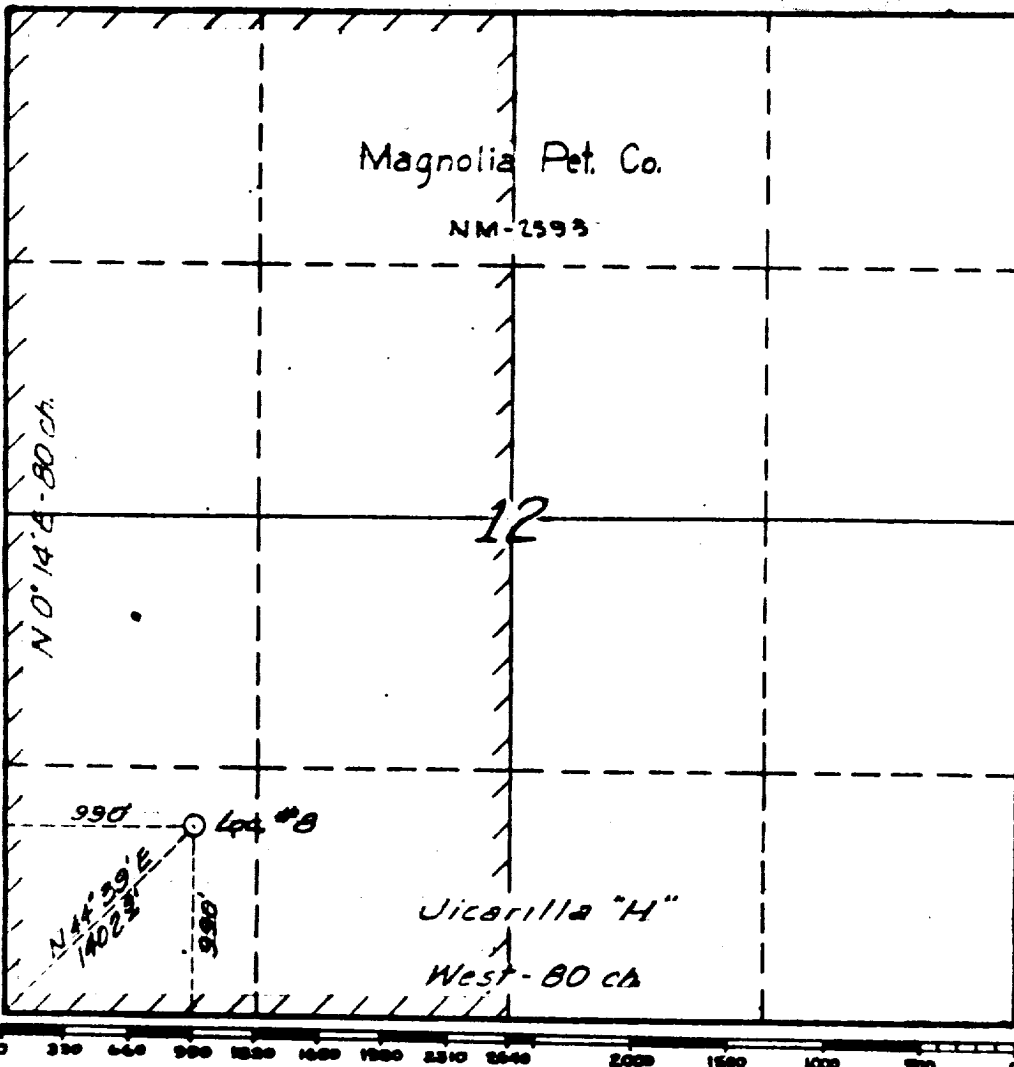

This is to certify that the information in Section A above is true and complete to the best of my knowledge and belief.

MAGNOLIA PETROLEUM COMPANY
(Operator)

By Young, Jr.
(Representative)

Box 2406, Hobbs, New Mexico
Address

This is to certify that the well location shown on the plat in Section B was plotted from field notes of actual surveys made by me or under my supervision and that the same is true and correct to the best of my knowledge and belief.

Date Surveyed June 15, 1958

Carl E. Turner
Registered Professional
Engineer and/or Land Surveyor

Certificate No. 249

the 1990s, the number of people in the world who are under 15 years of age is expected to increase by 1.5 billion, from 1.1 billion in 1990 to 2.6 billion in 2010. The number of people aged 65 and over is expected to increase by 1.1 billion, from 0.4 billion in 1990 to 1.5 billion in 2010. The number of people aged 15-64 is expected to increase by 1.1 billion, from 1.1 billion in 1990 to 2.2 billion in 2010. The number of people aged 65 and over is expected to increase by 1.1 billion, from 0.4 billion in 1990 to 1.5 billion in 2010. The number of people aged 15-64 is expected to increase by 1.1 billion, from 1.1 billion in 1990 to 2.2 billion in 2010.

the 1990s, the number of people in the United States who are 65 years of age or older is projected to increase from 20 million to 35 million, and the number of people 75 years of age or older is projected to increase from 10 million to 15 million (U.S. Census Bureau, 1996).

[illegible]