



STATE OF NEW MEXICO  
**ENERGY AND MINERALS DEPARTMENT**  
 OIL CONSERVATION DIVISION  
 AZTEC DISTRICT OFFICE

1000 RIO BRAZOS ROAD  
 AZTEC, NEW MEXICO 87410  
 (505) 334-6178

OIL CONSERVATION DIVISION  
 BOX 2088  
 SANTA FE, NEW MEXICO 87501

DATE Sept. 26, 1984

RE: Proposed MC \_\_\_\_\_  
 Proposed DHC x \_\_\_\_\_  
 Proposed NSL \_\_\_\_\_  
 Proposed SWD \_\_\_\_\_  
 Proposed WFX \_\_\_\_\_  
 Proposed PMX \_\_\_\_\_

Gentlemen:

I have examined the application dated August 25, 1984  
 for the El Paso Energy Co. Jicamilla 11910 #8 M-8-26A-4W  
 Operator Lease and Well No. Unit, S-T-R

and my recommendations are as follows:

Approve  
 \_\_\_\_\_  
 \_\_\_\_\_  
 \_\_\_\_\_  
 \_\_\_\_\_  
 \_\_\_\_\_

Yours truly,

Frank D. Chazy

August 27, 1984

Mr. Joe Ramey  
New Mexico Oil Conservation Division  
P.O. Box 2088  
Santa Fe, New Mexico 87501

Subject: Downhole Commingle  
Jicarilla 119 N #8 (MD)  
Unit M, Section 8, T26N, R4W  
Rio Arriba County, New Mexico

Dear Mr. Ramey:

El Paso Exploration Company requests administrative approval to downhole commingle the production from the Jicarilla 119 N #8 gas well located in Unit M, Section 8, T26N, R4W, Rio Arriba County, New Mexico. This well produces from the Blanco Mesa Verde and Basin Dakota pools. El Paso Exploration owns 100% working interest in both producing intervals and feels that downhole commingling is the most efficient way to produce the well. Additionally, the well has been found to have a packer leak and the current tubing configuration is non-conductive for effective gas flow to the surface. These items will be addressed in the following two paragraphs.

In May 1983, the annual packer leakage test indicated communication between the zones. We have confirmed the leakage from in-house testing conducted in June 1984. As can be seen from the enclosed well schematic, there are two locations where a leak can exist; at the Otis packoff (5782') within the 2-3/8" tubing string, or at the Baker packer (7178'). Shut-in pressures for the Mesa Verde and Dakota zones taken during the May 1983 packer leakage test are 637 psig and 629 psig, respectively. The corresponding bottom hole pressures are calculated to be 701 psig and 692 psig, respectively. The ratio of the bottom hole pressures is 1.01/1.00, therefore, no migration of gas or liquids will occur since neither zone is pressured over 50% of the other.

RECEIVED

SEP 25 1984

OIL CON. DIV.  
DIST. 3

RECEIVED  
AUG 30 1984  
OIL CONSERVATION DIVISION  
SANTA FE

Mr. Joe Ramey  
August 27, 1984  
Page 2

In addition to the communication between zones, it is felt that a 25% increase in production will be realized if the well is commingled due to the present tubing configuration. The Dakota production has to flow through a choke located above the packer at 7178' and then enters 1" tubing at 5784'. The Mesa Verde production enters the 2-3/8" tubing and must flow through the 1" by 2-3/8" annulus to the surface. These restrictions greatly increase the friction in the well and impede smooth fluid flow to the surface. To illustrate this effect, a similar situation can be cited on the Jicarilla 119 N #4. This well was also a Mesa Verde-Dakota dual that was commingled in February 1977. It lies in Section 6, just to the northwest of the subject well. It, too, had the same tubing configuration as the No. 8 well. After the workover, the commingled gas production was 231 MCFPD (averaged over 10 months) versus a combined gas production prior to the workover of 194 MCFPD (averaged over 12 months). The No. 8 well can be expected to perform in the same fashion, given the similarities between the two.

The attached production decline curve shows a substantial jump in the Mesa Verde production, corresponding at about the same time that the packer leak was detected. It is anticipated that when the restrictions are removed from the wellbore the Mesa Verde will continue producing at present levels or greater and the Dakota will increase in production. The expected commingled rate should be at least 250 MCFPD. Present oil rates are  $\pm\frac{1}{4}$  BOPD for each reservoir. These rates should increase to 2-3 BOPD. Both zones also produce a trace of water, but not enough to cause any formation damage due to commingling.

It is proposed that future production be allocated based on estimated remaining reserves. Mesa Verde reserves are 890 MMcfg and Dakota reserves are 410 MMcfg. Neither reservoir has oil reserves assigned to them. Therefore, based on these reserves, 68% of the gas production would be allocated to the Mesa Verde pool and 32% would be allocated to the Dakota pool. All oil produced should be split (50% Mesa Verde-50% Dakota) since each zone produces roughly the same small amounts.

All offset operators of the proposed commingling application, including the Bureau of Land Management, have been notified.

A well location plat, offset ownership plat, production decline curves, and productivity tests are also attached to this proposal.

Sincerely,



Doug Mussett  
Production Engineer

DM:as  
Enclosures

YEARLY DAILY AVERAGE Q , MCFPD

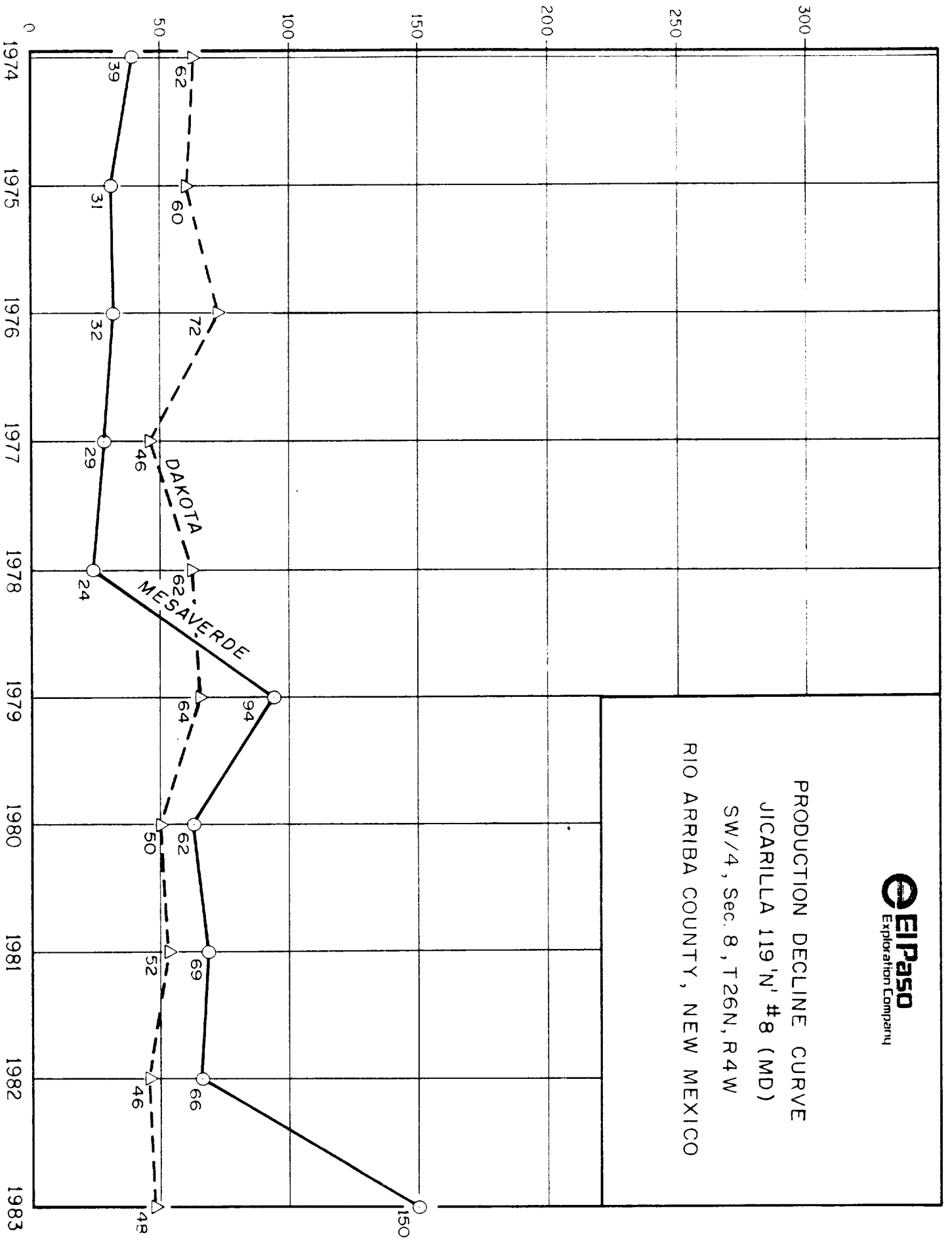

PRODUCTION DECLINE CURVE  
 JICARILLA 119 'N' #8 (MD)  
 SW/4, Sec. 8, T26N, R4W  
 RIO ARRIBA COUNTY, NEW MEXICO

IP

IDE 04-115  
FORM.....07  
POOL.....311  
E..86202

PRODUCTION DEPARTMENT  
WELL DELIVERABILITY SYSTEM  
SAN JUAN DELIVERABILITY AND SHUT-IN PRESSURE TEST SUMMARY--EPNG  
OPERATOR CODE...1987  
LOCATION..M-8-26-4  
TYPE STIMULUS.....6  
1ST DEL DATE..06-25-57  
OPER NAME.....EL PASO EXPLORATION CO  
WELL NAME.....JICARILLA 119 N #8 MV

RUN DATE 84-01-26  
ENG CODE: CP 11

POSITION CODE 39490  
\*\*\*\*\*JICARILLA 119 N #8 MV

DELIVERABILITY TEST PRESSURES IN PSIA AND VOLUMES IN MCF/D @ 15.025 P. B. \*\*\*\*\*

DATE	SHUT-IN DATE	TS	FL	SIPC	SIPT	FLOW PRESSURE	TBG	STATE Q	LINE PRES	AVG FLOW PRES	WELL WKG PRES	STATE DELIV	DEL PRES	CUM VOL TD TEST M3CF	REMARKS
06-03-57		A	1	1082	2368			55	727	728	728	69		0	
01-15-58		A	1	1087				49	486	486	486	47		16000	
08-29-58		A	1	1064				133	541	541	545	151		26000	
05-29-59		A	2	916	900			102	537	537	540	115		60000	
05-28-61		A	2	898	890			72	597	601	602	92		87000	
02-02-62		A	2	842	709			85	591	501	502	85		116000	
04-10-63		A	2	819	808			57	571	571	572	44		133000	
03-27-64		A	2	801	789			68	562	563	564	54		157000	
04-07-65		A	2	787	777			52	561	561	562	42		177000	
04-18-66		A	2	687	677			80	550	554	555	58		197000	
04-21-67		A	2	701	687			66	388	388	390	49		212000	
05-15-68		A	2	674	670				319	320	322	37		230000	
														259000	
06-23-80		A	2	624	322	536	238	76	214	225	233	40	499	448870	1981 OFF YEAR

1976 EXEMPT MARGINAL  
1977 EXEMPT MARGINAL  
1978 EXEMPT MARGINAL  
1984 EXEMPT MARGINAL

HP

CODE 04-130  
 FORM.....09  
 OPERATOR CODE...1987  
 TYPE STIMULUS...:6  
 OPER NAME...EL PASO EXPLORATION CO  
 POSITION CODE 39485  
 ER...18  
 POOL.....314  
 LOCATION..M-8-26-4  
 1ST DEL DATE..06-21-57  
 WELL NAME.....JICARILLA 119 N #8 DK  
 DE...86218

\*\*\*\*\*  
 DELIVERABILITY TEST PRESSURES IN PSIA AND VOLUMES IN MCF/D @ 15.025 P.B.  
 \*\*\*\*\*

DATE	SHUT-IN DATE	TS	FL	SIPC	SIPT	FLOW PRESSURE	STATE	LINE PRES	AVG FLOW PRES	WELL WKG PRES	STATE DELIV	DEL PRES	CUM VOL TD TEST M3CF	REMARKS
05-27-57		A	2		2255		158	699	557	571	230	378	0	
10-16-57		A	2		959		180	470	557	585	159	378	331182	1978 EXEMPT MARGINAL
08-29-58		A	2		1430		155	557	557	557	154	378	331182	1979 EXEMPT MARGINAL
05-29-59		A	2		1150		124	522	522	570	68	378	890000	1980 EXEMPT MARGINAL
05-29-60		A	2		1126		116	522	522	555	86	378	117000	1981 EXEMPT MARGINAL
05-28-61		A	2		1038		89	611	611	536	103	378	146000	1982 EXEMPT MARGINAL
02-02-62		A	2		949		75	582	582	585	92	378	165000	1983 EXEMPT MARGINAL
04-10-63		A	2		897		83	553	553	557	98	378	194000	1976 EXEMPT MARGINAL
03-27-64		A	2		882		56	567	568	555	68	378	219000	
04-07-65		A	2		877		71	550	552	555	86	378	241000	
04-18-66		A	2		861		66	401	401	405	66	378	260000	
04-21-67		A	2		807							378	287000	
06-03-77		A	2		756		93	290	291	291	85	378	514194	

1976 EXEMPT MARGINAL  
 1978 EXEMPT MARGINAL  
 1979 EXEMPT MARGINAL  
 1980 EXEMPT MARGINAL  
 1981 EXEMPT MARGINAL  
 1982 EXEMPT MARGINAL  
 1983 EXEMPT MARGINAL  
 1984 EXEMPT MARGINAL

**REVISED**

Well Location and Acreage Dedication Plat

Section A.

Date 1-9-59

Operator Northwest Production Corp. Lease "N"  
 Well No. 3-8 Unit Letter M Section 8 Township 26N Range 4W NMPM  
 Located 1190 Feet From South Line, 790 Feet From West Line  
 County Rio Arriba G. L. Elevation 6954.75 ungr Dedicated Acreage 320 Acres  
 Name of Producing Formation Dakota Pool Wildcat

1. Is the Operator the only owner\* in the dedicated acreage outlined on the plat below?  
 Yes  No .
2. If the answer to question one is "no," have the interests of all the owners been consolidated by communitization agreement or otherwise? Yes  No . If answer is "yes," Type of Consolidation \_\_\_\_\_
3. If the answer to question two is "no," list all the owners and their respective interests below:

<u>Owner</u>	<u>Land Description</u>
<u>Revised under Order No. R-1287</u>	

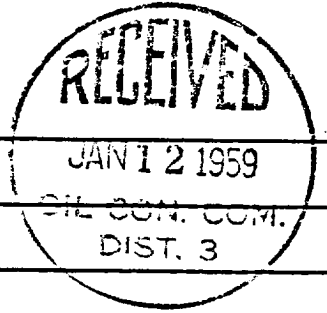

Section B

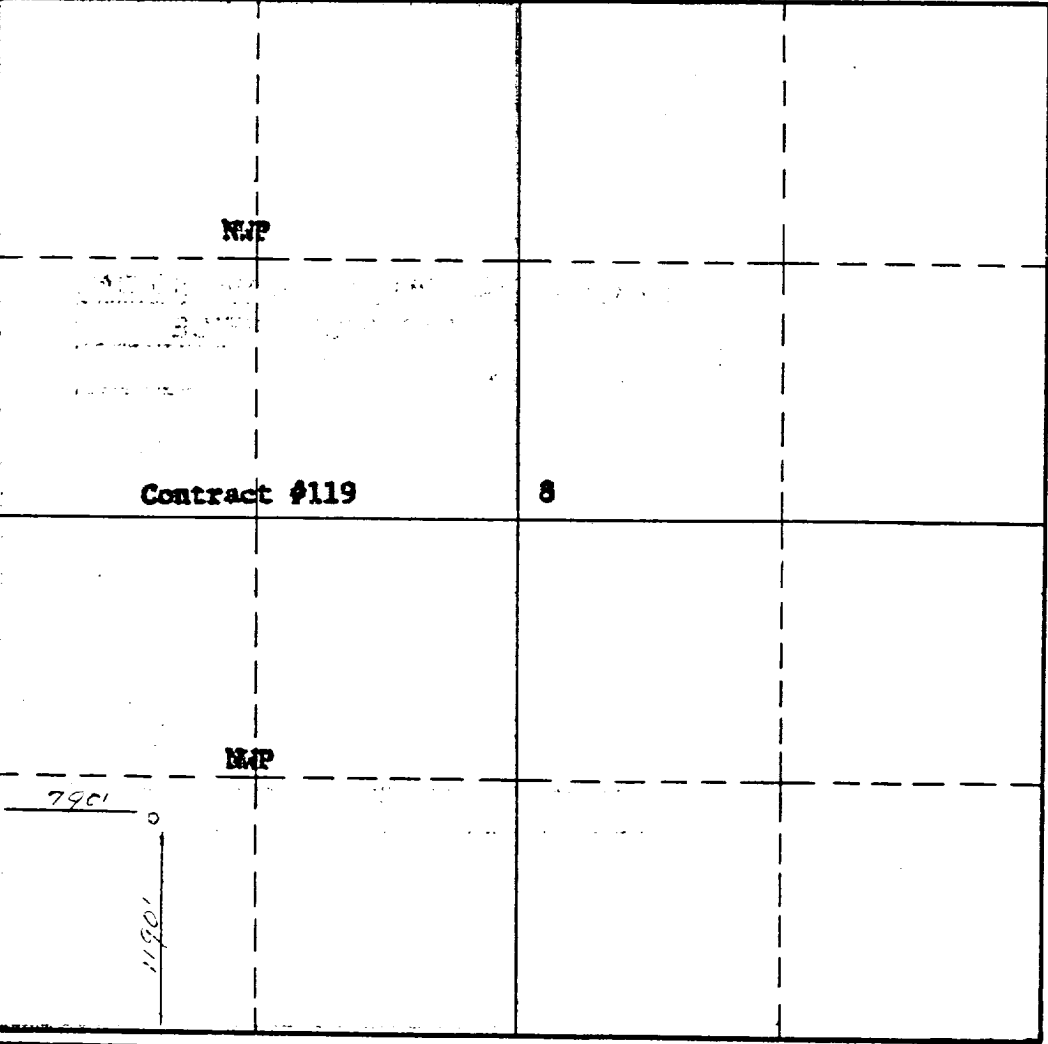

This is to certify that the information in Section A above is true and complete to the best of my knowledge and belief.

Northwest Production Corp.  
 (Operator)  
M. B. Jones M. B. JONES  
Asst Mgr, Prod Operations  
 (Representative)  
320 Sims Building  
Albuquerque, New Mexico  
 Address

This is to certify that the well location shown on the plat in Section B was plotted from field notes of actual surveys made by me or under my supervision and that the same is true and correct to the best of my knowledge and belief.

Date Surveyed January 18, 1957

/s/ James P. Leese  
 Registered Professional Engineer and/or Land Surveyor.

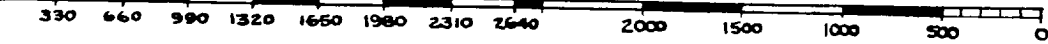

Well Name Jicarilla 119 N #8

Footage---- 1190' FSL, 790' FWL

APPLICATION TO COMMINGLE MESAVERDE/DAKOTA

County Rio Arriba State New Mexico Section 8 Township 26N Range 4W

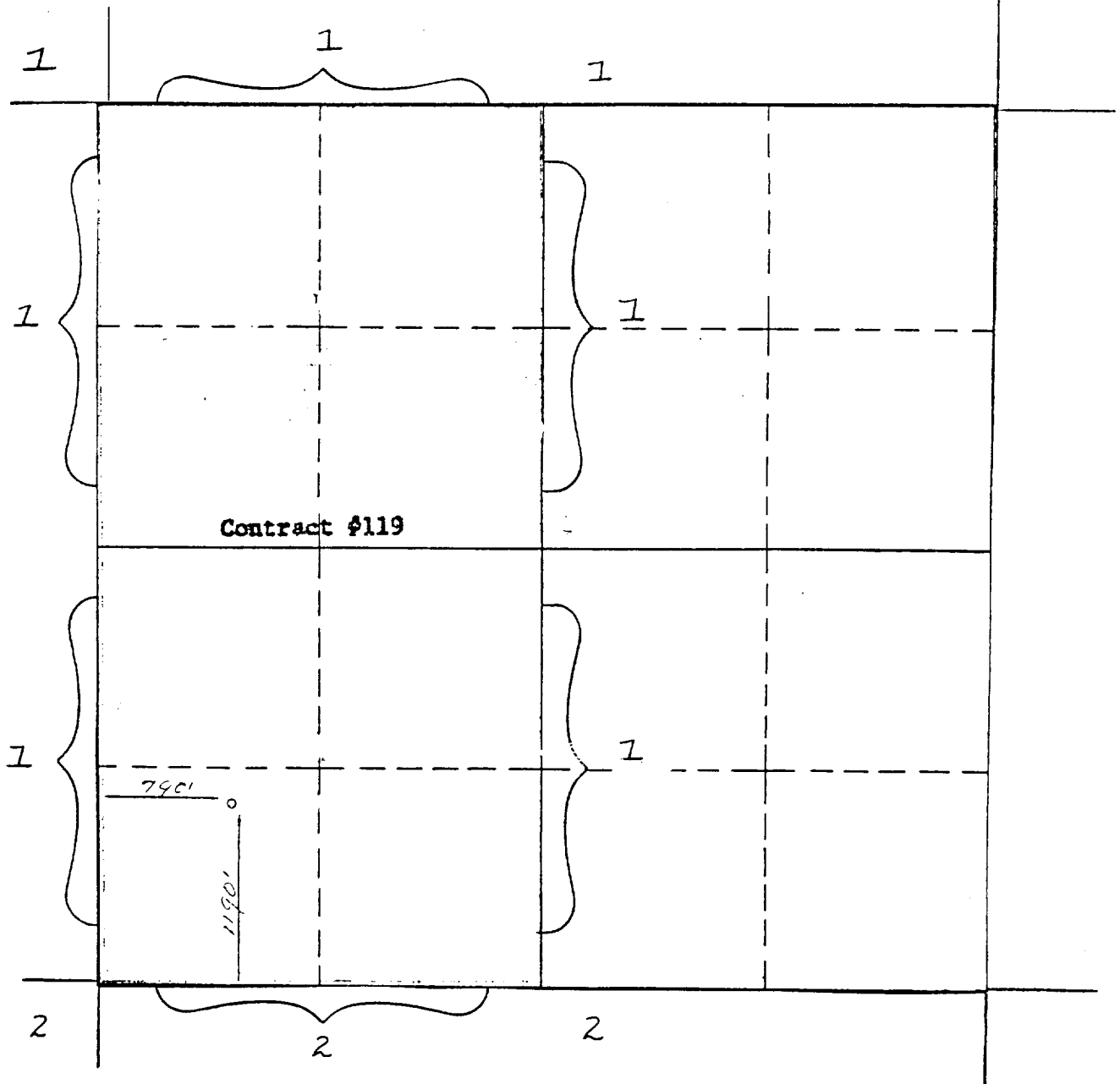

REMARKS:

- (1) El Paso Exploration Company
- (2) Union Texas Petroleum Corporation

*ca*



MESAVERDE DATA:

TOP OF MESAVERDE: 5153'

BOTTOM OF MESAVERDE: 5810'

- PERFORATIONS: 5156-5162', 5170-5174',
- 5202-5206', 5218-5226', 5232-5236',
- 5244-5250', 5266-5284', 5344-5348',
- 5384-5388', 5434-5446', 5484-5490',
- 5554-5560', 5592-5596', 5604-5608',
- 5668-5704', 5718-5722', 5726-5730',
- 5734-5738', 5750-5770',

Bush Rod Nipple at 3154'  
7 7/8" Casing at 3760'

GRANEROS DATA:

TOP OF GRANEROS: 7670'

BOTTOM OF GRANEROS: 7826'

- PERFORATIONS: 7696-7734', 7744-7758',
- 7774-7782', 7798-7804',

Holes in 2 1/8" Tubing:  
1- 1/4" @ 5765'  
1- 1/4" @ 5768'  
1- 1/4" @ 5777'  
1- 1/4" x 3/8" @ 5762'  
1- 1/4" x 3/8" @ 5757' -  
(Otis meas. 0-5' above 9rod.)

DAKOTA DATA:

TOP OF DAKOTA: 7826'

BOTTOM OF DAKOTA: 7910'

- 7828-7858', 7864-7870', 7874-7880',

Otis Pack-off at 5782.15'

1" Tubing at 5783.20'

DIAGRAMATIC SKETCH OF DUAL GAS

COMPLETION FOR "N" WELL 8-8

Otis Side-Door Choke at 7177'

Baker "EEJ" Packer at 7178.1'

2 3/8" Tubing at 7676.3'

5 1/2" Liner at 7909.96'

NORTHWEST PRODUCTION CORPORATION  
ALBUQUERQUE, NEW MEXICO

APPLICATION FOR DUAL GAS COMPLETION  
OF "N" WELL 8-8 IN MESAVERDE AND  
GRANEROS-DAKOTA FORMATION

RIO ARRIBA COUNTY  
NEW MEXICO

CONTRACT # 119

Drawn: W. H. McGohey  
Approved: Roy Phillips

Scale: 400' = 1"  
Date: 5-2-55

August 27, 1984

Union Texas Petroleum Corporation  
4001 Bloomfield Highway  
Farmington, New Mexico 87401

Re: Jicarilla 119 N #8 (MD)  
Unit M, Section 8, T26N, R4W  
Rio Arriba County, New Mexico

Gentlemen:

El Paso Exploration Company has requested administrative approval to downhole commingle the production from the Blanco Mesa Verde and Basin Dakota pools in its Jicarilla 119 N #8 well. El Paso feels that commingling production is the most efficient manner to produce this well.

In compliance with New Mexico Oil Conservation Division rules, we are notifying you, as operator of an offsetting proration unit, of our application for administrative approval to downhole commingle the Jicarilla 119 N #8. Enclosed are three copies of this letter. If there are no objections to this application, please sign and return one copy to the New Mexico Oil Conservation Division, Post Office Box 2088, Santa Fe, New Mexico 87501; one copy to El Paso Exploration Company at the above address; and keep the remaining copy for your records.

A well location and offset ownership plats are enclosed.

Sincerely,

  
Douglas W. Mussett

DWM:as

WAIVER

\_\_\_\_\_ hereby waives objection to El Paso Exploration Company's application for downhole commingling its Jicarilla 119 N #8 well as proposed above.

By: \_\_\_\_\_

Date: \_\_\_\_\_



OIL CONSERVATION DIVISION

10 1984

RECEIVED

P. O. BOX 4289  
FARMINGTON, NEW MEXICO 87499-4289  
PHONE: 505-325-2841

August 27, 1984

Union Texas Petroleum Corporation  
4001 Bloomfield Highway  
Farmington, New Mexico 87401

Re: Jicarilla 119 N #8 (MD)  
Unit M, Section 8, T26N, R4W  
Rio Arriba County, New Mexico

Gentlemen:

El Paso Exploration Company has requested administrative approval to downhole commingle the production from the Blanco Mesa Verde and Basin Dakota pools in its Jicarilla 119 N #8 well. El Paso feels that commingling production is the most efficient manner to produce this well.

In compliance with New Mexico Oil Conservation Division rules, we are notifying you, as operator of an offsetting proration unit, of our application for administrative approval to downhole commingle the Jicarilla 119 N #8. Enclosed are three copies of this letter. If there are no objections to this application, please sign and return one copy to the New Mexico Oil Conservation Division, Post Office Box 2088, Santa Fe, New Mexico 87501; one copy to El Paso Exploration Company at the above address; and keep the remaining copy for your records.

A well location and offset ownership plats are enclosed.

Sincerely,

  
Douglas W. Mussett

DWM:as

WAIVER

\_\_\_\_\_ hereby waives objection to El Paso Exploration Company's application for downhole commingling its Jicarilla 119 N #8 well as proposed above.

By: \_\_\_\_\_

Date: \_\_\_\_\_

**REVISED**

Well Location and Acreage Dedication Plat

Section A.

Date 1-9-59

Operator Northwest Production Corp. Lease "N"  
 Well No. 3-8 Unit Letter M Section 8 Township 26N Range 4W NMPM  
 Located 1190 Feet From South Line, 790 Feet From West Line  
 County Rio Arriba G. L. Elevation 6954.73 ungr Dedicated Acreage 320 Acres  
 Name of Producing Formation Dakota Pool Wildcat

1. Is the Operator the only owner\* in the dedicated acreage outlined on the plat below?  
 Yes  No
2. If the answer to question one is "no," have the interests of all the owners been consolidated by communitization agreement or otherwise? Yes  No . If answer is "yes," Type of Consolidation \_\_\_\_\_
3. If the answer to question two is "no," list all the owners and their respective interests below:

Owner

Land Description

Revised under Order No. R-1287

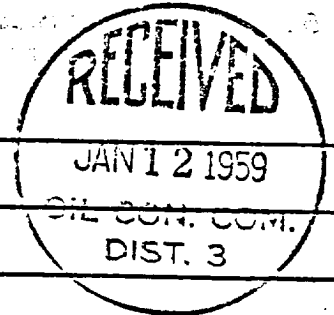

**Section B**

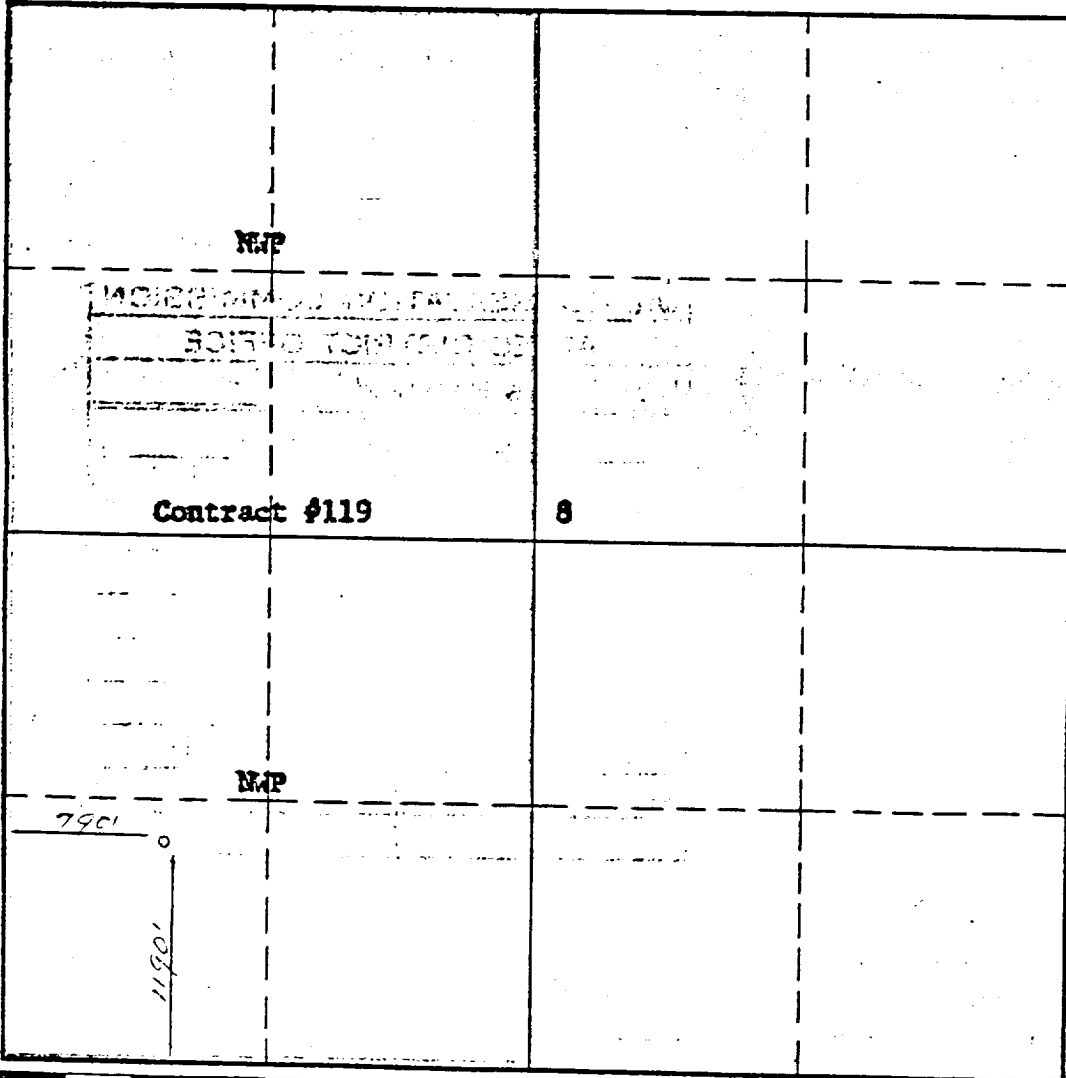

This is to certify that the information in Section A above is true and complete to the best of my knowledge and belief.

Northwest Production Corp.

(Operator)  
M. B. Jones M. B. JONES  
 Asst Mgr, Prod Operations

(Representative)  
520 Simas Building  
Albuquerque, New Mexico

Address

This is to certify that the well location shown on the plat in Section B was plotted from field notes of actual surveys made by me or under my supervision and that the same is true and correct to the best of my knowledge and belief.

Date Surveyed January 18, 1959

/s/ James P. Laese

Registered Professional  
 Engineer and/or Land Surveyor.

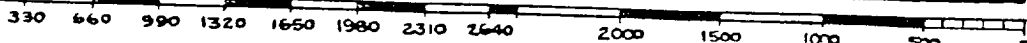

Footage--- 1190' FSL, 790' FWL

APPLICATION TO COMMINGLE MESAVERDE/DAKOTA

County Rio Arriba State New Mexico Section 8 Township 26N Range 4W

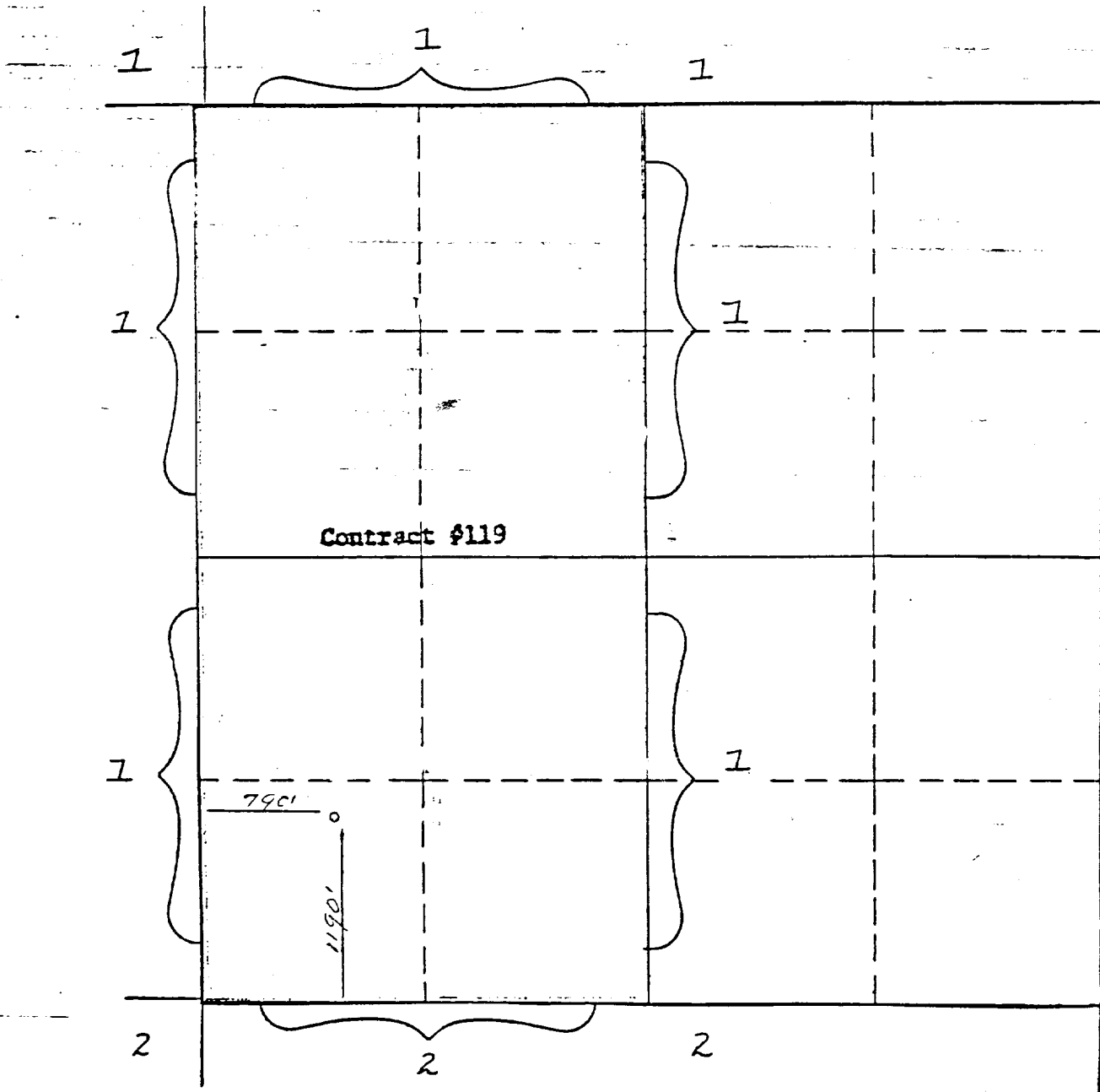

REMARKS:

- (1) El Paso Exploration Company
- (2) Union Texas Petroleum Corporation

Suite 500  
Aurora, Colorado 80014  
(303) 695-8778

CONSERVATION DIVISION  
SEP 20 1984  
RECEIVED

September 6, 1984

New Mexico Oil Conservation Division  
Post Office Box 1088  
Santa Fe, NM 87501

RE: Jicarilla 119 N #8 (MD)  
Unit M, Section 8, T26N, R4W  
Rio Arriba County, NM

Gentlemen:

At El Paso Exploration Company's request, we have executed the attached waiver of objection for their request to downhole commingle the Jicarilla 119 N #8.

Sincerely,



Donald B. Wells  
Division Operations Manager

DBW:bea  
Enclosure