

DOSWELL & PETTIGREW  
719 1st National Bank Bldg.  
Dallas 1, Texas

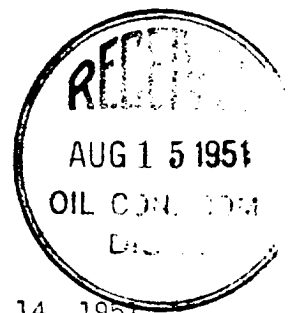

August 14, 1951

Mr. Al Greer,  
New Mexico Oil Conservation Commission,  
Aztec, New Mexico

Re: Santa Fe 079035

Dear Sir:

It is hereby requested that we be granted approval to drill on the subject lease, located in the NW $\frac{1}{4}$  SW $\frac{1}{4}$  Sec. 8, T. 26 N., R. 6 W., N.M.P.M., Rio Arriba County, New Mexico, Wildcat area.

This is to be well No. 8-18 Doswell, located 1600' from the south line and 1075' from the west line. It is impossible to drill the well due to rough terrain on the specified footage as set forth in spacing regulations.

*FED-DOSWELL #8-18*

Very truly yours,

*C. Wilson Moore*  
C. WILSON MOORE,  
Supt.

Cwm/jhb

(SUBMIT IN TRIPLICATE)

UNITED STATES  
DEPARTMENT OF THE INTERIOR  
GEOLOGICAL SURVEY

Land Office

Lease No.

Unit

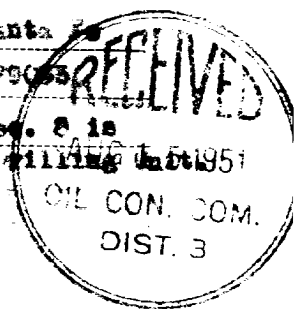

SUNDRY NOTICES AND REPORTS ON WELLS

NOTICE OF INTENTION TO DRILL.....	<input checked="" type="checkbox"/>	SUBSEQUENT REPORT OF WATER SHUT-OFF.....	
NOTICE OF INTENTION TO CHANGE PLANS.....		SUBSEQUENT REPORT OF SHOOTING OR ACIDIZING.....	
NOTICE OF INTENTION TO TEST WATER SHUT-OFF.....		SUBSEQUENT REPORT OF ALTERING CASING.....	
NOTICE OF INTENTION TO RE-DRILL OR REPAIR WELL.....		SUBSEQUENT REPORT OF REDRILLING OR REPAIR.....	
NOTICE OF INTENTION TO SHOOT OR ACIDIZE.....		SUBSEQUENT REPORT OF ABANDONMENT.....	
NOTICE OF INTENTION TO PULL OR ALTER CASING.....		SUPPLEMENTARY WELL HISTORY.....	
NOTICE OF INTENTION TO ABANDON WELL.....			

(INDICATE ABOVE BY CHECK MARK NATURE OF REPORT, NOTICE, OR OTHER DATA)

August 14, 1951

Well No. 8-18 is located 1500 ft. from N line and 1075 ft. from W line of sec. 8  
N. 24. Sec. 8 26 N. 6 S. T. 1. N. 1.  
 (1/4 Sec. and Sec. No.) (Twp.) (Range) (Meridian)  
Wildcat Big Arriba New Mexico  
 (Field) (County or Subdivision) (State or Territory)

The elevation of the derrick floor above sea level is        ft. (To be furnished later)

DETAILS OF WORK

(State names of and expected depths to objective sands; show sizes, weights, and lengths of proposed casings; indicate mudding jobs, cementing points, and all other important proposed work)

It is intended to drill with rotary tools to approximately 3000 feet to test the fractured cliffs formation.

Casing Program:

Set 500' - 6-5/8" w/250 sacks and cement to be circulated.

Set approx. 3000' - 5 1/2" w/250 sacks.

I understand that this plan of work must receive approval in writing by the Geological Survey before operations may be commenced.

Company DODWELL & PARTNERS,

Address 719 1st Nat'l. Bk. Bldg.,

Dallas 1, Texas

By

C. L. ...

Title

Supt.

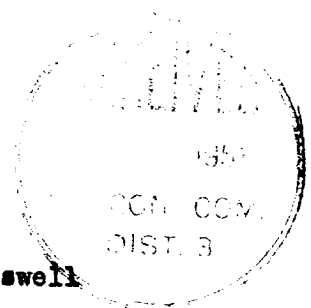

Company Doswell & Pettigrew  
Lease Santa Fe 079035 Well No 8-18 Doswell  
Sec. 8 T. 26 N. R. 6 W., N.M.P.M.  
Location 1600' from the South line and 1075'  
from the West line.

Rio Arriba County New Mexico

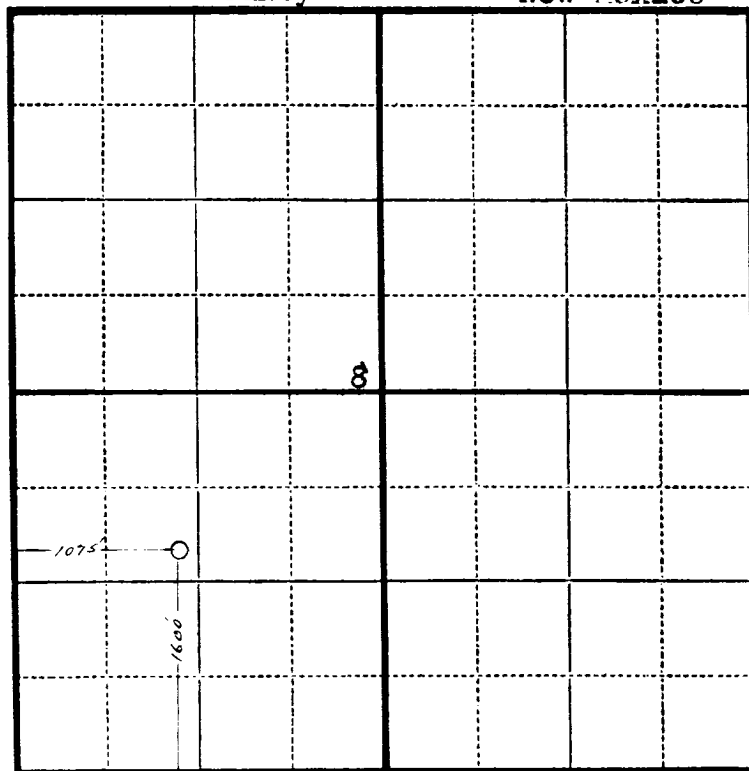

Scale—4 inches equals 1 mile.

This is to certify that the above plat was prepared from field notes of actual surveys made by me or under my supervision and that the same are true and correct to the best of my knowledge and belief.

Seal:

Charles J. Finklea  
Registered Professional Engineer and Land Surveyor. N. Mex. Reg. No. 1302

August 11  
Surveyed \_\_\_\_\_, 19 51