

DOSWELL & PETTIGREW
719 1st National Bank Bldg.
Dallas 1, Texas

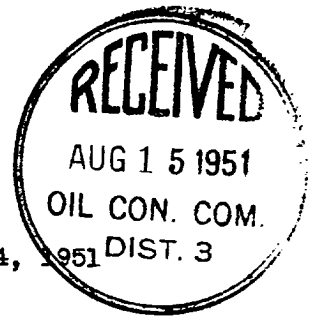

August 14, 1951

Mr. Al Greer,
New Mexico Oil Conservation Commission,
Aztec, New Mexico

Re: New Mexico 03553

Dear Sir:

It is hereby requested that we be granted approval to drill on the subject lease, located in the NW¹/₄ SW¹/₄ Sec. 11, T. 26 N., R. 6 W., N.M.P.M., Rio Arriba County, New Mexico, Wildcat area.

This is to be well No. 1-20 Doswell, located 1700' from the south line and 990' from the west line of section 11. It is impossible to drill the well, due to rough terrain, on the specified footage as set forth in spacing regulations.

Very truly yours,

C. WILSON MOORE,
Supt.

CWM/jhb

(SUBMIT IN TRIPLICATE)

UNITED STATES
DEPARTMENT OF THE INTERIOR
GEOLOGICAL SURVEY

Land Office New Mexico

Lease No. 03553

Unit Sec. 11

Designated Drilling Unit

SUNDRY NOTICES AND REPORTS ON WELLS

NOTICE OF INTENTION TO DRILL.....	<input checked="" type="checkbox"/>	SUBSEQUENT REPORT OF WATER SHUT-OFF.....	<input type="checkbox"/>
NOTICE OF INTENTION TO CHANGE PLANS.....	<input type="checkbox"/>	SUBSEQUENT REPORT OF SHOOTING OR ACIDIZING.....	<input type="checkbox"/>
NOTICE OF INTENTION TO TEST WATER SHUT-OFF.....	<input type="checkbox"/>	SUBSEQUENT REPORT OF ALTERING CASING.....	<input type="checkbox"/>
NOTICE OF INTENTION TO RE-DRILL OR REPAIR WELL.....	<input type="checkbox"/>	SUBSEQUENT REPORT OF REDRILLING OR REPAIR.....	<input type="checkbox"/>
NOTICE OF INTENTION TO SHOOT OR ACIDIZE.....	<input type="checkbox"/>	SUBSEQUENT REPORT OF ABANDONMENT.....	<input type="checkbox"/>
NOTICE OF INTENTION TO PULL OR ALTER CASING.....	<input type="checkbox"/>	SUPPLEMENTARY WELL HISTORY.....	<input type="checkbox"/>
NOTICE OF INTENTION TO ABANDON WELL.....	<input type="checkbox"/>		<input type="checkbox"/>

(INDICATE ABOVE BY CHECK MARK NATURE OF REPORT, NOTICE, OR OTHER DATA)

August 14, 1951

Well No. Deswell 1-20 is located 1700 ft. from S line and 990 ft. from W line of sec. 11

Sec. 11 (1/4 Sec. and Sec. No.) 26 N. (Twp.) 6 E. (Range) N. M. & T. M. (Meridian)
Midland (Field) Rio Arriba (County or Subdivision) New Mexico (State or Territory)

The elevation of the derrick floor above sea level is ----- ft. (To be furnished later)

DETAILS OF WORK

(State names of and expected depths to objective sands; show sizes, weights, and lengths of proposed casings; indicate mudding jobs, cementing points, and all other important proposed work)

It is intended to drill with Rotary Tools to approximately 3000 feet to test the Pictured Cliffs formation.

Casing Program:

Set 500' - 8-5/8" w/350 sacks and cement to be circulated.

Set approx. 3000' - 5 1/2" w/250 sacks.

I understand that this plan of work must receive approval in writing by the Geological Survey before operations may be commenced.

Company DES-ELL & PETTIGREW,

Address 719 1st National Bk. Bldg.,

Dallas 1, Texas

By C. ALTON MOORE,
Supt.

Title Supt.

Company Doswell & Pettigrew

Lease _____ Well No. _____

Sec. 11 T. 26 N., R. 6 W., N.M.P.M.

Location 1700' from the South line and 990'
from the West line.

Rio Arriba County

New Mexico

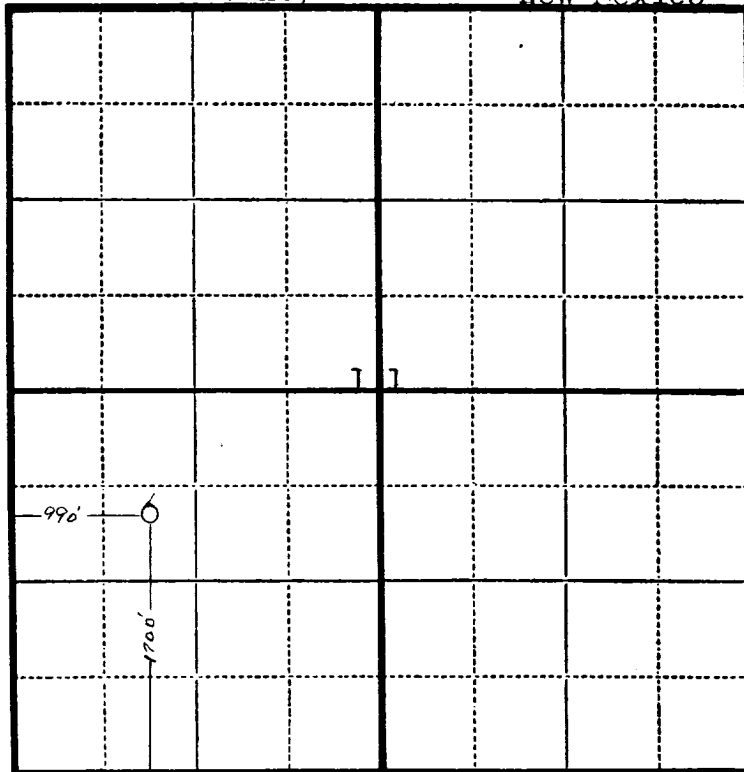

Scale—4 inches equals 1 mile.

This is to certify that the above plat was prepared from field notes of actual surveys made by me or under my supervision and that the same are true and correct to the best of my knowledge and belief.

Charles J. Finklea

Seal:

Registered Professional Charles J. Finklea
Engineer and Land Surveyor. N. Mex. Reg. No. 1302

Surveyed August 12, 1951

