

02

District I
P.O. Box 1980, Hobbs, NM

State of New Mexico
Energy, Minerals and Natural Resources Dept.

SUBMIT 1 COPY TO
APPROPRIATE
DISTRICT OFFICE
AND 1 COPY TO
SANTA FE OFFICE

District II
P.O. Drawer DD, Artesia,
NM 88221

OIL CONSERVATION DIVISION

2040 S. Pacheco

Santa Fe, New Mexico 87504

District III
1000 Rio Brazos Rd, Aztec,
NM 87410

PIT REMEDIATION AND CLOSURE REPORT

Operator: Caulkins Oil Company Telephone: (505) 632-1544
Address: P.O. Box 340, Bloomfield, NM 87413
Facility or Well Name: Breech "A" 204-M
Location: Unit or Qtr/Qtr L Sec 9 T 26N R 6W County Rio Arriba
Pit Type: Separator X Dehydrator Other
Land Type: BLM X, State , Fee , Other

Pit Location: Pit dimensions: length 27', width 23', depth 7'
(Attach diagram)
References: wellhead X, other
Footage from reference: 187'
Direction from reference: 330 Degrees East North
of
X West South X

Depth to Ground Water: (Vertical distance from contaminants to seasonal high water elevation of ground water)	Less than 50 feet	(20 points)	
	50 feet to 99 feet	(10 points)	
	Greater than 100 feet	(0 points)	<u>0</u>

Wellhead Protection Area: (Less than 200 feet from a private domestic water source, or; less than 1000 feet from all other water sources)	Yes	(20 points)	
	No	(0 points)	<u>0</u>

Distance to Surface Water: (Horizontal distance to perennial lakes, ponds, rivers, streams, creeks, irrigation canals and ditches)	Less than 200 feet	(20 points)	
	200 feet to 1000 feet	(10 points)	
	Greater than 1000 feet	(0 points)	<u>0</u>

RANKING SCORE (TOTAL POINTS): 0

SIGNATURE Robert L. Verquer PRINTED NAME
AND TITLE ROBERT L. VERQUER, SUPERINTENDENT

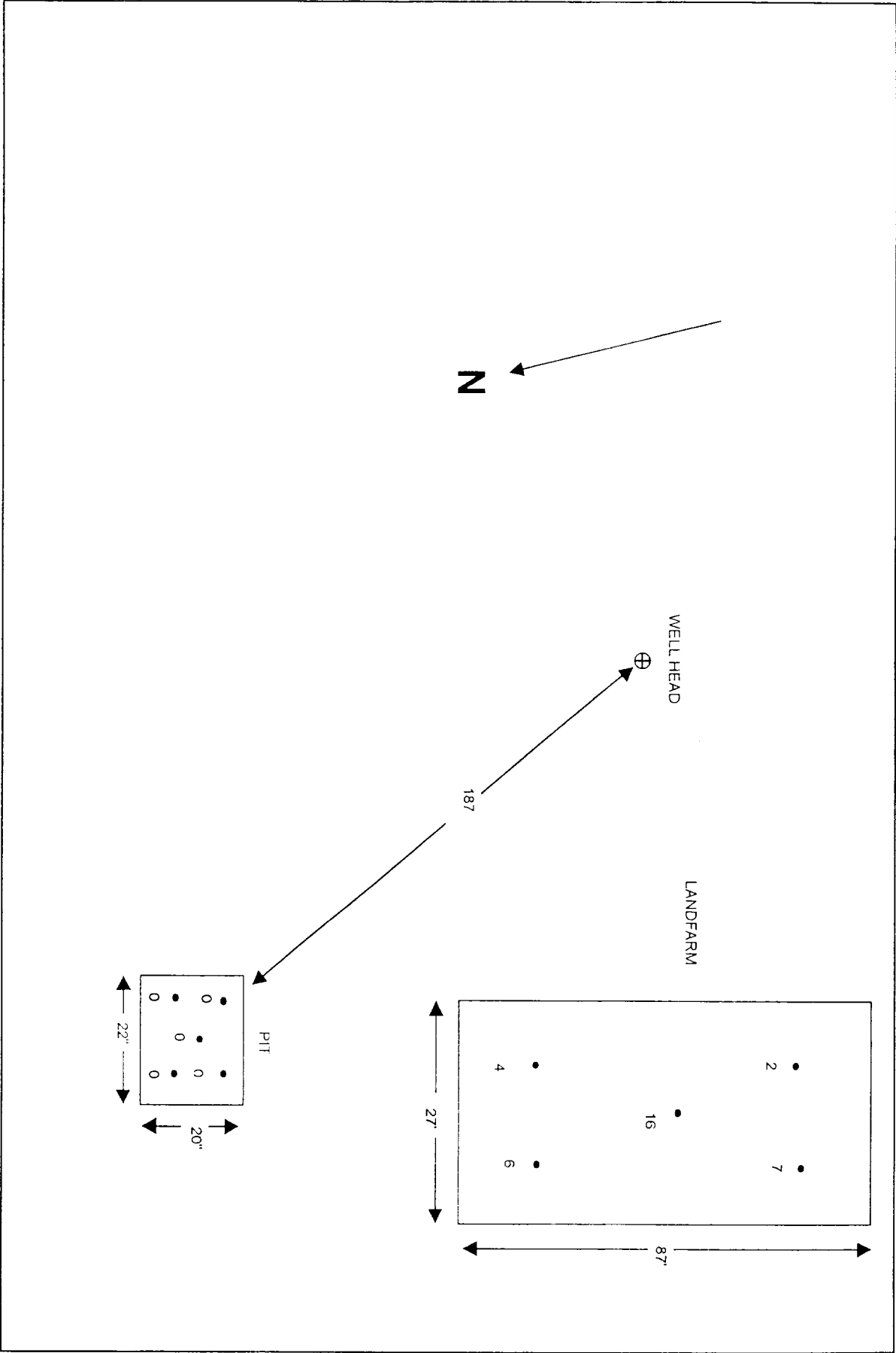



®Certificate of Analysis No. 9709201-07

FARMINGTON LABORATORY

P.O. BOX 1289

FARMINGTON, NEW MEXICO 87499-1289

PHONE (505) 326-2588

Caulkins Oil Co.
1997 E Blanco Blvd
Bloomfield, NM 87413
Attn: Bobby Verquer

Date: 10/27/97

Project: Landfarm
Site:
Sampled By: J. Waggoner
Sample ID: Breech A 204 M

Project No:
Matrix: Soil
Date Sampled: 09/29/97
Date Received: 09/29/97

Analytical Data

PARAMETER	RESULTS	DETECTION LIMIT	UNITS
Benzene	ND	1.0	µg/Kg
Toluene	ND	1.0	µg/Kg
Ethylbenzene	ND	1.0	µg/Kg
Total Xylene	ND	1.0	µg/Kg
Total Volatile Aromatic Hydrocarbons	ND		µg/Kg

Surrogate

% Recovery

1,4-Difluorobenzene
4-Bromofluorobenzene
Method 8020

100
127

Analyzed by: LJ

Date: 10/15/97

Total Petroleum Hydrocarbons-Diesel 2100 40.0 mg/Kg

Surrogate

% Recovery

n-Pentacosane
Method 8015A*** for Diesel

3200MI

Analyzed by: RR

Date: 10/09/97

Gasoline Range Organics ND 0.1 mg/Kg

Surrogate

% Recovery

4-Bromofluorobenzene
1,4-Difluorobenzene
Method 8015A*** for Gasoline

73
100

Analyzed by: RR

Date: 10/09/97

ND- Not detected

MI-Matrix Interference

Notes:

*Ref: Methods for Chemical Analysis of Water and Wastes, 1983, EPA

**Ref: Standard Methods for Examination of Water & Wastewater, 18th ed.

***Ref: Test Methods for Evaluating Solid Waste, EPA SW846, 3rd Ed.

QUALITY ASSURANCE: These analyses are performed in accordance with

EPA guidelines for quality assurance.

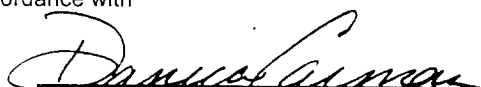
Danica Carman, Lab Manager



®Certificate of Analysis No. 9709201-08

FARMINGTON LABORATORY
P.O. BOX 1289
FARMINGTON, NEW MEXICO 87499-1289
PHONE (505) 326-2588

Caulkins Oil Co.
1997 E Blanco Blvd
Bloomfield, NM 87413
Attn: Bobby Verquer

Date: 10/27/97

Project: Bottom of Pit
Site:
Sampled By: J. Waggoner
Sample ID: Breech A 204 M

Project No:
Matrix: Soil
Date Sampled: 09/29/97
Date Received: 09/29/97

Analytical Data

PARAMETER	RESULTS	DETECTION LIMIT	UNITS
Benzene	ND	1.0	µg/Kg
Toluene	ND	1.0	µg/Kg
Ethylbenzene	ND	1.0	µg/Kg
Total Xylene	ND	1.0	µg/Kg
Total Volatile Aromatic Hydrocarbons	ND		µg/Kg

Surrogate **% Recovery**
1,4-Difluorobenzene 97
4-Bromofluorobenzene 57
Method 8020
Analyzed by: LJ
Date: 10/15/97

Total Petroleum Hydrocarbons-Diesel 96 40.0 mg/Kg

Surrogate **% Recovery**
n-Pentacosane 320MI
Method 8015A*** for Diesel
Analyzed by: RR
Date: 10/09/97

Gasoline Range Organics ND 0.1 mg/Kg

Surrogate **% Recovery**
4-Bromofluorobenzene 32MI
1,4-Difluorobenzene 107
Method 8015A*** for Gasoline
Analyzed by: RR
Date: 10/09/97

ND- Not detected MI-Matrix Interference

Notes: *Ref: Methods for Chemical Analysis of Water and Wastes, 1983, EPA
 **Ref: Standard Methods for Examination of Water & Wastewater, 18th ed.
 ***Ref: Test Methods for Evaluating Solid Waste, EPA SW846, 3rd Ed.

QUALITY ASSURANCE: These analyses are performed in accordance with
EPA guidelines for quality assurance.

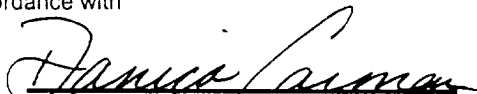
Danica Carman, Lab Manager

WELL NAME: Breach A 204-M

CAULKINS OIL
SITE SECURITY DIAGRAM

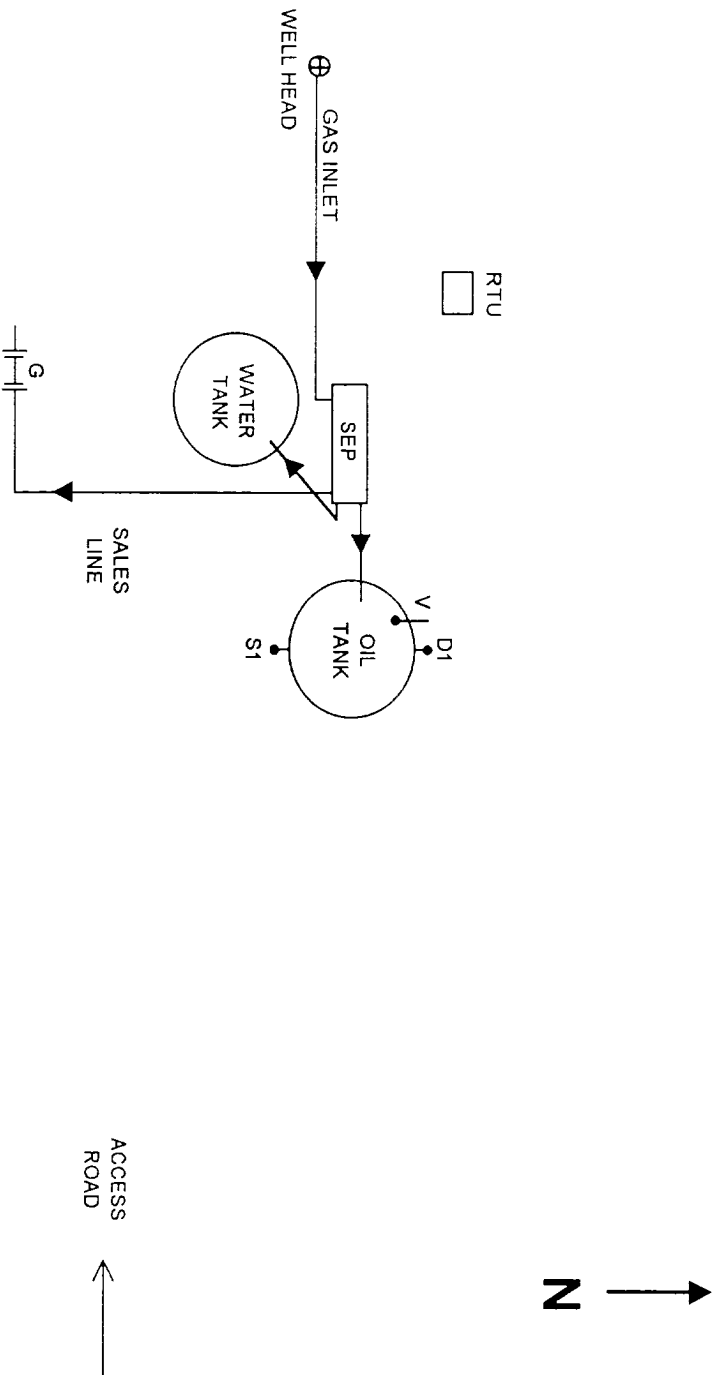

THIS LEASE IS SUBJECT TO THE SITE SECURITY PLAN
FOR NORTHWEST NEW MEXICO OPERATIONS. THE
PLAN IS LOCATED AT:

CAULKINS OIL COMPANY
2001 EAST BLANCO BLVD.
BLOOMFIELD, NEW MEXICO 87413

CAULKINS OIL COMPANY
LEASE NO.: NMSF079035A
LOCATION: NW/4 SW/4 SEC. 9,
T. 26N., R. 6W

ALL SALES VALVE ON TANKS AND BS&W DRAW VALVES CLOSED AND
SEALED WHILE WELL PRODUCING AND SHUT-IN.