

(SUBMIT IN TRIPLICATE)

UNITED STATES
DEPARTMENT OF THE INTERIOR
GEOLOGICAL SURVEY

Land Office Santa Fe
Lease No. 079160
Unit Rincon Unit

SUNDRY NOTICES AND REPORTS ON WELLS

NOTICE OF INTENTION TO DRILL.....	<input checked="" type="checkbox"/>	SUBSEQUENT REPORT OF WATER SHUT-OFF.....	
NOTICE OF INTENTION TO CHANGE PLANS.....		SUBSEQUENT REPORT OF SHOOTING OR ACIDIZING.....	
NOTICE OF INTENTION TO TEST WATER SHUT-OFF.....		SUBSEQUENT REPORT OF ALTERING CASING.....	
NOTICE OF INTENTION TO RE-DRILL OR REPAIR WELL.....		SUBSEQUENT REPORT OF RE-DRILLING OR REPAIR.....	
NOTICE OF INTENTION TO SHOOT OR ACIDIZE.....		SUBSEQUENT REPORT OF ABANDONMENT.....	
NOTICE OF INTENTION TO PULL OR ALTER CASING.....		SUPPLEMENTARY WELL HISTORY.....	
NOTICE OF INTENTION TO ABANDON WELL.....			

(INDICATE ABOVE BY CHECK MARK NATURE OF REPORT, NOTICE, OR OTHER DATA)

January 8, 1957

Well No. 92 is located 1650 ft. from N line and 1835 ft. from E line of sec. 11
NE Section 11 26N 7W 10TH
 (1/4 Sec. and Sec. No.) (Twp.) (Range) (Meridian)
So. Blanco P.C. Rio Arriba New Mexico
 (Field) (County or Subdivision) (State or Territory)

The elevation of the derrick floor above sea level is 6521 ft.

DETAILS OF WORK

(State names of and expected depths to objective sands; show sizes, weights, and lengths of proposed casings; indicate mudding jobs, cementing points, and all other important proposed work)

It is intended to drill a well thru the Pictured Cliff formation using rotary tools and to perforate and water fracture possible producing zones. Estimated T.D. 2805'.

Casing Program:

9 5/8" at 120' with 125 sacks regular cement circulated to surface.
5 1/2" at 2805' with 75 sacks regular cement, 75 sacks

The NE/4 of Section 11 is dedicated to this well.
NE/4 of 079160.

I understand that this plan of work must receive approval in writing by the Geological Survey before operations may be commenced.

Company El Paso Natural Gas Company

Address Box 997
Farmington, New Mexico

By ORIGINAL SIGNED E. S. OBERLY
Title Petroleum Engineer

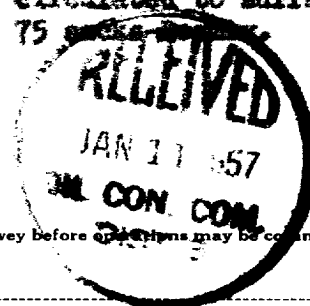

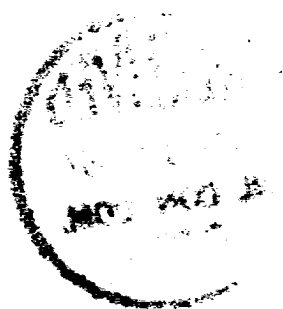

NEW MEXICO
OIL CONSERVATION COMMISSION

WELL LOCATION AND/OR GAS PRODUCTION PLAT

DECEMBER 28, 1956

EL PASO NATURAL GAS COMPANY

RINCON UNIT

SF 079160

92

11

26 N

7 W

1650

NORTH

1835

EAST

RIO ARriba

6541

PICTURED CLIFF

SO. BLANCO

160 AC.
(1882 PLAT)

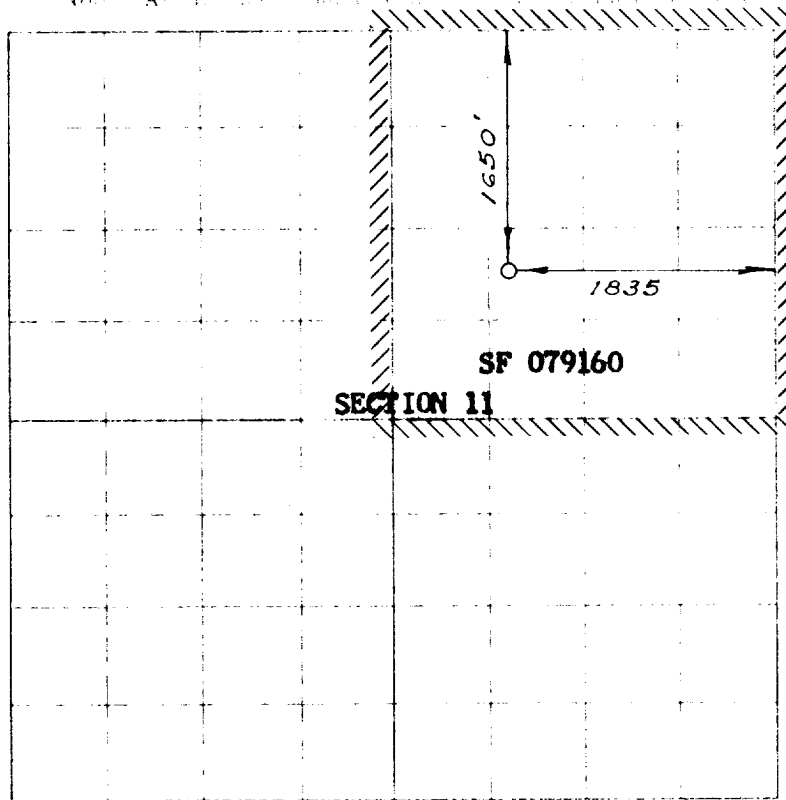

Scale: 1 inch = 400 feet

I hereby certify that the above plat was prepared from
field notes of actual surveys made by me or under my
supervision and that the same are true and correct to the
best of my knowledge and belief.

Date Surveyed: **DECEMBER 21, 1956**

E. O. Walker
Registered Professional Engineer and/or Land Surveyor

(Seal)

Farmington, New Mexico

NOTE

This section of
plat is to be used
for well location only.



1. Is this well owned by:
Yes _____
No _____
2. If the well is the property of
a person or persons other than the
applicant, is it within the
indicated acreage?
Yes _____
No _____

ORIGINAL SIGNED E. S. OBERLY

Petroleum Engineer

El Paso Natural Gas Co.

Box 997, Farmington, N.M.