

IN REPLY REFER TO:



COPY TO U.C.C.

UNITED STATES
DEPARTMENT OF THE INTERIOR
GEOLOGICAL SURVEY
P. O. Box 965
Farmington, New Mexico

June 23, 1955

Candado Exploration Company
1100 Idaho Tower
Phoenix, Arizona

Re: Santa Fe 079161

Gentlemen:

Receipt is acknowledged of your "Notice of Intention to Drill" dated June 22, 1955 covering your well No. 7 Candado in SW $\frac{1}{4}$ Sec. 10, T. 26 N., R. 7 W., N. M. P. M., Rio Arriba County, New Mexico, South Blance P.C.

Your proposed work is hereby approved subject to compliance with the provisions of the "Oil and Gas Operating Regulations" revised May 25, 1942, a copy of which will be sent to you on request, and subject to the following conditions:

1. Drilling operations so authorized are subject to the attached sheet for general conditions of approval.
2. Furnish copies of all logs.

Very truly yours,

(Orig. Sgd.) A. P. KLEEMAN

A. P. Kleeman
Acting District Engineer

APKleeman:cc

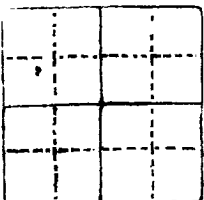

IN REPLY REFER TO:

UNITED STATES
DEPARTMENT OF THE INTERIOR
GEOLOGICAL SURVEY
P. O. Box 308
Washington, New Mexico



COPY TO U.S.G.

June 23, 1922

Canada Petroleum Company
1100 Lava Tower
Phoenix, Arizona

Dear Sir:

Gentlemen:

Receipt is acknowledged of your check of \$1000.00 in relation to
"Title" dated June 23, 1922 covering your well No. 1 Canada in the
T. 28 N., R. 12 E., S. 10, T. 28 N., R. 12 E., S. 10, T. 28 N., R. 12 E., S. 10,
New Mexico, South Dakota P.O.

Your proposed work is hereby approved and authorized to continue
with the provisions of the "Oil and Gas Leasing Regulations" provided
May 22, 1918, a copy of which will be sent to you on request, and sub-
ject to the following conditions:

1. Drilling operations as authorized are subject to the
attached sheet for general conditions of approval.
2. Monthly copies of all logs.

Very truly yours,

Wm. S. Kirtland

A. T. Kirtland
Acting District Engineer

RECEIVED

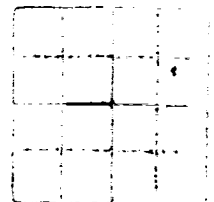
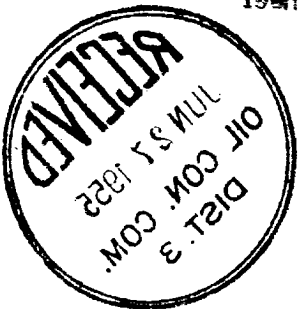

Land Office Santa Fe

Lease No. 079161

Unit NW/4 Sec. 10 is Designated Drilling Unit

(SUBMIT IN TRIPLICATE)
UNITED STATES
DEPARTMENT OF THE INTERIOR
GEOLOGICAL SURVEY

INDUSTRY NOTICES AND REPORTS ON WELLS

NOTICE OF INTENTION TO DRILL	<input checked="" type="checkbox"/>	SUBSEQUENT REPORT OF WATER SHUT-OFF
NOTICE OF INTENTION TO CHANGE PLANS	<input type="checkbox"/>	SUBSEQUENT REPORT OF SHOOTING OR ACIDIZING
NOTICE OF INTENTION TO TEST WATER SHUT-OFF	<input type="checkbox"/>	SUBSEQUENT REPORT OF ALTERING CASING
NOTICE OF INTENTION TO RE-DRILL OR REPAIR WELL	<input type="checkbox"/>	SUBSEQUENT REPORT OF REDRILLING OR REPAIR
NOTICE OF INTENTION TO SHOOF OR ACIDIZE	<input type="checkbox"/>	SUBSEQUENT REPORT OF ABANDONMENT
NOTICE OF INTENTION TO PULL OR ALTER CASING	<input type="checkbox"/>	SUPPLEMENTARY WELL HISTORY
NOTICE OF INTENTION TO ABANDON WELL	<input type="checkbox"/>	

RECEIVED
JUN 27 1955

U.S. GEOLOGICAL SURVEY
FARMINGTON, NEW MEXICO

(INDICATE ABOVE BY CHECK MARK NATURE OF REPORT, NOTICE, OR OTHER DATA)

June 22nd, 19 55

Well No. 7 is located 1550 ft. from N line and 990 ft. from E line of sec. 10
SW/4 NW/4 Sec. 10 (Twp.) 26N (Range) 7W (Meridian)
South Blanco P.C. (Field) Rio Arriba (County or Subdivision) New Mexico (State or Territory)

The elevation of the derrick floor above sea level is _____ ft. (Not available. Will furnish later)

DETAILS OF WORK

(State names of and expected depths to objective sands; show sizes, weights, and lengths of proposed casings; indicate mudding jobs, cementing points, and all other important proposed work)

Pictured Cliffs Sand test. Estimated total depth 2300'.
Surface Casing: 90' of 8-5/8" OD 24# J-55 casing cemented with 80 sacks.
Production " : Approximately 2300' of 5-1/2" OD 14# J-55 casing cemented with 100 sacks.

If commercial production is indicated, the producing section will be shot with nitroglycerin and/or sand-oil treated.

I understand that this plan of work must receive approval in writing by the Geological Survey before operations may be commenced.

Company CARRADO PRODUCTION COMPANY
Address 1400 Luna Tower
Phoenix, Arizona

By Henry J. Sachs
Title President

RECEIVED
JUN 27 1955
OIL CON. COM.
DIST. 3



(SUBMIT IN TRIPLICATE)

UNITED STATES
DEPARTMENT OF THE INTERIOR
GEOLOGICAL SURVEY

Land Office Santa Fe
Lease No. 079161
Unit NW/4 Sec. 10 is
Designated Drilling Unit

SUNDRY NOTICES AND REPORTS ON WELLS

NOTICE OF INTENTION TO DRILL.....	<input checked="" type="checkbox"/>	SUBSEQUENT REPORT OF WATER SHUT-OFF.....
NOTICE OF INTENTION TO CHANGE PLANS.....	<input type="checkbox"/>	SUBSEQUENT REPORT OF SHOOTING OR ACIDIZING.....
NOTICE OF INTENTION TO TEST WATER SHUT-OFF.....	<input type="checkbox"/>	SUBSEQUENT REPORT OF ALTERING CASING.....
NOTICE OF INTENTION TO RE-DRILL OR REPAIR WELL.....	<input type="checkbox"/>	SUBSEQUENT REPORT OF REDRILLING OR REPAIR.....
NOTICE OF INTENTION TO SHOOT OR ACIDIZE.....	<input type="checkbox"/>	SUBSEQUENT REPORT OF ABANDONMENT.....
NOTICE OF INTENTION TO PULL OR ALTER CASING.....	<input type="checkbox"/>	SUPPLEMENTARY WELL HISTORY.....
NOTICE OF INTENTION TO ABANDON WELL.....	<input type="checkbox"/>	

(INDICATE ABOVE BY CHECK MARK NATURE OF REPORT, NOTICE, OR OTHER DATA.)

RECEIVED
JUN 23 1955
U.S. GEOLOGICAL SURVEY
FARMINGTON, NEW MEXICO

June 22nd, 19 55

Well No. 7 is located 1550 ft. from $\left\{ \begin{matrix} N \\ S \end{matrix} \right\}$ line and 990 ft. from $\left\{ \begin{matrix} E \\ W \end{matrix} \right\}$ line of sec. 10
SW/4 NW/4 Sec. 10 26N 7W N.M.P.M.
(1/4 Sec. and Sec. No.) (Twp.) (Range) (Meridian)
South Blanco P.C. Rio Arriba New Mexico
(Field) (County or Subdivision) (State or Territory)

The elevation of the derrick floor above sea level is ft. (Not available. Will furnish later)

DETAILS OF WORK

(State names of and expected depths to objective sands; show sizes, weights, and lengths of proposed casings; indicate mudding jobs, cementing points, and all other important proposed work)

Pictured Cliffs Sand test. Estimated total depth 2300'.

Surface Casing: 90' of 8-5/8" OD 24# J-55 casing cemented with 80 sacks.

Production " : Approximately 2200' of 5-1/2" OD 14# J-55 casing cemented with 100 sacks.

If commercial production is indicated, the producing section will be shot with nitroglycerin and/or sand-oil treated.

RECEIVED
JUN 27 1955
OIL CON. COM.
DIST. 3

I understand that this plan of work must receive approval in writing by the Geological Survey before operations may be commenced.

Company CANDADO PRODUCTION COMPANY

Address 1400 Lubra Tower

Phoenix, Arizona

By Genay H. Hatcher

Title President

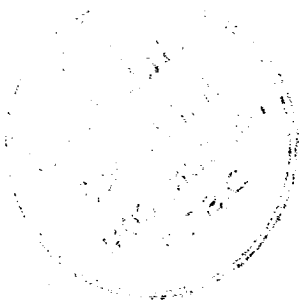

Company Huerfanito Drilling Co.

Lease _____ Well No. _____

Sec. 10 T. 26 N R. 7 W N.M.P.M.

Location 1550 feet from north line; 990 feet
from west line.

Elevation: _____

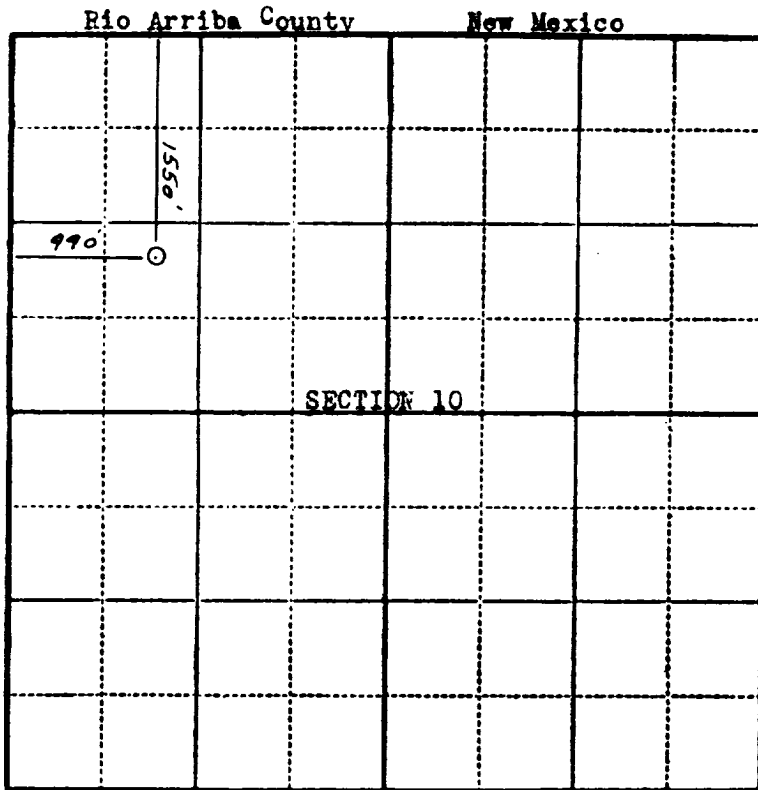

Scale—4 inches equal 1 mile.

This is to certify that the above plat was prepared from field notes of actual surveys made by me or under my supervision and that the same are true and correct to the best of my knowledge and belief.

Stephen H. Kinney
STEPHEN H. KINNEY
Registered Professional
Engineer and Land Surveyor

Surveyed June 18, 19 55

Seal:

RECEIVED
JUN 21 1955
U. S. GEOLOGICAL SURVEY
FARMINGTON NEW MEXICO