

(SUBMIT IN TRIPLICATE)

Indian Agency JicarillaApacheAllottee Tribal LeaseLease No. Contract NO. 152UNITED STATES  
DEPARTMENT OF THE INTERIOR  
GEOLOGICAL SURVEY

## SUNDRY NOTICES AND REPORTS ON WELLS

NOTICE OF INTENTION TO DRILL	<input checked="" type="checkbox"/>	SUBSEQUENT REPORT OF WATER SHUT-OFF	
NOTICE OF INTENTION TO CHANGE PLANS		SUBSEQUENT REPORT OF SHOOTING OR ACIDIZING	MAY 23 1963
NOTICE OF INTENTION TO TEST WATER SHUT-OFF		SUBSEQUENT REPORT OF ALTERING CASING	
NOTICE OF INTENTION TO REDRILL OR REPAIR WELL		SUBSEQUENT REPORT OF REDRILLING OR REPAIR	
NOTICE OF INTENTION TO SHOOT OR ACIDIZE		SUBSEQUENT REPORT OF ABANDONMENT	U. S. GEOLOGICAL SURVEY
NOTICE OF INTENTION TO PULL OR ALTER CASING		SUPPLEMENTARY WELL HISTORY	FARMINGTON, NEW MEXICO
NOTICE OF INTENTION TO ABANDON WELL			

(INDICATE ABOVE BY CHECK MARK NATURE OF REPORT, NOTICE, OR OTHER DATA)

May 21, 1963

Well No. 4-8 is located 1550 ft. from N line and 890 ft. from W line of sec. 8

<u>NW/4</u>	<u>Sec. 8</u>	<u>26N</u>	<u>5W</u>	<u>NMPM</u>
(1/4 Sec. and Sec. No.)		(Twp.)	(Range)	(Meridian)
<u>Basin Dakota</u>	<u>Rio Arriba</u>	<u>New Mexico</u>		
(Field)	(County or Subdivision)	(State or Territory)		

## Tapicito Pictured Cliffs

The elevation of the derrick floor above sea level is \_\_\_\_\_ ft.

## DETAILS OF WORK

(State names of and expected depths to objective sands; show sizes, weights, and lengths of proposed casings; indicate mudding jobs, cementing points, and all other important proposed work)

Drill 13" hole to 300', set 9 5/8" surface casing, drill to total depth of 3675' with mud, run 7" casing and cement drill 7" casing shoe, drill to total depth 7620' with gas, run 4 1/2" liner and cement. Selectively perforate and sand frac Dakota and Pictured Cliffs formations and effect an approved type dual completion using a packer and separate tubing strings.

I understand that this plan of work must receive approval in writing by the Geological Survey before operations may be commenced.

Company Consolidated Oil & Gas, Inc.Address 4150 East Mexico Ave.Denver, 22 Colo.

By

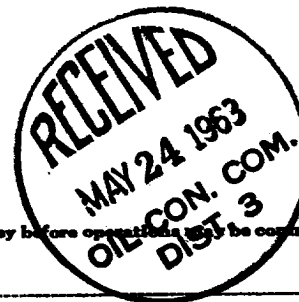
Title Area Superintendent

100-100000

100-100000

100-100000

100-100000

100-100000

100-100000

100-100000

100-100000

100-100000

100-100000

100-100000

100-100000

100-100000

100-100000

100-100000

100-100000

100-100000

100-100000

100-100000

100-100000

100-100000

## NEW MEXICO OIL CONSERVATION COMMISSION

## Well Location and Acreage Dedication Plat

Section A.

Date \_\_\_\_\_

Operator CONSOLIDATED OIL AND GAS, INC. Lease JICARILLA  
 Well No. 4-8 Unit Letter E Section 8 Township 26 NORTH Range 5 WEST NMPM  
 Located 1550 Feet From the NORTH Line, 890 Feet From the WEST Line  
 County RIO ARriba G. L. Elevation 6958' Dedicated Acreage 160 Acres  
 Name of Producing Formation PICTURED CLIFFS Pool TAPICOTO PICTURED CLIFFS

1. Is the Operator the only owner in the dedicated acreage outlined on the plat below?  
 Yes ☒ No \_\_\_\_\_
2. If the answer to question one is "no", have the interests of all the owners been consolidated by communitization agreement or otherwise? Yes \_\_\_\_\_ No \_\_\_\_\_. If answer is "yes", Type of Consolidation.

3. If the answer to question two is "no", list all the owners and their respective interests below:

Owner

Land Description



Section B.

Note: All distances must be from outer boundaries of section.

This is to certify that the information in Section A above is true and complete to the best of my knowledge and belief.

Consolidated Oil & Gas.

(Operator)

(Representative)

4150 East Mexico Ave.

(Address)

Denver 22 Colorado

Ref: GLO plat dated 4 Nov. 1882

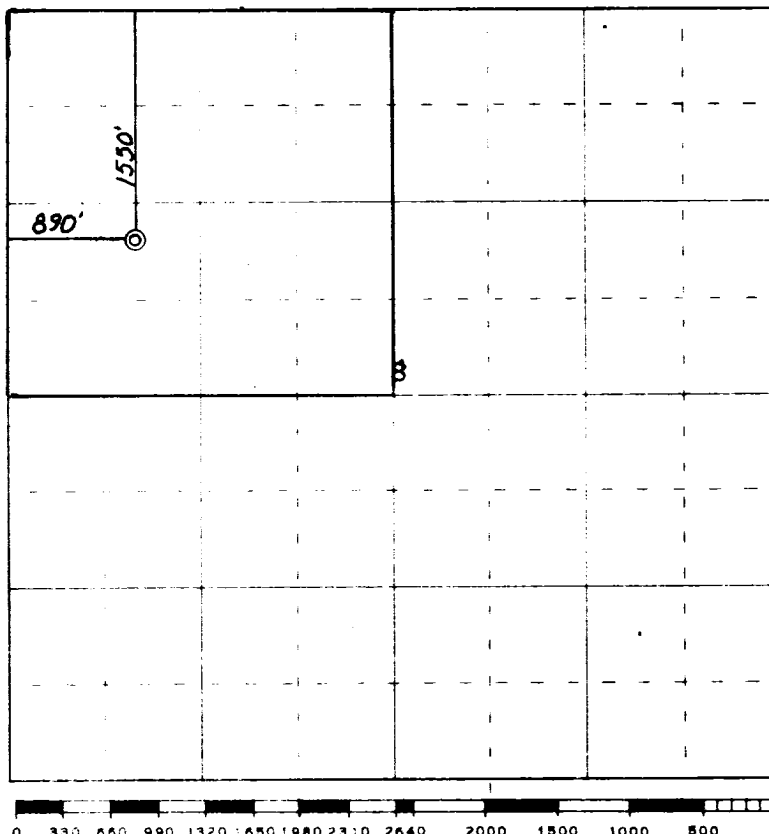

Scale 4 inches equal 1 mile

This is to certify that the above plat was prepared from field notes of actual surveys made by me or under my supervision and that the same are true and correct to the best of my knowledge and belief.

(Seal)

Farmington, New Mexico

Date Surveyed 21 May 1963

James P. Leese  
 Registered Professional Engineer and/or Land Surveyor  
 James P. Leese, N. Mex. Reg. No. 1463

## NEW MEXICO OIL CONSERVATION COMMISSION

## Well Location and Acreage Dedication Plat

Section A.

Date \_\_\_\_\_

Operator CONSOLIDATED OIL AND GAS, INC. Lease JICARILLA  
 Well No. 4-8 Unit Letter E Section 8 Township 26 NORTH Range 5 WEST NMPM  
 Located 1550 Feet From the NORTH Line, 890 Feet From the WEST Line  
 County RIO ARriba G. L. Elevation 6958' Dedicated Acreage 320 Acres  
 Name of Producing Formation DAKOTA Pool Basin DAKOTA

1. Is the Operator the only owner in the dedicated acreage outlined on the plat below?  
 Yes X No \_\_\_\_\_
2. If the answer to question one is "no", have the interests of all the owners been consolidated by communitization agreement or otherwise? Yes \_\_\_\_\_ No \_\_\_\_\_. If answer is "yes", Type of Consolidation.
3. If the answer to question two is "no", list all the owners and their respective interests below:

Owner

Land Description

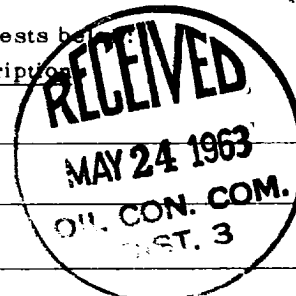

Section B.

Note: All distances must be from outer boundaries of section.

This is to certify that the information in Section A above is true and complete to the best of my knowledge and belief.

**Consolidated Oil & Gas Inc.**

(Operator)

(Representative)

**4190 East Mexico Ave**

(Address)

**Denver 22, Colorado**

Ref: GLO plat dated 4 Nov. 1882

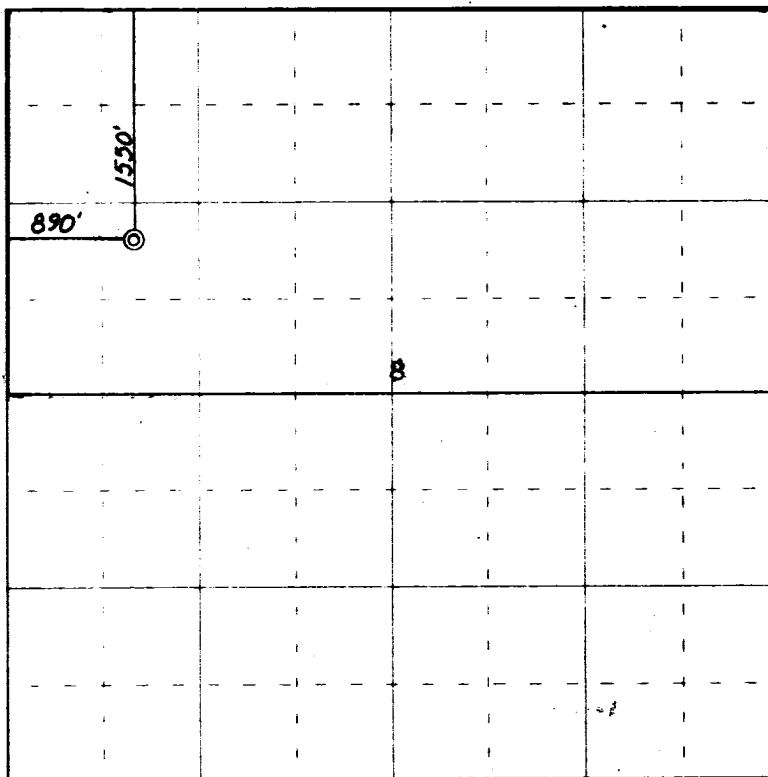

0 330 660 990 1320 1650 1980 2310 2640 2000 1500 1000 500 0

Scale 4 inches equal 1 mile

This is to certify that the above plat was prepared from field notes of actual surveys made by me or under my supervision and that the same are true and correct to the best of my knowledge and belief.

Date Surveyed 21 May 1963

James P. Leese  
 Registered Professional Engineer and/or Land Surveyor  
 James P. Leese, N. Mex. Reg. No. 1463

Farmington, New Mexico