

UNITED STATES  
DEPARTMENT OF THE INTERIOR  
GEOLOGICAL SURVEY

Allottee .....

Lease No. **Jicar 11 a "H"**

## SUNDRY NOTICES AND REPORTS ON WELLS

NOTICE OF INTENTION TO DRILL.....	<input checked="" type="checkbox"/>	SUBSEQUENT REPORT OF WATER SHUT-OFF.....
NOTICE OF INTENTION TO CHANGE PLANS.....	<input type="checkbox"/>	SUBSEQUENT REPORT OF SHOOTING OR ACIDIZING.....
NOTICE OF INTENTION TO TEST WATER SHUT-OFF.....	<input type="checkbox"/>	SUBSEQUENT REPORT OF ALTERING CASING.....
NOTICE OF INTENTION TO REDRILL OR REPAIR WELL.....	<input type="checkbox"/>	SUBSEQUENT REPORT OF REDRILLING OR REPAIR.....
NOTICE OF INTENTION TO SHOOT OR ACIDIZE.....	<input type="checkbox"/>	SUBSEQUENT REPORT OF ABANDONMENT.....
NOTICE OF INTENTION TO PULL OR ALTER CASING.....	<input type="checkbox"/>	SUPPLEMENTARY WELL HISTORY.....
NOTICE OF INTENTION TO ABANDON WELL.....	<input type="checkbox"/>	

(INDICATE ABOVE BY CHECK MARK NATURE OF REPORT, NOTICE, OR OTHER DATA)

May 29, 1957

Well No. **3** is located **990** ft. from **N** line and **990** ft. from **E** line of sec. **12**Section 12 26 N 3-E N.M.P.M.  
(34 Sec. and Sec. No.) (Twp.) (Range) (Meridian)Blanco  
(Field)Rio Arriba  
(County or Subdivision)New Mexico  
(State or Territory)The elevation of the derrick floor above sea level is **7119** ft.

## DETAILS OF WORK

(State names of and expected depths to objective sands; show sizes, weights, and lengths of proposed casings; indicate mudding jobs, and other important proposed work)

We propose to drill the above well to a Total Depth of 6300' with Rotary Tools. We expect to test the following zones at the following approximate depths if indicative of oil or gas show:

**SAND**  
**Pictured Cliffs**  
**Mesa Verde**

**EXPECTED TOP**  
**3600'**  
**6300'**

We expect to test any other zones that appear productive of oil or gas. **CASING PROGRAM:** Approximately 300' of 10-1/4" Surface Casing w/approximately 300 sz cement, approximately 4200' of 7-5/8" intermediate casing w/approximately 150 sz cement, approximately 2300' of 5 1/2" liner w/approximately 200 sz cement on bottom and will squeeze top of liner w/approximately 200 sz cement. We propose to perforate and sandwaterflood productive zones in the Pictured Cliffs and Mesa Verde Zones for Comp.

I understand that this plan of work must receive approval in writing by the Geological Survey before operations may be commenced.

Company **Magnolia Petroleum Company**Address **Box 633**  
**Midland, Texas**By **R. Y. Gorman**  
**R. Y. GORMAN**  
Title **Division Superintendent**



NEW MEXICO  
OIL CONSERVATION COMMISSION

Form C-128

Well Location and/or Gas Proration Plat

Date May 24, 1957

Operator MAGNOLIA PETROLEUM COMPANY Lease JICARILLA "H"

Well No. Three (3) Section 12 Township 26N Range 3W NMPM

Located 990 Feet From North Line, 990 Feet From East Line,

Edo Arriba County, New Mexico. G. L. Elevation 7200

Name of Producing Formation Mesa Verde Pool Blanco Dedicated Acreage 320

(Note: All distances must be from outer boundaries of Section)

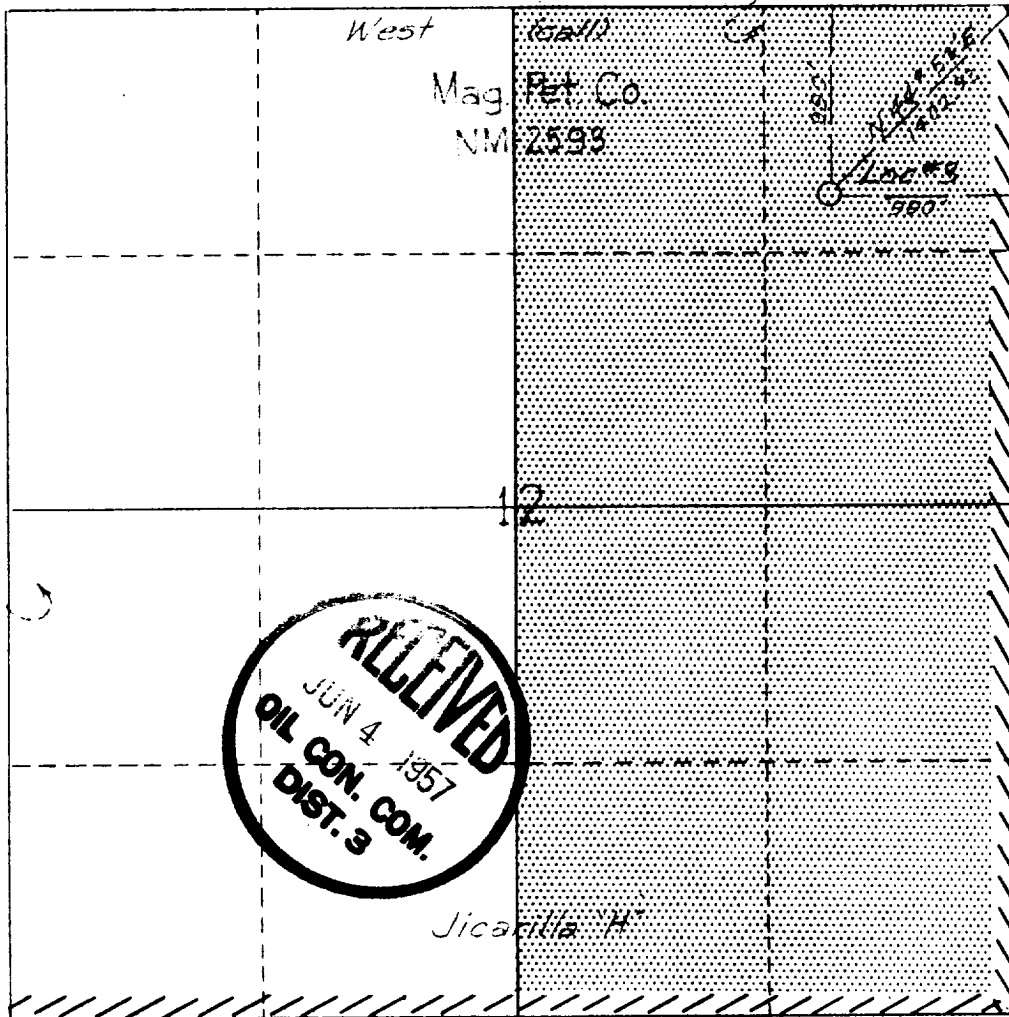

Scale: 1" = 1000'

LEGEND

Lease Boundary

Allocated Acreage

1. Is this Well a Dual Comp.? Yes X No       

2. If the answer to Question 1 is yes, are there any other dually completed wells within the dedicated acreage? Yes        No X

This is to certify that the above plat was prepared from field notes of actual surveys made by me or under my supervision and that the same are true and correct to the best of my knowledge and belief.

Name R. T. German  
Position R.T. GERMAN, Division Superintendent  
Representing Magnolia Petroleum Company  
Address Box 633 - Midland, Texas

Date Surveyed April 2, 1957

Carl E. Turner  
Registered Professional Engineer and/or Land Surveyor

#2400

NEW MEXICO  
OIL CONSERVATION COMMISSION

Form C-128

Well Location and/or Gas Proration Plat

Date May 24, 1957

Operator MAGNOLIA PETROLEUM COMPANY Lease JICARILLA "H"  
Well No. Three (3) Section 12 Township 26N Range 2W NMPM  
Located 990 Feet From North Line, 990 Feet From East Line,  
Rio Arriba County, New Mexico. G. L. Elevation 7100  
Undesignated Pictured  
Name of Producing Formation Pictured Cliffs Pool Cliffs Gas Dedicated Acreage 160

(Note: All distances must be from outer boundaries of Section)

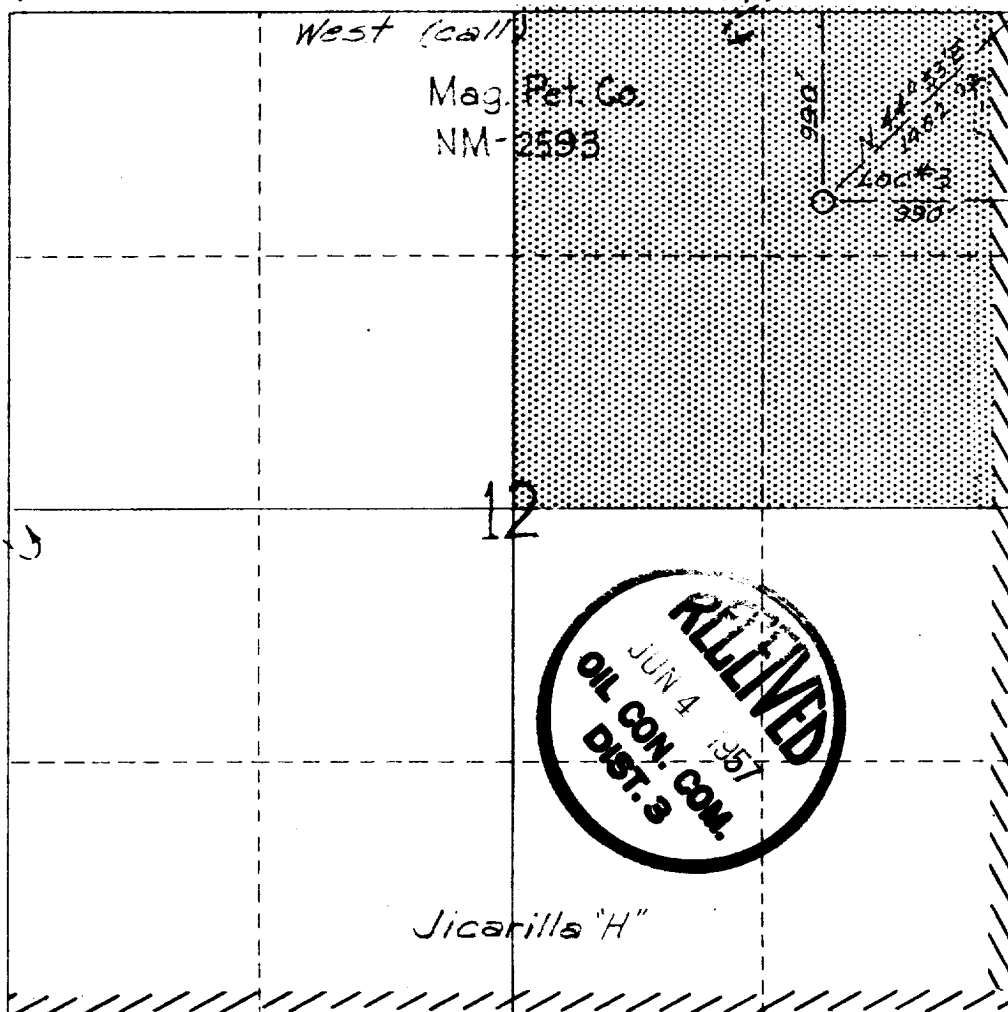

Scale: 1" = 1000'

LEGEND

Allocated  
Acreage



Lease  
Boundary



1. Is this Well a Dual Comp.? Yes X No. \_\_\_\_\_

2. If the answer to Question 1 is yes, are there any other dually completed wells within the dedicated acreage?

Yes \_\_\_\_\_ No X

This is to certify that the above plat was prepared from field notes of actual surveys made by me or under my supervision and that the same are true and correct to the best of my knowledge and belief.

Name R.T. GERMAN  
Position Division Superintendent  
Representing Magnolia Petroleum Company  
Address Box 633 - Midland, Texas

Date Surveyed April 2, 1957

Carl E. Turner  
Registered Professional Engineer and/or Land Surveyor  
#2495