

District I
P.O. Box 1980, Hobbs, NM

District II
P.O. Drawer DD, Artesia, NM 88211

District III
1000 Rio Brazos Rd, Aztec, NM 87410

Denny E. Faust
DEPUTY OIL & GAS INSPECTOR

State of New Mexico
Energy, Minerals and Natural Resources Department

SUBMIT 1 COPY TO
APPROPRIATE
DISTRICT OFFICE
AND 1 COPY TO
SANTA FE OFFICE

FEB 26 1998

OIL CONSERVATION DIVISION

2040 South Pacheco Street
Santa Fe, New Mexico 87505

Approved
PIT REMEDIATION AND CLOSURE REPORT

Operator: PNM Gas Services (Caulkins) Telephone: 324-3764

Address: 603 W. Elm Street Farmington, NM 87401

Facility or Well Name: Breach A #132E

Location: Unit D Sec 9 T 26N R 6W County Rio Arriba

Pit Type: Separator Dehydrator Other Drip

Land Type: BLM ☒ State Fee Other

Pit Location: Pit dimensions: length 20 width 20 depth 3

(Attach diagram) Reference: wellhead ☒ other

Footage from reference: 270'

Direction from reference: 85 Degrees ☒ East North
of
 West South ☒

Depth to Ground Water:

Less than 50 feet (20 points)
50 feet to 99 feet (10 points)
Greater than 100 feet (0 points) 0

(Vertical distance from contaminants to
seasonal high water elevation of ground
water)

Wellhead Protection Area:

(Less than 200 feet from a private
domestic water source, or: less than 1,000
feet from all other water sources)

Yes (20 points)
No (0 points) 0

Distance to Surface Water:

Less than 200 feet (20 points)
200 feet to 1,000 feet (10 points)
Greater than 1,000 feet (0 points) 0

(Horizontal distance to perennial lakes,
ponds, rivers, streams, creeks, irrigation
canals and ditches)

RANKING SCORE (TOTAL POINTS): 0

RECEIVED
NM - 1 1997
OIL CON. DIV.
DIST. 3

Breach A #132E

Date Remediation Started: 8/6/97 Date Completed: 8/6/97Remediation Method: Excavation x Approx. Cubic Yard 264

(Check all appropriate sections)

Landfarmed x Amount Landfarmed (cubic yds) 264

Other _____

Remediation Location: Onsite x Offsite _____
(i.e., landfarmed onsite, name and location of offsite facility)

Backfill Material Location: _____

General Description of Remedial Action:

Excavated contaminated soil to pit size of 18' X 22' X 18' and landfarmed soil onsite within a bermed area at a depth of 6" to 12". Soil was aerated by plowing until soil met regulatory levels.Ground Water Encountered: No ✓ Yes _____ Depth _____

Final Pit Closure Sampling:

Sample Location 5 pt composite-4 side walls and center of pit bottom

(if multiple samples, attach sample result and diagram of sample locations and depths.)

Sample depth 16' walls and 18' bottom.Sample date 8/6/97 Sample time 10:00:00 AM

Sample Results

Benzene (ppm) < 0.1000Total BTEX (ppm) 24.7580

Field headspace (ppm) _____

TPH (ppm) 2011.00 Method 8015A

Vertical Extent (ft) _____ Risk Assessment form attached Yes _____ No _____

Ground Water Sample: Yes _____ No ✓ (If yes, see attached Groundwater Site Summary Report)

I HEREBY CERTIFY THAT THE INFORMATION ABOVE IS TRUE AND COMPLETE TO THE BEST OF MY KNOWLEDGE AND MY BELIEF

DATE October 27, 1997

SIGNATURE

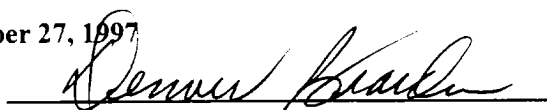
PRINTED NAME Denver Bearden
AND TITLE Administrator III

Breach A#132 E
Caulkins Oil
Sec. 9, 24N, 6W, D

8-4-97

Start of excavation :

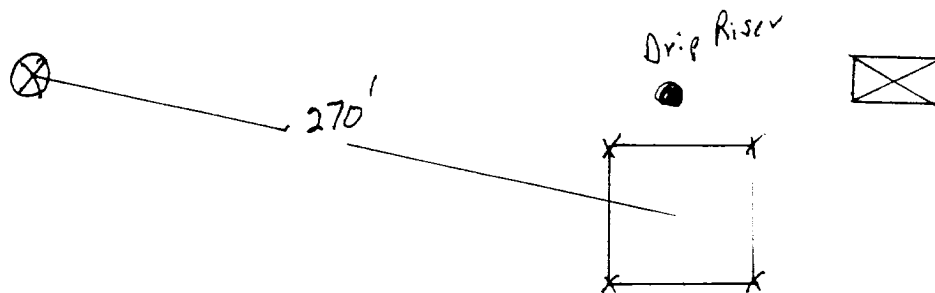

End of excavation :

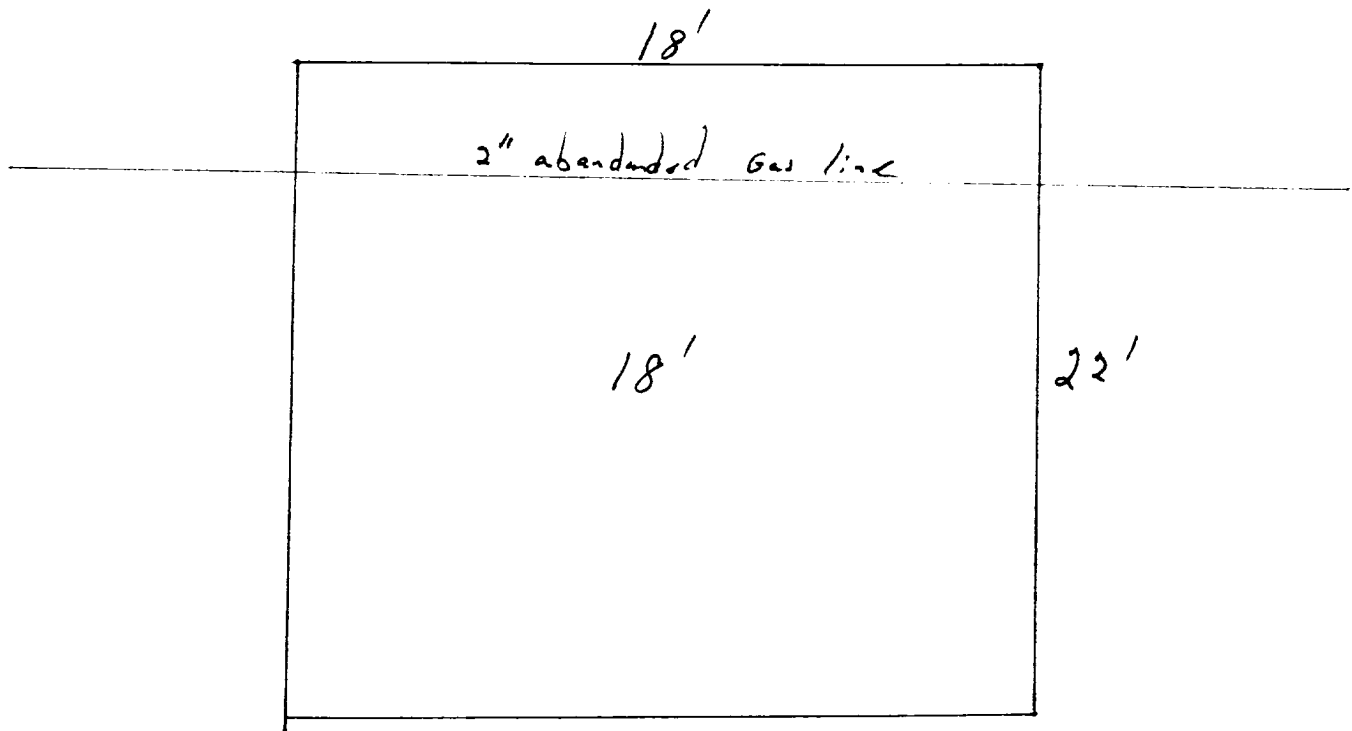

OFF: (505) 325-5667



LAB: (505) 325-1556

ANALYTICAL REPORT

Attn: *Denver Bearden*
Company: *PNM Gas Services*
Address: *603 W. Elm*
City, State: *Farmington, NM 87401*

Date: *16-Aug-97*
COC No.: *5935*
Sample No.: *15670*
Job No.: *2-1000*

Project Name: *PNM Gas Services - Breech A #132E*
Project Location: *9708061000; Composite, 4 Walls @ 16' and Bottom @ 18'*
Sampled by: *GC* Date: *6-Aug-97* Time: *10:00*
Analyzed by: *HR/DC* Date: *14-Aug-97*
Sample Matrix: *Soil*

Laboratory Analysis

Parameter	Results as Received	Unit of Measure	Limit of Quantitation	Unit of Measure
<i>Diesel Range Organics (C10 - C28)</i>	2011	mg/kg	5	mg/kg

ND - Not Detected at Limit of Quantitation

Quality Assurance Report

DRO QC No.: 0548-STD

Continuing Calibration Verification

Parameter	Method Blank	Unit of Measure	True Value	Analyzed Value	RPD	RPD Limit
<i>Diesel Range (C10 - C28)</i>	ND	ppm	200	213	6.3	15%

Matrix Spike

Parameter	1- Percent Recovered	2 - Percent Recovered	Limit	RPD	RPD Limit
<i>Diesel Range (C10-C28)</i>	82	88	(70-130)	7	20%

Method - *SW-846 EPA Method 8015A mod. - Nonhalogenated Volatile Hydrocarbons by Gas Chromatography*

Approved by: *[Signature]*
Date: *8/16/97*

P.O. BOX 2606 • FARMINGTON, NM 87499

OFF: (505) 325-5667



LAB: (505) 325-1556

ANALYTICAL REPORT

Attn: *Denver Bearden*
Company: *PNM Gas Services*
Address: *603 W. Elm*
City, State: *Farmington, NM 87401*

Date: *18-Aug-97*
COC No.: *5935*
Sample No.: *15670*
Job No.: *2-1000*

Project Name: *PNM Gas Services - Breech A #132E*
Project Location: *9708061000; 4 Walls @ 16' & Bottom @ 18'*
Sampled by: *GC* Date: *6-Aug-97* Time: *10:00*
Analyzed by: *DC* Date: *16-Aug-97*
Sample Matrix: *Soil*

Laboratory Analysis

Parameter	Results as Received	Unit of Measure	Limit of Quantitation	Unit of Measure
<i>Benzene</i>	ND	ug/kg	100	ug/kg
<i>Toluene</i>	403	ug/kg	100	ug/kg
<i>Ethylbenzene</i>	1245	ug/kg	100	ug/kg
<i>m,p-Xylene</i>	17891	ug/kg	100	ug/kg
<i>o-Xylene</i>	5219	ug/kg	100	ug/kg
	<i>TOTAL</i>	24758	ug/kg	

ND - Not Detected at Limit of Quantitation

Method - SW-846 EPA Method 8020A Aromatic Volatile Organics by Gas Chromatography

Approved by: *[Signature]*
Date: *8/18/97*

P.O. BOX 2606 • FARMINGTON, NM 87499

↑
N

9-8-97 @ 1200

Breach A #132E

Caulkins

(D) 9-26N-6W

Rio Arriba

Sample # 9709081200

Land Farm field headspace 7.8 ppm

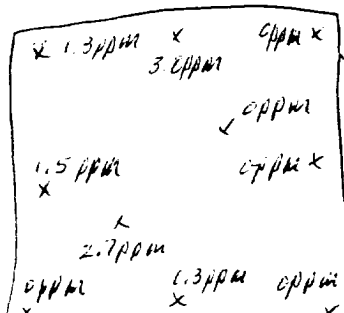
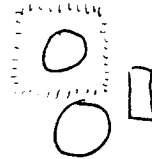

OW + 1

OFF: (505) 325-5667



LAB: (505) 325-1556

ANALYTICAL REPORT

Attn: *Denver Bearden*
Company: *PNM Gas Services*
Address: *603 W. Elm*
City, State: *Farmington, NM 87401*

Date: *15-Sep-97*
COC No.: *5668*
Sample No.: *16103*
Job No.: *2-1000*

Project Name: *PNM Gas Services - Breech A #132E Landfarm*

Project Location: *9709081200; Composite*

Sampled by: *RH* Date: *8-Sep-97* Time: *12:00*

Analyzed by: *DC/HR* Date: *10-Sep-97*

Sample Matrix: *Soil*

Laboratory Analysis

Parameter	Results as Received	Unit of Measure	Limit of Quantitation	Unit of Measure
<i>Diesel Range Organics (C10 - C28)</i>	<i>971</i>	<i>mg/kg</i>	<i>5</i>	<i>mg/kg</i>

ND - Not Detected at Limit of Quantitation

Quality Assurance Report

DRO QC No. 0555-STD

Continuing Calibration Verification

Parameter	Method Blank	Unit of Measure	True Value	Analyzed Value	RPD	RPD Limit
<i>Diesel Range (C10 - C28)</i>	<i>ND</i>	<i>ppm</i>	<i>200</i>	<i>189</i>	<i>5.7</i>	<i>15%</i>

Matrix Spike

Parameter	1- Percent Recovered	2 - Percent Recovered	Limit	RPD	RPD Limit
<i>Diesel Range (C10-C28)</i>	<i>87</i>	<i>92</i>	<i>(70-130)</i>	<i>5</i>	<i>20%</i>

Method - *SW-846 EPA Method 8015A mod. - Nonhalogenated Volatile Hydrocarbons by Gas Chromatography*

Approved by: *[Signature]*
Date: *9/15/97*

P.O. BOX 2606 • FARMINGTON, NM 87499

Telephone: (505) 325-5667 Fax: (505) 325-1556