

(SUBMIT IN TRIPLICATE)

Indian Agency JicarillaApacheUNITED STATES
DEPARTMENT OF THE INTERIOR
GEOLOGICAL SURVEYAllottee Socony MobilLease No. Contract 97

SUNDRY NOTICES AND REPORTS ON WELLS

NOTICE OF INTENTION TO DRILL	<input checked="" type="checkbox"/>	SUBSEQUENT REPORT OF WATER SHUT-OFF	
NOTICE OF INTENTION TO CHANGE PLANS		SUBSEQUENT REPORT OF SHOOTING OR ACIDIZING	
NOTICE OF INTENTION TO TEST WATER SHUT-OFF		SUBSEQUENT REPORT OF ALTERING CASING	
NOTICE OF INTENTION TO REDRILL OR REPAIR WELL		SUBSEQUENT REPORT OF REDRILLING OR REPAIR	
NOTICE OF INTENTION TO SHOOT OR ACIDIZE		SUBSEQUENT REPORT OF ABANDONMENT	
NOTICE OF INTENTION TO PULL OR ALTER CASING		SUPPLEMENTARY WELL HISTORY	
NOTICE OF INTENTION TO ABANDON WELL			

(INDICATE ABOVE BY CHECK MARK NATURE OF REPORT, NOTICE, OR OTHER DATA)

U. S. GEOLOGICAL SURVEY
FARMINGTON, NEW MEXICO

July 5, 1962

Well No. 9 is located 790 ft. from N line and 790 ft. from E line of sec. 7NE 7 26N 3W NMPM
(1/4 Sec. and Sec. No.) (Twp.) (Range) (Meridian)Tapcito Pictured Cliffs Rio Arriba New Mexico
(Field) (County or Subdivision) (State or Territory)
Blanco MesaverdeThe elevation of the derrick floor above sea level is 6966 ft. KB

DETAILS OF WORK

(State names of and expected depths to objective sands; show sizes, weights, and lengths of proposed casings; indicate mudding jobs, cementing points, and all other important proposed work)

Drill to 300' Run 10 3/4" casing and circulate cement to surface. Drill with mud to 4000' and set 7" casing with 200 sx. - this thru Pictured Cliffs. Drill with gas through Mesaverde to about 6100' Hang 4 1/2" liner and cement throughout. Selectively perforate and frac MV and PC effecting approved type dual PC-MV completion with packer separation and two tubing strings.

I understand that this plan of work must receive approval in writing by the Geological Survey before operations may be commenced.

Company Consolidated Oil & Gas, Inc.Address 1700 Broadway2121 Tower Bldg.Denver 2, ColoradoBy [Signature]Title Chief EngineerEVP

NUMBER OF COPIES RECEIVED	
DISTRIBUTION	
SANTA FE	
FILE	
U.S.G.S.	
LAND OFFICE	
TRANSPORTER	OIL GAS
PRODUCTION OFFICE	
OPERATOR	

NEW MEXICO OIL CONSERVATION COMMISSION
WELL LOCATION AND ACREAGE DEDICATION PLAT
 SEE INSTRUCTIONS FOR COMPLETING THIS FORM ON THE REVERSE SIDE

FORM C-128
 Revised 5/1/57

SECTION A

Operator CONSOLIDATED OIL AND GAS, INC.		Lease TRIBAL "C"		Well No. 9
Unit Letter A	Section 7	Township 26 NORTH	Range 3 WEST	County RIO ARriba
Actual Footage Location of Well: 790 feet from the NORTH line and 790 feet from the EAST line				
Ground Level Elev. 6955.0	Producing Formation Pictured Cliffs	Pool Tapicito	Dedicated Acreage: 160 Acres	

1. Is the Operator the only owner in the dedicated acreage outlined on the plat below? YES ☒ NO ____ . ("Owner" means the person who has the right to drill into and to produce from any pool and to appropriate the production either for himself or for himself and another. (65-3-29 (e) NMSA 1935 Comp.)
2. If the answer to question one is "no," have the interests of all the owners been consolidated by communitization agreement or otherwise? YES ____ NO ____ . If answer is "yes," Type of Consolidation ____
3. If the answer to question two is "no," list all the owners and their respective interests below:

Owner	Land Description

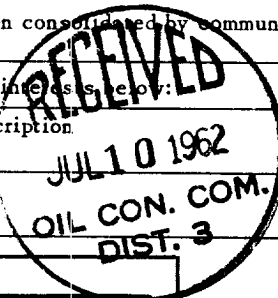

SECTION B

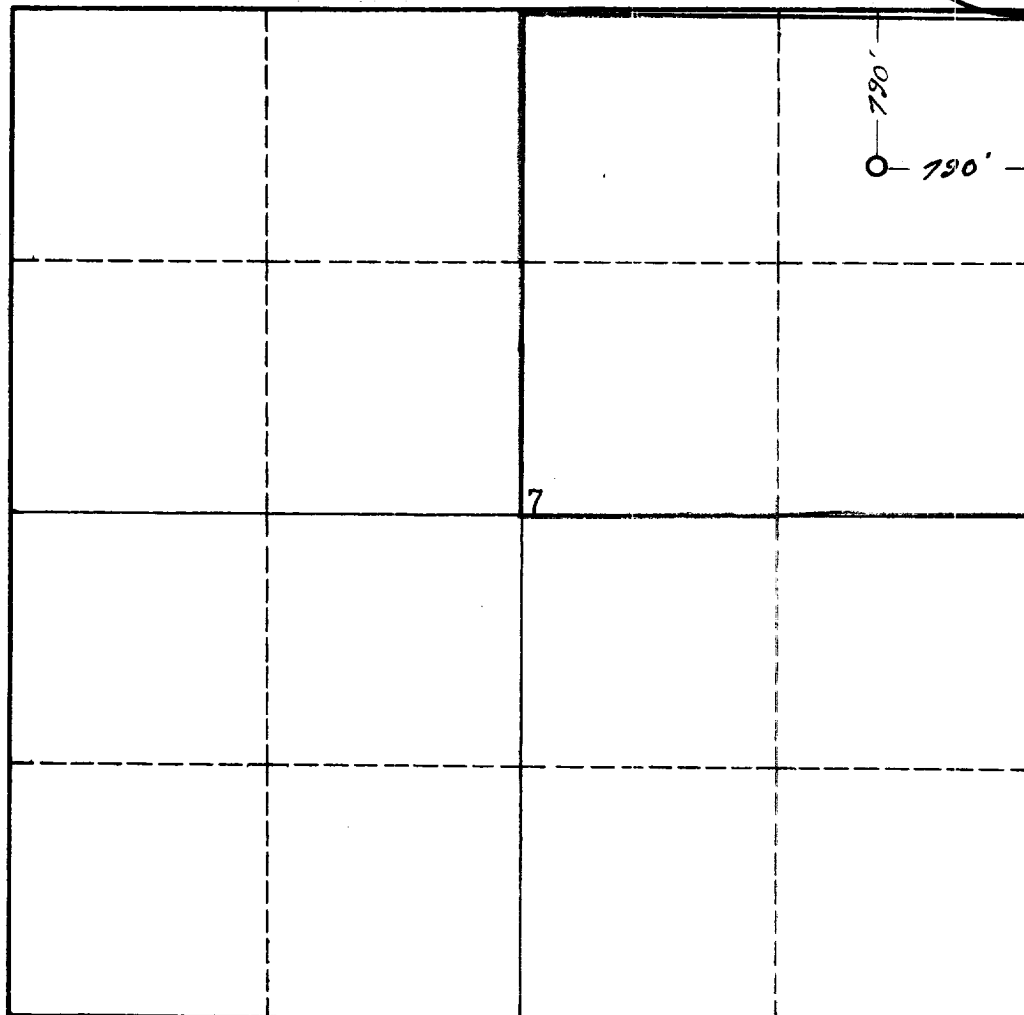

CERTIFICATION

I hereby certify that the information in SECTION A above is true and complete to the best of my knowledge and belief.

Name <i>[Signature]</i>
Position Chief Engineer EMT
Company Consolidated Oil & Gas, Inc.
Date 7-5-62

I hereby certify that the well location shown on the plat in SECTION B was plotted from field notes of actual surveys made by me or under my supervision, and that the same is true and correct to the best of my knowledge and belief.

Date Surveyed 2 March 1962
Registered Professional Engineer and/or Land Surveyor <i>[Signature]</i> James P. Leese
Certificate No. 1463 San Juan Engineering Company

0 330 660 990 1320 1650 1980 2310 2640 2000 1500 1000 500 0

INSTRUCTIONS FOR COMPLETION OF FORM C-128

1. Operator shall furnish and certify to the information called for in Section A.
2. Operator shall outline the dedicated acreage for *both* oil and gas wells on the plat in Section B.
3. A registered professional engineer or land surveyor registered in the State of New Mexico or approved by the Commission shall show on the plat the location of the well and certify this information in the space provided.
4. All distances shown on the plat must be from the outer boundaries of the Section.
5. If additional space is needed for listing owners and their respective interests as required in question 3 of Section A, please use space below.