

STATE OF NEW MEXICO  
OIL CONSERVATION  
COMMISSION  
DISTRICT NO. 3  
Phone 59 P. O. Box 697  
AZTEC, NEW MEXICO

(SUBMIT IN TRIPLICATE)  
UNITED STATES  
DEPARTMENT OF THE INTERIOR  
GEOLOGICAL SURVEY

Land Office New Mexico  
Lease No. 03551  
Unit \_\_\_\_\_

SUNDRY NOTICES AND REPORTS ON WELLS

NOTICE OF INTENTION TO DRILL	SUBSEQUENT REPORT OF WATER SHUT-OFF	DIST <u>3</u>
NOTICE OF INTENTION TO CHANGE PLANS	SUBSEQUENT REPORT OF SHOOTING OR ACIDIZING	
NOTICE OF INTENTION TO TEST WATER SHUT-OFF	SUBSEQUENT REPORT OF ALTERING CASING	
NOTICE OF INTENTION TO RE-DRILL OR REPAIR WELL	SUBSEQUENT REPORT OF REDRILLING OR REPAIR	
NOTICE OF INTENTION TO SHOOT OR ACIDIZE	SUBSEQUENT REPORT OF ABANDONMENT	
NOTICE OF INTENTION TO PULL OR ALTER CASING	SUPPLEMENTARY WELL HISTORY	
NOTICE OF INTENTION TO ABANDON WELL		

(INDICATE ABOVE BY CHECK MARK NATURE OF REPORT, NOTICE, OR OTHER DATA)

December 17, 1951

Well No. 7-35-109 is located 660 ft. from N line and 660 ft. from E line of sec. 3  
SW 1/4, Sec. 3 26N 6W N.M.P.M.  
wildcat (1/4 Sec. and Sec. No.) (Twp.) (Range) (Meridian)  
Rio Arriba County New Mexico  
(Field) (County or Subdivision) (State or Territory)

The elevation of the derrick floor above sea level is \_\_\_\_\_ ft. (To be furnished later)

DETAILS OF WORK

(State names of and expected depths to objective sands; show sizes, weights, and lengths of proposed casings; indicate mudding jobs, cementing points, and all other important proposed work)

This is a Tecito Test for oil.

Propose to drill to approximately 6700' with Rotary Tools.

Casing program: 10 3/4", 36#, w/250 sax.

7 5/8", 26#, w/250 sax.

I understand that this plan of work must receive approval in writing by the Geological Survey before operations may be commenced.

Company LARRY et al Operating Account

Address Room 219  
616 East Central Avenue  
Albuquerque, New Mexico

By E. R. Richardson  
Business Manager  
Title \_\_\_\_\_

Lead Office \_\_\_\_\_  
 Texas No. \_\_\_\_\_  
 U.S. \_\_\_\_\_

**DEPARTMENT OF THE INTERIOR  
 GEOLOGICAL SURVEY  
 UNITED STATES  
 (SUBMIT IN TRIPLICATE)**

NOTICE OF INTENTION TO DRILL  
 NOTICE OF INTENTION TO CHANGE PLANT  
 NOTICE OF INTENTION TO TEST WATER SHUT-OFF  
 NOTICE OF INTENTION TO RE-DRILL OR REPAIR WELL  
 NOTICE OF INTENTION TO SHUT OR ACIDIZE  
 NOTICE OF INTENTION TO TULL OR ALTER CASING  
 NOTICE OF INTENTION TO ABANDON WELL

**SUNDRY NOTICES AND REPORTS ON WELLS**

NOTICE OF INTENTION TO DRILL	SUBSEQUENT REPORT OF WATER SHUT-OFF
NOTICE OF INTENTION TO CHANGE PLANT	SUBSEQUENT REPORT ON SHOOTING OR ACIDIZING
NOTICE OF INTENTION TO TEST WATER SHUT-OFF	SUBSEQUENT REPORT OF ALTERING CASING
NOTICE OF INTENTION TO RE-DRILL OR REPAIR WELL	SUBSEQUENT REPORT OF REPAIRING OR REPAIRING
NOTICE OF INTENTION TO SHUT OR ACIDIZE	SUBSEQUENT REPORT OF ABANDONMENT
NOTICE OF INTENTION TO TULL OR ALTER CASING	SUPPLEMENTARY WELL HISTORY
NOTICE OF INTENTION TO ABANDON WELL	

(INDICATE ABOVE BY CHECK MARK NATURE OF REPORT, NOTICE OR OTHER DATA)

Well No. \_\_\_\_\_ is located \_\_\_\_\_ ft. from \_\_\_\_\_ line and \_\_\_\_\_ ft. from \_\_\_\_\_ line of sec. \_\_\_\_\_  
 (Town and Range No.) (County or Subdivision) (State or Territory)

The elevation of the derrick floor above sea level is \_\_\_\_\_ ft.

**DETAILS OF WORK**

(State names of and expected depths to objective sands; show sizes, weights, and lengths of proposed casing; indicate mudding jobs, cementing points, and all other important proposed work)

\_\_\_\_\_

I understand that this plan of work must receive approval in writing by the Geological Survey before operations may be commenced.

Company \_\_\_\_\_

Address \_\_\_\_\_

By \_\_\_\_\_

Title \_\_\_\_\_

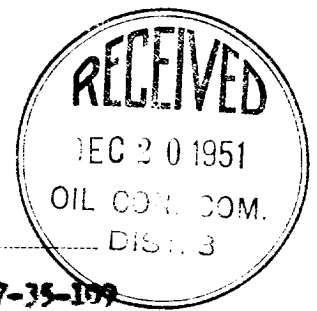

Company Lewy Et Al., Operating Account

Lease New Mexico 03551 Federal-Dowell Well No. 7-35-109

Section 3 Township 26 North Range 6 West N. M. P. M.

Location 660 feet from South line and 560 feet from West line of Section

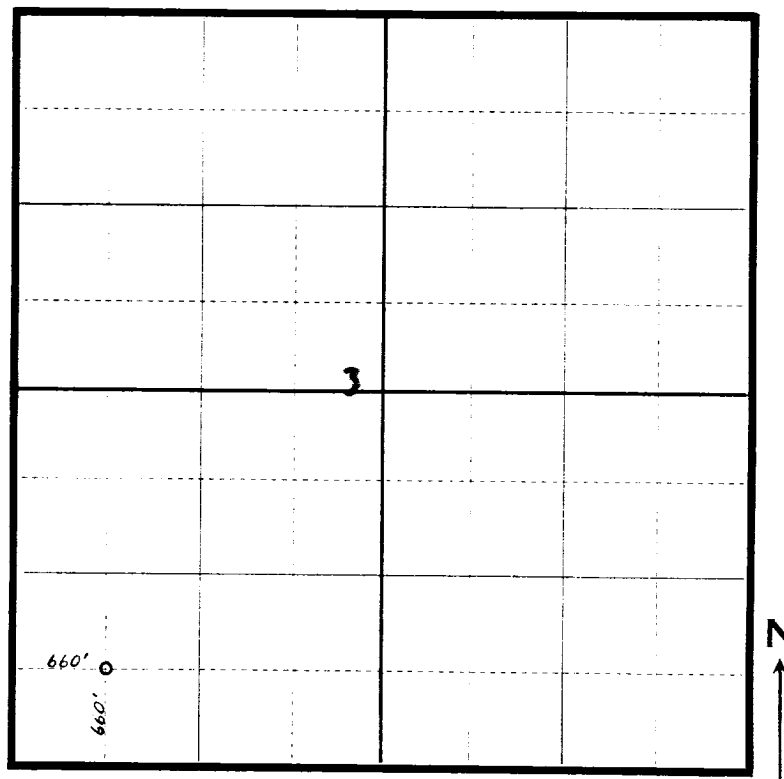

Rio Arriba County, New Mexico. Scale: 4 Inches = 1 Mile.

This is to certify that the above plat was made from field notes of actual surveys made by me or under my supervision and that the representations thereon set forth are true and correct to the best of my knowledge and belief.

*Edmund Ross* **Edmund Ross**  
NEW MEXICO REGISTERED PROFESSIONAL ENGINEER  
AND/OR LAND SURVEYOR NO. 81

Seal:

Surveyed December 13th., 195 1

The first part of the paper is devoted to the study of the properties of the function  $f(x)$  defined by the equation  $f(x) = \int_0^x f(t) dt$ . It is shown that  $f(x)$  is a constant function. The second part of the paper is devoted to the study of the properties of the function  $f(x)$  defined by the equation  $f(x) = \int_0^x f(t) dt$ . It is shown that  $f(x)$  is a constant function.

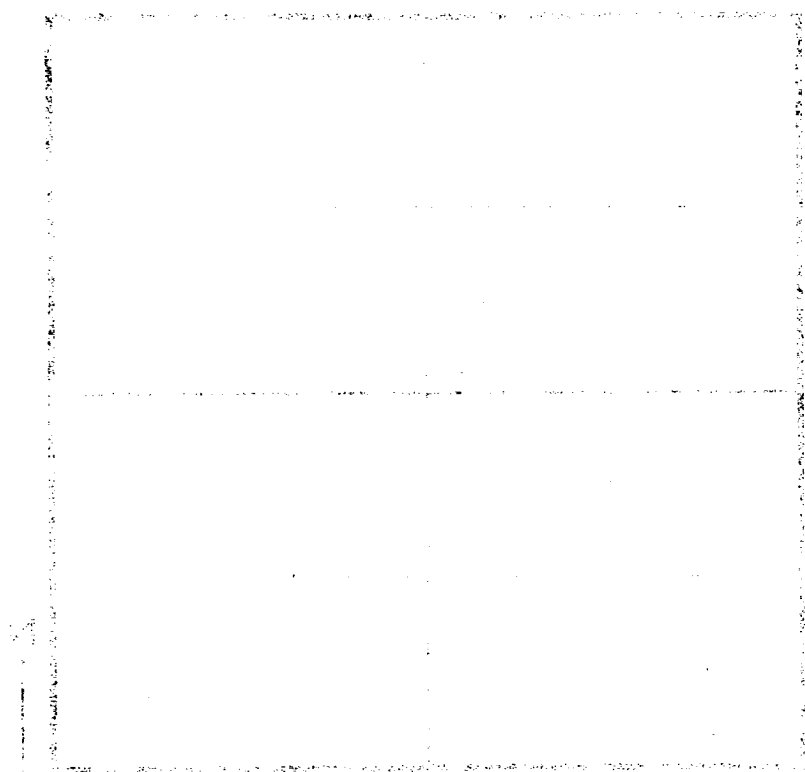

Fig. 1. Graph of the function  $f(x)$  defined by the equation  $f(x) = \int_0^x f(t) dt$ .

The third part of the paper is devoted to the study of the properties of the function  $f(x)$  defined by the equation  $f(x) = \int_0^x f(t) dt$ . It is shown that  $f(x)$  is a constant function.

The fourth part of the paper is devoted to the study of the properties of the function  $f(x)$  defined by the equation  $f(x) = \int_0^x f(t) dt$ . It is shown that  $f(x)$  is a constant function.

□

The fifth part of the paper is devoted to the study of the properties of the function  $f(x)$  defined by the equation  $f(x) = \int_0^x f(t) dt$ . It is shown that  $f(x)$  is a constant function.