

Jicarilla Indian

STATE OF NEW MEXICO  
OIL CONSERVATION  
COMMISSION  
DISTRICT NO. 3  
Phone 99 P. O. Box 697  
AZTEC, NEW MEXICO

(SUBMIT IN TRIPLICATE)  
UNITED STATES  
DEPARTMENT OF THE INTERIOR  
GEOLOGICAL SURVEY

Land Office Contract #150  
Lease Sec. 1, T-26-N,  
R-5-W  
Unit

SUNDRY NOTICES AND REPORTS ON WELLS

NOTICE OF INTENTION TO DRILL	SUBSEQUENT REPORT OF WATER SHUT-OFF
NOTICE OF INTENTION TO CHANGE PLANS	SUBSEQUENT REPORT OF SHOOTING OR ACIDIZING
NOTICE OF INTENTION TO TEST WATER SHUT-OFF	SUBSEQUENT REPORT OF ALTERING CASING
NOTICE OF INTENTION TO RE-DRILL OR REPAIR WELL	SUBSEQUENT REPORT OF REDRILLING OR REPAIR
NOTICE OF INTENTION TO SHOOT OR ACIDIZE	SUBSEQUENT REPORT OF ABANDONMENT
NOTICE OF INTENTION TO PULL OR ALTER CASING	SUPPLEMENTARY WELL HISTORY
NOTICE OF INTENTION TO ABANDON WELL	

(INDICATE ABOVE BY CHECK MARK NATURE OF REPORT, NOTICE, OR OTHER DATA)

June 23,

54

Jicarilla  
1-G/ 1665' XX 890' XX 19  
Well No. is located T-26-N R-5-W line and N.M.P.M. line of sec.  
NW SW Section 1  
Wildcat (Sec. and Sec. No.) Rio Arriba County (Range) New Mexico (Meridian)  
(Field) (County or Subdivision) (State or Territory)  
To be furnished

The elevation of the derrick floor above sea level is \_\_\_\_\_ ft.

DETAILS OF WORK

(State names of and expected depths to objective sands; show sizes, weights, and lengths of proposed casings; indicate mudding jobs, cement-

The objective sand is the Pictured Cliffs expected at about 3500'.

Proposed casing program 200' 9-5/8" cemented to surface  
3500' 7" cemented with 150 sacks

Well will be drilled using rotary tools to top of Pictured Cliffs where casing will be set. Pictured Cliffs will be cleared out using cable tools to a total depth of about 3550'. Well will be sand fraced using about 10,000 gals. oil and 5000# sand.

If the well is dry in the Pictured Cliff formation, we propose to go to the Mesaverde formation and will submit a revised casing program at that time.

I understand that this plan of work must be approved in writing by the Geological Survey before operations may be commenced.

Company Burt Building, Dallas, Texas

Address

A. M. Wiederkehr  
Manager Exploration Department  
Title

DEPARTMENT OF THE ARMY  
WASHINGTON, D. C. 20315

UNITED STATES DEPARTMENT OF THE INTERIOR  
BUREAU OF LAND MANAGEMENT  
WATER RESOURCES DIVISION  
SALT LAKE CITY, UTAH 84143

21.547 10 2780134 1.44 101704 178406

1. The first part of the report is a summary of the work done during the period covered by the report. This part should be written in a clear and concise manner, and should include a statement of the objectives of the work, a description of the methods used, and a summary of the results obtained. It should also include a statement of the conclusions drawn from the work.

[illegible]

SECRET

(S) (U)

-----

CONFIDENTIAL

1. The first group of people who are interested in the study of the history of the United States are the people who are interested in the history of the United States. This group of people is interested in the history of the United States because they want to know more about the country they live in. They want to know about the people who lived in the United States and the things that happened in the United States. They want to know about the history of the United States because they want to know more about the country they live in.

2. What is the purpose of the study?  
The purpose of the study is to determine the effect of the use of the Internet on the learning of English as a second language.

10. *How do you think the following factors will affect the demand for health care services in the future?*

.....

220100A

[illegible]

Company.....SOUTHERN UNION GAS COMPANY.....

Lease.....Jicarilla.....Well No. 1-G.....

Sec.....I....., T. 26 N....., R. 5 W., N.M.P.M.

Location.....1665' from the South line and 890' from  
the West line.

RECEIVED  
JUN 28 1954  
L. J. FINKLEA

Rio Arriba County

New Mexico

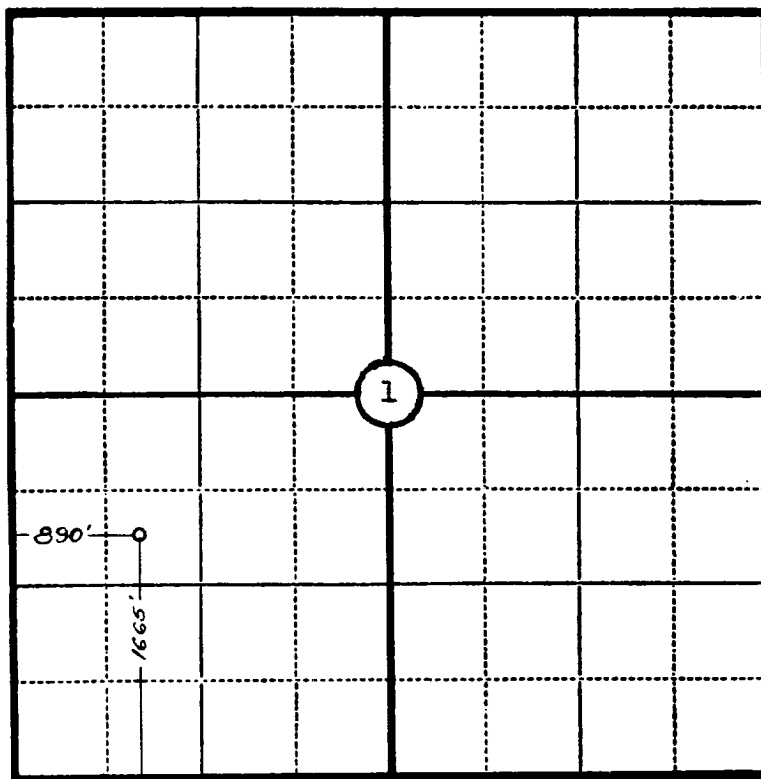

Scale—4 inches equal 1 mile.

This is to certify that the above plat was prepared from field notes of actual surveys made by me or under my supervision and that the same are true and correct to the best of my knowledge and belief.

*Charles J. Finklea*

Seal:

Charles J. Finklea  
Registered Professional N. Mex. Reg. No. 1302  
Engineer and Land Surveyor.

Surveyed ..... 17 March ..... , 19 54 .....