

NEW MEXICO OIL CONSERVATION COMMISSION  
Santa Fe, New Mexico

NOTICE OF INTENTION TO DRILL OR RECOMPLETE

Notice must be given to the District Office of the Oil Conservation Commission and approval obtained before drilling or recompletion begins. If changes in the proposed plan are considered advisable, a copy of this notice showing such changes will be returned to the sender. Submit this notice in QUINTUPLICATE. One copy will be returned following approval. See additional instructions in Rules and Regulations of the Commission.

Lexington, Kentucky  
(Place)

November 20, 1953  
(Date)

OIL CONSERVATION COMMISSION  
SANTA FE, NEW MEXICO

Gentlemen:

You are hereby notified that it is our intention to commence the (Drilling) (Recompletion) of a well to be known as

Southern Petroleum Exploration Inc.,  
(Company or Operator)

State  
(Lease)

, Well No. 2, in \_\_\_\_\_ (Unit) The well is

located 1650 feet from the South line and 1850 feet from the

XXXX East line of Section 2, T. 26 North, R. 7 West, NMPM.

(GIVE LOCATION FROM SECTION LINE) South Slope-Pictured Cliff Pool, Rio Arriba County

If State Land the Oil and Gas Lease is No. E - 291

If patented land the owner is \_\_\_\_\_

Address \_\_\_\_\_

We propose to drill well with drilling equipment as follows: Notary to top of  
Pictured Cliff. Complete with Cable Tools

The status of plugging bond is STATE WIDE

Drilling Contractor Holia Oil Company, Wichita Falls, Texas  
Ray Ferral, Cable Tools

We intend to complete this well in the Pictured Cliff  
formation at an approximate depth of 3000 feet.

CASING PROGRAM

We propose to use the following strings of Casing and to cement them as indicated:

Size of Hole	Size of Casing	Weight per Foot	New or Second Hand	Depth	Sacks Cement
<u>13 3/4</u>	<u>10 3/4</u>	<u>32.75</u>	<u>New</u>	<u>100</u>	<u>90</u>
<u>8 3/8</u>	<u>7</u>	<u>20</u>	<u>New</u>	<u>3000</u>	<u>160</u>

If changes in the above plans become advisable we will notify you immediately.

ADDITIONAL INFORMATION (If recompletion give full details of proposed plan of work.)

**If gas is found in Pictured Cliff - Open hole will be shot with 350 quarts of**

**Nitre - Gel., Tamped and shot and cleaned out to total depth and one inch siphon**

Approved installed. 11-27, 1953  
Except as follows:

Sincerely yours,

Southern Petroleum Exploration  
(Company or Operator)

By \_\_\_\_\_

Position Land and Exploration Department

Send Communications regarding well to

Name J. A. Mac

Address 152 Walnut Street

Lexington, Kentucky

OIL CONSERVATION COMMISSION

By Ernest C. Arnold

Title \_\_\_\_\_

Company.....Southern Petroleum Exploration, Inc.....

Lease.....E - 291.....State.....Well No.....2.....

Sec.....2....., T.....26 N....., R.....7 W....., N.M.P.M.....

Location.....1650' from the South line and 1850' from  
the East line.

Elevation.....6675 Ungraded ground.....

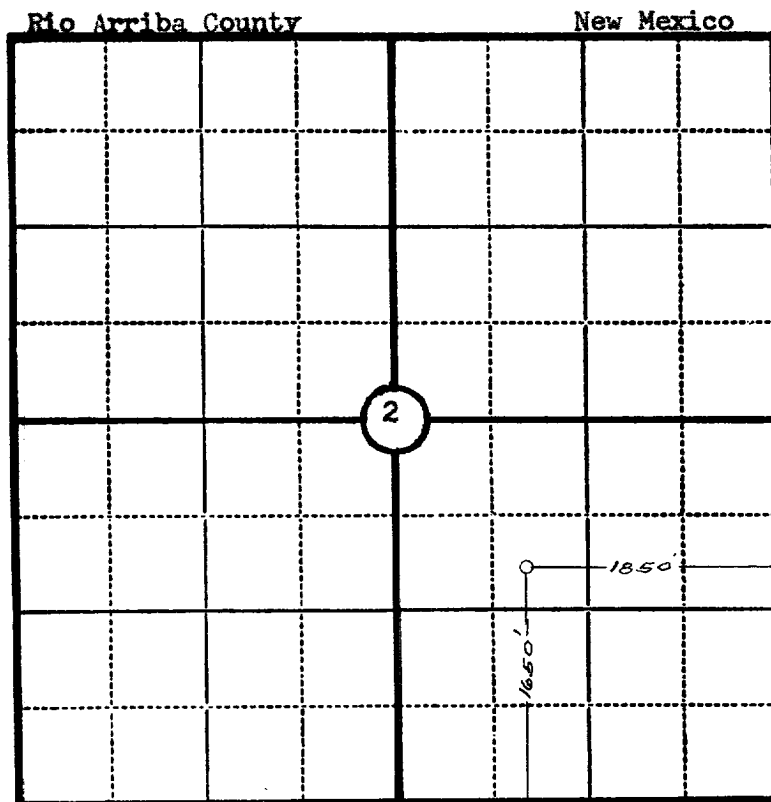

This is to certify that the above plat was prepared from field notes of actual surveys made by me or under my supervision and that the same are true and correct to the best of my knowledge and belief.

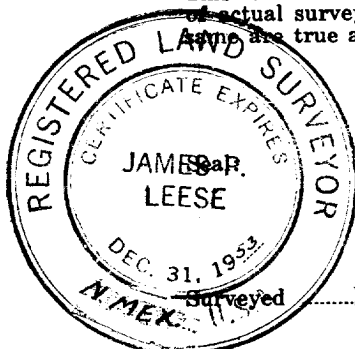

*James P. Leese*  
Registered Professional  
Engineer and Land Surveyor.

James P. Leese  
N. Mex. Reg. No. 1463

November 17, 1953.

**OIL CONSERVATION COMMISSION**  
**AZTEC DISTRICT OFFICE**

No. Copies Received 6

**DISTRIBUTION**

	NO. FURNISHED	
Operator	<u>1</u>	
Santa Fe	<u>1</u>	
Proration Office	<u>1</u>	
State Land Office	<u>1</u>	
U. S. G. S.	<u>2</u>	
Transporter		
File	<u>1</u>	<input checked="" type="checkbox"/>