



STATE OF NEW MEXICO
ENERGY AND MINERALS DEPARTMENT

OIL CONSERVATION DIVISION
AZTEC DISTRICT OFFICE

1000 RIO BRAZOS ROAD
AZTEC, NEW MEXICO 87410
(505) 334-6178

OIL CONSERVATION DIVISION
BOX 2088
SANTA FE, NEW MEXICO 87501

DATE

July 20, 1982

RE:

Proposed MC _____
Proposed DHC a _____
Proposed NSL _____
Proposed SWD _____
Proposed WFX _____
Proposed PMX _____

Gentlemen:

I have examined the application dated

June 30, 1982

for the

Luch Pet. Corp.
Operator

Lindrich #13

Lease and Well No.

K-3-26N-7W

Unit, S-T-R

and my recommendations are as follows:

Approve

Yours truly,

Frank J. Chang

OIL CONSERVATION DIVISION
STATE OF NEW MEXICO



LADD PETROLEUM CORPORATION
830 DENVER CLUB BUILDING
DENVER, COLORADO 80202

RE: APPLICATION OF LADD PETROLEUM CORPORATION FOR DOWNHOLE
COMMINGLING OF THE LINDRITH #13 WELL IN RIO ARRIBA COUNTY,
NEW MEXICO.

APPLICATION

Pursuant to Rule 303(C) of the Rules and Regulations of The State of New Mexico Oil Conservation Division, the Applicant, Ladd Petroleum Corporation, hereby makes application for approval of downhole commingling in the well bore of the Lindrith #13 Well in Rio Arriba County, New Mexico.

The Applicant further states:

1. The Operator of the Lindrith 13 Well is the Applicant, Ladd Petroleum Corporation.
2. The Lindrith 13 Well is located on Federal Lease SF 079161, insofar as it covers the following described lands:
TOWNSHIP 26 NORTH, RANGE 7 WEST, N.M.P.M.
SECTION 3: NE/4 SW/4 (LARGO GALLUP)
SECTION 3: NE/4 SW/4 (BASIN DAKOTA)
RIO ARRIBA COUNTY, NEW MEXICO.
3. The legal location of the well is as follows:
TOWNSHIP 26 NORTH, RANGE 7 WEST, N.M.P.M.
SECTION 3: 1820' FSL & 1820' FWL
(UNIT LETTER K)
RIO ARRIBA COUNTY, NEW MEXICO.
4. The Lindrith 13 Well is currently dually completed in the Largo Gallup Pool and the Basin Dakota Pool pursuant to New Mexico Oil Conservation Multiple Completion Order MC-1313.
5. The Lindrith 13 Well is capable of only low marginal production from the Largo Gallup Pool, and the well is also, only capable of low marginal production from the Basin Dakota Pool.
6. The ownership of the above mentioned Pools is common.
7. The proposed commingling from the above Pools will result in the recovery of additional hydrocarbons from each of these pools, thereby, preventing waste, and the commingling will not violate correlative rights.
8. Please use our Lindrith #24 Well located in Section 4, T26N-R7W, as evidence for fluid compatibility for these two pools. It has been on commingled production since July, 1979.

Wherefore, the Applicant requests the New Mexico Oil Conservation Division grant this application by giving approval to the downhole commingling of the Lindrith #13 Well in Rio Arriba County, New Mexico.

RESPECTFULLY SUBMITTED,

Terry Jones
Production Foreman-Farmington Area

cc: (SEE ATTACHED)

DISTRIBUTION LIST

- | | |
|---|---|
| 1. Mr. Joe D. Ramey-Director State Of New Mexico Oil Conservation Division Main Office P. O. Box 2088 Santa Fe, New Mexico 87501 | 8. Manager-Land Husky Oil, Ltd. 600 South Cherry St. Denver, Colorado 80222 |
| 2. Mr. F. T. Chavez State of New Mexico Oil Conservation Division District III 1000 Rio Brazos Road Aztec, New Mexico 87410 | 9. Director-Land Dept. El Paso Natural Gas Co. P. O. Box 1492 El Paso, Texas 79978 |
| 3. Mr. James Sims Minerals Management Service Drawer 600 Farmington, New Mexico 87401 | 10. Helen Lorraine Harvey, et.a P. O. Box 177 Wichita Falls, Texas 76301 |
| 4. District Production Superintendent Consolidated Oil & Gas, Inc. P. O. Box 2038 Farmington, New Mexico 87401 | 11. Petroleum Corp. of Texas P. O. Box 911 Breckenridge, Tex. 76024 |
| 5. Manager of Land & Contracts DEPCO, INC. Petroleum Club Building-#1025 Denver, Colorado 80202 | 12. Mr. George Mayfield Ladd Petroleum Corporation 830 Denver, Club Bldg. Denver, Colorado 80202 |
| 6. Mr. Bud Crane Dugan Production Corporation P. O. Box 234 Farmington, New Mexico 87401 | 13. Mr. Clyde Phillips Ladd Petroleum Corporation P. O. Box 7961 Midland, Texas 79701 |
| 7. Production Superintendent Bolin Oil Company 1120 Oil & Gas Building Wichita Falls, Texas 76301 | |

CERTIFICATION OF MAIL LIST

I, Terry Jones, certify that I mailed a copy of the Application for Downhole Commingling of the Lindrith #13 Well in Rio Arriba County, New Mexico, to all operators of leases offsetting the dedicated acreage for this well, the U. S. Geological Survey-Minerals Management Service, and the Supervisor of the District III, Office of the New Mexico Oil Conservation Division on the 25th of June, 1982.

Sincerely,



Terry Jones
Production Foreman-Farmington Area

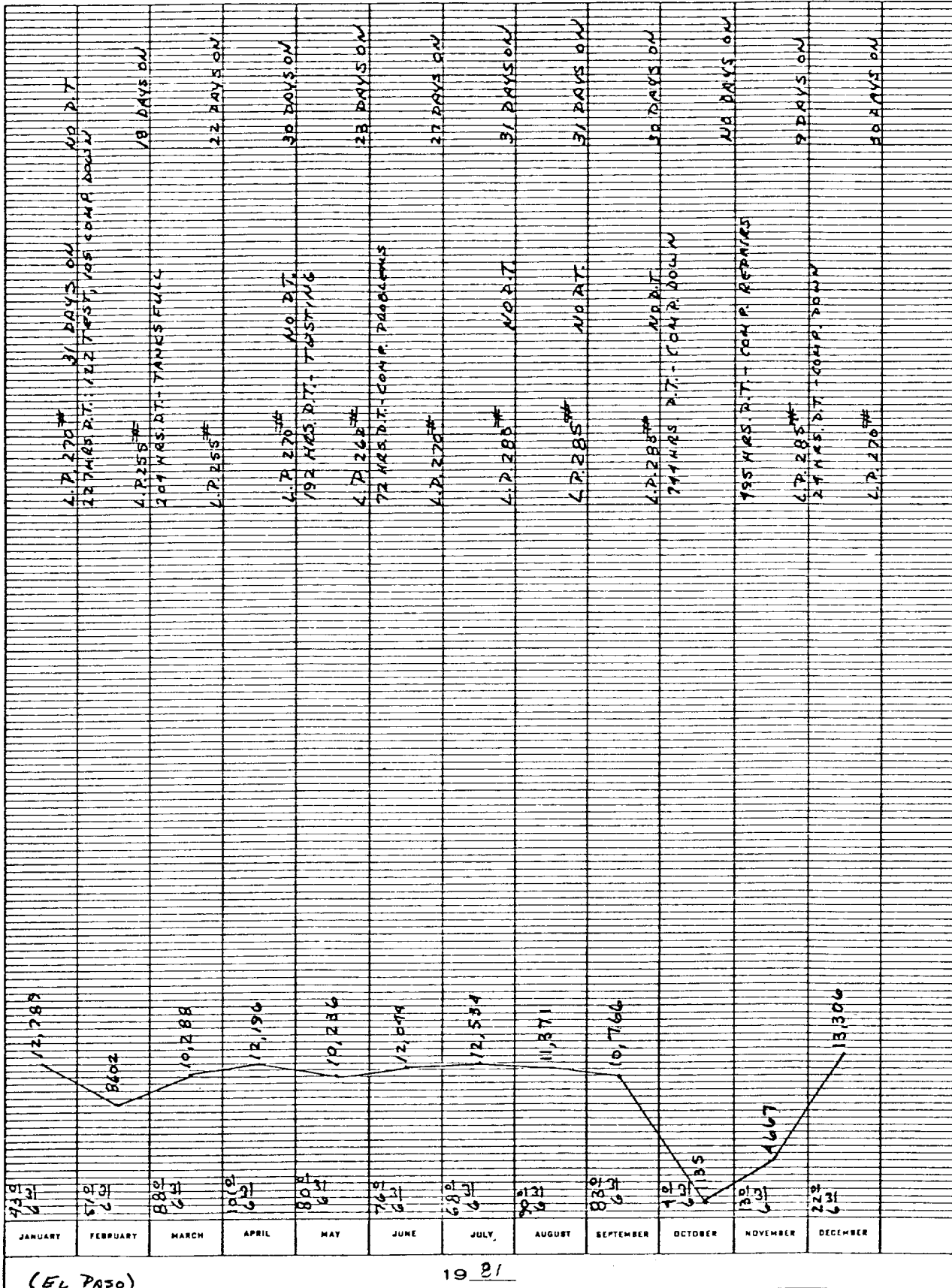

(EL PASO)

19 21

LINDRITN #13 (GA)
(LARGE GALLUP FIELD)

MADE IN U.S.A.

ONE YEAR BY MONTHS

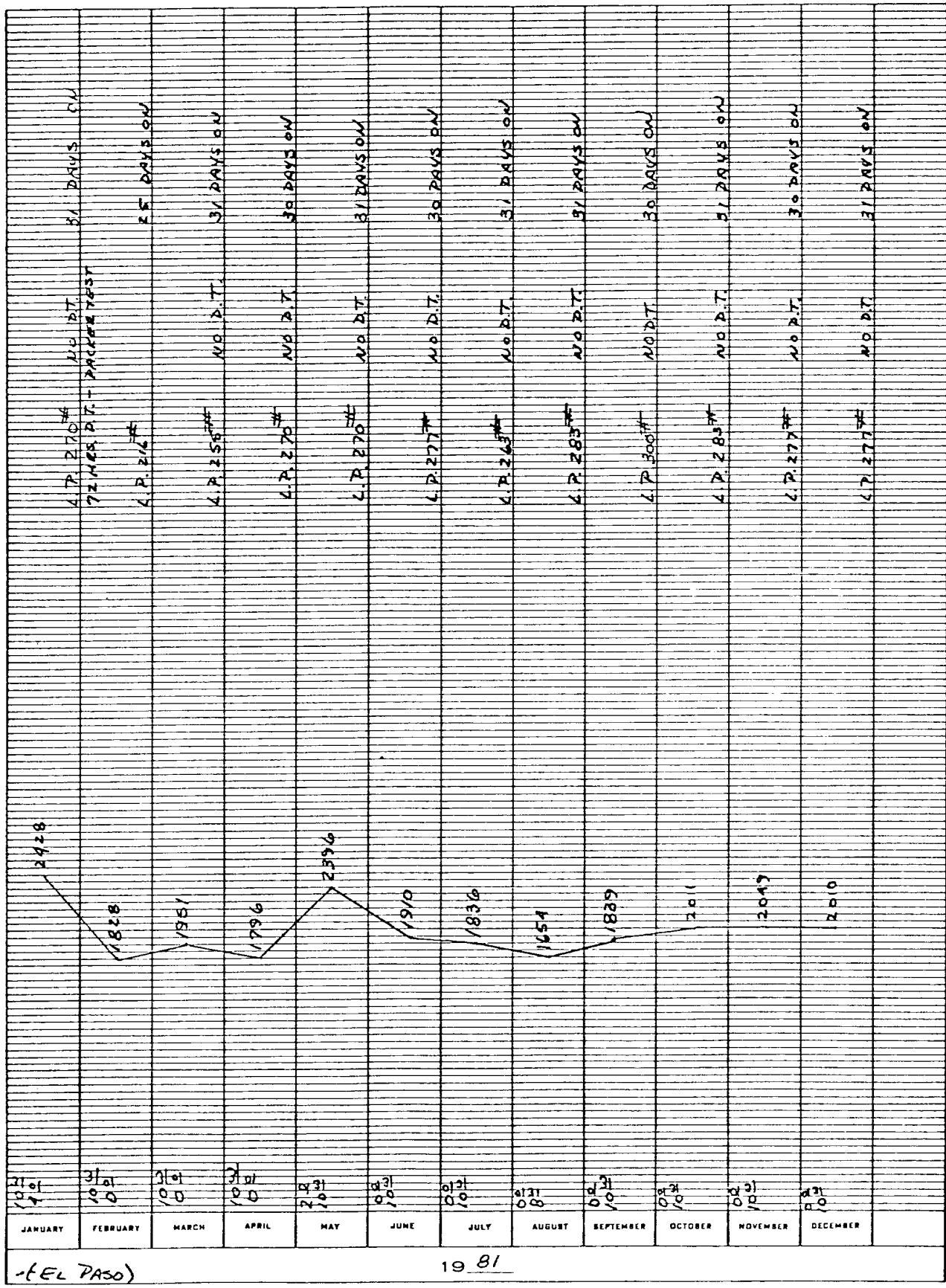

(-EL PASO)

19 81

LINDRITH 13 (DK)
(BASIN DAKOTA FIELD)

NEW MEXICO OIL CONSERVATION COMMISSION WELL LOCATION AND ACREAGE DEDICATION PLAT

Form C-102
Supersedes C-128
Effective 1-1-65

All distances must be from the outer boundaries of the Section.

| | | | | | |
|--|--------------------------------------|-----------------------------|-----------------------------|--|--|
| Operator <i>MSC Colloch Oil Corp of Calif.</i> | | Lease <i>Lindbergh</i> | | Well No. <i>13</i> | |
| Unit Letter <i>K</i> | Section <i>3</i> | Township <i>26 North</i> | Range <i>7 West</i> | County <i>Rio Arriba</i> | |
| Actual Footage Location of Well: <i>1820</i> feet from the <i>South</i> line and <i>1820</i> feet from the <i>West</i> line | | | | | |
| Ground Level Elev. <i>6583</i> | Producing Formation <i>Gallup</i> | | Pool <i>Largo Gallup</i> | Dedicated Acreage: <i>320</i> Acres | |

1. Outline the acreage dedicated to the subject well by colored pencil or hachure marks on the plat below.
2. If more than one lease is dedicated to the well, outline each and identify the ownership thereof (both as to working interest and royalty).
3. If more than one lease of different ownership is dedicated to the well, have the interests of all owners been consolidated by communitization, unitization, force-pooling, etc?

☐ Yes ☐ No If answer is "yes," type of consolidation _____

If answer is "no," list the owners and tract descriptions which have actually been consolidated. (Use reverse side of this form if necessary.) _____

No allowable will be assigned to the well until all interests have been consolidated (by communitization, unitization, forced-pooling, or otherwise) or until a non-standard unit, eliminating such interests, has been approved by the Commission.

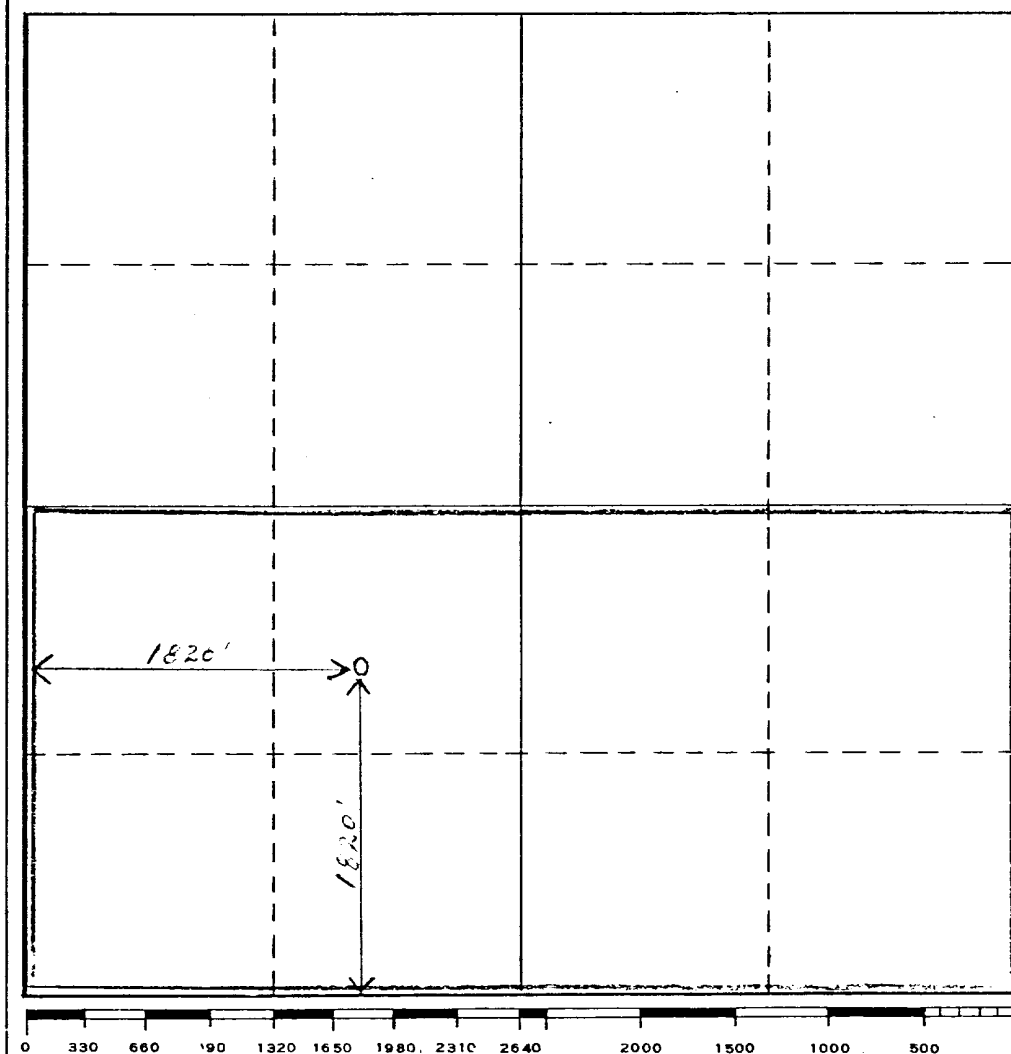

CERTIFICATION

I hereby certify that the information contained herein is true and complete to the best of my knowledge and belief.

Name *Jim L. Jantz*
 Position *Agent*
 Company *MSC Colloch Oil Corp of Calif.*
 Date *10-31-66*

I hereby certify that the well location shown on this plat was plotted from field notes of actual surveys made by me or under my supervision, and that the same is true and correct to the best of my knowledge and belief.

Date Surveyed _____

Registered Professional Engineer and/or Land Surveyor _____

Certificate No. _____

PIL CONSERVATION DIVISION
P. O. BOX 2088
SANTA FE, NEW MEXICO 87501

GAS-OIL RATIO TESTS

No well will be assigned an allowable greater than the amount of oil produced on the official test.

During gas-oil ratio test, each well shall be produced at a rate not exceeding the top unit allowable for the pool in which well is located by more than 25 percent. Operator is encouraged to take advantage of this 25 percent tolerance in order that well can be assigned increased allowables when authorized by the Division.

Gas volumes must be reported in MCF measured at a pressure base of 15.025 psia and a temperature of 60° F. Specific gravity base will be 0.60.

Report casing pressure in lieu of tubing pressure for any well producing through casing

Mail original and one copy of this report to the district office of the New Mexico Oil Conservation Division in accordance with Rule 301 and appropriate pool rules.

I hereby certify that the above information is true and complete to the best of my knowledge and belief.

(Signature)

Prof. Foucar
(Title)

STATE OF NEW MEXICO
ENERGY AND MINERALS DEPARTMENT

OIL CONSERVATION DIVISION
P. O. BOX 2088
SANTA FE, NEW MEXICO 87501

Form C-116
Revised 10-1-78

GAS - OIL RATIO TESTS

| Operator <i>Lard Petroleum Corp.</i> | | Pool <i>Basin Dakota</i> | | County <i>Rio Arriba</i> | | | | | | | | | | |
|---|-----------|-----------------------------|----------|--|--------------|----------------|------------|-------------|------------------|----------------------|-------------------|-------------|-----------------|------------------------------|
| Address <i>830 DENVER CLUB Bldg. DENVER, Colo. 80202</i> | | TYPE OF TEST - (X) | | Schedulable <input type="checkbox"/> Completion <input type="checkbox"/> Special <input checked="" type="checkbox"/> | | | | | | | | | | |
| LEASE NAME | WELL NO. | LOCATION | | | DATE OF TEST | STATUS | CHOKE SIZE | TBG. PRESS. | DAILY ALLOW-ABLE | LENGTH OF TEST HOURS | PROD. DURING TEST | | | GAS - OIL RATIO CU. FT./BBL. |
| | | U | S | T | | | | | | | R | WATER BBLs. | GRAV. OIL BBLs. | |
| <i>Lindbergh</i> | <i>13</i> | <i>K</i> | <i>3</i> | <i>26 N</i> | <i>700</i> | <i>5-28-82</i> | | <i>262</i> | | <i>24</i> | <i>4</i> | <i>0</i> | <i>82</i> | <i>82,000</i> |

No well will be assigned an allowable greater than the amount of oil produced on the official test.

During gas-oil ratio test, each well shall be produced at a rate not exceeding the top unit allowable for the pool in which well is located by more than 25 percent. Operator is encouraged to take advantage of this 25 percent tolerance in order that well can be assigned increased allowables when authorized by the Division.

Gas volumes must be reported in MCF measured at a pressure base of 15.025 psia and a temperature of 60° F. Specific gravity base will be 0.60.

Report casing pressure in lieu of tubing pressure for any well producing through casing.

Mail original and one copy of this report to the district office of the New Mexico Oil Conservation Division in accordance with Rule 301 and appropriate pool rules.

I hereby certify that the above information is true and complete to the best of my knowledge and belief.

Henry J. Stone
(Signature)
Paul J. Sullivan
(Title)

7 DAY SI TEST LINDRITH #13 LARGO GALLUP, BASIN DAKOTA

6-14-82 10:00 A.M. SI BOTH ZONES
6-21-82 3:00 P.M. DAKOTA TBG. SI PRESSURE 817 PSI.
6-21-82 3:00 P.M. GALLUP TBG. SI PRESSURE 423 PSI.

Based on the 1981 production of this dually completed well, the Dakota will produce 17% of the total gas and 9% of the total condensate, and the Gallup will produce 83% of the total gas and 91% of the total condensate when the well is commingled.

Sincerely,

Terry Jones
Production Foreman-Farmington Area