

District III
1000 Rio Brazos Rd, Aztec,
NM 87410

State of New Mexico
Energy, Minerals and Natural Resources Dept.

SUBMIT 1 COPY TO
APPROPRIATE
DISTRICT OFFICE
AND 1 COPY TO
SANTA FE OFFICE

OIL CONSERVATION DIVISION
2040 S. Pacheco
Santa Fe, New Mexico 87504

PIT REMEDIATION AND CLOSURE REPORT

Operator: Caulkins Oil Company Telephone: (505) 632-1544

Address: P.O. Box 340, Bloomfield, NM 87413

Facility or Well Name: Breech "E" 68-E

Location: Unit or Qtr/Qtr L Sec 4 T 26N R 6W County Rio Arriba

Pit Type: Separator X Dehydrator Other

Land Type: BLM X, State , Fee , Other

Pit Location: Pit dimensions: length 20', width 22', depth 12'
(Attach diagram)

References: wellhead X, other _____

Footage from reference: 90'

Direction from reference: 290 Degrees _____ East North X
of
X West South

Depth to Ground Water:	Less than 50 feet	(20 points)
(Vertical distance from	50 feet to 99 feet	(10 points)
contaminants to seasonal high	Greater than 100 feet	(0 points)
water elevation of ground water)		<u>0</u>

Wellhead Protection Area: Yes (20 points)
(Less than 200 feet from a private domestic water source, No (0 points) 0
or; less than 1000 feet from all other water sources;

Distance to Surface Water: (Horizontal distance to perennial lakes, ponds, rivers, streams, creeks, irrigation canals and ditches)	Less than 200 feet	(20 points)	
	200 feet to 1000 feet	(10 points)	
	Greater than 1000 feet	(0 points)	<u>0</u>

RANKING SCORE (TOTAL POINTS): 0

SIGNATURE Robert L. Verquer PRINTED NAME
AND TITLE ROBERT L. VERQUER, SUPERINTENDENT

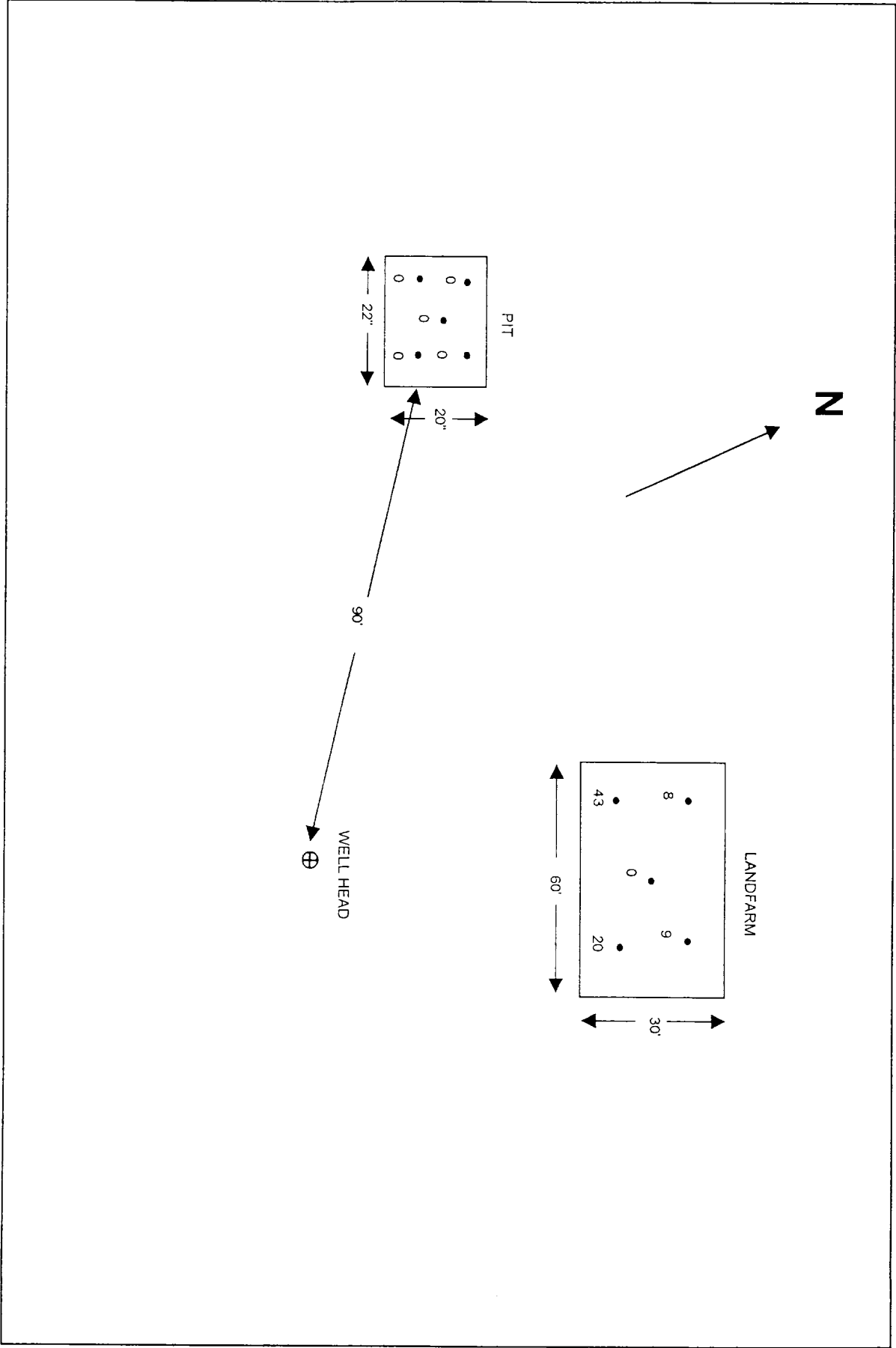

ANAITAS ENVIRONMENTAL LABS
Operated under contract by:
CDS Laboratories
75 Suttle Street
PO Box 2605
Durango, CO 81302

Phone: (970)-247-4220
Fax : (970)-247-4227

Report Date: 09/17/97

ANALYSIS REPORT

Attn:

CAULKINS OIL CO
PO BOX 340
BLOOMFIELD, NM 87413

Our Lab #: A97-133162 (7641)
Sample ID: BREECH E 68E (LAND FARM)
Date Login: 08/19/97
Date Rec'd: 08/18/97

COLLECTION INFORMATION

Date/Time/By: 08/13/97 1215
Location:

Lab#	Testname	Result	Units
<hr/>			
A97-133162	BENZENE	0.213	ppm
	ETHYL BENZENE	< 0.125	ppm
	TOLUENE	< 0.125	ppm
	XYLENE (TOTAL)	< 0.250	ppm
	Diesel Range Organics	638	ppm
	Gasoline Range Organics	12.5	ppm

Approved By: Cynthia Barr Checked By: DZ

ANAITAS ENVIRONMENTAL LABS
Operated under contract by:
CDS Laboratories
75 Suttle Street
PO Box 2605
Durango, CO 81302

Phone: (970)-247-4220
Fax : (970)-247-4227

Report Date: 09/17/97

ANALYSIS REPORT

Attn:

CAULKINS OIL CO
PO BOX 340
BLOOMFIELD, NM 87413

Our Lab #: A97-133163 (7641)
Sample ID: BREECH E 68E (PIT BOTTOM)
Date Login: 08/19/97
Date Rec'd: 08/18/97

COLLECTION INFORMATION

Date/Time/By: 08/13/97 1215
Location:

Lab#	Testname	Result	Units
<hr/>			
A97-133163	BENZENE	0.126	ppm
	ETHYL BENZENE	< 0.125	ppm
	TOLUENE	< 0.125	ppm
	XYLENE (TOTAL)	< 0.250	ppm
	Diesel Range Organics	516	ppm
	Gasoline Range Organics	5.0	ppm

Approved By: Cynthia Pore Checked By: DZ

WELL NAME: Breecb E 68-E

CAULKINS OIL
SITE SECURITY DIAGRAM

