

NEW MEXICO
OIL CONSERVATION COMMISSION

Form C-128

Well Location and/or Gas Proration Plat

Date 4-10-56

Operator HUMBLE OIL & REFINING CO. Lease JICARILLA APACHE TRIBE OF INDIANS "K"

Well No. 1 Section 3 Township 26-N Range 5-W NMPM

Located 2178 Feet From NORTH Line, 1220 Feet From EAST Line,

RIO ARRIBA

County, New Mexico. G. L. Elevation

Name of Producing Formation PICT'D CLIFFS GAS Pool PICT'D CLIFFS Dedicated Acreage 159.80

WILDCAT

(Note: All distances must be from outer boundaries of Section)

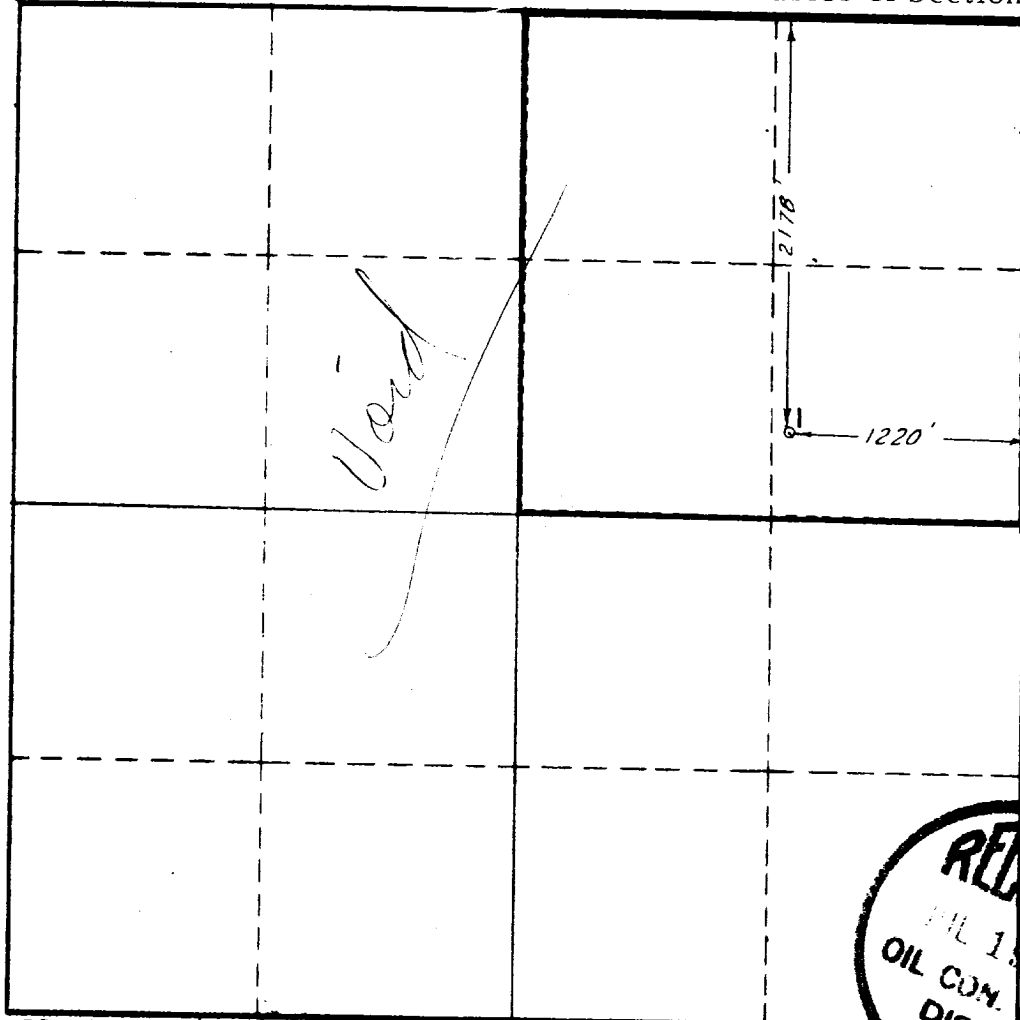

SCALE: 1"=1000'



1. Is this Well a Dual Comp. ? Yes Yes
2. If the answer to Question 1 is yes, are there any other dually completed wells within the dedicated acreage? Yes No

This is to certify that the above plat was prepared from field notes or actual surveys made by me or under my supervision and that the same are true and correct to the best of my knowledge and belief.

Name H. P. Hensley
Position ASSISTANT DIVISION SUPERINTENDENT
Representing HUMBLE OIL & REFINING CO.
Address BOX 1600 MIDLAND, TEXAS

Date Surveyed 4-10-56
E. T. Shahan
Registered Professional Engineer and/or
Land Surveyor
LEASE NO 196184
CONTRACT NO. 151

W-A-2170

OIL CONSERVATION COMMISSION		
AZTEC DISTRICT OFFICE		
No. Copies Received <u>7</u>		
DISTRIBUTION		
	NO. FURNISHED	
Operator	<u>4</u>	
Santa Fe		
Proration Office		
State Land Office		
U. S. G. S.	<u>1</u>	
Transporter		
File	<u>1</u>	<input checked="" type="checkbox"/>