5000-6
File-1

(SUBMIT IN TRIPLICATE)

UNITED STATES
DEPARTMENT OF THE INTERIOR
GEOLOGICAL SURVEY

Indian Agency _____

SiouxvilleAllottee **Contract 0119**

Lease No. _____

SUNDRY NOTICES AND REPORTS ON WELLS

NOTICE OF INTENTION TO DRILL		SUBSEQUENT REPORT OF WATER SHUT-OFF	
NOTICE OF INTENTION TO CHANGE PLANS	X	SUBSEQUENT REPORT OF SHOOTING OR ACIDIZING	
NOTICE OF INTENTION TO TEST WATER SHUT-OFF		SUBSEQUENT REPORT OF ALTERING CASING	
NOTICE OF INTENTION TO REDRILL OR REPAIR WELL		SUBSEQUENT REPORT OF REDRILLING OR REPAIR	
NOTICE OF INTENTION TO SHOOT OR ACIDIZE		SUBSEQUENT REPORT OF ABANDONMENT	
NOTICE OF INTENTION TO PULL OR ALTER CASING		SUPPLEMENTARY WELL HISTORY	
NOTICE OF INTENTION TO ABANDON WELL			

(INDICATE ABOVE BY CHECK MARK NATURE OF REPORT, NOTICE, OR OTHER DATA)

January 14, 19**57**

 Well No. **W 4-6** is located **1090** ft. from **[N]** line and **1190** ft. from **[E]** line of sec. **6**
SE/4 NE/4 6
(1/4 Sec. and Sec. No.)
26N**4W****N.M.P.M.****Blanco Mountains &****Rio Arriba****New Mexico**
Willcox (Graneros-Sabota)
(Field)
(County or Subdivision)(State or Territory)
 The elevation of the **well ground** above sea level is **7140** ft.

DETAILS OF WORK

(State names of and expected depths to objective sands; show sizes, weights, and lengths of proposed casings; indicate mudding jobs, cementing points, and all other important proposed work)

TO 8392. FWD 8375. 3 1/2" liner has been perforated fr 8000-8132, 8200-84, 8225-90, 8245-60, 8274-84, 8300-12, 8345-90 8350-64 and the Sabota-Graneros fractured in two stages. It is proposed to cut 27 @ 8000' and perforate the 3 1/2" liner opposite the Mesavada from from approx 8275-8170'. The Mesavada will then be fractured in two stages, using approx 40,000 gals wt for each stage. The well will be cleaned out to 8375', 2-3/8" CB tubing will be run with Washall packer set @ approx 7400' to separate the Mesavada from the Graneros-Sabota formation. The well will be completed to produce the Graneros-Sabota thru the 2-3/8" tubing and the Mesavada thru the tubing-casing annulus. The NE/4 of Section 6, containing 162.72 acres is dedicated to the Graneros-Sabota form and the E/2 of Section 6, containing 322.72 acres is dedicated to the Mesavada form.

I understand that this plan of work must receive approval in writing by the Geological Survey before operations may be carried out.

 Company **WESTERN PRODUCTION CORPORATION**

 Address **500 Stone Building**
Albuquerque, New Mexico

 By **RAY PHILLIPS**
Ray Phillips

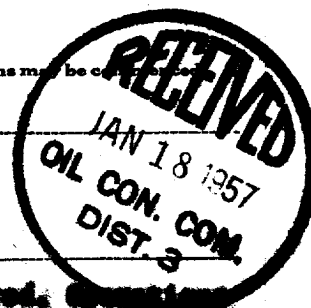
 Title **Asst. Mgr., Prod. Operations**



NEW MEXICO
OIL CONSERVATION COMMISSION

Form C-128

Well Location and/or Gas Proration Plat

Date January 14, 1957

Operator NORTHWEST PRODUCTION CORPORATION Lease 1

Well No. 4-C Section 6 Township 26 North Range 4 West NMPM

Located 1830 Feet From North Line, 1190 Feet From East Line,

Rio Arriba County, New Mexico. G. L. Elevation 7149 Ungraded

Name of Producing Formation Mesavada Pool Blanco-W Dedicated Acreage 322.72

(Note: All distances must be from outer boundaries of Section)

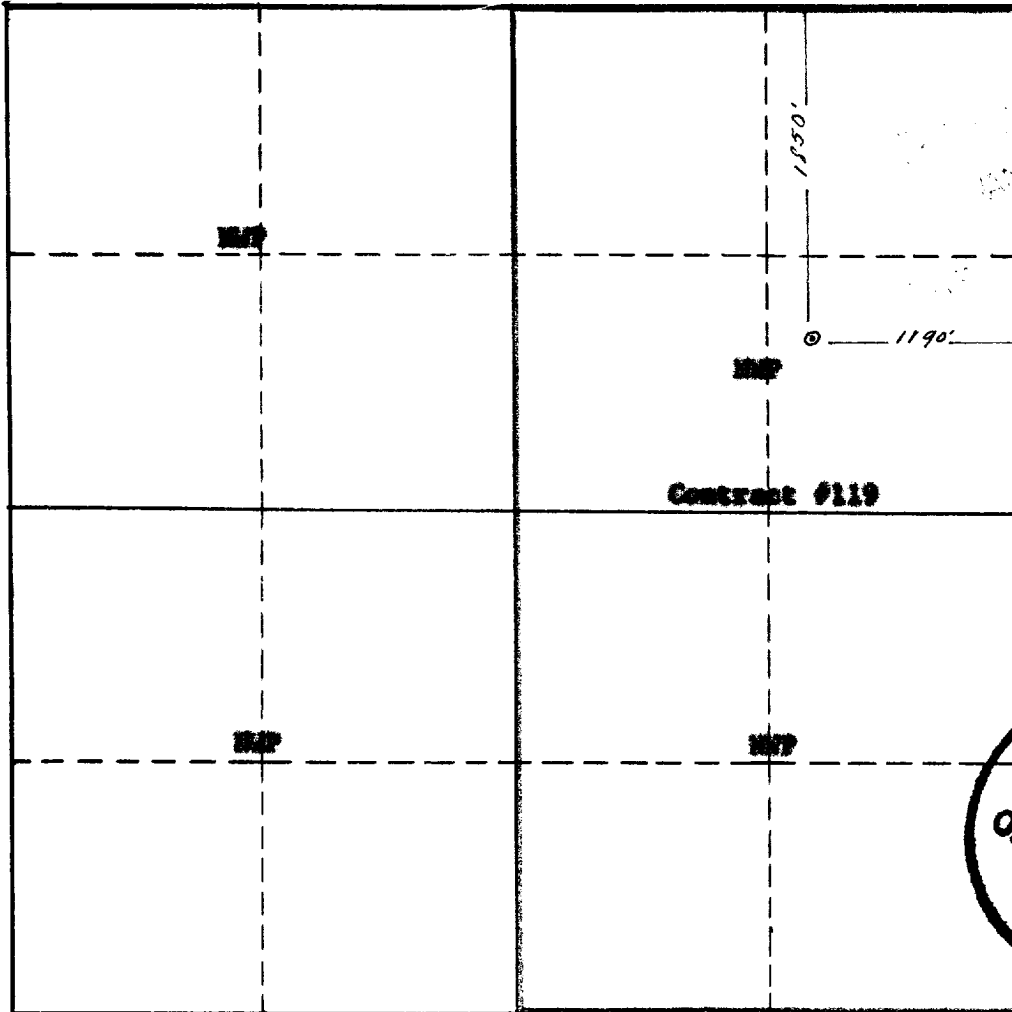

NOTE

This section of form is to be used for gas wells only.



SCALE: 1"=1000'

1. Is this Well a Dual Comp. ? Yes X No .
2. If the answer to Question 1 is yes, are there any other dually completed wells within the dedicated acreage ? Yes No X.

RAY PHILLIPS

Name Ray Phillips

Position Asst. Mgr., Prod. Operations

Representing Northwest Production Corporation

Address 320 Stone Bldg., Albuquerque, N. M.

This is to certify that the above plat was prepared from field notes of actual surveys made by me or under my supervision and that the same are true and correct to the best of my knowledge and belief.

Date Surveyed June 12, 1956
/s/ Ernest V. Schuchman

Registered Professional Engineer and/or Land Surveyor



NEW MEXICO
OIL CONSERVATION COMMISSION

Form C-128

Well Location and/or Gas Proration Plat

Date January 14, 1957

Operator NORTHWEST PRODUCTION CORPORATION Lease "H"

Well No. 4-6 Section 6 Township 26 North Range 4 West NMPM

Located 1830 Feet From North Line, 1190 Feet From East Line,

Rio Arriba County, New Mexico. G. L. Elevation 7142 Ungraded

Name of Producing Formation Graneros-Bakota Pool Wildcat Dedicated Acreage 162.72

(Note: All distances must be from outer boundaries of Section)

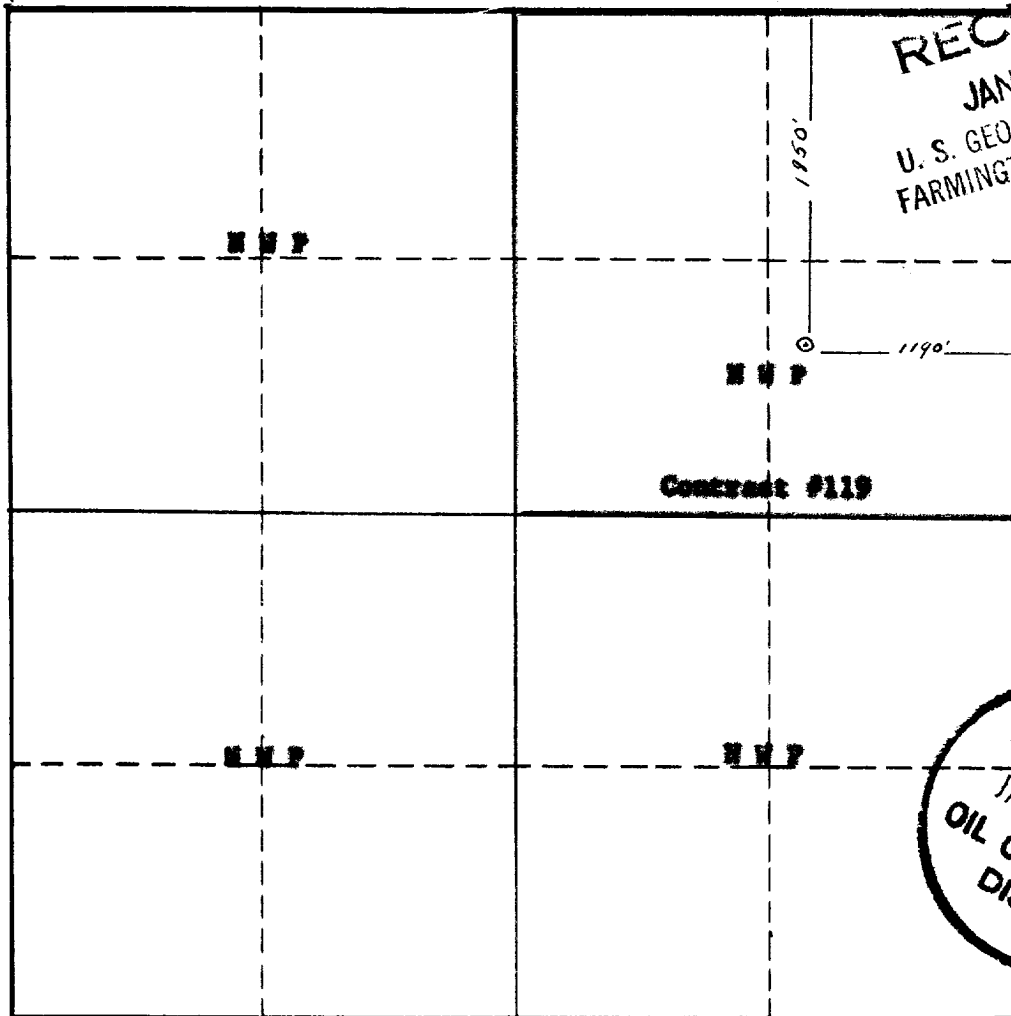

NOTE

This section of form is to be used for gas wells only.



SCALE: 1"=1000'

1. Is this Well a Dual Comp. ? Yes X No .
2. If the answer to Question 1 is yes, are there any other dually completed wells within the dedicated acreage? Yes No X.

Name RAY PHILLIPS
Position Asst. Mgr., Prod. Operations
Representing Northwest Production Corporation
Address 520 Stone Bldg., Albuquerque, N. M.

This is to certify that the above plat was prepared from field notes of actual surveys made by me or under my supervision and that the same are true and correct to the best of my knowledge and belief.

Date Surveyed June 13, 1956

/s/ Ernest V. Schaback

Registered Professional Engineer and/or Land Surveyor