

NEW MEXICO OIL CONSERVATION COMMISSION

Well Location and Acreage Dedication Plat

Section A.

Date _____

Operator CONSOLIDATED OIL AND GAS, INC. Lease 18047
 Well No. 1-5 Unit Letter H Section 5 Township 26 NORTH Range 4 WEST NMPM
 Located 1720 Feet From the NORTH Line, 805 Feet From the EAST Line
 County RIO ARriba G. L. Elevation 7287.0 Dedicated Acreage 320 Acres
 Name of Producing Formation _____ Pool _____

1. Is the Operator the only owner in the dedicated acreage outlined on the plat below?

Yes X No _____

2. If the answer to question one is "no", have the interests of all the owners been consolidated by communization agreement or otherwise? Yes _____ No _____. If answer is "yes", Type of Consolidation.

3. If the answer to question two is "no", list all the owners and their respective interests below:

Owner

Land Description

RECEIVED

RECEIVED

DEC 30 1963

DEC 27 1963

OIL CON. COM.
DIST.U. S. GEOLOGICAL SURVEY
FARMINGTON, NEW MEXICO

Section B.

This is to certify that the information
 in Section A above is true and complete
 to the best of my knowledge and belief.

~~Consolidated Oil & Gas Inc.~~

(Operator)

(Representative)

P.O. Box 2038

(Address)

Farmington, New Mexico

Note: All distances must be from outer boundaries of section.

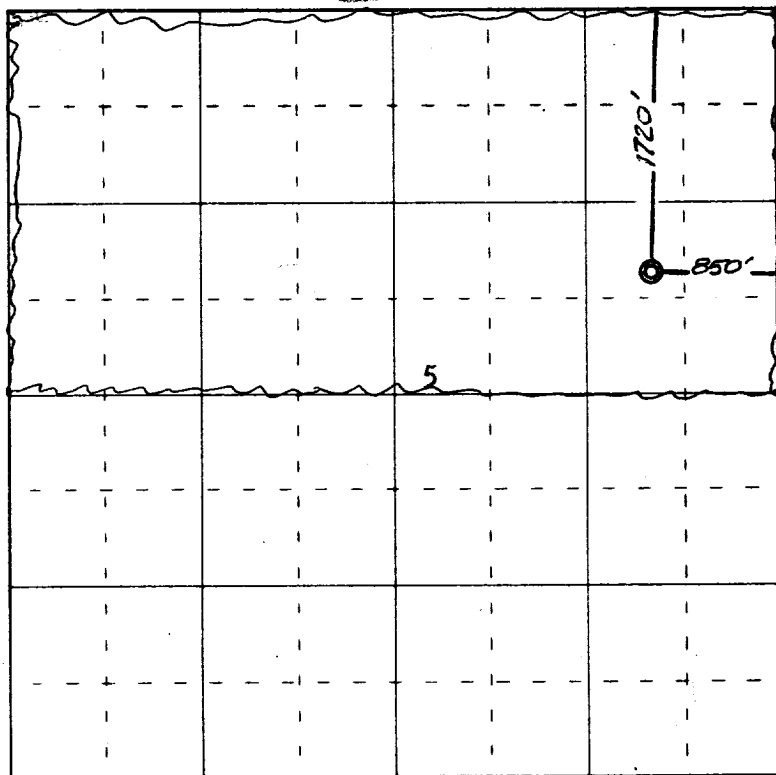

0 330 660 990 1320 1650 1980 2310 2640 2000 1500 1000 500 0

Scale 4 inches equal 1 mile

This is to certify that the above plat was prepared from field notes of actual surveys
 made by me or under my supervision and that the same are true and correct to the best
 of my knowledge and belief.

Date Surveyed 13 December 1963

James P. Leese
 Registered Professional Engineer and/or Land Surveyor
 James P. Leese, N. Mex. Reg. No. 1463
 San Juan Engineering Company

Farmington, New Mexico